

aquatherm greenpipe® - elbow 45°

Material : **fusiolen®** PP-R
 Pipe Series : SDR 6 and up
 In accordance with : NSF-14, NSF-51, NSF-61, CSA-B137.11,
 ICC AC 122, ICC ESR 1613, ASTM F 2389,
 CFIA #A508, ICC PMG-1014, IAPMO
 Color : green

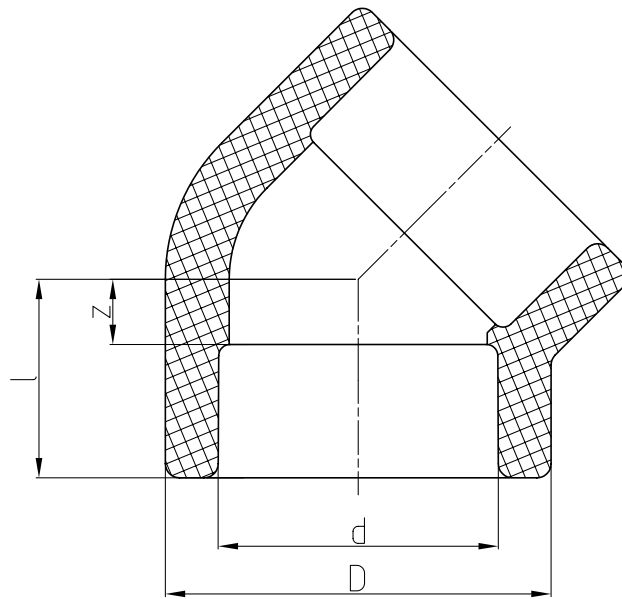

Art.- No.	Dimension	PU	d	z	l	D	Weight
	Nom. I.D.	pc	[in]	[in]	[in]	[in]	lb/pc
0112506	3/8"	10	0.63	0.18	0.69	0.96	0.02
0112508	1/2"	10	0.79	0.20	0.77	1.16	0.03
0112510	3/4"	10	0.98	0.24	0.87	1.34	0.04
0112512	1"	5	1.26	0.30	1.00	1.69	0.08
0112514	1.25"	5	1.57	0.37	1.18	2.05	0.12
0112516	1.5"	5	1.97	0.45	1.38	2.68	0.25
0112518	2"	1	2.48	0.55	1.63	3.31	0.49
0112520	2.5"	1	2.95	0.65	1.83	3.94	0.76
0112522	3"	1	3.54	0.77	2.07	4.72	1.23
0112524	3.5"	1	4.33	0.93	2.38	5.79	2.19
0112526	4"	1	4.92	1.06	2.64	6.57	2.82

aquatherm greenpipe® - elbow 45°

Material : **fusiolen®** PP-R
 Pipe Series : SDR 6 and up
 In accordance with : NSF-14, NSF-51, NSF-61, CSA-B137.11,
 ICC AC 122, ICC ESR 1613, ASTM F 2389,
 CFIA #A508, ICC PMG-1014, IAPMO
 Color : green

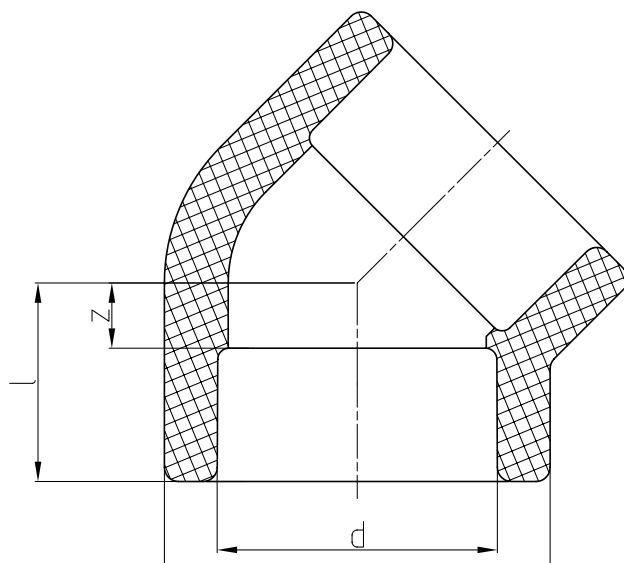

Art.- No.	Dimension [in]	PU	d	z	Weight
	Nom. I.D.	pc	[in]	[in]	lb/pc
0112530	6" -- (SDR 7.4)	1	6.30	3.74	4.19
0112531	6" -- (SDR 11)	1	6.30	3.74	3.03
0112534	8" -- (SDR 7.4)	1	7.87	10.79	18.04
0112535	8" -- (SDR 11)	1	7.87	10.79	11.91
0112538	10" -- (SDR 7.4)	1	9.84	16.22	28.66
0112539	10" -- (SDR 11)	1	9.84	16.22	16.17