

aquatherm greenpipe® - reducing tee

Material : **furiolen®** PP-R
 Pipe Series : SDR 6 and up
 In accordance with : NSF-14, NSF-51, NSF-61, CSA-B137.11,
 ICC AC 122, ICC ESR 1613, ASTM F 2389,
 CFIA #A508, ICC PMG-1014, IAPMO
 Color : green

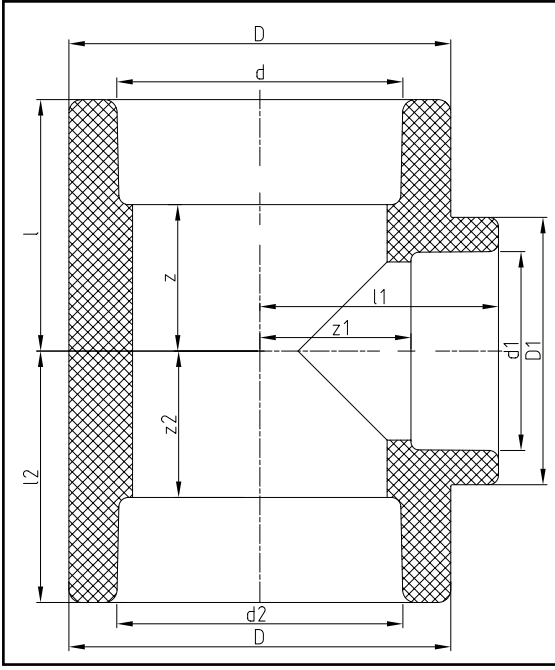

| Art. No. | Dimension | PU | d | l | z | D | d1 | l1 | z1 | D1 | d2 | l2 | z2 | Weight |
|----------|----------------------|----|------|------|------|------|------|------|------|------|------|------|------|--------|
| | Nom. I.D. | pc | [in] | [in] | [in] | [in] | [in] | [in] | [in] | [in] | [in] | [in] | [in] | lb/pc |
| 0113506 | 1/2" X 3/8" X 3/8" | 10 | 0.79 | 1.00 | 0.43 | 1.16 | 0.63 | 1.00 | 0.47 | 1.16 | 0.63 | 1.00 | 0.49 | 0.06 |
| 0113508 | 1/2" X 1/2" X 3/8" | 10 | 0.79 | 1.00 | 0.43 | 1.16 | 0.63 | 1.00 | 0.47 | 1.16 | 0.79 | 1.00 | 0.43 | 0.06 |
| 0113510 | 1/2" X 3/8" X 1/2" | 10 | 0.79 | 1.00 | 0.43 | 1.16 | 0.79 | 1.00 | 0.43 | 1.16 | 0.63 | 1.00 | 0.49 | 0.06 |
| 0113511 | 1/2" X 1/2" X 3/4" | 10 | 0.79 | 1.22 | 0.65 | 1.34 | 0.98 | 1.20 | 0.57 | 1.34 | 0.79 | 1.22 | 0.65 | 0.09 |
| 0113512 | 3/4" X 3/8" X 3/8" | 10 | 0.98 | 1.22 | 0.59 | 1.34 | 0.63 | 1.20 | 0.69 | 1.34 | 0.63 | 1.22 | 0.71 | 0.10 |
| 0113514 | 3/4" X 1/2" X 3/8" | 10 | 0.98 | 1.22 | 0.59 | 1.34 | 0.63 | 1.20 | 0.69 | 1.34 | 0.79 | 1.22 | 0.65 | 0.09 |
| 0113516 | 3/4" X 3/4" X 3/8" | 10 | 0.98 | 1.22 | 0.59 | 1.34 | 0.63 | 1.20 | 0.69 | 1.34 | 0.98 | 1.22 | 0.59 | 0.08 |
| 0113518 | 3/4" X 3/8" X 1/2" | 10 | 0.98 | 1.22 | 0.59 | 1.34 | 0.79 | 1.20 | 0.63 | 1.34 | 0.63 | 1.22 | 0.71 | 0.09 |
| 0113520 | 3/4" X 1/2" X 1/2" | 10 | 0.98 | 1.22 | 0.59 | 1.34 | 0.79 | 1.20 | 0.63 | 1.34 | 0.79 | 1.22 | 0.65 | 0.09 |
| 0113522 | 3/4" X 3/4" X 1/2" | 10 | 0.98 | 1.22 | 0.59 | 1.34 | 0.79 | 1.20 | 0.63 | 1.34 | 0.98 | 1.22 | 0.59 | 0.08 |
| 0113528 | 1" X 1" X 3/8" | 5 | 1.26 | 1.38 | 0.67 | 1.69 | 0.63 | 1.22 | 0.71 | 1.16 | 1.26 | 1.38 | 0.67 | 0.12 |
| 0113532 | 1" X 1/2" X 1/2" | 5 | 1.26 | 1.44 | 0.74 | 1.69 | 0.79 | 1.46 | 0.89 | 1.69 | 0.79 | 1.44 | 0.88 | 0.18 |
| 0113534 | 1" X 1" X 1/2" | 5 | 1.26 | 1.38 | 0.67 | 1.69 | 0.79 | 1.22 | 0.65 | 1.16 | 1.26 | 1.38 | 0.67 | 0.12 |
| 0113540 | 1" X 1" X 3/4" | 5 | 1.26 | 1.38 | 0.67 | 1.69 | 0.98 | 1.36 | 0.73 | 1.69 | 1.26 | 1.38 | 0.67 | 0.14 |
| 0113542 | 1.25" X 1.25" X 1/2" | 5 | 1.57 | 1.63 | 0.83 | 2.05 | 0.79 | 1.42 | 0.85 | 1.34 | 1.57 | 1.63 | 0.83 | 0.20 |

aquatherm greenpipe® - reducing tee

| Art. - No. | Dimension | PU | d | l | z | D | d1 | l1 | z1 | D1 | d2 | l2 | z2 | Weight |
|------------|----------------------|----|------|------|------|------|------|------|------|------|------|------|------|--------|
| | Nom. I.D. | pc | [in] | [in] | [in] | [in] | [in] | [in] | [in] | [in] | [in] | [in] | [in] | lb/pc |
| 0113544 | 1.25" X 1.25" X 3/4" | 5 | 1.57 | 1.63 | 0.83 | 2.05 | 0.98 | 1.42 | 0.79 | 1.34 | 1.57 | 1.63 | 0.83 | 0.20 |
| 0113546 | 1.25" X 1.25" X 1" | 5 | 1.57 | 1.65 | 0.85 | 2.05 | 1.26 | 1.59 | 0.89 | 2.05 | 1.57 | 1.65 | 0.85 | 0.23 |
| 0113547 | 1.5" X 1.5" X 1/2" | 5 | 1.97 | 1.95 | 1.02 | 2.68 | 0.79 | 1.59 | 1.02 | 1.16 | 1.97 | 1.95 | 1.02 | 0.41 |
| 0113548 | 1.5" X 1.5" X 3/4" | 5 | 1.97 | 1.95 | 1.02 | 2.68 | 0.98 | 1.75 | 1.12 | 1.69 | 1.97 | 1.95 | 1.02 | 0.42 |
| 0113550 | 1.5" X 1.5" X 1" | 5 | 1.97 | 1.95 | 1.02 | 2.68 | 1.26 | 1.75 | 1.04 | 1.69 | 1.97 | 1.95 | 1.02 | 0.41 |
| 0113551 | 1.5" X 1.5" X 1.25" | 5 | 1.97 | 1.95 | 1.02 | 2.68 | 1.57 | 1.95 | 1.14 | 2.68 | 1.97 | 1.95 | 1.02 | 0.49 |
| 0113552 | 2" X 2" X 1/2" | 1 | 2.48 | 2.36 | 1.28 | 3.31 | 0.79 | 1.91 | 1.34 | 1.34 | 2.48 | 2.36 | 1.28 | 0.74 |
| 0113554 | 2" X 2" X 3/4" | 1 | 2.48 | 2.36 | 1.28 | 3.31 | 0.98 | 1.91 | 1.28 | 1.34 | 2.48 | 2.36 | 1.28 | 0.75 |
| 0113556 | 2" X 2" X 1" | 1 | 2.48 | 2.36 | 1.28 | 3.31 | 1.26 | 2.11 | 1.40 | 2.05 | 2.48 | 2.36 | 1.28 | 0.76 |
| 0113558 | 2" x 2" X 1.25" | 1 | 2.48 | 2.36 | 1.28 | 3.31 | 1.57 | 2.11 | 1.30 | 2.05 | 2.48 | 2.36 | 1.28 | 0.73 |
| 0113560 | 2" X 2" X 1.5" | 1 | 2.48 | 2.36 | 1.28 | 3.31 | 1.97 | 2.36 | 1.44 | 3.31 | 2.48 | 2.36 | 1.28 | 0.88 |
| 0113561 | 2.5" X 2.5" X 1/2" | 1 | 2.95 | 2.70 | 1.52 | 3.94 | 0.79 | 2.15 | 1.57 | 1.34 | 2.95 | 2.70 | 1.52 | 1.18 |
| 0113562 | 2.5" X 2.5" X 3/4" | 1 | 2.95 | 2.70 | 1.52 | 3.94 | 0.98 | 2.15 | 1.52 | 1.34 | 2.95 | 2.70 | 1.52 | 1.16 |
| 0113564 | 2.5" X 2.5" X 1" | 1 | 2.95 | 2.70 | 1.52 | 3.94 | 1.26 | 2.32 | 1.61 | 2.05 | 2.95 | 2.70 | 1.52 | 1.16 |
| 0113566 | 2.5" X 2.5" X 1.25" | 1 | 2.95 | 2.70 | 1.52 | 3.94 | 1.57 | 2.32 | 1.52 | 2.05 | 2.95 | 2.70 | 1.52 | 1.18 |
| 0113568 | 2.5" X 2.5" X 1.5" | 1 | 2.95 | 2.70 | 1.52 | 3.94 | 1.97 | 2.60 | 1.67 | 3.31 | 2.95 | 2.70 | 1.52 | 1.15 |
| 0113570 | 2.5" X 2.5" X 2" | 1 | 2.95 | 2.70 | 1.52 | 3.94 | 2.48 | 2.60 | 1.52 | 3.31 | 2.95 | 2.70 | 1.52 | 1.21 |
| 0113576 | 3" X 3" X 1" | 1 | 3.54 | 3.11 | 1.81 | 4.72 | 1.26 | 2.56 | 1.85 | 2.05 | 3.54 | 3.11 | 1.81 | 1.99 |
| 0113578 | 3" X 3" X 1.25" | 1 | 3.54 | 3.11 | 1.81 | 4.72 | 1.57 | 2.56 | 1.75 | 2.05 | 3.54 | 3.11 | 1.81 | 1.97 |
| 0113580 | 3" X 3" X 1.5" | 1 | 3.54 | 3.11 | 1.81 | 4.72 | 1.97 | 2.95 | 2.03 | 3.31 | 3.54 | 3.11 | 1.81 | 2.22 |
| 0113582 | 3" x 3" x 2" | 1 | 3.54 | 3.11 | 1.81 | 4.72 | 2.48 | 2.95 | 1.87 | 3.31 | 3.54 | 3.11 | 1.81 | 2.02 |
| 0113584 | 3" X 3" X 2.5" | 1 | 3.54 | 3.11 | 1.81 | 4.72 | 2.95 | 3.19 | 2.01 | 4.72 | 3.54 | 3.11 | 1.81 | 2.29 |
| 0113586 | 3.5" X 3.5" X 2" | 1 | 4.33 | 3.66 | 2.20 | 5.79 | 2.48 | 3.44 | 2.36 | 3.94 | 4.33 | 3.66 | 2.20 | 3.69 |
| 0113588 | 3.5" X 3.5" X 2.5" | 1 | 4.33 | 3.66 | 2.20 | 5.79 | 2.95 | 3.44 | 2.26 | 3.94 | 4.33 | 3.66 | 2.20 | 3.59 |
| 0113590 | 3.5" X 3.5" X 2.5" | 1 | 4.33 | 3.66 | 2.20 | 5.79 | 3.54 | 3.50 | 2.20 | 4.72 | 4.33 | 3.66 | 2.20 | 3.63 |
| 0113592 | 4" X 4" X 2.5" | 1 | 4.92 | 4.59 | 3.01 | 6.57 | 2.95 | 4.19 | 3.01 | 3.94 | 4.92 | 4.59 | 3.01 | 3.59 |
| 0113594 | 4" X 4" X 3" | 1 | 4.92 | 4.59 | 3.01 | 6.57 | 3.54 | 4.31 | 3.01 | 4.72 | 4.92 | 4.59 | 3.01 | 3.63 |
| 0113596 | 4" X 4" X 3.5" | 1 | 4.92 | 4.59 | 3.01 | 6.57 | 4.33 | 4.47 | 3.01 | 5.79 | 4.92 | 4.59 | 3.01 | 5.80 |