

Features

- Acrylic
- 6 individually adjustable ProFlex® hydro-massage jets
- Drop-in
- Left or right drain
- Molded lumbar supports and armrests
- Optional K-9696 whirlpool trim kit in various finishes
- Pump with air switch and grounding-type plug-in cord
- ADA compliant when installed with seat at head end
- Tile flange on three sides for alcove installation [K-1106-L/-R]
- 60" (1524 mm) x 32" (762 mm) x 18-1/8" (460 mm)

BATH WHIRLPOOL

K-1106

ALSO K-1106-L, K-1106-R

ADA

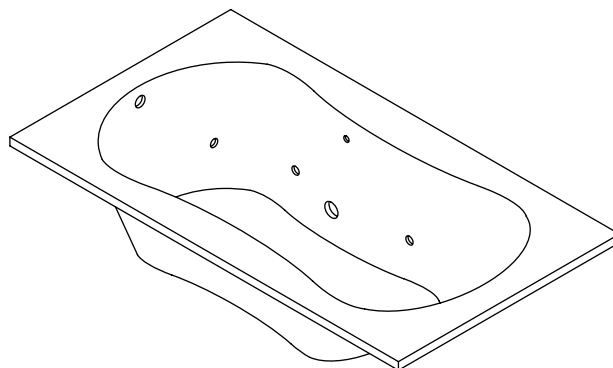

Codes/Standards Applicable

Specified model meets or exceeds the following:

- ASME A112.19.7
- ANSI Z124.1.2
- UL 1795
- ADA
- ASTM E162
- ASTM E662
- ICC/ANSI A117.1

Colors/Finishes

- 0: White
- Other: Refer to Price Book for additional colors/finishes

Accessories

- 0: White
- CP: Polished Chrome
- PB: Polished Brass
- Other: Refer to Price Book for additional colors/finishes

Specified Model

Model	Description	Colors/Finishes	
K-1106	Bath whirlpool – drop-in	<input type="checkbox"/> 0	<input type="checkbox"/> Other_____
K-1106-L	Bath whirlpool – tile flange, left drain	<input type="checkbox"/> 0	<input type="checkbox"/> Other_____
K-1106-R	Bath whirlpool – tile flange, right drain	<input type="checkbox"/> 0	<input type="checkbox"/> Other_____

Recommended Accessories				
K-7213	Clearflo bath cable drain with PVC tubing	<input type="checkbox"/> CP		<input type="checkbox"/> Other_____
K-7214	Clearflo bath cable drain without PVC tubing	<input type="checkbox"/> CP		<input type="checkbox"/> Other_____
K-11677	Adjustable trip lever bath drain	<input type="checkbox"/> CP	<input type="checkbox"/> PB	

Product Specification

The acrylic bath whirlpool shall be 60" (1524 mm) in length, 32" (762 mm) in width, and 18-1/8" (460 mm) in height. Product shall be drop-in or tile flange on three sides for alcove installation [K-1106-L/-R]. Product shall be available with a left or right drain [K-1106-L/-R]. Product shall have 6 individually adjustable ProFlex hydro-massage jets, a pump with air switch and grounding-type plug-in cord, and molded lumbar supports. Product shall be ADA compliant when installed with seat at head end. Product shall have an optional K-9696 whirlpool trim kit in various finishes. Bath whirlpool shall be Kohler Model K-1106-_____.

PROFLEX[®] 6032

Optional Accessories

K-1284	Removable apron	<input type="checkbox"/> 0	<input type="checkbox"/> Other_____
K-9696	Jet trim kit – metal finish	<input type="checkbox"/> 0	<input type="checkbox"/> Other_____

Technical Information

Fixture*:	
Basin area:	
Bottom area	46" (1168 mm) x 20" (508 mm)
Top area	55" (1397 mm) x 22" (559 mm)
Weight	49 lbs (22 kg)
To overflow:	
Water depth	12-1/2" (318 mm)
Capacity	49 gal (185 L)
* Approximate measurements for comparison only.	

Pump:	V	Hz	A
1-speed	120	60	7.5

Required Electrical Service

Dedicated circuit required, protected with a Class A Ground-Fault Circuit-Interrupter (GFCI):

Pump/control 120 V, 15 A, 60 Hz

Locate the outlet behind the whirlpool and within 24" (610 mm) of the pump.

Installation Notes

Install this product according to the installation guide.

Floor support under bath must provide for a minimum of 36 lbs/square foot (177 kg/square meter) loading.

The apron must be installed before the finished floor and wall materials.

No change in measurements if connected with drain illustrated. (K-11677 or K-11677M)

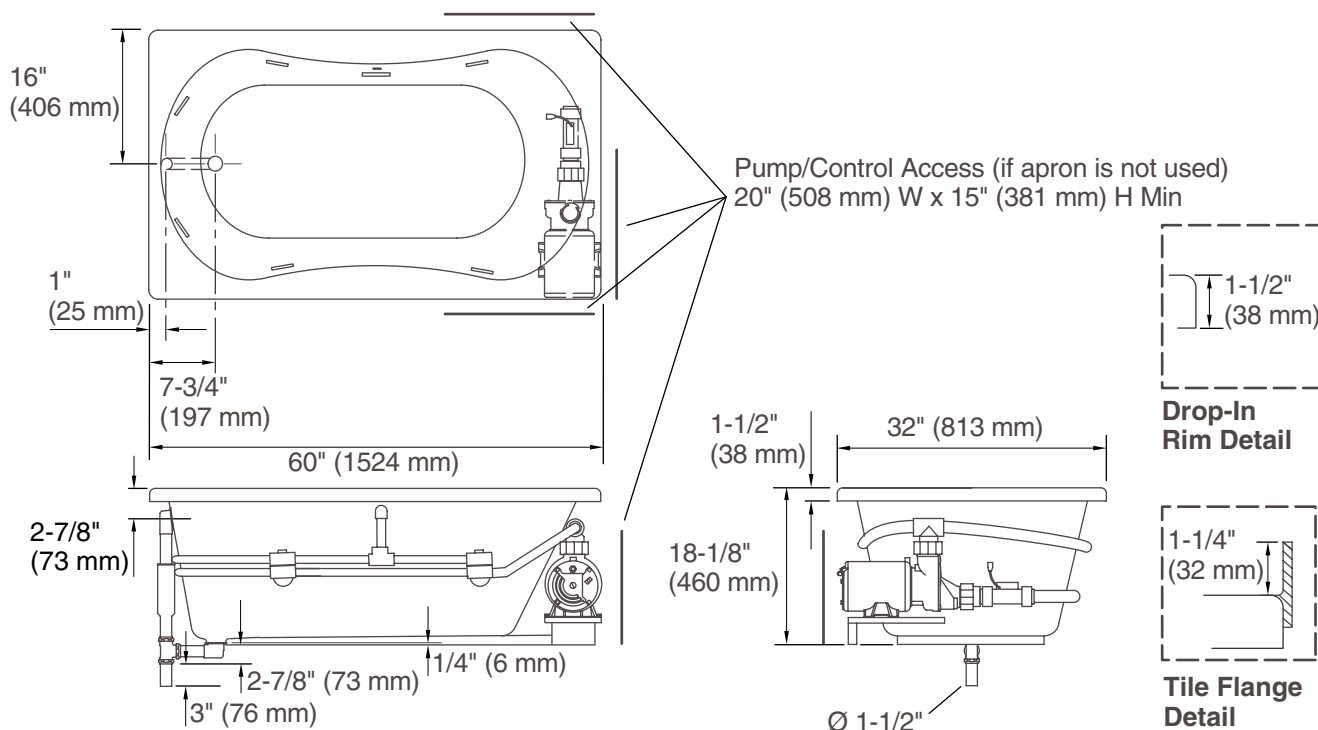

Product Diagram