

# DIMENSIONAL SPECIFICATIONS

## LEAD-FREE BRASS BARSTOCK FITTINGS\*

### COUPLING

Part #	Size (IN.)	Approx. Net WT. (LB.)	A	B
NLBS111-02	1/8	0.02	1.00	0.63
NLBS111-04	1/4	0.04	1.13	0.75

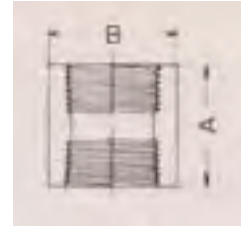

### REDUCING COUPLING

Part #	Size (IN.)	Approx. Net WT. (LB.)	E	F
NLBS112-0402	1/4 X 1/8	0.04	1.13	0.75
NLBS112-0602	3/8 X 1/8	0.07	1.19	0.88
NLBS112-0604	3/8 X 1/4	0.06	1.19	0.88

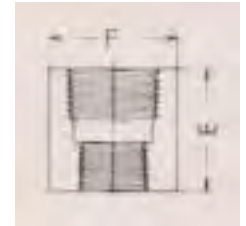

\*Conforms with lead content requirements for lead-free plumbing as defined by the U.S. California Safe Drinking Water Act. Certified <0.25 weighted average % lead.



# MERIT BRASS

DIRECTING THE FLOW OF *Quality*

# DIMENSIONAL SPECIFICATIONS

## LEAD-FREE BRASS BARSTOCK FITTINGS\*

### HEX HEAD BUSHING

Part #	Size (IN.)	Approx. Net WT. (LB.)	A	B
NLBS114-0402	1/4 X 1/8	0.02	0.67	0.63
NLBS114-0602	3/8 X 1/8	0.05	0.75	0.69
NLBS114-0604	3/8 X 1/4	0.04	0.75	0.69
NLBS114-0802	1/2 X 1/8	0.09	0.81	0.88
NLBS114-0804	1/2 X 1/4	0.08	0.81	0.88
NLBS114-0806	1/2 X 3/8	0.06	0.81	0.88
NLBS114-1202	3/4 X 1/8	0.16	0.94	1.06
NLBS114-1204	3/4 X 1/4	0.18	0.94	1.06
NLBS114-1206	3/4 X 3/8	0.15	0.94	1.06
NLBS114-1208	3/4 X 1/2	0.11	0.94	1.06
NLBS114-1612	1 X 3/4	0.22	1.06	1.38

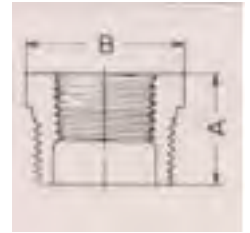

### FACE BUSHING

Part #	Size (IN.)	Approx. Net WT. (LB.)		
NLBS115-0402	1/4 X 1/8	0.01		
NLBS115-0602	3/8 X 1/8	0.02		
NLBS115-0604	3/8 X 1/4	0.02		
NLBS115-0804	1/2 X 1/4	0.05		
NLBS115-0806	1/2 X 3/8	0.03		
NLBS115-1206	3/4 X 3/8	0.06		
NLBS115-1208	3/4 X 1/2	0.05		



\*Conforms with lead content requirements for lead-free plumbing as defined by the U.S. California Safe Drinking Water Act. Certified <0.25 weighted average % lead.



# MERIT BRASS

DIRECTING THE FLOW OF *Quality*

# DIMENSIONAL SPECIFICATIONS

## LEAD-FREE BRASS BARSTOCK FITTINGS\*

### SQUARE HEAD SOLID PLUG

Part #	Size (IN.)	Approx. Net WT. (LB.)	C	D
NLBS117A-02	1/8	0.02	0.69	0.28
NLBS117A-04	1/4	0.04	0.69	0.38
NLBS117A-06	3/8	0.06	0.82	0.44
NLBS117A-08	1/2	0.12	0.94	0.56

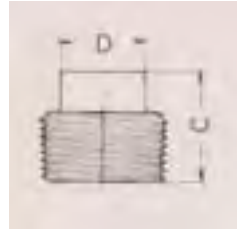

### HEX HEAD PLUG

Part #	Size (IN.)	Approx. Net WT. (LB.)	B	E
NLBS117H-02	1/8	0.02	0.44	0.63
NLBS117H-04	1/4	0.03	0.63	0.75
NLBS117H-06	3/8	0.05	0.69	0.88
NLBS117H-08	1/2	0.08	0.88	0.94
NLBS117H-12	3/4	0.14	1.06	1.06



### SLOTTED HEAD PLUG

Part #	Size (IN.)	Approx. Net WT. (LB.)		
NLBS117S-02	1/8	0.01		



\*Conforms with lead content requirements for lead-free plumbing as defined by the U.S. California Safe Drinking Water Act. Certified <0.25 weighted average % lead.



# MERIT BRASS

DIRECTING THE FLOW OF *Quality*

# DIMENSIONAL SPECIFICATIONS

## LEAD-FREE BRASS BARSTOCK FITTINGS\*

### HEX COUNTERSUNK PLUG

Part #	Size (IN.)	Approx. Net WT. (LB.)	A
NLBS118HC-02	1/8	0.01	0.27
NLBS118HC-04	1/4	0.02	0.41
NLBS118HC-06	3/8	0.03	0.41
NLBS118HC-08	1/2	0.07	0.54



### HEX LOCKNUT

Part #	Size (IN.)	Approx. Net WT. (LB.)	A
NLBS119-08	1/2	0.04	0.54



### CAP

Par#	Size (IN.)	Approx. Net WT. (LB.)	C	F
NLBS116-02	1/8	0.03	0.69	0.63
NLBS116-04	1/4	0.02	0.69	0.75

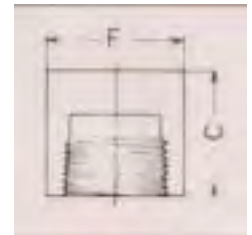

\*Conforms with lead content requirements for lead-free plumbing as defined by the U.S. California Safe Drinking Water Act. Certified <0.25 weighted average % lead.



# MERIT BRASS

DIRECTING THE FLOW OF *Quality*