



Garden Bathtub Installation Instructions

Tools you might need for proper installation

- **Galvanized Nails or Screws**
- **Large Level**
- **Hammer or Screw Gun**
- **Shims**
- **Adhesive**

Thank you for purchasing Praxis Bathware. For best results, please read and follow all directions carefully.

PRE-INSTALLATION PLANNING

- 1.** Please do not store units out of doors. - Keep out of sunlight and exposure to weather.
- 2.** Review Figure 2 for framing recommendations. If a fire rated alcove is required, approved finish material must be installed prior to unit installation. Access to drain and supply connections should be provided so that these connections may be made after the unit has been installed. Framing alcove must reflect exterior dimensions of bathtub to permit installation of unit. Note in diagram the required opening in the floor to provide clearance for the drain trap and fitting connection.

Bathtub must be fastened to the framing studs with galvanized screws or nails through the mounting flanges. The use of ledger boards is not required. Ledger board may be used at installers preference.

- 3.** Each manufactured unit is made with the intent of being shimmed upon installation. This compensates for any settling or slope that may have occurred at the job site floor. The shims are included with the unit, packed inside a plastic bag. The shims need to be placed under the unit after it is put into place and is being leveled.

INSTALLATION PROCEDURE

- 1.** Make certain your recessed framed pocket is square and plumb in accordance with rough-in dimensions. You may prefer to complete framing of the back wall and the plumbing end wall then frame out the opposite end wall after the unit has been set.
- 2.** Finish rough plumbing, but leave unstrapped at this stage. Find drain line and trap locations as shown in raming diagram.

- 3.** If installing spout and faucets on the top deck of the bathtub, or through the wainscoting, Measure and mark locations of fittings on the finished side of the unit. Recheck locations and drill 1/4" pilot holes. Cut holes to final size using the appropriate size hole saw.

- 4.** Drain and/or Overflow assembly should be installed on unit according to the manufacturers instructions. Apply a bead of 100% silicone caulk, around the drain opening in unit before installing the fitting. A 12" x 6" minimum cutout in the sub floor is needed to provide access to the drain fitting.

- 5.** Now move unit into place. Position the unit at the open end of the framed pocket, and tilt into place. If using ledger boards, make sure underside is in contact with the ledger boards.

- 6.** Plumb and level the unit in two directions: Place a level on top of the apron, and along the finished flat area at the top of the wall at each side. When leveled, install wood shims under the back edge of bathtub bottom board. If any gap is present between the floor and bottom of the tub apron at the front, fill with solid shim material.

Mount unit to framing with 6d galvanized nails or screws through the mounting flanges, 8" on center vertically, and to all studs horizontally.

- 7.** Make connections to supply and drain lines. Strap all lines to the framing. Install finish trim. Caulk if necessary.

Check for leaks before closing off plumbing access.

- 8.** Finish wall board as detailed in Figure 4.



Garden Bathtub Installation Instructions

Do not use abrasive cleaners

The most important caution is to avoid use of harsh abrasive cleaners or gritty scouring powders. To clean the unit, simply use a household liquid detergent with soft sponge cloth and warm water. More persistent stains, tar, or paint can be removed with naphtha or mineral spirits. Remove excess plaster by scraping with a sharpened soft wood stick. Avoid wire brushes, metal scrapers or tools. Restore dull areas by rubbing with automotive type body cleaning compound.

CAUTION

If you use a **RUBBER FLOOR MAT** in this tub or shower unit it must be removed after each usage. If left in the unit, it may cause blisters or damage to the surface finish.

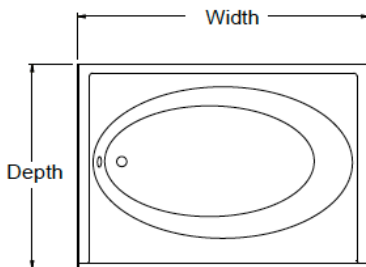

Figure 1

Typical Garden Tub with Center Drain

* Ledger boards are not required.

Place Support Shims

The shims need to be placed under the bottom back edge of the unit after it is put into place and leveled. An adhesive needs to be applied to the bottom of each shim to permanently secure it in place. A minimum of two shims must be used on each unit to ensure proper support and a solid base.

Place shims under 2 x 4 support at back.

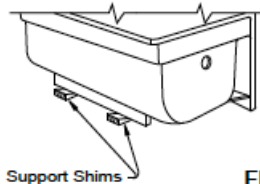

Figure 3

Install and Finish Wall Board

Install wall board so it covers the mounting flanges on the bathing unit. Leave a small gap between the finished surface of the bathing unit and edge of the wall board. Apply caulking to fill this gap.

Fasten wall board to framing studs. Tape seams and finish wall board as typical.

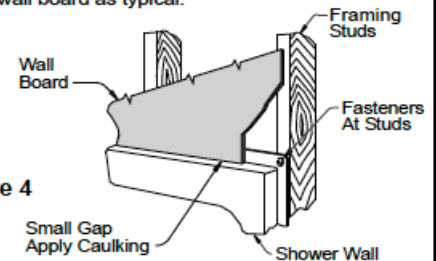

Figure 4

LIMITED WARRANTY

Praxis Companies warrants to the owner of its one piece Shower and Tub/Shower units as follows:

Units manufactured of fiberglass reinforced polyester resin, that it will, free of charge, repair or exchange as its option, any Praxis Companies unit found to be defective in materials or workmanship upon inspection by an authorized representative of Praxis Companies for a period of three (3) years from date of purchase. The exchange of a unit is limited to supplying a replacement unit of comparable size and style and does not include any costs of removal or installation.

This warranty shall be voided if the unit is moved from its place of initial installation or is not installed in accordance with the instructions supplied by the manufacturer of the unit. Further, this warranty does not apply if the unit has been subjected to accident, abuse, misuse, damage caused by flood, fire or act of God.

Since local code requirements vary greatly throughout the country, distributors, dealers, installation contractors and users of plumbing products should determine whether there are any code restrictions on the use of a specific product. Praxis Companies makes no representation or warranty regarding and shall not be responsible for any code compliance.

The owner agrees by use of this unit that the obligations of Praxis Companies shall not exceed to contingent or indirect damage or injury to the structure of its contents, that the obligations of Praxis Companies are limited to those set forth herein, and that no other obligations, expressed or implied, are assumed by Praxis Companies. Contact: Praxis Companies Warranty Department. (800) 443-7289 Ext: 130. gyoung@praxiscompanies.com.

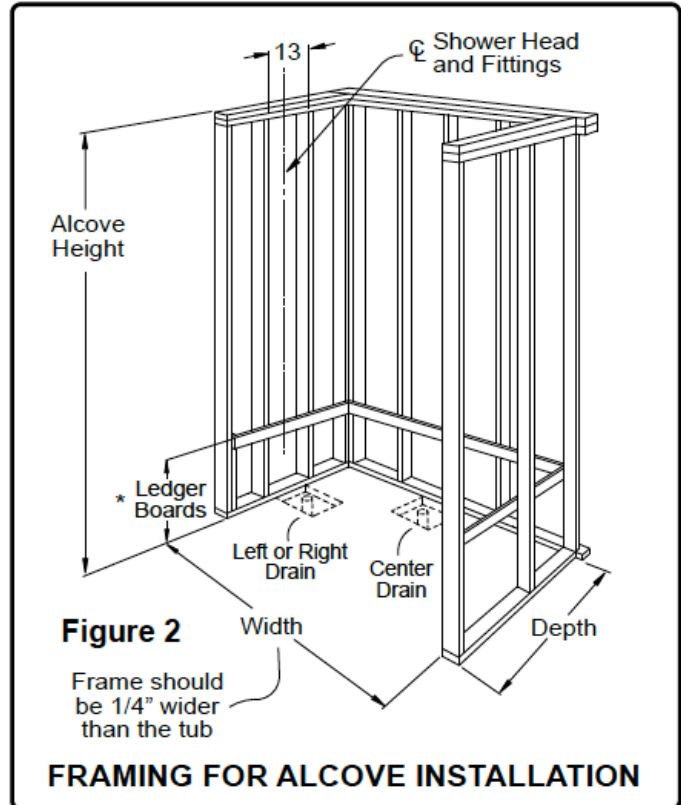

Praxis Companies LLC

435 Industrial Road | Savannah, Tennessee 38372 | Tel: (800) 443 7269 | Fax: (731) 925 0379

www.praxiscompanies.com