

Safety Precautions

Read all safety precautions and installation instructions carefully before installing or servicing this fixture. Failure to comply with these instructions could result in potentially fatal electric shock and/or property damage.

It is recommended that all wiring shall be performed by a qualified electrician. This fixture must be wired in accordance with all national and local electrical codes.

Do not handle any energized fixture or attempt to energize any fixture with wet hands or while standing on a wet or damp surface or in water.

Make sure that the power source conforms to the requirements of the fixture. (See labels on fixture housing).

To reduce the risk of electrical shock, and to assure proper operation, this fixture must be adequately grounded. To accomplish proper grounding, there must be a separate ground wire (green) or bare metal contact (metal conduit) between this fixture and the ground connection of your main power supply panel. The green ground screw location is clearly marked on the fixture housing.

This fixture is intended for use for general indoor lighting in dry locations only.

Assembly Instructions

WCM432 model shown

1. Preparing for installation.

- A. **Disconnect electrical power** before installing or servicing this fixture.
- B. Remove center wire-way cover (3) by squeezing near the dimple (4) at each end in the fixture channel (2).
- C. Remove appropriate knockout(s) for power supply entry (5).

2. Fixture mounting.

- D. Some models have two 1/8" deep by approximately 2 1/4" diameter mounting depressions with a 1/4" diameter hole for mounting (1). Other models have four knockouts located at the outer edges of the fixture channel (1). To remove knockouts it is recommended to use a blunt object facing away from you to punch out.
- E. Position the fixture channel (2) onto the ceiling and mark all appropriate mounting locations. **You may need someone to help you hold the fixture up.** Take the fixture channel (2) down and punch a small hole in the ceiling at each of the locations you have marked using a nail or an awl to see if there is a wood joist above that you can mount the fixture to. Where there is a wood joist, use a suitable wood screw (not included) to mount the fixture. Where there is no joist to screw into, a 3/16" toggle bolt (not included) must be used to mount the fixture channel securely to the ceiling. Secure fixture channel to ceiling.

3. Wiring.

Caution: Make sure power is off at fuse or circuit breaker box. Check power wires for damage or scrapes. If power supply wires are within three inches of ballast use wire suitable for at least 90C (194F). **Note:** Most dwellings built before 1985 have supply wire rated to 60C. Consult a qualified electrician before installing.

- F. This unit will not operate properly unless connected to a "grounded" electrical circuit. Electrical shock, over heating, low or no light output, and shortened lamp life can result if proper grounding is not done. Feed the green (or green and yellow) wire through knockout (5) and securely attach to provided green ground screw (7).
- G. Models ending in MV: Using luminaire disconnect provided, insert white supply wire into the hole across from white ballast lead. Insert black hot supply wire into hole across from black ballast lead. **Do not mix wires.**
- H. All other models: Use wire connectors provided to connect in-coming white supply wire to cord white wire. Connect in-coming black supply wire to cord black wire. **Do not mix wires.**
- I. Replace ballast cover by placing one edge of ballast cover into dimples, swing upward, press cover allowing second edge to catch second set of dimples and lock in place. Make sure no wires become crimped between cover and fixture.
- J. Install appropriate lamps (not included): Insert linear lamp pins into lamp holder. Rotate into place to seat lamp for proper connection. For bent shape U-lamps; align bend in lamp into lamp holders and snap lamp pins into sockets. (not shown)
- K. Install diffuser (8) into decorative frame (9). Slip metal tab on wood frame (11) between channel (2) and the ceiling surface. Swing wood frame (9) up to ceiling. The opposite end of the wood frame (9) uses a 2" screw (10) to secure it to the channel. Insert screw (10) through the wood frame (9) and screw into the end of the channel (2).
- L. Restore power at fuse or circuit breaker box.

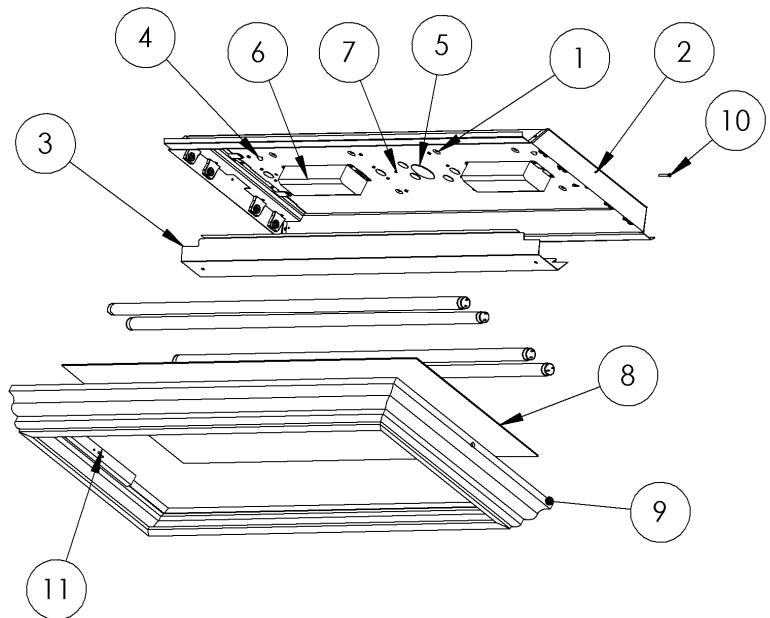

NOTE: It is possible to remove the lamps and diffuser without removing the frame from the fixture.

- A. Slide the diffuser to one corner, which will allow the opposite corner to clear the frame.
- B. Slowly pull the opposite corner of the diffuser past the frame and guide the rest of the diffuser out.
- C. To remove the lamps, rotate them out of their sockets and angle the lamp from corner to corner and drop the lamp through the frame opening. Follow the opposite procedure to replace the lamps.
- D. To replace the diffuser, insert one corner all the way into the corner of the wood frame. Bow the lens slightly and insert the adjacent corner inside of the frame. Bow the lens on the longest edge sliding one corner inside of the frame and then the last corner. Allow the diffuser to drop down and center the lens inside of the wood frame.

Limited Factory Warranty

American Fluorescent Corporation hereby warranty that this fixture is free from defects in materials and workmanship when installed and used under normal operating conditions for a period of 2 years from date of purchase. This warranty covers all component parts and extends only to replacement of defective fixture or components; it does not cover failure due to improper installation, misuse, mishandling or damage incurred in transit.