

4

3

2

1

**BILL OF MATERIAL (CURRENT LEVEL)**

ITEM	PT/ASSY	DESCRIPTION	TYPE	QTY.
1	1-229	HOTEL SHELF HARDWARE PACK	ASSEMBLY	2
2	1-231	M3 HEX KEY AND M6 X 6 SET SCREWS KIT	ASSEMBLY	1
3	40402	HOTEL SHELF ROSETTE	PART	2
4	11XXC	MOUNTING BRACKET	PART	2

**NOTES:**

1. PLACE ITEMS 1,2 AND 4 IN SEPARATE BAG.

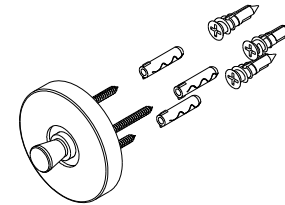
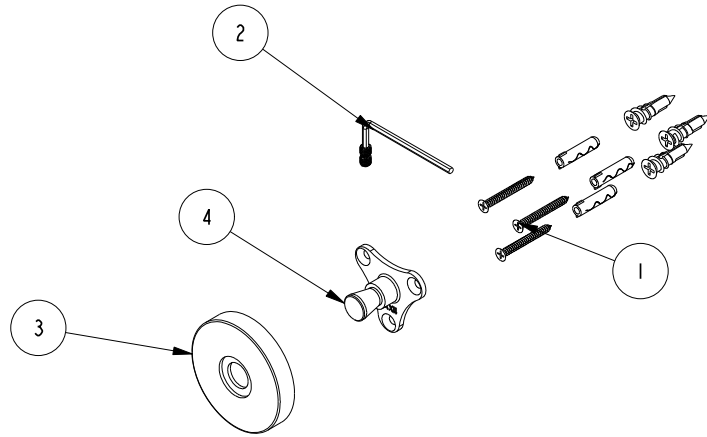

COPYRIGHT 2005 GINGER. THESE DRAWINGS AND THE DESIGNS DEPICTED HEREIN ARE THE PROPRIETARY PROPERTY OF GINGER. ANY USE OR REPRODUCTION IS SUBJECT TO THE EXPRESS APPROVAL OF GINGER. UNAUTHORIZED USE IS STRICTLY PROHIBITED. ALL RIGHTS RESERVED.

**GINGER**

2001 E. CARNEGIE AVE.  
SANTA ANNA CA 92705  
(949) 417-5207

**HOTEL SHELF MOUNTING KIT**

ASSY. NO.

**464B**

SCALE .250

REF. -

SHEET | OF |

REV

EN-1706

03/07/11

REV DESC

DATE

4

3

2

1