

CorStone®

SELF RIM INSTALLATION

Required Tools and Materials

- Eye and ear protection is always recommended.
- Pencil
- Jig-saw
- Sandpaper
- Silicone adhesive sealant
- Tape measure
- Drill and 1/4" bit
- Router
- Cleaning materials

If this is a replacement for a sink of the same size, no cutting of your existing countertop is necessary. If this is a new installation, or you are replacing a smaller sink, we offer the following useful advice :

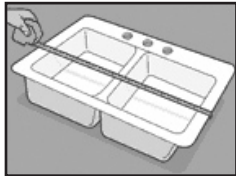

Fig. 1



Fig. 2

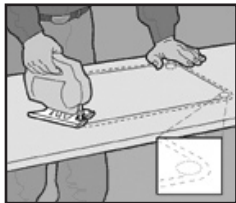

Fig. 3



Fig. 4

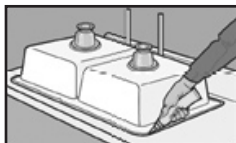

Fig. 5



Fig. 6

1. Measure Sink. (Fig. 1) Using measurement find center point over the cabinet area where sink is to be installed.
2. Place the sink UPSIDE DOWN on counter top.(Fig. 2) With a pencil, trace a line around the outside edge of the sink onto the countertop.
3. Remove sink from the countertop.
4. Measure in 1/2" and draw new lines inside the first sink outline.
5. Cut out the countertop on this INNER line. (Fig. 3)
6. Install the sink hardware - faucets, drain etc. before installing sink in cutout area of the countertop. (Fig. 4) Remember to install basket strainers and drains with plumbers putty only. Caulk and other adhesives are not meant for this usage.
7. Clean edge of cutout with denatured alcohol; place a bead of silicone sealant around the perimeter of the rim.
8. Turn sink upside down and apply a bead of silicone to the outer rim. (Fig. 5)
9. Check location of drain trap and water supply outlets.
10. Carefully place sink in position, line up all hardware with taps and drain. Press sink firmly into place. Allow to set overnight, without moving or disturbing in any way. No clamps required! (Fig. 6)
11. After 24 hours, apply another bead of caulk around rim of sink, where it makes contact with the countertop. To complete your installation, smooth and trim the bead of caulk. Let dry overnight. You're all set to use your beautiful new sink!

CARE AND CLEANING INSTRUCTIONS

This sink has been designed and engineered to resist scratches and stains when used properly. The durable finish will resist food acids and should not stain under normal kitchen use. Improper use can and may damage this sink or its finish and void the warranty.

Please review the following instructions carefully before using your sink.

How to Clean Your Sink

- Rinse the sink thoroughly after every use.
- Sink scratches can be buffed and polished with CorStone® Creme Polish.
- Common household bleach may be used to spruce up and sanitize your sink. Although the cast acrylic surface will not absorb stains, occasionally a residue will build up on the surface that may. Simply wipe with bleach to remove.
- The use of abrasive cleaners is not necessary as wiping with a soft cloth or sponge and liquid soap will remove any residue.
- The use of abrasive cleaners will void the warranty and dull the finish of the sink.

Using Your Sink

- For years of satisfactory use and service, your sink should be rinsed thoroughly and dried with a soft towel after every use.
- Wipe-down with a solution of bleach and water in the bowl once a week. Towel dry and your sink will sparkle and shine.
- The use of protective mats, racks or dishpans in this sink is recommended. Regular cleaning and rinsing underneath mats will help maintain your sink.
- Always use a cutting board or sink protector when using knives or sharp objects in the sink.
- Do not leave wet dishrags, sponges or cleaning pads in your sink as the residue may discolor and dry on the sink surface.
- Steel wool pads should never be used on your sink or left on the surface areas as small particles of iron may rust and embed into the sink surface.
- Restore surface with CorStone® Creme Polish.
- Never pour or place hot grease or pots directly into your sink. Wait until pot and contents have cooled before placing in sink. Remember, if you do happen to damage this sink, minor cuts or scratches can be buffed and polished to restore the finish.

LIMITED LIFETIME WARRANTY

Products are warranted to be free from defects in materials and workmanship.

This warranty excludes:

1. Any obligation other than replacement of defective parts, when presented to the selling distributor, together with proof of purchase, during the warranty period.
 2. Any labor charges, removal and reinstallation expense, freight or postage, or any incidental or consequential damages resulting from any defective product.
 3. Products classified as "accessories."
 4. Normal wear and tear.
- This warranty shall be voided by any of the following:
1. Modification.
 2. Improper installation, care or maintenance of the product.
 3. Use of the product for any purpose or in any manner other than for which it is specifically intended.
 4. Improper use and maintenance contrary to use and care instructions. This warranty supersedes any and all other warranties, expressed or implied. The foregoing warranties are exclusive and made only to the buyer.

NO OTHER WARRANTY, WHETHER EXPRESSED, IMPLIED, OR STATUTORY INCLUDING ANY WARRANTY OF MERCHANTABILITY OR FITNESS FOR A PARTICULAR PURPOSE SHALL EXIST IN CONNECTION WITH ANY OF THE GOODS OR SERVICES SUPPLIED HEREUNDER, AND ALL SUCH WARRANTIES ARE HEREBY EXPRESSLY EXCLUDED.

No employee, agent, or other person is authorized to give any warranties on behalf of CorStone in addition to or different from those herein given, or to assume for CorStone any other liability in connection with any of its products except in writing which is signed by an officer of CorStone expressly and intentionally giving such warranties or assuming such liability.