

Flapperless™ toilets are supplied as a complete unit, including all components which are designed to work in conjunction with each other, to give satisfactory service and reliability. Substitution with any other parts or components not supplied by Niagara Flapperless™ could result in product failure, potential flooding, a failure of the installation, and consequent water damage.

In cases where parts are substituted, Niagara Flapperless™ can not be held liable for any damages. In order to have your new toilet provide the best performance, we assemble all of the components at the factory. Each fill valve is designed to meet the highest code and flushing requirements.

TO ORDER REPLACEMENT PARTS FOR YOUR NIAGARA FLAPPERLESS™ TOILET,
PLEASE CALL NIAGARA FLAPPERLESS™ AT (800) 831-8383.

Troubleshooting Guide		
Problem	Possible Cause	Corrective Action
Poor or sluggish flush	A. Water supply is blocked. B. Water level is too low in dump bucket. C. Water level in Flapperless™ dump bucket is too low. D. Water level in bowl is too low. E. Water supply valve is partially closed. F. Partially clogged trapway or drain. G. Outlet is partially blocked by wax gasket. H. Water inlet screen is clogged.	A. Shut off water supply, disconnect supply and check water supply valve opening. (Valve is located on wall or floor.) B. Adjust water level in dump bucket by turning black screw on top of float arm counterclockwise to raise the level. Water level must be on the water line mark. C. Refer to installation instructions (Step 8) to adjust water level. D. Check the refill reservoir inside bottom of tank to ensure the drain hole is open. E. Open supply valve. F. Clear passage with plunger or auger. If you are unable to clear blockage, please contact a plumber. G. Lift toilet and replace wax ring gasket (see Step 1 of installation instructions). H. Shut off water supply valve; remove water supply tube from bottom of supply pipe assembly (C2216-1). Remove water inlet filter screen from inside of the bottom of supply tube and clean. Reinstall filter screen in bottom of supply pipe assembly; attach water supply tube and turn water supply valve on.
Fill valve does not shut off	A. Water level in dump bucket is too high. B. Sand or debris lodged in the valve. C. Fill valve disk shut-off seal may need to be replaced.	A. Refer to installation instructions (Step 8) to adjust the water level. B. Shut off water supply valve; remove front cap from the Fluidmaster™ valve by turning counterclockwise; turn water supply on very slowly and flush out the line. C. Shut off water supply; remove the front cap from the Fluidmaster™ valve and replace the rubber seal disk (Fluidmaster™ Part No. 242).
Warning: Do not place toilet bowl cleaner tablets in the bottom of the toilet tank. The use of the tablets in this manner may cause the bowl to clog. If toilet bowl cleaner tablets are to be used, they must be placed in the Toilet Bowl Refill Reservoir (C2216-7) and not in the bottom of the tank.		

Note: Detail, below, shows tank in the 10" rough-in position. Tank slides to the rear by 2" for 12" rough-in. Tank may be adjusted anywhere between 10" and 12".



Flapperless Dump Bucket Repair Parts*

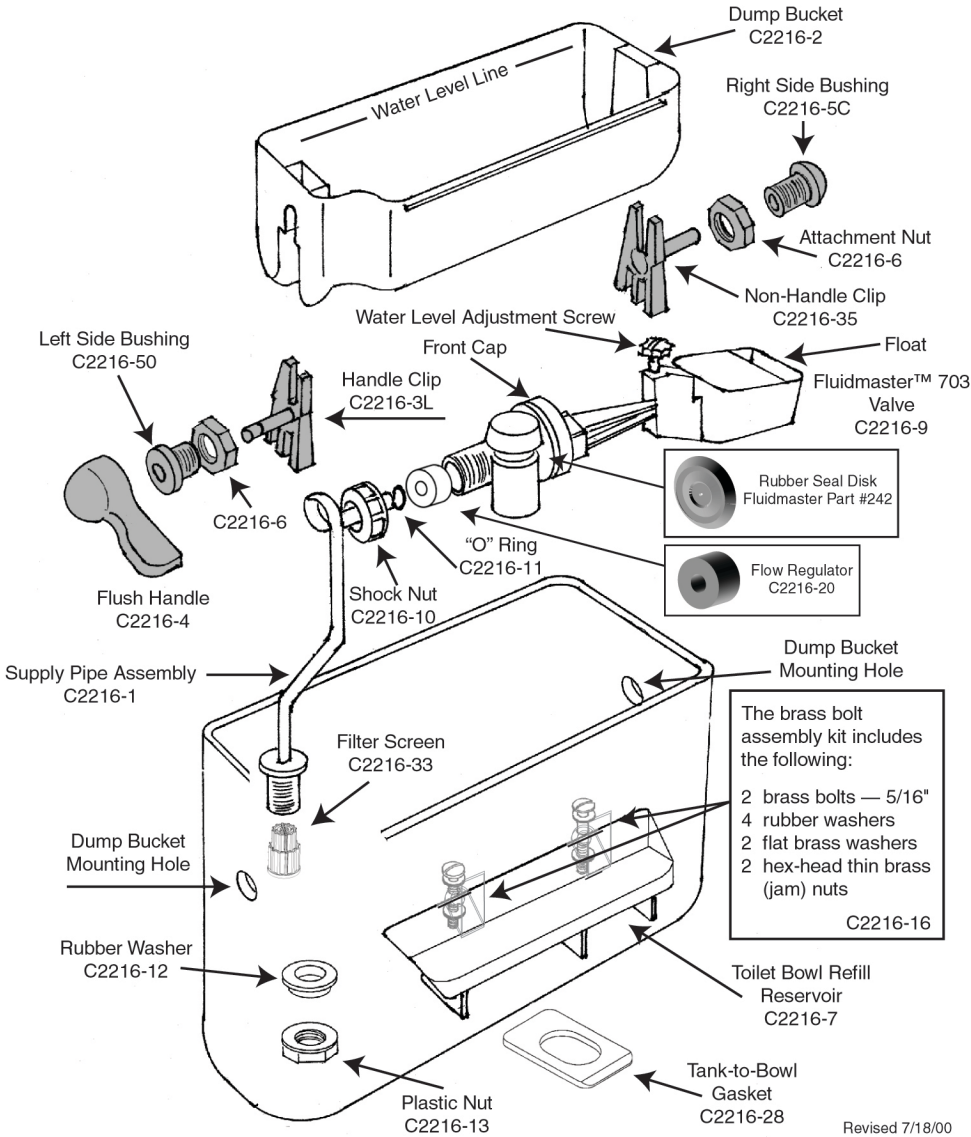

Revised 7/18/00

*Left-hand assembly of flush handle components shown in shaded areas; reverse these parts for right-hand flush handle assembly.

TO ORDER REPLACEMENT PARTS FOR YOUR NIAGARA FLAPPERLESS™ TOILET,
PLEASE CALL NIAGARA FLAPPERLESS™ AT (800) 831-8383.

Niagara Flapperless™ Toilet Installation Instructions

Vitreous china plumbing products are heavy and fragile. To avoid injury or damage, ask for assistance and handle with extreme care.

You have just purchased the best gravity-flush, 1.6-gallon-per-flush (6.0 LPF) toilet one can purchase. To insure proper installation, carefully read these instructions and be sure you have the proper tools to complete the job.

When installing a 1.6-gallon-per-flush (6.0 LPF) toilet, make sure the plumbing system is vented adequately and that the soil pipe is clean.

Be very cautious when working with vitreous china plumbing products. Vitreous china can break and chip if you overtighten mounting bolts or nuts. Such breaks and chips are as sharp as glass and should be handled with care. Take care when handling these products.

Recommended Tools

- 1/2" x 9/16" box or open-end wrench
- Adjustable wrench
- Caulking
- Hacksaw
- Level
- Putty knife
- Screwdriver
- Tape measure

TO START, TURN OFF THE MAIN WATER SUPPLY.

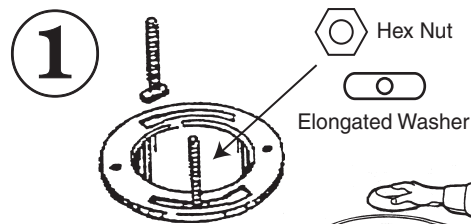

Install new "T" bolts with elongated brass flat washers and thin brass hex-head (jam) nuts.

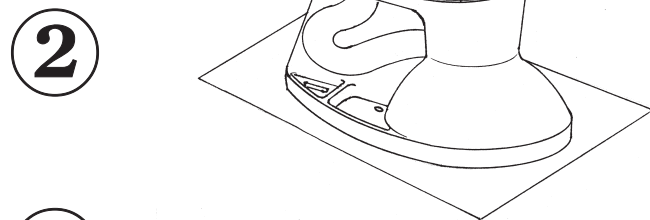

Remove the toilet from the box and set the toilet upside-down on a soft surface. (You may use the box for this purpose.) Set the wax ring firmly in place around the outlet of the toilet.

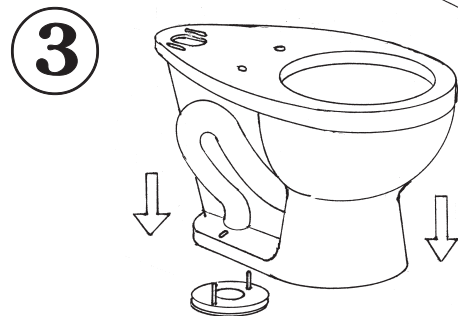

Carefully lower the toilet bowl onto the floor flange while aligning the "T" bolts through the two holes in the toilet bowl foot.

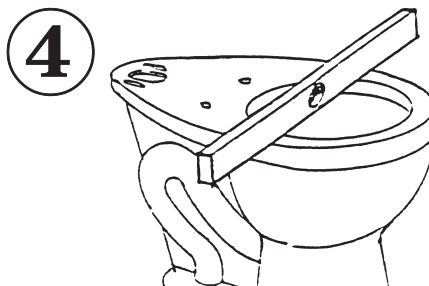

Make sure that the toilet bowl is level. If the toilet tilts or is rocking, insert shims under the base.

Install the plastic washer (be sure that the side marked "top" is facing up), round metal washer, and full hex nut. **DO NOT OVERTIGHTEN.** Cut off any excess bolt length and snap the bolt cap in place. Run a bead of caulk around the base of the toilet for a finished look and to meet plumbing codes.

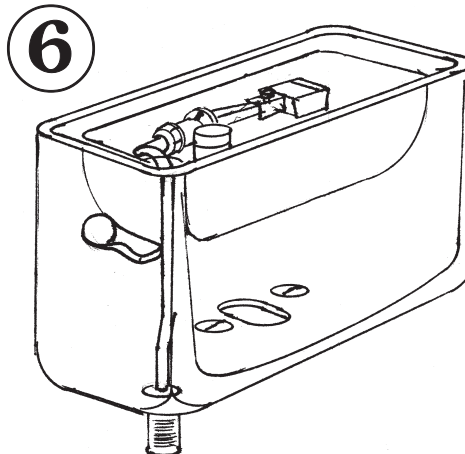
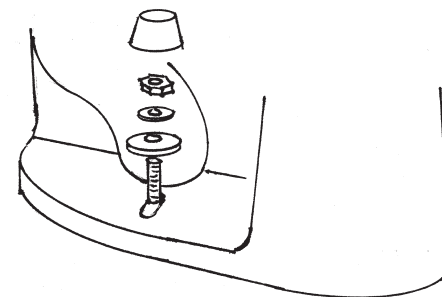

Install the toilet tank. (The tank has been factory assembled and has the gasket seal between the bowl and the bottom of the tank and is ready to set in place.) Place the tank on the toilet bowl. Slide the tank toward the front or back of the bowl until the desired gap is obtained between the tank and the wall. (Note: the gap is normally 1/2- to 1-inch.) Secure the tank in place with the two (2) metal washers and (2) wing nuts provided. **DO NOT OVERTIGHTEN.**

Connect the water supply to the toilet fill valve and hand tighten. Carefully connect the water supply to the shut-off valve.

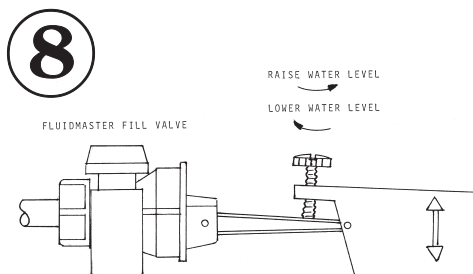
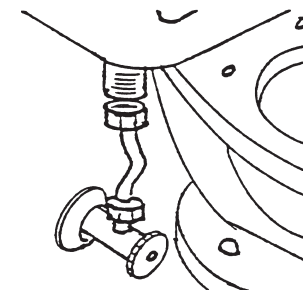

Open the shut-off valve slowly and check for leaks. Fill the Flapperless™ dump bucket to the water line. Adjust the level, if necessary, by turning the black screw on top of the float. Turn the screw to the right to lower the water level or to the left to raise the level.