

FireLock® Butterfly Valve



SERIES 705 WITH WEATHERPROOF ACTUATOR

The Series 705 Butterfly Valve features a weatherproof actuator housing Approved for indoor or outdoor use, a ductile iron body and disc with Nitrile seats. Designed for fire protection services only. Victaulic FireLock Series 705 Butterfly Valve is cULus Listed, LPCB Listed, FM and VdS Approved for 300 psi/2068 kPa service. Contact Victaulic for details of agency approvals.



APPROVALS AND LISTINGS

	Approval/Listing Service Pressures Series 705 Butterfly Valve			
	cULus	FM	VdS	LPCB
2"/50mm	up to 300psi/2068kPa	n/a	up to 300psi/2068kPa	up to 300psi/2068kPa
2 1/2"/65mm	up to 300psi/2068kPa	up to 300psi/2068kPa	n/a	up to 300psi/2068kPa
76.1mm	up to 300psi/2068kPa	up to 300psi/2068kPa	up to 300psi/2068kPa	up to 300psi/2068kPa
3"/80mm	up to 300psi/2068kPa	up to 300psi/2068kPa	up to 300psi/2068kPa	up to 300psi/2068kPa
4"/100mm	up to 300psi/2068kPa	up to 300psi/2068kPa	up to 300psi/2068kPa	up to 300psi/2068kPa
5"/125mm	up to 300psi/2068kPa	up to 300psi/2068kPa	n/a	up to 300psi/2068kPa
139.7mm	up to 300psi/2068kPa	up to 300psi/2068kPa	up to 300psi/2068kPa	up to 300psi/2068kPa
6"/150mm	up to 300psi/2068kPa	up to 300psi/2068kPa	up to 300psi/2068kPa	up to 300psi/2068kPa
165.1mm	up to 300psi/2068kPa	up to 300psi/2068kPa	n/a	up to 300psi/2068kPa
8"/200mm	up to 300psi/2068kPa	up to 300psi/2068kPa	up to 300psi/2068kPa	up to 300psi/2068kPa
10"/250mm	up to 300psi/2068kPa	up to 300psi/2068kPa	n/a	up to 300psi/2068kPa
12"/300mm	up to 300psi/2068kPa	up to 300psi/2068kPa	n/a	up to 300psi/2068kPa

JOB/OWNER

System No. _____

Location _____

CONTRACTOR

Submitted By _____

Date _____

ENGINEER

Spec Sect _____ Para _____

Approved _____

Date _____

FireLock® Butterfly Valve

SERIES 705
WITH WEATHERPROOF ACTUATOR

MATERIAL SPECIFICATIONS

Body: Ductile iron conforming to ASTM A-536, grade 65-45-12

End Face, 2 – 6"/50 – 150 mm: Ductile iron conforming to ASTM A-536, grade 65-45-12

Seal Retainer, 8 – 12"/200 – 300 mm: Ductile iron conforming to ASTM A-536, grade 65-45-12

Coating: Black alkyd enamel

Disc: Ductile iron conforming to ASTM A-536, grade 65-45-12, with electroless nickel coating conforming to ASTM B-733

Seat:

- Grade "T3" Nitrile

Stems: 416 stainless steel conforming to ASTM A-582

Stem Seal Cartridge: C36000 brass

Bearings: Stainless Steel with TFE lining

Stem Seals: Nitrile

Stem Retaining Ring: Carbon steel

Actuator:

- 2 - 8"/50 - 200mm: Brass or bronze traveling nut on a steel lead screw, in a ductile iron housing
- 10 - 12"/250 - 300mm: Steel worm and cast iron quadrant gear, in a cast iron housing

FireLock® Butterfly Valve

**SERIES 705
WITH WEATHERPROOF ACTUATOR**

DIMENSIONS –

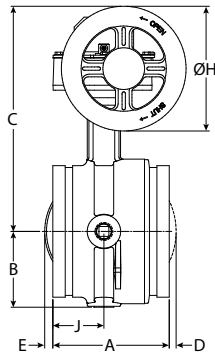
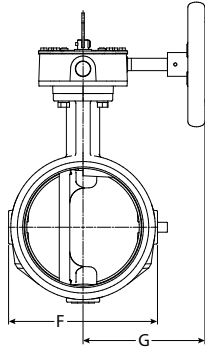

Note: Optional 1/2"15mm tap available.
Contact Victaulic for details.

Size		Dimensions – Inches/millimeters									
Size	Outside Diameter	End to End A	B	C	D	E	F	G	DIA H	J	
2" 60.3 mm	2.375 60.3	4.25 108.0	2.28 57.9	6.41 162.8	—	—	4.00 101.6	4.22 107.2	4.50 114.3	2.12 53.8	
2½" 73 mm	2.875 73.0	3.77 95.8	2.28 57.9	7.54 191.5	—	—	4.00 101.6	4.22 107.2	4.50 114.3	1.77 45.0	
76.1 mm	3.000 76.1	3.77 95.8	2.28 57.9	7.54 191.5	—	—	4.00 101.6	4.22 107.2	4.50 114.3	1.77 45.0	
3" 88.9 mm	3.500 88.9	3.77 95.8	2.53 64.3	7.79 197.9	—	—	4.50 114.3	4.22 107.2	4.50 114.3	1.77 45.0	
108 mm	4.250 108.0	4.63 117.6	2.88 73.2	8.81 223.8	—	—	5.50 139.7	4.22 107.2	4.50 114.3	2.20 55.9	
4" 114.3 mm	4.500 114.3	4.63 117.6	2.88 73.2	8.81 223.8	—	—	5.50 139.7	4.22 107.2	4.50 114.3	2.20 55.9	
133 mm	5.250 133.0	5.88 149.4	3.35 85.1	10.88 276.4	—	—	6.56 166.6	6.19 157.2	6.30 160.0	2.58 65.5	
139.7 mm	5.500 139.7	5.88 149.4	3.35 85.1	10.88 276.4	—	—	6.56 166.6	6.19 157.2	6.30 160.0	2.58 65.6	
5" 141.3 mm	5.563 141.3	5.88 149.4	3.35 85.1	10.88 276.4	—	—	6.56 166.6	6.19 157.2	6.30 160.0	2.58 65.5	
159 mm	6.250 159.0	5.88 149.4	3.84 97.5	11.38 289.1	—	0.41 10.4	7.52 191.0	6.19 157.2	6.30 160.0	2.58 65.5	
165.1 mm	6.500 165.1	5.88 149.4	3.84 97.5	11.38 289.1	—	0.41 10.4	7.52 191.0	6.19 157.2	6.30 160.0	2.58 65.5	
6" 168.3	6.625 168.3	5.88 149.4	3.84 97.5	11.38 289.1	—	0.41 10.4	7.52 191.0	6.19 157.2	6.30 160.0	1.90 48.3	
8" 219.1 mm	8.625 219.1	5.33 135.4	5.07 128.8	13.53 343.6	0.80 20.3	1.47 37.3	10.00 254.0	6.19 157.2	8.10 205.7	2.33 59.2	
10" 273 mm	10.750 273.0	6.40 162.6	6.37 161.8	15.64 397.3	1.41 35.8	1.81 46.0	12.25 311.2	8.10 205.7	9.00 228.6	—	
12" 323.9 mm	12.750 323.9	6.50 165.1	7.36 186.9	16.64 422.7	2.30 58.4	2.80 71.1	14.25 362.0	8.10 205.7	9.00 228.6	—	

FireLock® Butterfly Valve

**SERIES 705
WITH WEATHERPROOF ACTUATOR**

PERFORMANCE

The chart expresses the frictional resistance of Victaulic Series 705 Butterfly Valve in equivalent feet/meters of straight pipe.

Size			Size		
Nominal Size Inches mm	Actual Outside Diameter Inches mm	Equiv. Feet/m of Pipe	Nominal Size Inches mm	Actual Outside Diameter Inches mm	Equiv. Feet/m of Pipe
2 50	2.375 60.3	6 1.8	6 150	6.625 168.3	14 4.2
2½ 65	2.875 73.0	6 1.8	159 mm	159 mm	14 4.3
76.1 mm	3.000 76.1	6 1.8	165.1 mm	6.500 165.1	14 4.2
3 80	3.500 88.9	7 2.1	8 200	8.625 219.1	16 4.9
4 100	4.500 114.3	8 2.4	10 250	10.750 273.0	18 5.5
108 mm	108 mm	8 2.4	12 300	12.750 323.9	19 5.8
5 125	5.563 141.3	12 3.7			
133 mm	133 mm	12 3.7			
139.7 mm	5.500 139.7	12 3.7			

FireLock® Butterfly Valve

**SERIES 705
WITH WEATHERPROOF ACTUATOR**

PERFORMANCE

C_v values for flow of water at +60°F/+16°C with a fully open valve are shown in the table below. For additional details, contact Victaulic.

Formulas for C_v Values:

$$\Delta P = \frac{Q^2}{C_v^2}$$

$$Q = C_v \times \sqrt{\Delta P}$$

Where:

Q = Flow (GPM)

ΔP = Pressure Drop (psi)

C_v = Flow Coefficient

Size		C _v (Full Open)	Size		C _v (Full Open)	Size		C _v (Full Open)
Nominal Size Inches mm	Actual Outside Diameter Inches mm		Nominal Size Inches mm	Actual Outside Diameter Inches mm		Nominal Size Inches mm	Actual Outside Diameter Inches mm	
2	2.375 60.3	170	5 125	5.563 141.3	1200	8 200	8.625 219.1	3400
2½ 65	2.875 73.0	260	133 mm	133 mm	1200	10 250	10.750 273.0	5800
76.1 mm	3.000 76.1	260	139.7 mm	5.500 139.7	1200	12 300	12.750 323.9	9000
3 80	3.500 88.9	440	6 150	6.625 168.3	1800			
4 100	4.500 114.3	820	159 mm	159 mm	1800			
108 mm	108 mm	820	165.1 mm	6.500 165.1	1800			

Formulas for K_v Values:

$$\Delta P = \frac{Q^2}{K_v}$$

$$Q = K_v \times \sqrt{\Delta P}$$

Where:

Q = Flow (m³/hr)

ΔP = Pressure (bar)

K_v = Flow Factor

Size		K _v (Full Open)	Size		K _v (Full Open)	Size		K _v (Full Open)
Nominal Size Inches mm	Actual Outside Diameter Inches mm		Nominal Size Inches mm	Actual Outside Diameter Inches mm		Nominal Size Inches mm	Actual Outside Diameter Inches mm	
2	2.375 60.3	147	5 125	5.563 141.3	1040	8 200	8.625 219.1	2940
2½ 65	2.875 73.0	225	133 mm	133 mm	1040	10 250	10.750 273.0	5020
76.1 mm	3.000 76.1	225	139.7 mm	5.500 139.7	1040	12 300	12.750 323.9	7790
3 80	3.500 88.9	380	6 150	6.625 168.3	1560			
4 100	4.500 114.3	710	159 mm	159 mm	1560			
108 mm	108 mm	710	165.1 mm	6.500 165.1	1560			

FireLock® Butterfly Valve

SERIES 705 WITH WEATHERPROOF ACTUATOR

SWITCH AND WIRING

1. The supervisory switch contains two single pole, double throw, pre-wired switches.
2. Switches are rated:
 - 10 amps @ 125 or 250 VAC/60 Hz
 - 0.50 amps @ 125 VDC
 - 0.25 amps @ 250 VDC
3. **Switches supervise the valve in the “OPEN” position.**
4. One switch has two #18 insulated wires per terminal, which permit complete supervision of leads (refer to diagrams and notes below). The second switch has one #18 insulated wire per terminal. This double circuit provides flexibility to operate two electrical devices at separate locations, such as an indicating light and an audible alarm, in the area that the valve is installed.
5. A #14 insulated ground lead (green) is provided.
 - Switch #1 = S1 For connection to the supervisory circuit of a UL Listed alarm control panel
 - Switch #2 = S2 Auxiliary switch that may be connected to auxiliary devices, per the authority having jurisdiction

- | | | |
|----|---|--|
| S1 | { | Normally Closed: (2) Blue
Common: (2) Yellow |
| S2 | { | Normally Closed: Blue with Orange Stripe
Normally Open: Brown with Orange Stripe
Common: Yellow with Orange Stripe |

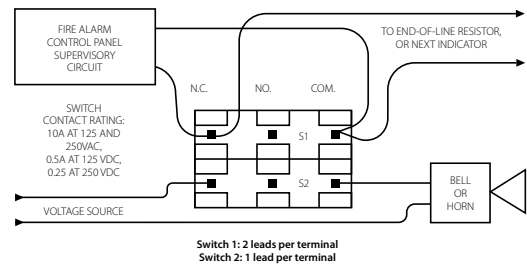
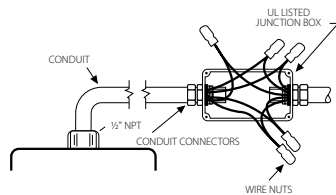

NOTE: The above diagram shows a connection between the common terminal (yellow – S1 and yellow-with-orange stripe – S2) and the normally closed terminal (blue – S1 and blue-with-orange stripe – S2). In this example, the indicator light and alarm will stay on until the valve is fully open. When the valve is fully open, the indicator light and alarm will go out. Cap off any unused wires (e.g. brown with orange stripe).

Only S1 (two leads per terminal) may be connected to the fire alarm control panel.

The connection of the alarm switch wiring shall be in accordance with NFPA 72 and the auxiliary switch per NFPA 70 (NEC).

FireLock® Butterfly Valve

SERIES 705
WITH WEATHERPROOF ACTUATOR

WARRANTY

Refer to the Warranty section of the current Price List or contact Victaulic for details.

NOTE

This product shall be manufactured by Victaulic or to Victaulic specifications. All products to be installed in accordance with current Victaulic installation/assembly instructions. Victaulic reserves the right to change product specifications, designs and standard equipment without notice and without incurring obligations.

INSTALLATION

Reference should always be made to the installation sheet included with the valve. Verify you have the latest revision by visiting our website at www.victaulic.com. Further reference can be found in the I-100 Victaulic Field Installation Handbook.

For complete contact information, visit www.victaulic.com

10.81 5662 REV C UPDATED 12/2010

VICTAULIC IS A REGISTERED TRADEMARK OF VICTAULIC COMPANY. © 2010 VICTAULIC COMPANY. ALL RIGHTS RESERVED.

10.81

