

Installation Instructions / Warranty

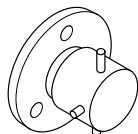

Starck
10930XX1

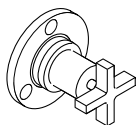

Citterio
39927XX1



Citterio
39931XX1

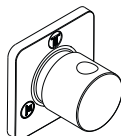

Citterio M
34934XX1

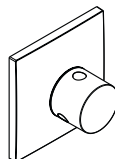

Massaud
18934001

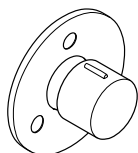

Steel
35930801

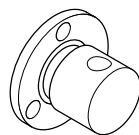

Uno
38934XX1

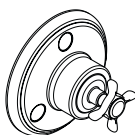

Montreux
16833XX1



Montreux
16832XX1



Terrano
37925XX1

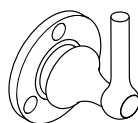

Terrano
37920XX1



Carlton
17925XX0

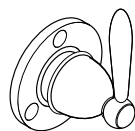

Carlton
17920XX1

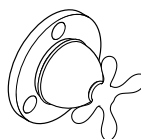

Phoenix
17942XX1



Phoenix
17943XX1

AXOR[®]
hansgrohe

Starck
10930XX1

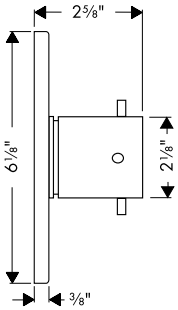

Citterio
39931XX1

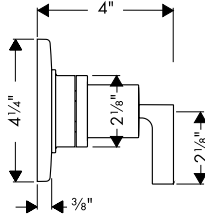

Citterio
39927XX1

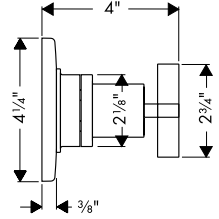

Citterio M
34934XX1

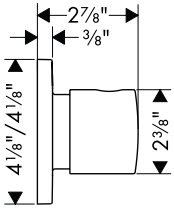

Massaud
18934001

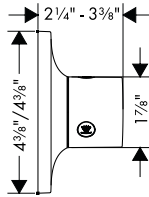

Steel
35930801

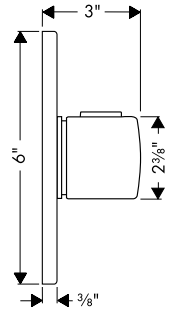

Uno
38934XX1

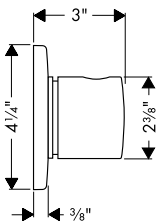

Montreux
16833XX1

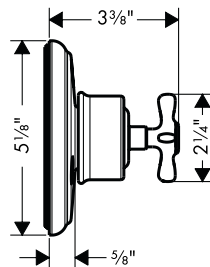

Montreux
16832XX1

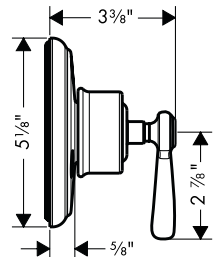

Terrano
37925XX1

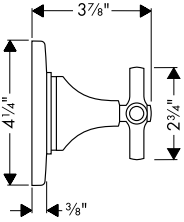

Terrano
37920XX1

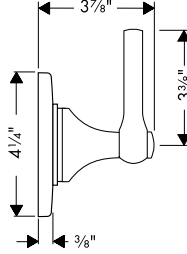

Carlton
17925XX0

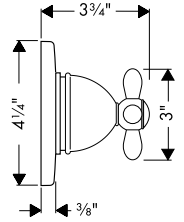

Carlton
17920XX1

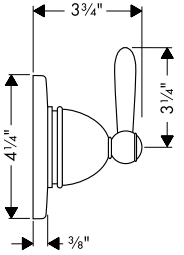

Phoenix
17942XX0

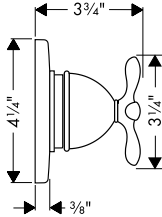

Phoenix
17943XX0

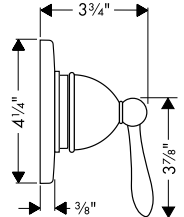

Installation Considerations

- For best results, Hansgrohe recommends that this unit be installed by a licensed, professional plumber.
- Please read over these instructions thoroughly before beginning installation. Make sure that you have all tools and supplies needed to complete the installation.
- This trim kit is for use with Quattro Diverter rough 15930181, Trio Stop Diverter rough 15981181, or Trio Diverter 15984181.
- The rough valve must be installed, and the finished wall completed and made watertight before installation of this trim kit.
- To prevent scald injury, the maximum output temperature of the shower valve must be no higher than 120°F. In Massachusetts, the maximum output temperature of the shower valve can be no higher than 112°F.
- Keep this booklet and the receipt (or other proof of date and place of purchase) for this product in a safe place. The receipt is required should it be necessary to request warranty parts.

À prendre en considération pour l'installation

- Pour de meilleurs résultats, Hansgrohe recommande que ce produit soit installé par un plombier professionnel licencié.
- Ce dispositif requiert une pièce intérieure Quattro 15930181, Trio Stop 15981181, ou Trio 15984181.
- La pièce intérieure doit être installée et la surface murale doit être complètement finie et étanche avant l'installation de ce dispositif.
- Veuillez lire attentivement ces instructions avant de procéder à l'installation. Assurez-vous de disposer de tous les outils et du matériel nécessaires pour l'installation.
- Pour empêcher des blessures par ébullition, la température de sortie maximale du robinet de douche ne doit pas excéder 120°F. Au Massachusetts, la température de sortie maximale du robinet de douche ne doit pas excéder 112°F.
- Conservez ce livret et le reçu (ou une autre preuve sur laquelle figurent la date et l'endroit de l'achat) pour ce produit dans un endroit sûr. Le reçu est requis si vous commandez des pièces sous garantie.

Consideraciones para la instalación

- Para obtener mejores resultados, Hansgrohe recomienda que la instalación de esta unidad esté a cargo de un plomero profesional matriculado.
- Antes de comenzar la instalación, lea estas instrucciones detenidamente. Asegúrese de tener las herramientas y los insumos necesarios para completar la instalación.
- Utilice este dispositivo con pieza interior Quattro 15930181, Trio Stop 15981181, o Trio 15984181.
- La pieza interior debe estar instalada y la superficie mural debe estar completamente acabada y estanco antes de la instalación de este dispositivo.
- Al prevenir escaldar, la temperatura de salida máxima de la válvula de chaparrón no debe ser más alto que 120°F. En Massachusetts: la temperatura de salida máxima de la válvula no puede ser más alto que 112°F.
- Mantenga este folleto y el recibo (u otra prueba de la fecha y el lugar de compra) para este producto en un lugar seguro. El recibo es requerido lo debe es necesario para solicitar partes de garantía.

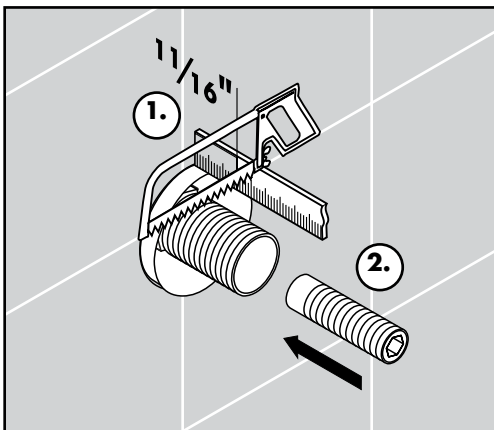
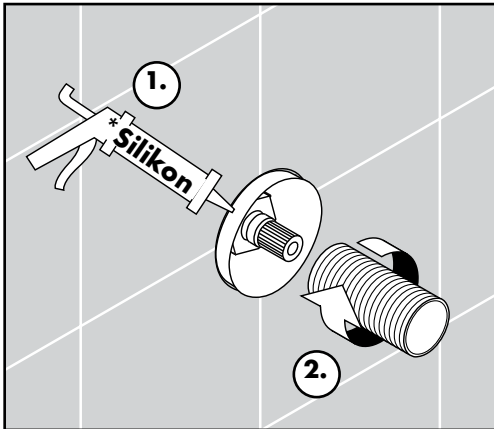
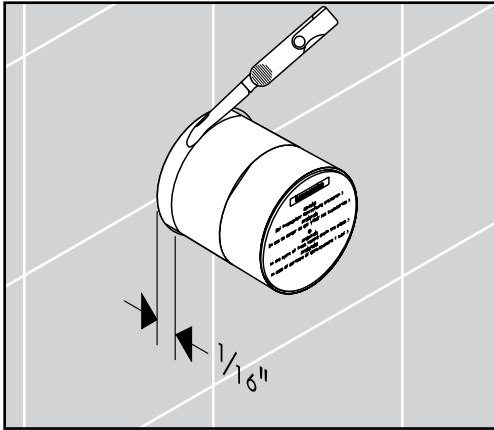

Installation

Cut the plaster shield so that it extends $\frac{1}{16}$ " outside the surface of the finished wall.



Seal the wall around the plaster shield with waterproof sealant (1).



Failure to seal the wall can lead to possible water damage.

Install the slip coupling (2).

Cut the slip coupling so that it extends $1\frac{1}{16}$ " outside the surface of the finished wall (1).

Install the extension spindle (2).

Installation

Coupez le protecteur de façon à ce qu'une partie de $\frac{1}{16}$ po soit à l'extérieur de la surface du mur fini.



Scellez le mur autour du protecteur à l'aide d'un agent d'étanchéité (1).



Si le mur n'est pas scellé, l'eau pourrait éventuellement causer des dommages.

Installez le raccord à glissement (2).

Coupez le raccord à glissement de façon à ce qu'une partie de $\frac{5}{8}$ po soit à l'extérieur de la surface du mur fini (1).

Installez la tige d'extension (2).

Instalación

Corte el protector de yeso de modo que sobresalga $\frac{1}{16}$ " de la superficie de la pared terminada.



Selle la pared alrededor del protector de yeso con un sellador impermeable (1).



Si no se sella la pared, pueden producirse daños por acción del agua.

Instale el acoplamiento deslizante (2).

Corte el acoplamiento deslizante de modo que sobresalga $\frac{5}{8}$ " de la superficie de la pared terminada (1).

Instale el husillo de extensión (2).

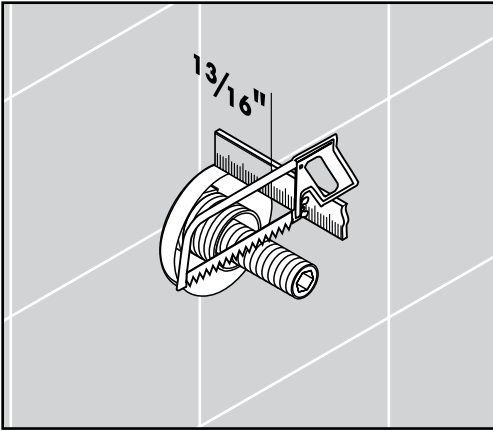

Cut the extension spindle so that it extends $1\frac{3}{16}$ " outside the surface of the finished wall.

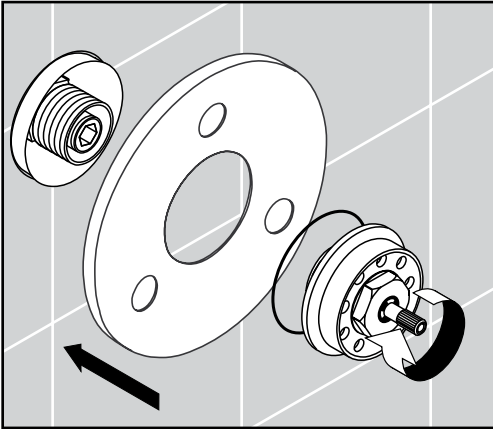

Install the escutcheon.

Install the nut.

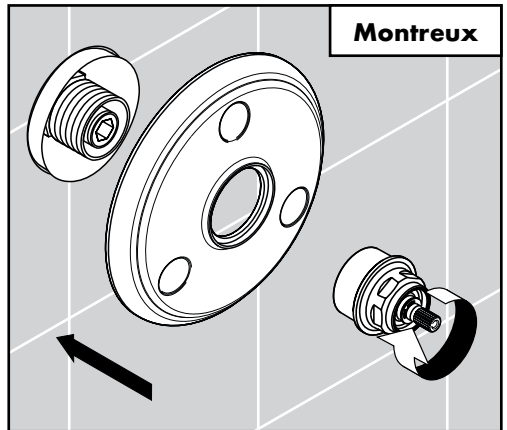
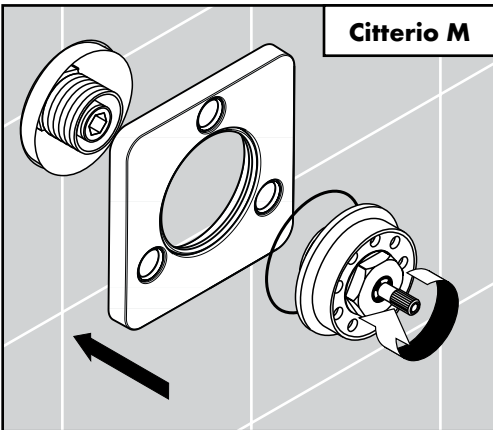

Coupez la tige d'extension de façon à ce qu'une partie de $\frac{3}{4}$ po soit à l'extérieur de la surface du mur fini.

Corte el husillo de extensión de modo que sobresalga $\frac{3}{4}$ " de la superficie de la pared terminada.

Installez l'écusson.

Instale el escudo.

Installez l'écrou.

Instale la tuerca.

Massaud

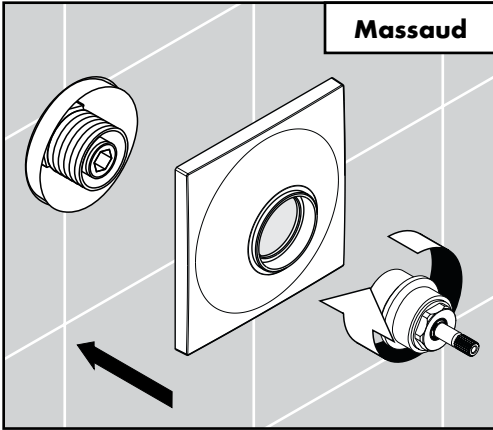

Massaud: Install the nut.

Install the handle

Starck / Montreux / Terrano

Push the handle onto the shaft.

Tighten the screw.

Install the screw cover.

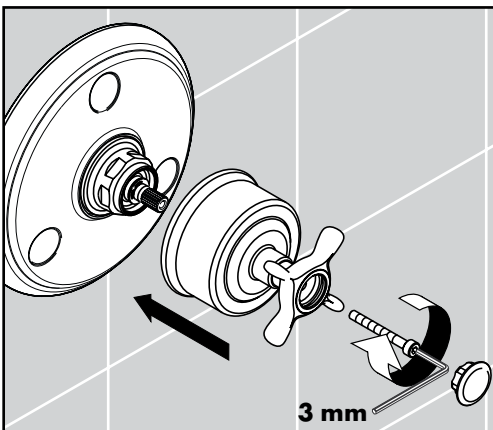
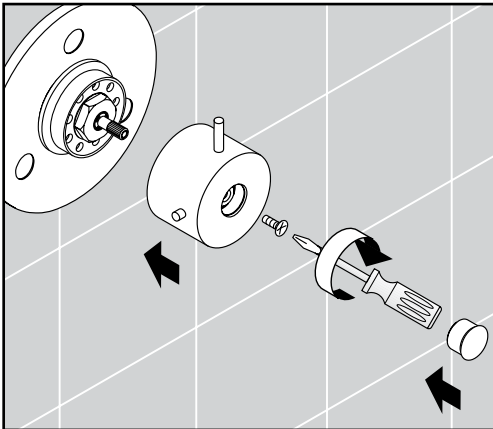

Massaud : Installez l'écrou.

Massaud: Instale la tuerca.

Installation de la poignée

Starck / Montreux / Terrano

Poussez la poignée sur l'arbre.

Serrez la vis.

Installez le cache-vis.

Instale el mando

Starck / Montreux / Terrano

Coloque el mando a presión en el eje.

Apriete el tornillo.

Instale la tapa del tornillo.

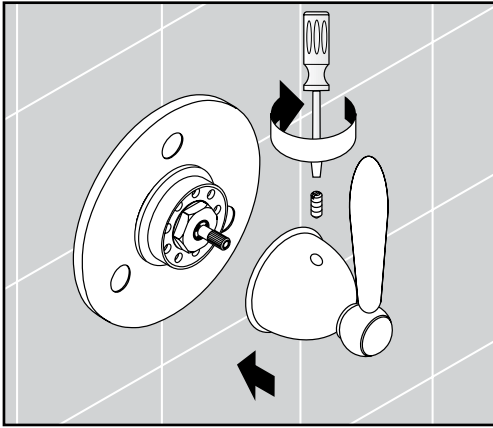

Carlton / Phoenix

Push the handle onto the shaft.

Tighten the screw.

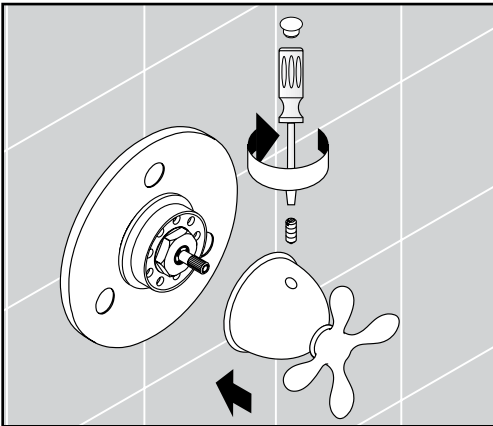

Phoenix: Install the screw cover.

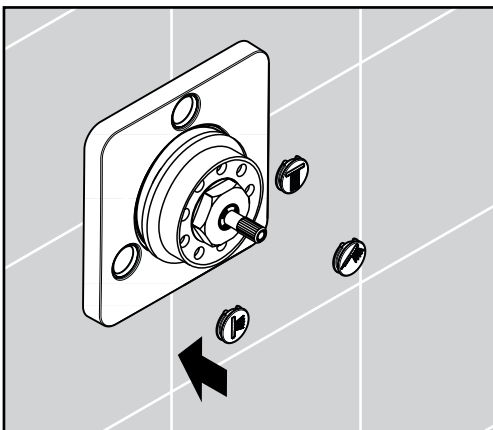

Citterio M: install the icons on the escutcheon.

Carlton / Phoenix

Poussez la poignée sur l'arbre.

Serrez la vis.

Carlton / Phoenix

Coloque el mando a presión en el eje.

Apriete el tornillo.

Phoenix seulement : Installez le cache-vis.

Phoenix únicamente: Instale la tapa del tornillo.

Citterio M : Installez les icônes sur l'écusson.

Citterio M: Instale los iconos en el escudo.

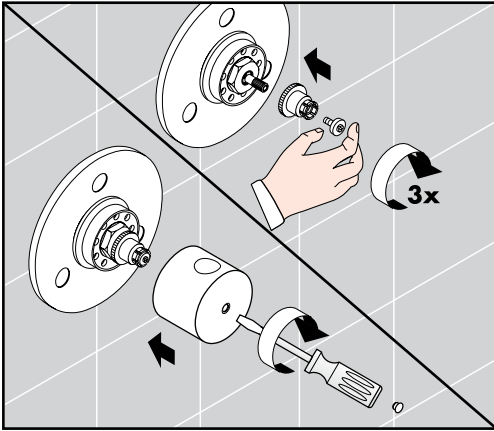

Steel / Citterio M / Uno

Install the snap connector.

Install the screw, but tighten it by hand only three turns.

Push the handle over the snap connector.

Tighten the screw.

Install the screw cover.

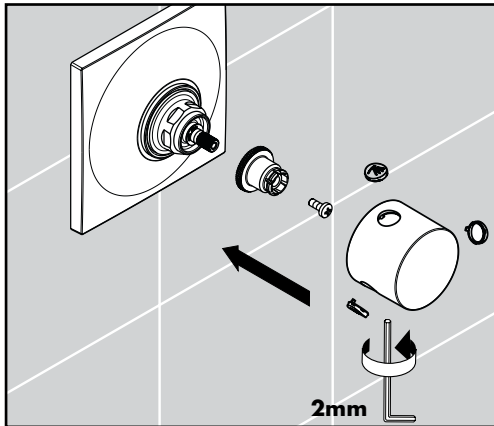

Citterio / Massaud

Install the snap connector.

Tighten the screw.

Install the handle.

Tighten the screw using a 2 mm Allen wrench.

Massaud only: Install the icons on the handle.

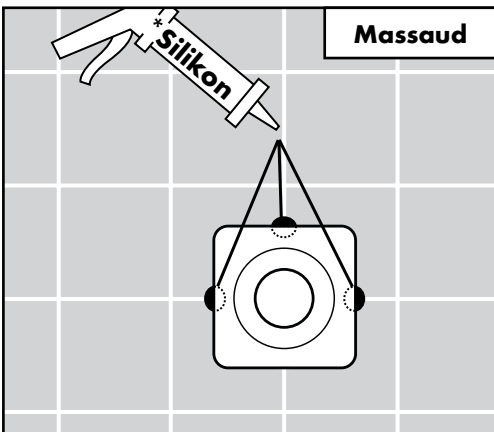

Massaud: Seal the wall at the grout lines using waterproof sealant.

Steel / Citterio M / Uno

Installez le connecteur à encliqueter.

Installez la vis, mais serrez-la à la main en faisant seulement trois tours.

Poussez la poignée sur le connecteur à encliqueter.

Serrez la vis.

Installez le cache-vis.

Citterio / Massaud

Installez le connecteur à encliqueter.

Serrez la vis.

Installez la poignée.

Serrez la vis à l'aide d'une clé hexagonale de 2 mm.

Massaud seulement : Installez les icônes sur la poignée.

Massaud : Scellez le mur sur les lignes des joints à l'aide d'un agent d'étanchéité.

Steel / Citterio M / Uno

Instale el conector a presión.

Instale el tornillo, pero apriételo a mano sólo tres vueltas.

Coloque el mando sobre el conector a presión.

Apriete el tornillo.

Instale la tapa del tornillo.

Citterio / Massaud

Instale el conector a presión.

Apriete el tornillo.

Instale el mando.

Apriete el tornillo con una llave Allen de 2 mm.

Massaud únicamente: Instale los iconos en el mando.

Massaud: Selle la pared en las líneas de lechada de cemento con un sellador impermeable.

Replacement Parts / Pièces détachées / Repuestos

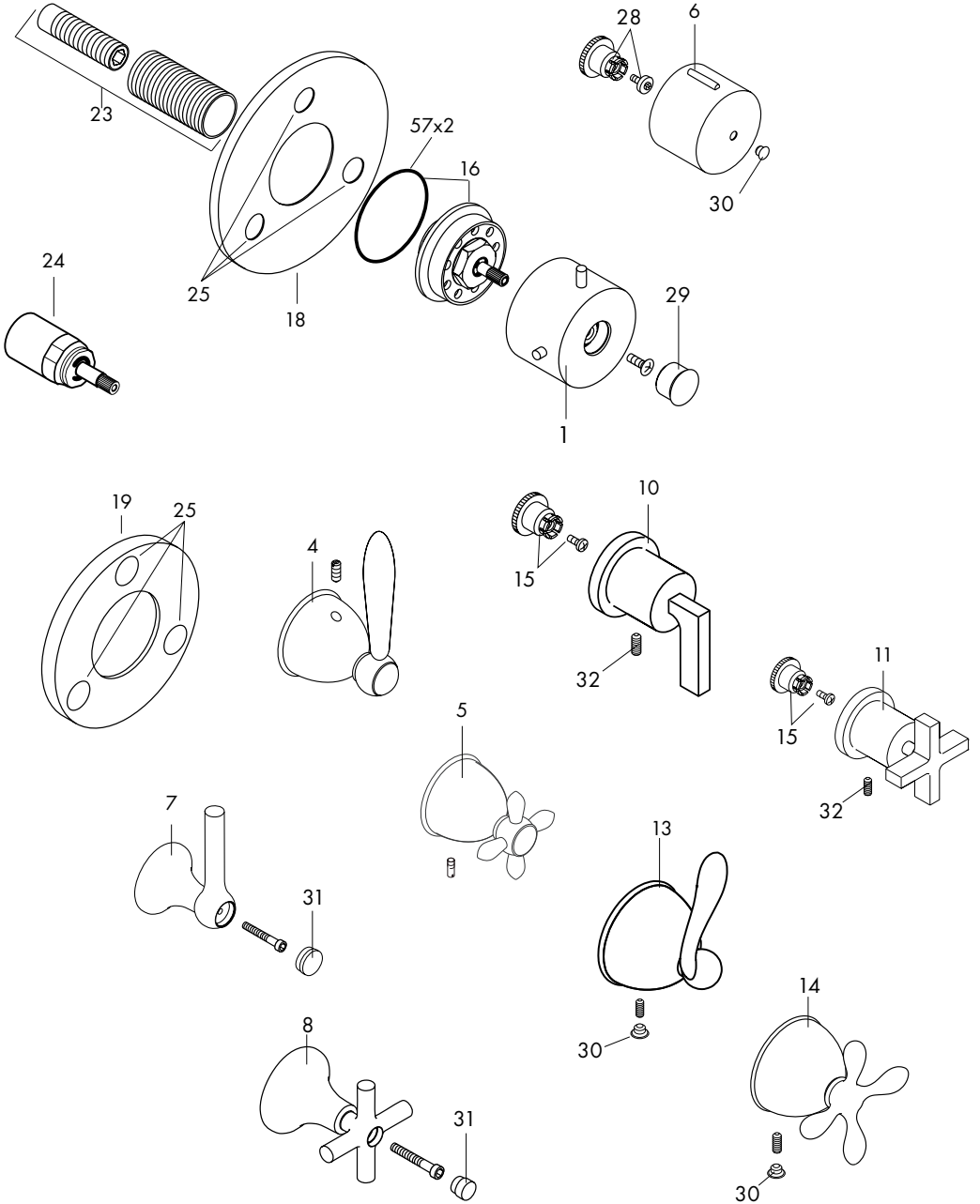

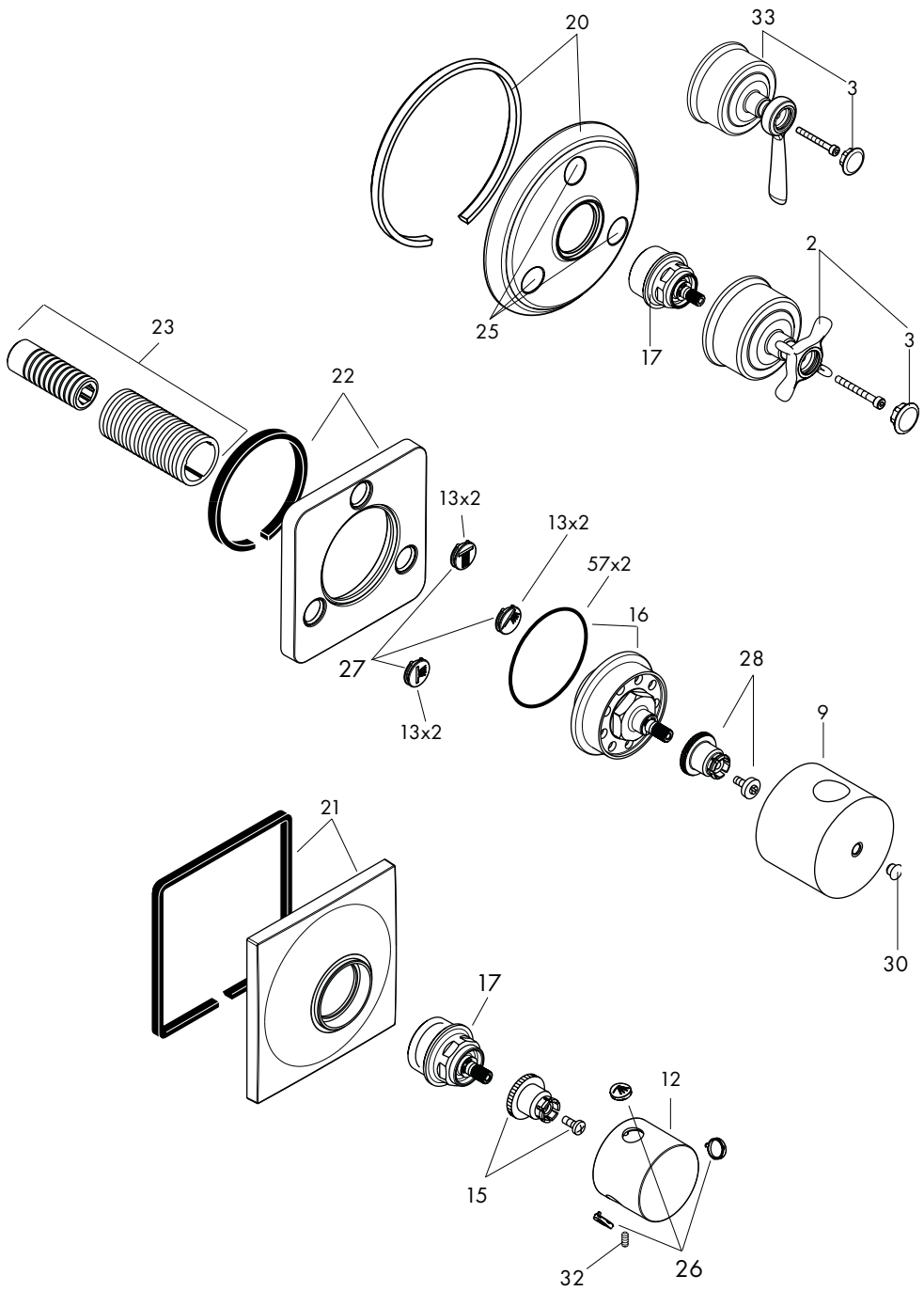

1	Starck handle	poignée Starck	mando Starck	10993XX1
2	Montreux cross handle	poignée croisillon Montreux	mando Montreux	16593XX0
3	screw cover	cache vis	tapón	97987000
4	Carlton lever handle	poignée levier Carlton	mando Carlton	17993XX1
5	Carlton cross handle	poignée croisillon Carlton	mando Carlton	17298XX1
6	Steel handle	poignée Steel	mando Steel	35993XX1
7	Terrano lever handle	poignée levier Terrano	mando Terrano	37993XX1
8	Terrano cross handle	poignée croisillon Terrano	mando Terrano	37995XX1
9	Uno/Citterio M handle	poignée Uno/Citterio M	mando Uno / Citterio M	38993XX1
10	Citterio lever handle	poignée levier Citterio	mando Citterio	39993XX1
11	Citterio cross handle	poignée croisillon Citterio	mando Citterio	39995XX1
12	Massaud handle	poignée Massaud	mando Massaud	18095001
13	Phoenix lever handle	poignée levier Phoenix	mando Phoenix	96632XX1
14	Phoenix cross handle	poignée croisillon Phoenix	mando Phoenix	96792XX1
15	handle fixing set	fixation pour manette	anclaje para mando	94184000
16	Starck/Carlton/Phoenix/ Uno/Steel/ Terrano/Cit- terio/Citterio M nut	écrou Starck/Carlton/ Phoenix/Uno/ Steel/Ter- rano/Citterio/Citterio M	tuerca Starck/Carlton/ Phoenix/Uno/ Steel/Ter- rano/Citterio/Citterio M	96489XX0
17	Montreux/Massaud nut	écrou Montreux/Massaud	tuerca Montreux/ Massaud	98677XX0
18	Starck/Steel escutcheon	rosace Starck/Steel	escudo Starck / Steel	94356XX0
19	Uno/Carlton/Phoenix/ Terrano/Citterio escutcheon	rosace Uno/Carlton/ Phoenix/Terrano/Citterio	escudo Uno/Carlton/ Phoenix/Terrano/Citterio	13936XX0
20	Montreux escutcheon	rosace Montreux	escudo Montreux	98669XX0
21	Massaud escutcheon	rosace Massaud	escudo Massaud	98676000
22	Citterio M escutcheon	rosace Citterio M	escudo Citterio M	98963XX0
23	fixing set	fixation	set de fijación	96392000
24	1" extension set	rallonge 25 mm	prolongación	96370000
25	icon stickers	symboles autocollants	indicador adhesivo	97218XX0
26	Massaud icons	symboles Massaud	indicador Massaud	95237000
27	Citterio M icons	symboles Citterio M	indicador Citterio M	95238000
28	handle fixing set	fixation pour manette	anclaje para mando	94184001
29	Starck screw cover	cache vis Starck	tapón Starck	96540XX1

30	Steel/Uno/Phoenix screw cover	cache vis Steel/Uno/ Phoenix	tapón Steel/Uno/Phoenix	96541001
31	Terrano screw cover set	cache vis Terrano	tapón Terrano	96542XX0
32	M4x10 handle screw	vis M4x10	tornillo M4x10	97667000
33	Montreux lever handle	poignée levier Montreux	mando Montreux	16693XX0

Cleaning Recommendation for Hansgrohe Products

Modern lavatory faucets, kitchen faucets, and showers consist of very different materials to comply with the needs of the market with regard to design and functionality. To avoid damage and returns, it is necessary to consider certain criteria when cleaning.

Cleaning Materials for Faucets and Showers

Acids are a necessary ingredient of cleaning materials for removing lime, however please pay attention to the following points when cleaning faucets and showers:

- Only use cleaning materials which are explicitly intended for this type of application.
- Never use cleaning materials which contain hydrochloric, formic, phosphoric, or acetic acid, as they cause considerable damage.
- Never mix one cleaning material with another.
- Never use cleaning materials or appliances with an abrasive effect, such as unsuitable cleaning powders, sponge pads, or micro fiber cloths.

Cleaning Instructions for Faucets and Showers

Please follow the cleaning material manufacturer's instructions. In addition, pay attention to the following points:

- Clean the faucets and showers as and when required
- Use the amount of cleaning product and the amount of time recommended by the manufacturer. Do not leave the cleaner on the fixture longer than necessary.
- Regular cleaning can prevent calcification.
- When using spray cleaners, spray first onto a soft cloth or sponge. Never spray directly onto the faucet as droplets can enter openings and gaps and cause damage.
- After cleaning, rinse thoroughly with clean water to remove any cleaner residue.

Important

Residues of liquid soaps, shampoos, and shower foams can also cause damage, so rinse with clean water after using.

Please note: if the surface is already damaged, the effect of cleaning materials will cause further damage.

Components with damaged surfaces must be replaced or injury could result.

Damage caused by improper treatment is not covered under the warranty.

Recommandations pour le nettoyage des produits Hansgrohe

Les robinetteries modernes de lavabo, de cuisine et de douche utilisent des matériaux très différents pour répondre aux besoins du marché en termes de conception et de fonctionnalité. Certaines règles de base doivent être respectées lors du nettoyage de ces produits afin d'éviter de les endommager ou d'avoir à les retourner.

Produits de nettoyage pour robinetteries et douches

Les acides sont une partie intégrante nécessaire de tous les produits de détartrage; il faut cependant prendre les précautions suivantes lors du nettoyage des robinets et des douches :

- N'utilisez que des produits/articles de nettoyage conçus spécifiquement pour les articles de robinetterie et de douche.
- N'utilisez jamais de produits/articles de nettoyage contenant de l'acide chlorhydrique, formique, phosphorique ou acétique car ils pourraient causer des dommages considérables.
- Ne mélangez jamais deux produits de nettoyage.
- N'utilisez jamais de produits/articles de nettoyage de nature abrasive tels que poudres de nettoyage, tampons-éponge ou chiffons microfibre non appropriés.

Instructions de nettoyage pour robinetteries et douches

Veuillez suivre les instructions du fabricant de produits/articles de nettoyage. De plus, tenez compte des conseils suivants :

Nettoyez vos produits de robinetterie et de douche aussi souvent que nécessaire.

- Utilisez la quantité de produit nettoyant et respectez la durée recommandée par le fabricant. Ne laissez pas le produit sur les articles de robinetterie plus longtemps que nécessaire.
- Un nettoyage régulier peut prévenir la formation de dépôts calcaires.
- Si vous utilisez des nettoyeurs en vaporisateur, vaporisez d'abord sur une éponge ou un chiffon. Ne vaporisez jamais directement sur un robinet : des gouttelettes pourraient s'infiltrer dans les ouvertures et les interstices et endommager celui-ci.
- Après le nettoyage, rincez abondamment avec de l'eau propre pour éliminer tout résidu de produit nettoyant.

Important

Les résidus de savon liquide, de shampooing et de mousse pour la douche peuvent également endommager la robinetterie; rincez donc avec de l'eau propre après utilisation de ces produits.

Veillez noter : si la surface est déjà endommagée, les produits de nettoyage l'endommageront encore plus.

Les composants dont la surface est endommagée devraient être remplacés sous peine d'entraîner des blessures.

Les dommages dus à un mauvais traitement ne sont pas couverts par la garantie.

Recomendación de limpieza para los productos de Hansgrohe

Hoy en día, las griferías de baño y de cocina así como duchas modernas se componen de materiales muy distintos para satisfacer las exigencias del mercado respecto al diseño y la funcionalidad.

Para evitar daños y reclamaciones hay que tener en cuenta ciertos aspectos tanto en el uso como en su limpieza posterior.

Para el cuidado de las griferías y las duchas en principio hay que seguir lo siguiente:

- Usar sólo detergentes previstos específicamente para este campo de aplicación.
- No aplicar detergentes que contengan hipoclorito sódico, ácido clorhídrico, fórmico o acético porque pueden causar daños importantes.
- Detergentes que contienen ácido fosfórico tampoco pueden ser aplicados ilimitadamente.
- Por regla general no se deben mezclar detergentes.
- Tampoco se deben utilizar utensilios abrasivos, como son polvos abrasivos, esponjas o paños de microfibra.

Se tienen que seguir siempre las instrucciones de uso de los fabricantes de los detergentes.

- La limpieza tiene que ser realizada según la dosificación y el tiempo de actuación, en función del objeto y ajustada a las necesidades específicas del mismo.
- Gracias a una limpieza periódica se pueden evitar las incrustaciones de cal.
- No conviene rociar el detergente en ningún caso sobre la grifería sino sobre los textiles y ejecutar la limpieza así, porque el líquido puede entrar en aperturas o hendiduras de la grifería y causar daños.
- Después de la limpieza hay que aclarar con suficiente agua para eliminar completamente el resto de detergente.
- La utilización de limpiadores a vapor no está permitida, las altas temperaturas pueden dañar los productos.

Indicaciones importantes

Los residuos de productos de aseo como jabón líquido, champús y gel de ducha pueden dañar también los materiales.

Por lo que también se deberá prestar atención a lo siguiente: aclarar con abundante agua después del uso.

Con materiales ya dañados la acción de detergentes incrementará el desgaste de estos.

Los componentes con superficies dañadas deberán cambiarse, en otro caso se corre el peligro de lesionarse.

Los daños que resulten de un uso inadecuado no están incluidos en nuestra garantía.

Limited Lifetime Consumer Warranty

This product has been manufactured and tested to the highest quality standards by Hansgrohe, Inc. ("Hansgrohe"). This warranty is limited to Hansgrohe products which are purchased by a consumer in the United States after March 1, 1996, and installed in either the United States or Canada.

WHO IS COVERED BY THE WARRANTY

This warranty extends to the original consumer purchaser only. This warranty is non-transferable.

WHAT IS COVERED BY THE WARRANTY

This warranty covers only your Hansgrohe manufactured product. Hansgrohe warrants this product against defects in material or workmanship as follows: Hansgrohe will repair at no charge for parts only or, at its option, replace any product or part of the product that proves defective because of improper workmanship and/or material, under normal installation, use, service and maintenance. If Hansgrohe is unable to provide a replacement and repair is not practical or cannot be timely made, Hansgrohe may elect to refund the purchase price in exchange for the return of the product.

LENGTH OF WARRANTY

Replacement or repaired parts of products will be covered for the term of this warranty as stated in the following two sentences. If you are a consumer who purchased the product for use primarily for personal, family, or household purposes, this warranty extends for as long as you own the product and the home in which the product is originally installed. If you purchased the product for use primarily for any other purpose, including, without limitation, a commercial purpose, this warranty extends only (i) for 1 year, with respect to Hansgrohe and Commercial products, and (ii) for 5 years, with respect to AXOR products.

THIS WARRANTY DOES NOT COVER, AND HANSGROHE WILL NOT PAY FOR:

- A. Conditions, malfunctions or damage not resulting from defects in material or workmanship.
- B. Conditions, malfunctions or damage resulting from (1) normal wear and tear, improper installation, improper maintenance, misuse, abuse, negligence, accident or alteration, or (2) the use of abrasive or caustic cleaning agents or "no-rinse" cleaning products, or the use of the product in any manner contrary to the product instructions. (3) Conditions in the home such as excessive water pressure or corrosion.
- C. Labor or other expenses for the disconnection, deinstallation, or return of the product for warranty service, or for installation or reinstallation of the product (including but not limited to proper packaging and shipping costs), or for installation or reinstallation of the product.
- D. Accessories, connected materials and products, or related products not manufactured by Hansgrohe.

TO OBTAIN WARRANTY PARTS OR INFORMATION

Contact your Hansgrohe retailer, or contact Technical Service at:

Hansgrohe Inc.
1492 Bluegrass Lakes Parkway
Alpharetta GA 30004
Toll-free (800) 334-0455.

In requesting warranty service, you will need to provide

1. The sales receipt or other evidence of the date and place of purchase.
2. A description of the problem.
3. Delivery of the product or the defective part, postage prepaid and carefully packed and insured, to Hansgrohe Inc. 1492 Bluegrass Lakes Parkway, Alpharetta, Georgia 30004, Attention: Technical Service, if required by Hansgrohe.

When warranty service is completed, any repaired or replacement product or part will be returned to you postage prepaid.

EXCLUSIONS AND LIMITATIONS

REPAIR OR REPLACEMENT (OR, IN LIMITED CIRCUMSTANCES, REFUND OF THE PURCHASE PRICE) AS PROVIDED UNDER THIS WARRANTY IS THE EXCLUSIVE REMEDY OF THE PURCHASER. HANSGROHE NEITHER ASSUMES NOR AUTHORIZES ANY PERSON TO CREATE FOR IT ANY OBLIGATION OR LIABILITY IN CONNECTION WITH THIS PRODUCT.

HANSGROHE SHALL NOT BE LIABLE TO PURCHASER OR ANY PERSON FOR ANY INCIDENTAL, SPECIAL, OR CONSEQUENTIAL DAMAGES, ARISING OUT OF BREACH OF THIS WARRANTY OR ANY IMPLIED WARRANTY (INCLUDING MERCHANTABILITY).

Some States do not allow the exclusion or limitation of incidental or consequential damages, so the above limitation or exclusion may not apply to you. This warranty gives you specific legal rights, and you may have other rights which vary from State to State. You may be required

by law to give us a reasonable opportunity to correct or cure any failure to comply before you can bring any action in court against us under the Magnuson-Moss Warranty Act.

PRODUCT INSTRUCTIONS AND QUESTIONS

Upon purchase or prior to installation, please carefully inspect your Hansgrohe product for any damage or visible defect. Prior to installing, always carefully study the enclosed instructions on the proper installation and the care and maintenance of the product. If you have questions at any time about the use, installation, or performance of your Hansgrohe product, or this warranty, please call or write to us or call us toll-free at 800 334 0455.

hansgrohe

Hansgrohe, Inc. • 1490 Bluegrass Lakes Parkway • Alpharetta, GA 30004
Tel. 770-360-9880 • Fax 770-360-9887

www.hansgrohe-usa.com