

STEP 1:

Insert the appropriate nut driver into a $\frac{3}{8}$ " or $\frac{1}{2}$ " portable drill.

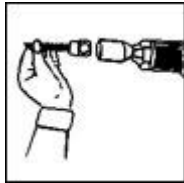

STEP 2:

Insert the **SAMMYS** into the #14SW (red) nut driver. With drill unit in a horizontal position and at a right angle to the structural member, begin installation.

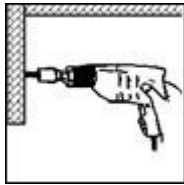

STEP 3:

When the nut driver spins free on the **SAMMYS**, stop the drill and remove.

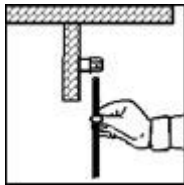

STEP 4:

The unit is now ready to receive $\frac{1}{4}$ ", $\frac{3}{8}$ " or metric all thread rod or bolt stock.

Note: When installing SWDR, follow the above instructions, add retainer nut and torque until fully seated against purlin (~ 20 in-lbs.).

Important Note: Warranty requires the use of the appropriate Sammy Nut Driver for installations.