

INSTALLATION INSTRUCTIONS

Lyndon™ Deck Mount Tub Filler with Hand Shower

Model D35109900



AMERICAN STANDARD

Thank you for selecting DXV by American Standard.
To ensure that your installation proceeds smoothly,
please read these instructions carefully
before you begin.

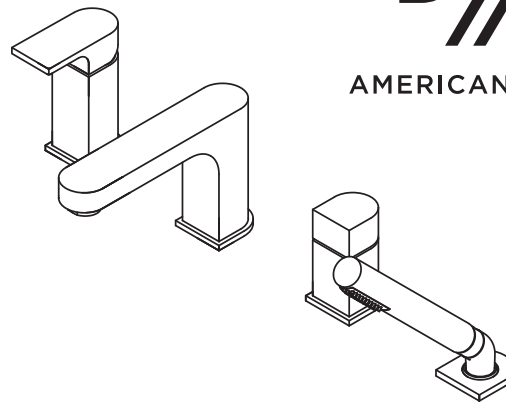

RECOMMENDED TOOLS AND MATERIALS

Most of the procedures require the use of common tools and materials, which are available from hardware and plumbing, supply stores. It is essential that the tools and materials be on hand before work is begun.



Channel Locks



Adjustable Wrench

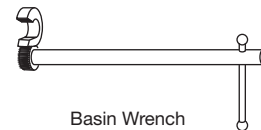

Basin Wrench

ROUGHING-IN DIMENSIONS:

- For reference

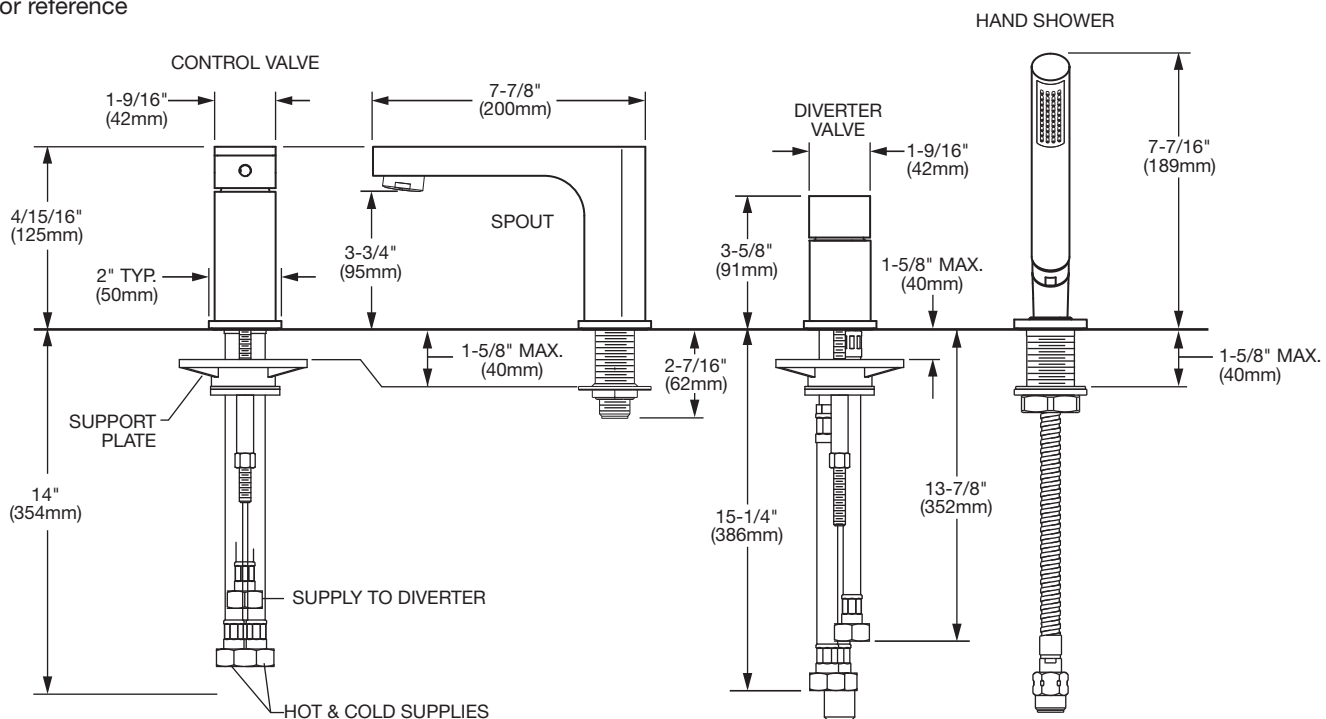

In the United States:

DXV by American Standard
One Centennial Avenue
Piscataway, New Jersey 08855
Attention: Director of Customer Care

For residents of the United States, warranty information may also be obtained by calling the following toll free number: (800) 227-2734
www.DXV.com

In Canada:

DXV by American Standard
5900 Avebury Road
Mississauga, Ontario
L5R 3M3
Canada

Toll Free: 1-800-387-0369
Local: 905-306-1093
Fax: 1-800-395-1498
www.DXV.ca

In Mexico:

DXV by American Standard
Via Morelos 330
Col. Santa Clara Coatitla
Ecatepec, Estado de México 55540

Toll Free: 01-800-8391200
www.DXV.mx

SAVE FOR FUTURE USE

1 INSTALL CONTROL VALVE

CAUTION

Turn off hot and cold water supplies before beginning.

IMPORTANT NOTICE TO THE INSTALLER!

Please check with your local Code Authority for acceptable installation requirements for this Tub Filler set with hand shower. Some local codes may require a vacuum breaker and/or a pressure balanced mixing valve to be installed in conjunction with this product.

- Seat SEAL (1) into under side of FAUCET BASE (2). Fig. A.
- Feed FAUCET SUPPLIES (3), MOUNTING STUD (4) and DIVERTER HOSE (5) through the mounting hole. Fig. A.
- From below, install SUPPORT PLATE (6), GASKET with RETAINING WASHER (7) onto MOUNTING STUD (4). Install MOUNTING NUT (8) onto MOUNTING STUD (4). Fig. B.
- Adjust Faucet so that it is centered. Tighten MOUNTING NUT (8) to complete faucet mounting. Fig. B.

Fig. B.

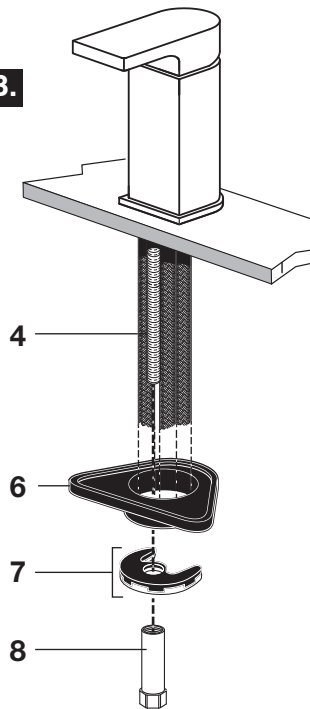
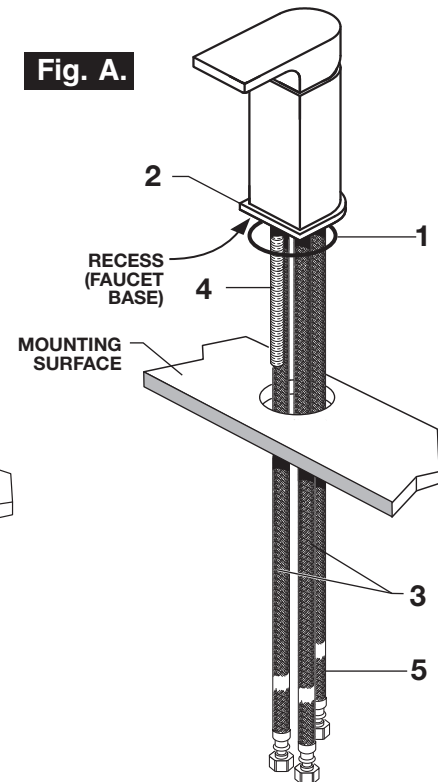
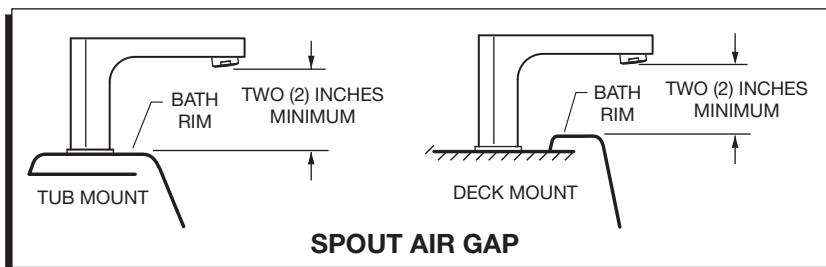
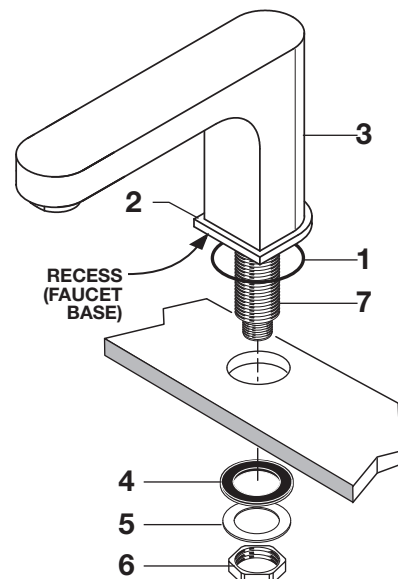

Fig. A.



2 INSTALL SPOUT

- Seat SEAL (1) into under side of SPOUT BASE (2).
- Install SPOUT (3) into mounting hole.
- From below, install RUBBER GASKET (4) METAL WASHER (5) and MOUNTING NUT (6) onto SPOUT SHANK (7).
- Adjust SPOUT (3) so that it is centered. Tighten MOUNTING NUT (6) to complete spout mounting.



3 INSTALL CONTROL VALVE

- Seat SEAL (1) into under side recess in FAUCET BASE (2). **Fig. A.**
- Feed three HOSES (4), and MOUNTING STUD (3) through the mounting hole. **Fig. A.**
- From below, install SUPPORT PLATE (5), GASKET with RETAINING WASHER (6) onto MOUNTING STUD (3). Install MOUNTING NUT (7) onto MOUNTING STUD (3) **Fig. B.**
- Adjust diverter so that it is centered. Tighten MOUNTING NUT (7) to complete diverter mounting. **Fig. B.**

Fig. A.

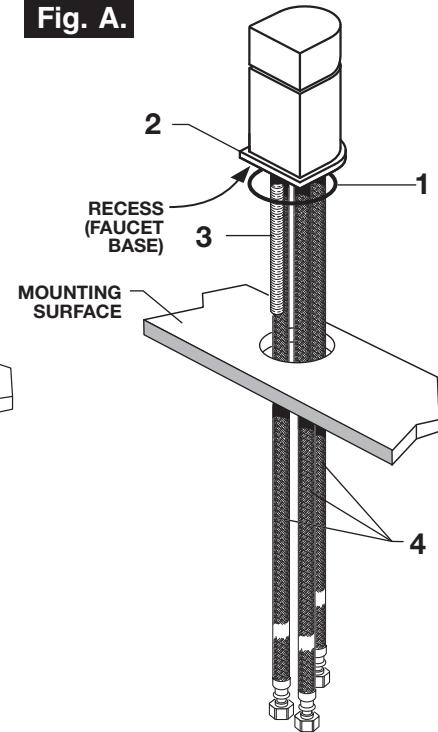
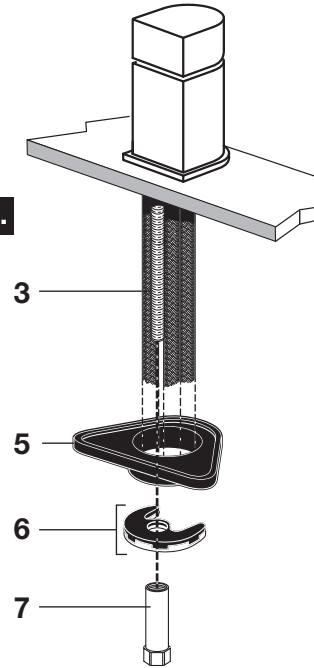
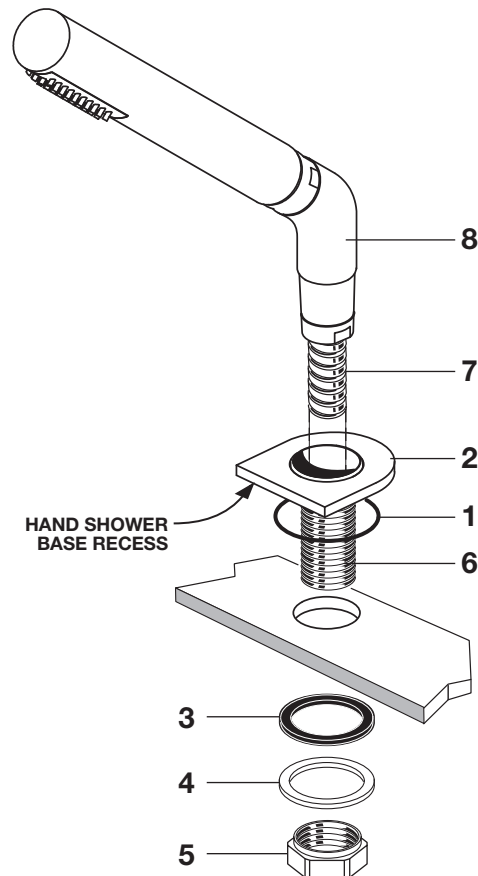

Fig. B.



4 INSTALL HAND SHOWER

- Seat SEAL (1) into HAND SHOWER BASE (2) recess.
- Install HAND SHOWER HOLDER (2) into mounting hole.
- From below, install GASKET (3), METAL WASHER (4) and MOUNTING NUT (5) onto SHOWER HOLDER SHANK (6).
- Adjust HAND SHOWER HOLDER (2) so that it is centered. Tighten MOUNTING NUT (5) to complete holder mounting.
- Feed SHOWER HOSE (7) through HAND SHOWER HOLDER (2) and seat HAND SHOWER (8) into holder.



5 MAKE ALL HOSE CONNECTIONS

- Connect the CONTROL VALVE HOSE (A) and DIVERTER VALVE HOSE (A) to the 1/2" CONNECTING NIPPLE (1). Use FIBER SEAL WASHERS (2).
- Connect DIVERTER VALVE HOSE (C) to SPOUT CONNECTION (3). Use FIBER SEAL WASHER (2).
- Connect DIVERTER VALVE HOSE (B) to HAND SPRAY CONNECTOR (6). Use small FIBER SEAL WASHER (2).
- Connect HAND SHOWER (B) to HAND SPRAY CONNECTION (4). Use FIBER SEAL WASHER (5).
- Connect HOT and COLD HOSES to water supplies.

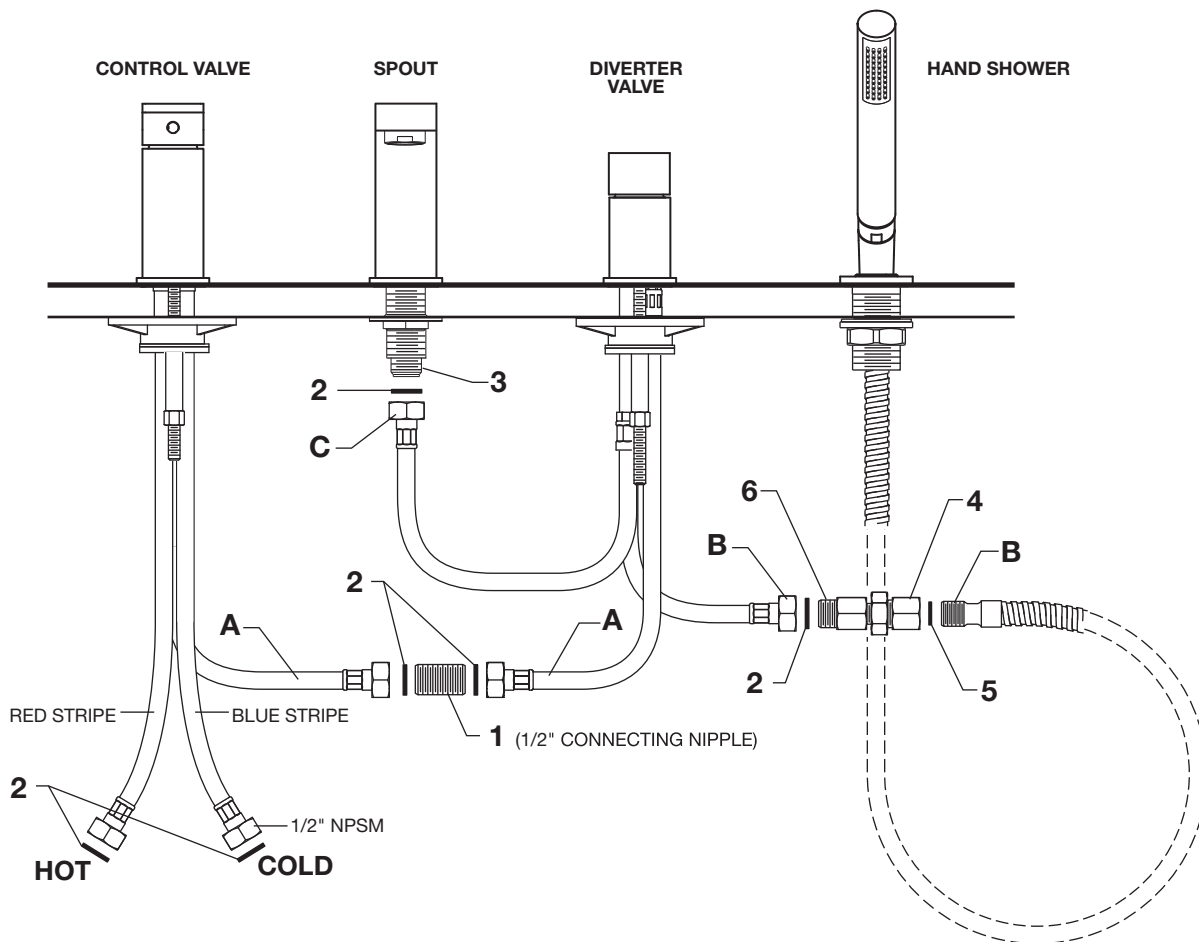

6 CHECK CONNECTIONS FOR LEAKS

- Move Handle down to "off" position.
- Turn on water supplies and check for leaks. ➡
- Turn on control and diverter valve and check all connections for leaks. ➡ Tighten connections if needed.

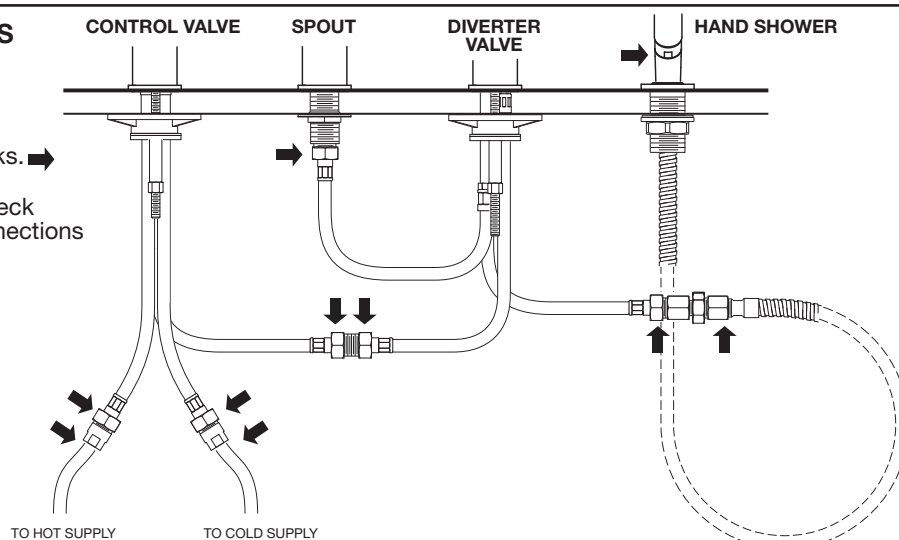

7 TEST INSTALLED BATH FAUCET

- Move HANDLE (1) down into "off" position.
- Remove STREAM STRAIGHTENER (2).
- Turn DIVERTER VALVE to "Spout". Operate HANDLE (1) up and down, in COLD and HOT positions, to flush water lines thoroughly.
- Replace AERATOR (2).
- Turn DIVERTER VALVE to "Hand Shower". With HANDLE (1) down in "off" position, pull HAND SPRAY (3) from holder and direct SPRAY END (3) into bath. Operate HANDLE (1) up and down, in COLD and HOT positions to check SPRAY operation.

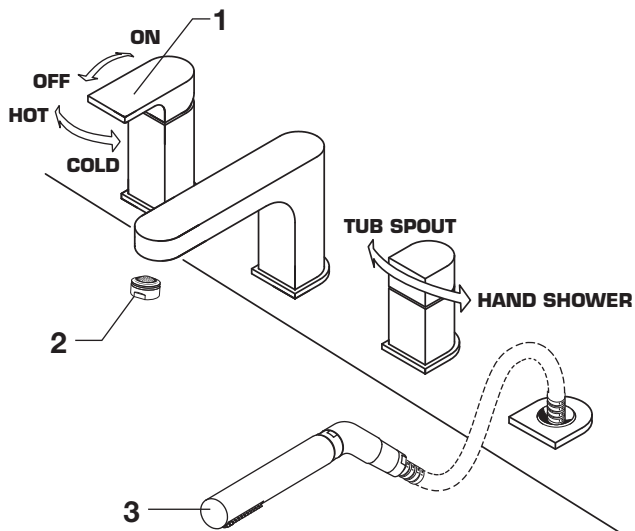

8 SERVICE

CAUTION

Turn off hot and cold water supplies before beginning.

- To remove or replace cartridge: (Control and Diverter Valves)
 - Turn valve to OFF position.
 - Pull out PLUG BUTTON (1) and loosen HANDLE SCREW (2).
 - Pull off HANDLE (3).
 - Unthread and remove CARTRIDGE NUT (4) with CARTRIDGE RING NUT KEY (7).
 - Pull out CARTRIDGE (5).
 - Inspect CARTRIDGE (5) and O-RINGS (6) for debris and clean if necessary.
 - Clean MANIFOLD (8) and rinse clean.
 - Reinstall CARTRIDGE (5) and O-RINGS (6) onto MANIFOLD (8).
 - Reinstall CARTRIDGE NUT (4) and HANDLE ASSEMBLY (3).
- If spout drips, operate handle several times from OFF to ON and HOT to COLD position. Do not force handle.

Low water flow from faucet:

- Remove STREAM STRAIGHTENER (9) and clean if necessary.

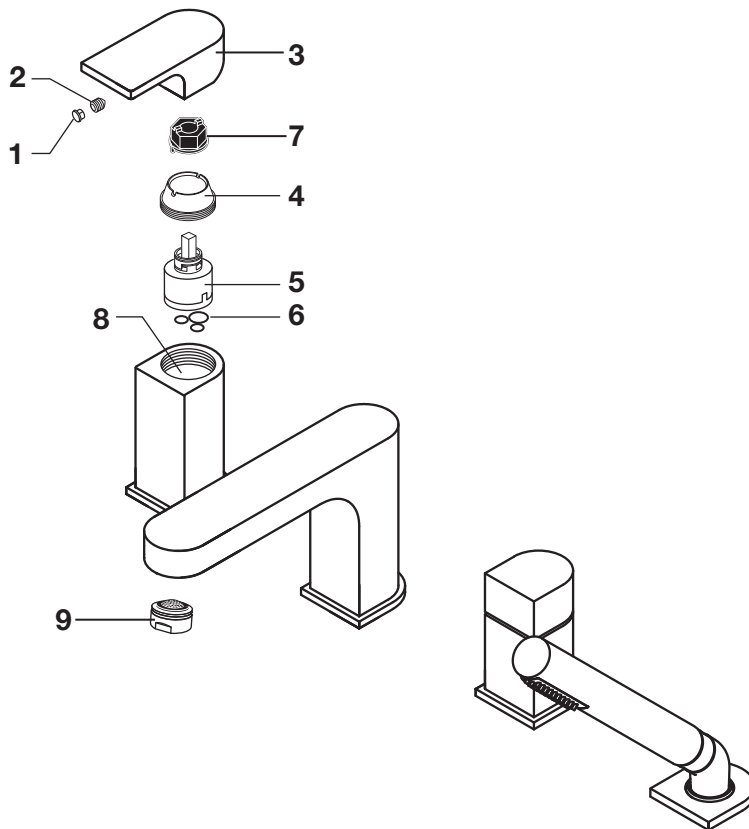



AMERICAN STANDARD

Lyndon™ Deck Mount Tub Filler with Hand Shower

MODEL NUMBER

D35109900

Replace the "YYY" with
appropriate finish code

POLISHED CHROME	100
BRUSHED NICKEL	144

