

### MODEL NUMBERS

605X.102 605X.104 605X.105  
605X.163 605X.164 605X.165

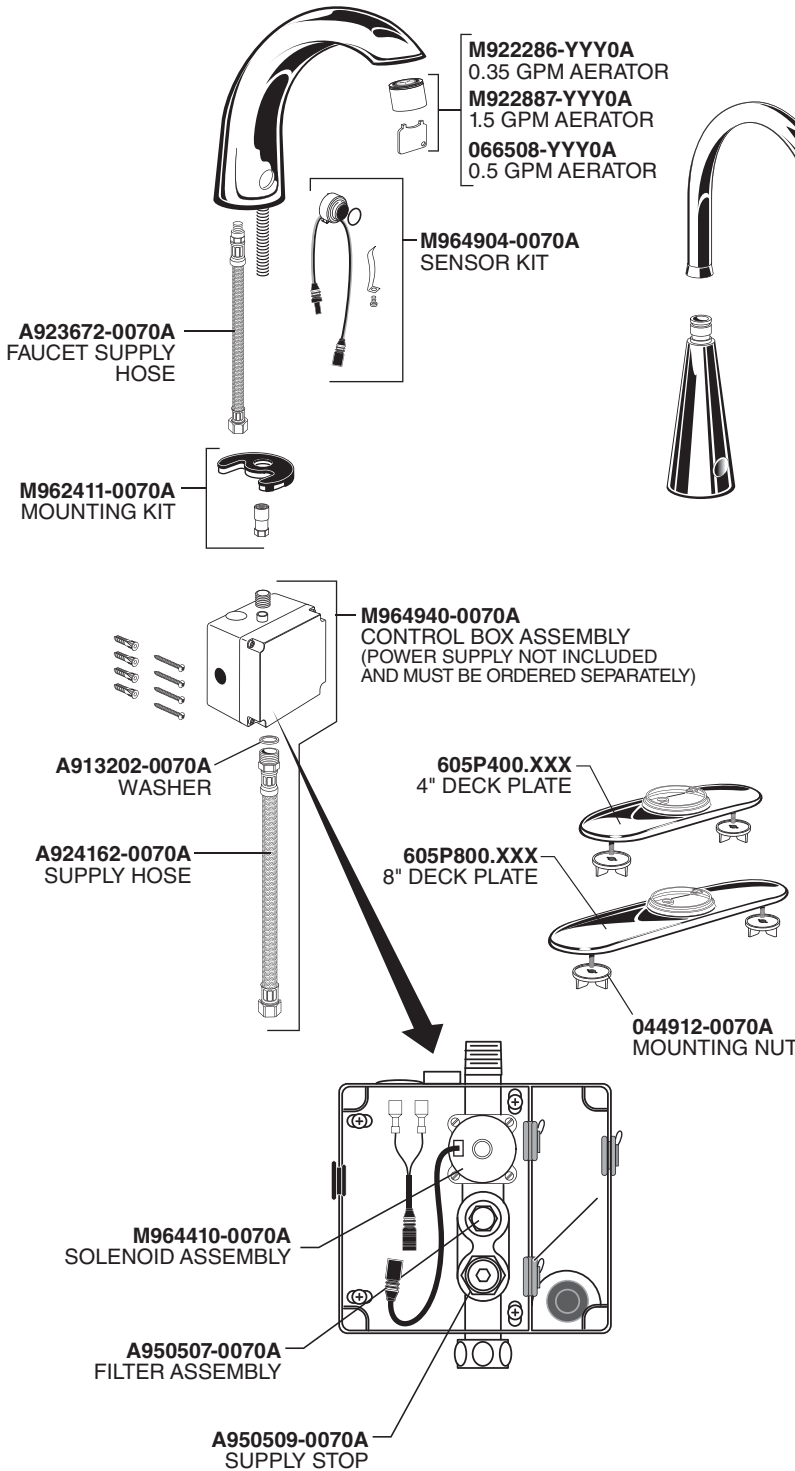

### DC Long Life Power Pack

6053.193

**M950510-0070A**  
27" EXTENSION CABLE

**M950361-0070A**  
LONG LIFE BATTERY

### DC Standard Battery

6053.193

**M950510-0070A**  
27" EXTENSION CABLE

**M950514-0070A**  
BATTERY HOLDER

**A923654-0070A**  
BATTERY 6V CR-P2

### AC Plug-in

6056.193

**M950510-0070A**  
27" EXTENSION CABLE

**M950338-0070A**  
POWER SUPPLY

### AC Hardwire

6059.193

**M950510-0070A**  
27" EXTENSION CABLE

**M950511-0070A**  
10' EXTENSION

**M950520-0070A**  
POWER SUPPLY

**M950512-0070A**  
Y-ADAPTER

### AC Multi

6057.193

**M950510-0070A**  
27" EXTENSION CABLE

**M950511-0070A**  
10' EXTENSION

**M950512-0070A**  
Y-ADAPTER



**HOT LINE FOR HELP**  
For toll-free information and answers to your questions, call:

(844) CRT-TEAM / (844) 278-8326

Mon. - Fri. 8:00 a.m. to 8:00 p.m. EST Saturday 10:00 a.m. to 4:00 p.m. EST  
IN MEXICO 01-800-839-1200

IN CANADA 1-800-387-0369 (TORONTO 1-905-306-1093)  
Weekdays 8:00 a.m. to 7:00 p.m. EST

Product names listed herein are trademarks of AS America, Inc. ©2015

To learn more about American Standard Selectronic® Products visit our website at:  
[www.americanstandard-us.com](http://www.americanstandard-us.com) or e-mail us at: [CRTTEAM@americanstandard.com](mailto:CRTTEAM@americanstandard.com)

Appropriate finish code

CHROME

002