

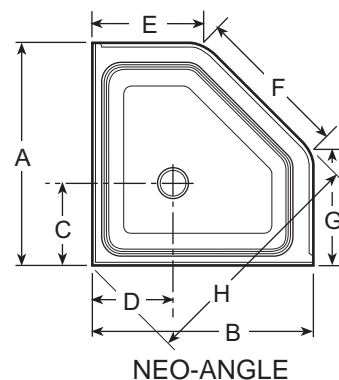

SHOWER BASE INSTALLATION INSTRUCTIONS

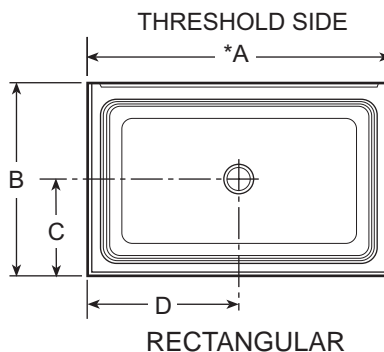
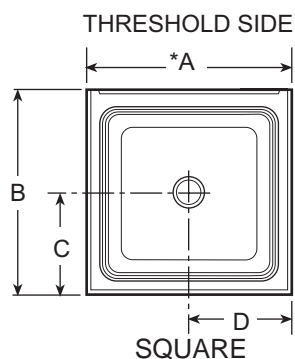

* Add 1/8" for rough-in dimensions.

PRODUCT CHART (TRU-LEVEL™)

	PRODUCT NO.	MODEL NAME	DIMENSIONS								PRODUCT WEIGHT
			A	B	C	D	E	F	G	H	
SQUARE	S344000	3636S	36	36	17.5	18.0					24 lb
	S364000	4848S	48	48	23.25	24.0					43 lb
	S348000	4242S	42	42	20.25	21.0					34 lb
RECTANGULAR	S356000	4834S	48	34	16.5	24.0					30 lb
	S368000	6036S	60	36	17.5	30.0					43 lb
	T366000	4248S	42	48	23.25	21.0					38 lb
	T362000	4236S	42	36	17.5	21.0					28 lb
	T370000	6042S	60	42	20.25	30.0					50 lb
	T354000	3642S	36	42	20.25	18.0					28 lb
	T374000	4832S	48	32	15.0	24.0					29 lb
	T232000	4234S	42	34	16.5	21.0					27 lb
	T228000	6034S	60	34	16.5	30.0					39 lb
NEO-ANGLE	T358000	3838N	38	38	14.5	14.5	17.38	29.0	17.38	39.0	23 lb
	S352000	4242N	42	42	16.06	16.06	21.50	29.0	21.50	45.0	29 lb
	S360000	4848N	48	48	16.25	16.25	27.50	29.0	27.50	53.0	39 lb

Product specifications are subject to change without notice.
Use installation instructions provided with product.

NOTE: This is a professional grade product. A knowledge of construction techniques, plumbing and electrical installation according to codes are required for proper installation and user satisfaction. We recommend that a licensed contractor perform the installation of all Jacuzzi Whirlpool Bath products. Our warranty does not cover improper installation related problems.

INSTALLATION INSTRUCTIONS

4 EASY STEPS TO INSTALL YOUR NEW SHOWER BASE

STEP 1. If the subfloor is level, no other preparation is necessary. You can proceed to install the base. If the subfloor is not level, level shower base by spreading floor leveling compound, mortar, plaster or minimal expansion structural foam with a density of a minimum of 5 lbs./cubic ft. **EVENLY** over **ENTIRE** area where base will be installed. (See Figure 1.) **NOTE:** The compound used **MUST** make contact with the entire bottom surface of the base feet. The base is **NOT** to be supported by the base flange.

STEP 2. Position and install base on leveled surface over drain.

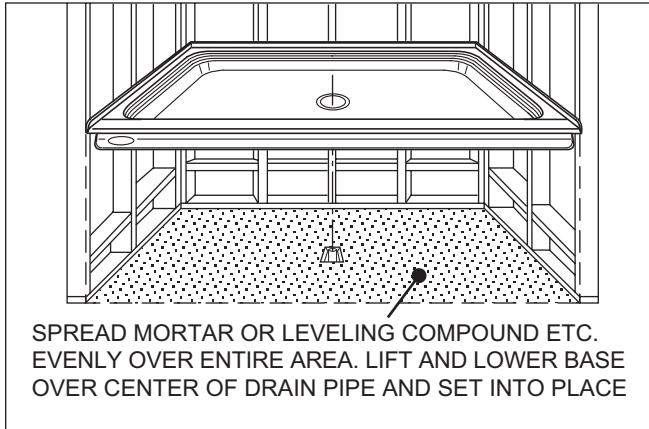

Figure 1

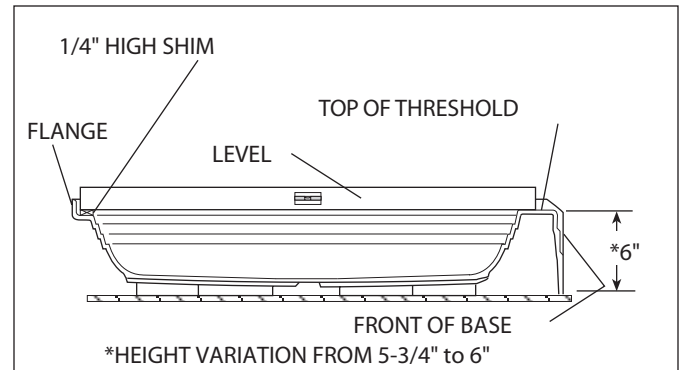

Figure 2A. FRONT TO BACK LEVELING

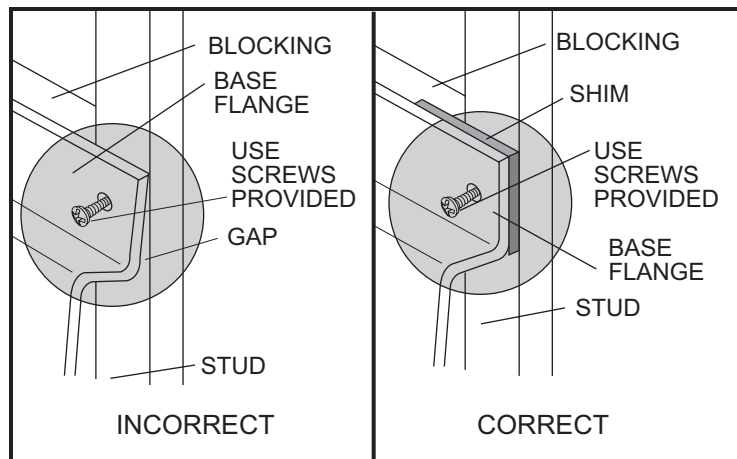

Figure 2B

IMPORTANT: IF THERE IS ANY GAP BETWEEN BASE FLANGE AND STUD OR BLOCKING, SHIMS MUST BE USED.

STEP 2. (Continued) Install your drain (NOT PROVIDED) at this time. Follow the directions that come with your drain kit.

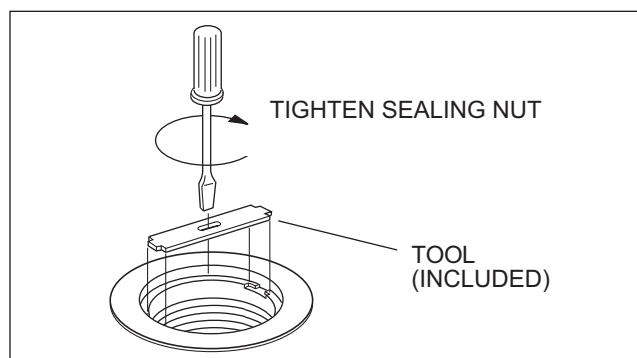

Figure 2C

STEP 3. Install cement board.

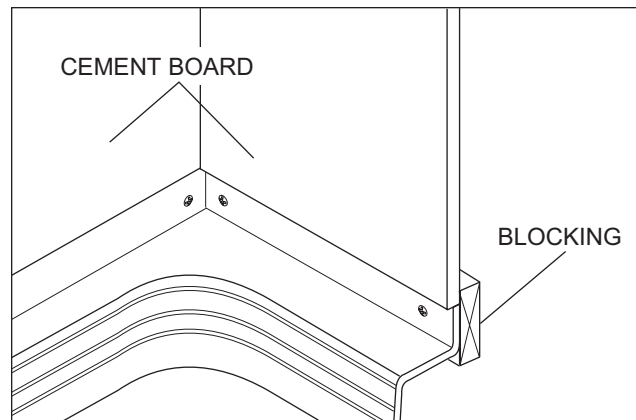

Figure 3

STEP 4. Install finishing materials and caulk base leaving 1/4" weep holes.

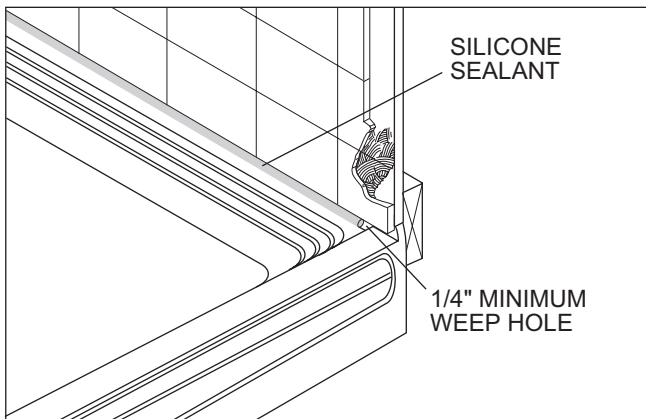

Figure 4A

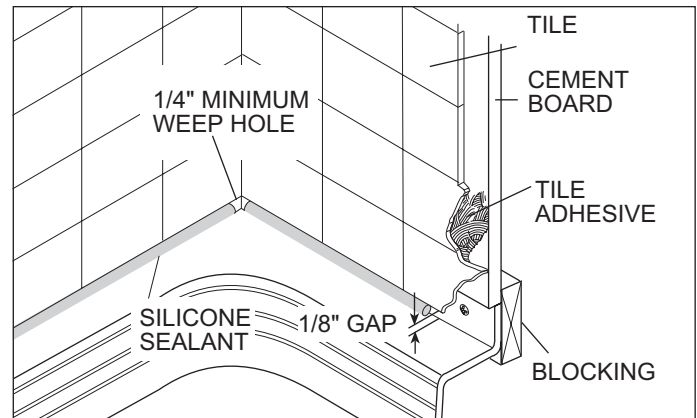

Figure 4B

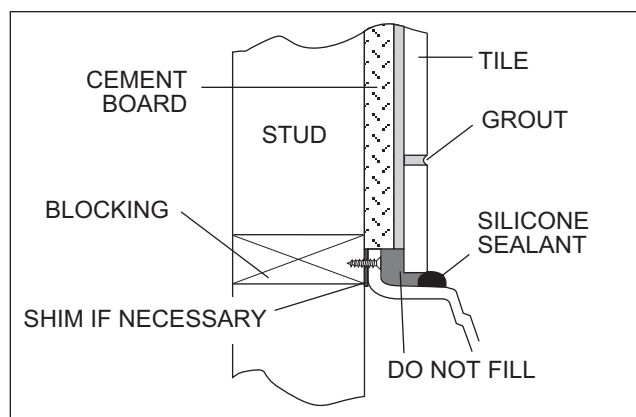

Figure 4C

Filling the area marked DO NOT FILL will prevent moisture from draining back into the base through the weep holes.

Detailed Installations Instructions

Important: Read complete instructions before beginning installation.

These shower bases are not provided with a shower drain. You must purchase a shower drain kit to properly complete this installation.

Remove the shower base from the carton. **Do not destroy the shipping carton until after satisfactory inspection of the product.**

Immediately upon receipt, inspect the base before installing. Should inspection reveal any damage or defect in the finish, do not install the base. Damage or defect to the finish claimed after the base is installed is excluded from the warranty. Jacuzzi Whirlpool Bath's responsibility for shipping damage ceases upon delivery of the products in good order to the carrier. Refer any claims for damage to the carrier. For definitions of warranty coverage and limitations, refer to the published warranty information packaged with the product. Jacuzzi Whirlpool Bath is not responsible for any defect that could have been discovered, repaired, or avoided by following this inspection and testing procedure.

Plan the installation in relation to the finished wall surfaces. Take into account the dimensions of both the shower base and the shower door enclosure to be used with it. Install the optional trim parts when all other installation has been completed.

PRELIMINARY ROUGH-IN

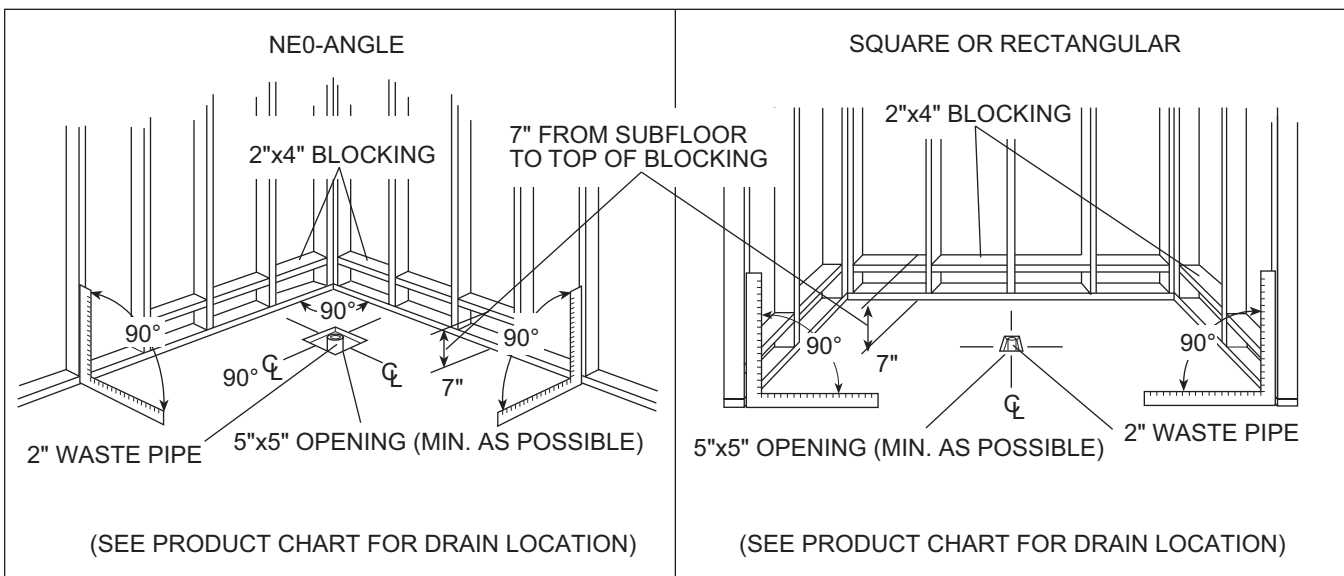

Provide an opening in the subfloor no less than 5" x 5" square. This opening should be located on the center lines of the shower base drain hole (See Product Chart).

The opening is to accommodate a 2" waste pipe. The waste pipe should be 1/4" to 1/2" above the surface of the subfloor.

Install the drain (NOT PROVIDED). Follow the instructions provided with your drain kit.

The illustration to the right is for EXAMPLE only.

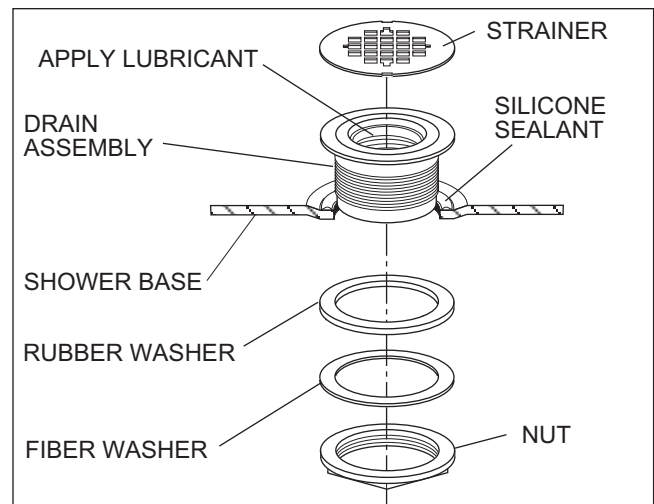

DETAILED INSTRUCTIONS FOR INSTALLING YOUR NEW SHOWER BASE

STEP 1

If the subfloor is level, no other preparation is necessary. You can proceed to install the base. If the subfloor is not level, level shower base by spreading floor leveling compound, mortar, plaster or minimal expansion structural foam having a density of a minimum of 5 lbs./cubic ft. **EVENLY** over **ENTIRE** area where base will be installed. (See Figure 1.) The compound used **MUST** make contact with the entire bottom surface of the base feet. The base is **NOT** to be supported by the base flange. Both sides of a joint or splice of sub-floor should be level to each other. Level and support waste pipe cutout area greater than 5" x 5".

STEP 2

With the drain fitting passing over the center of the drainpipe, lower the shower base carefully into place, push down firmly until the base is in place. You **must** check the level of the base in two directions. A 1/4" high shim is necessary at the back of the base for front to back leveling. (See Figure 2A.) Do not lift a corner to level the base. This will cause a loss of contact with the mortar. Attach the shower base flange to the stud wall and blocking with screws provided. Use a minimum of 3 screws per flange section.

NOTE: If there is any gap between base flange and stud or blocking, shims MUST be used to prevent distortion or cracking of the flange. (See Figure 2B.)

Tighten the drain as directed by the instructions that came with the drain kit. (see Figure 2C for an EXAMPLE). After drain is fully installed, test for proper drainage. If the shower base does not drain properly, rectify this condition before proceeding with the installation. **Jacuzzi Whirlpool Bath is not responsible for removal and/or reinstallation costs.**

NOTE: Watertight installation of the drain is the installer's responsibility. Drain leakage is excluded from the Jacuzzi Whirlpool Bath warranty.

Replace the strainer (if your drain kit came with one) and tape over the drain hole to prevent finishing material from entering drain.

STEP 3

Place cement board or equivalent on top of shower base flange and secure to studwall (see Figure 3).

STEP 4

Apply tile (or other finishing material) leaving a 1/8" gap between the finishing material and the shower base flange lip. Seal this gap with silicone sealant. Leave a minimum 1/4" weep hole at the back and front corners of the shower base (see Figures 4A and 4B). The weep holes are necessary to allow drainage from leakage through unsealed tiled grout.

Filling the area marked **DO NOT FILL** will prevent moisture from draining back into the base through the weep holes (see Figure 4C). This moisture is due to leakage through the tile grout. Sealing the tile grout will prevent this leakage.

Clean-Up After Installation

To avoid dulling and scratching the acrylic surface of the base, never use abrasive cleaners. A mild liquid detergent and warm water clean soiled surfaces.

Remove spilled plaster with a wood or plastic edge. Metal tools scratch the surface. Spots left by plaster or grout can be removed if lightly rubbed with detergent on a damp cloth or sponge.

Paint, tar, or other difficult stains can be removed with paint thinner, turpentine, or isopropyl alcohol (rubbing alcohol).

Minor scratches which do not penetrate the color finish can be removed by lightly sanding with 600-grit wet/dry sandpaper. You can restore the glossy finish to the acrylic surface of the base with a special compound, Meguiar's #10 Mirror Glaze. If not available, use automotive rubbing compound followed by an application of automotive paste wax.

Major scratches and gouges which penetrate the acrylic surface require refinishing. Ask your Jacuzzi Whirlpool Bath dealer for special instructions.

Determining Glass Enclosure Dimensions

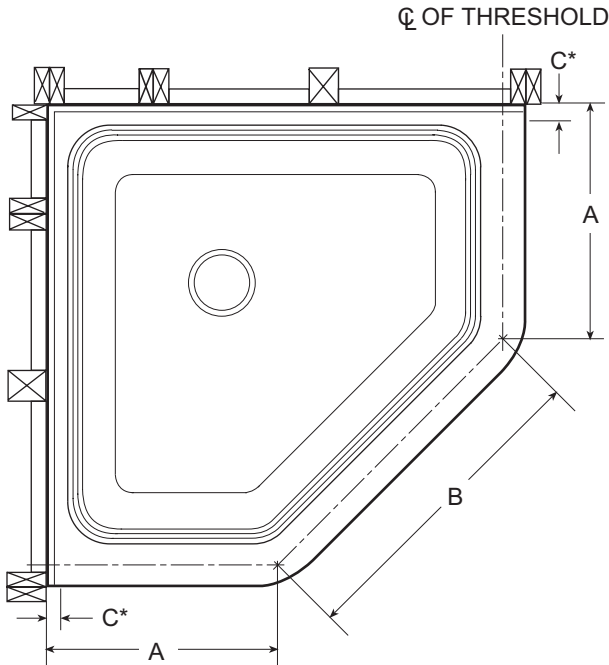

ROUGH-IN DIMENSION CHART (Neo-Angle Only)

MODEL	A	B	C*
3838N	16 3/4"	28"	1-3/8"
4242N	20-3/4"	27-3/8"	1-3/8"
4848N	26-3/4"	27-1/2"	1-3/8"

*C represents the dimension from the stud wall to the face of the finishing materials used in the shower construction.

If Jacuzzi Whirlpool Bath surround walls are used, subtract 1-3/8" from dimension A to arrive at glass enclosure dimensions. If other materials are used, subtract their thickness from dimension A.

FOR SQUARE & RECTANGULAR SHOWER BASES: if Jacuzzi Whirlpool Bath surround walls are used, subtract 1-3/8" from stud wall of each end to arrive at glass enclosure dimensions (see front page illustration and chart). If other materials are used, subtract their thickness from stud wall of each end.

Authorized Service

If you need a referral for a service company near you, or need assistance with operation or maintenance related questions, please call our Service Support Department at 1-800-288-4002. For service agent listing, visit our web site at <http://www.jacuzzi.com/>. To find the service agent listings, click on "For The Trade". Then click on Electrical/Mechanical Service Agents. Depending on the problem, click on "Electrical/Mechanical Repairs" or "Finish, Surface or Shell-Related Problems".

PRODUCT SPECIFICATIONS ARE SUBJECT TO CHANGE WITHOUT NOTICE. USE INSTALLATION INSTRUCTIONS SUPPLIED WITH PRODUCT.

Jacuzzi Whirlpool Bath has obtained applicable code (standards) listings generally available on a national basis for products of this type. It is the responsibility of the installer/owner to determine specific local code compliance prior to installation of the product.

Jacuzzi Whirlpool Bath makes no representation or warranty regarding, and will not be responsible for any code compliance.

Jacuzzi Whirlpool Bath

14801 Quorum Dr., Suite 400 Dallas, TX 75254

Service Support: Call 800-288-4002

© 1994 Jacuzzi Whirlpool Bath E124000W 10/06



Printed on Recycled Paper

Printed in U.S.A.

Jacuzzi Whirlpool Bath Limited Warranty Shower System Product

WARRANTY COVERAGE

Jacuzzi Whirlpool Bath (the "Company") offers the following express limited warranty to the original purchaser of any Jacuzzi Whirlpool Bath Shower System product ("unit") who purchases the product for personal or single family use ("user"). The Company will repair or replace, at its option, the unit or its equipment in accordance with the following terms and conditions. Units in commercial use are excluded from any warranty coverage whatsoever.

ONE YEAR LIMITED WARRANTY ON SHOWER SYSTEM

Our limited warranty on Shower System products is for one (1) year. Our warranty covers the unit and factory-installed components (e.g., pump, motor) against defects in material or workmanship. Warranty coverage begins on the date the unit was originally purchased by the user.

NINETY DAY (PARTS ONLY) LIMITED WARRANTY ON OPTIONS AND ACCESSORIES

Our limited warranty on options and accessories manufactured by the Company is for ninety (90) days for parts only. Our warranty covers options and accessories manufactured by the Company (e.g., fill spout kits, trim kits, skirts) against defects in material or workmanship. Warranty coverage begins on the date the option or accessory was originally purchased by the user.

WARRANTY LIMITATIONS

Our limited warranty does not cover defects, damage, or failure caused by the common carrier, installer, user, or other person, or resulting from, without limitation, any of the following: careless handling (lifting unit by plumbing, abrading finish, etc.); modification of any type for any reason (including modification to meet local codes); improper installation (including installation not in accordance with instructions and specifications provided with the unit); connections supplied by the installer of the equipment; improper voltage supply or unauthorized electrical modification; misuse; incorrect operation, or lack of proper routine maintenance; operation of the unit without specified minimum amount of water or at inappropriate water temperature; use of abrasive or improper cleaners; or acts of God, such as lightning, floods, earthquakes, etc.

In addition, THE COMPANY WILL NOT BE RESPONSIBLE FOR INCIDENTAL OR CONSEQUENTIAL DAMAGES or losses arising from any cause (e.g., water damage to carpet, ceiling, loss of use, etc.) including its own negligence; damages to, respecting, or resulting from: plated parts when chemicals are used in the unit; optional equipment not manufactured by the Company but supplied by Dealer, installer or the Company; the unit's prior usage as an operational display; or defects that should have been discovered before installation. This limited warranty does not include: labor, transportation, or other costs incurred in the removal and/or reinstallation of the original unit and/or installation of a replacement unit; any costs relating to obtaining access for repair; or loss of use damage, including loss of sales, profit or business advantage of any kind under any circumstances. Units in commercial use are excluded from any warranty coverage whatsoever.

Warranty coverage is provided only in the United States of America and Canada.

EXCLUSION OF IMPLIED WARRANTIES

IMPLIED WARRANTIES OF MERCHANTABILITY AND FITNESS FOR A PARTICULAR PURPOSE ARE DISCLAIMED TOGETHER OR TO THE FULL EXTENT ALLOWED BY LAW.

NOTICE: This warranty gives you specific legal rights, and you may also have other rights which vary from state to state. There are no warranties applicable to Jacuzzi Whirlpool Bath products except as expressly stated herein or as implied by applicable state and federal laws. The Company will not be responsible for any statements or representations made in any form that go beyond, are broader than or are inconsistent with any authorized literature or specifications furnished by the Company.

Some states do not allow limitations on how long an implied warranty lasts, or the exclusion or limitation of incidental or consequential damages, so the above limitations and exclusions may not apply to you.

RETURN OF WARRANTY CARD

The attached pre-addressed Warranty Registration Card MUST be filled out by the purchaser within thirty (30) days from purchase and mailed to Jacuzzi Whirlpool Bath in order for this warranty to become effective.



Jacuzzi Whirlpool Bath
14801 Quorum Dr., Suite 400
Dallas, TX 75254

RESPONSIBILITIES OF OTHERS

Inspecting the unit prior to installation is the responsibility of the installer or building contractor who acts on behalf of the user. They are responsible for ensuring the unit is free of defect or damage. Notices are placed on and in the unit and on the shipping carton advising the installer of this responsibility. In the event of a problem, the unit must not be installed. The Company is not responsible for failures or damage that could have been discovered, repaired, or avoided by proper inspection and testing prior to installation.

Damage occurring in transit is the responsibility of the carrier. The user or installer MUST open the crates and inspect the unit for damage when it is delivered. If damage is discovered, it must be reported immediately to the seller and the carrier in writing, and an inspection requested. Failure of the carrier to respond should be reported to the seller and the carrier. Your freight claims should be filed promptly thereafter.

It is the responsibility of the installer, building contractor, or user to provide access for service. The Company is not responsible for any costs relating to obtaining access for repair. The user shall bear such costs and, if appropriate, must seek recovery from the installer.

Damage occurring to the unit during installation is the responsibility of the installer and/or building contractor and damage occurring thereafter is the responsibility of the user.

Failure of any optional equipment is the sole responsibility of the equipment manufacturer. (Options and accessories manufactured by the Company are warranted for ninety (90) days from the original date of purchase for parts only.)

The Distributor or Dealer is responsible for knowing local code requirements and notifying the installing contractor and/or user of these requirements at the time of purchase. The Company is not responsible for costs to modify any product to obtain any code approval, such as city, county, or state building codes in U.S.A. or municipal or provincial codes in Canada.

WARRANTY SERVICE

For the customer's benefit, the Company maintains a list of independent service personnel to perform required warranty service repairs. Such firms are not agents or representatives of the Company and cannot bind the Company by words or conduct.

The Company will provide the warranty service described above when the following conditions have been met: the failure is of the nature or type covered by the warranty; the user has informed an Authorized Jacuzzi Whirlpool Bath Service Agent or Warranty Service Department Representative of the nature of the problem during the warranty period; conclusive evidence (e.g., proof of purchase or installation) is provided to the foregoing by the user proving that the failure occurred or was discovered within the warranty period; an authorized independent service person or Company representative has been permitted to inspect the unit during regular business hours within a reasonable time after the problem was reported by the user.

In order to obtain warranty service, consult your local telephone book for the location of the nearest Jacuzzi Whirlpool Bath Authorized Service Agent. Describe the problem and the Authorized Service Agent will inspect the unit and provide the required warranty service.

If you are unable to contact a Jacuzzi Whirlpool Bath Authorized Service Agent, call or write:

Jacuzzi Whirlpool Bath
14801 Quorum Dr., Suite 400
Dallas, TX 75254
Call: 800-288-4002

To obtain warranty replacement for factory-installed components or Company supplied options and accessories manufactured and supplied by the Company, call or write the above. Provide a description of the problem and proof of purchase. You will be instructed how to obtain replacements and where to return, at your expense, the failed component(s), option(s), or accessory(ies).

All replacement parts, equipment, and repairs shall assume the remaining warranty period of the part(s) replaced.

The Company's warranty obligation shall be discharged upon tender of replacement or repair. The customer's refusal to accept the tender terminates the Company's warranty obligation.

©1994 Jacuzzi Whirlpool Bath E124000W 10/06

Ninety-Day
Parts Only
Limited Warranty
On
Accessory(ies)



Warranty Registration Card

This card must be filled out and returned to the address printed on the other side within thirty (30) days from date of purchase in order for this warranty to be come effective.

Purchaser's Name _____

Purchaser's Address _____

City _____ State _____ Zip _____

Date of Purchase _____

Model Name _____

Serial Number _____

Dealer's Name _____

Dealer's Address _____

1. How did you first hear about this Jacuzzi® product?

- ☐ Advertisement ☐ Article in Magazine/Newspaper
☐ Visited Dealer/Plumbing Supplier ☐ Yellow Pages
☐ Builder/Plumber/Remodeler ☐ Decorator/Architect
☐ Visited Retailer/Home Center Store
☐ Word of Mouth ... Friend/Relative/Acquaintance
☐ Other (Please Describe) _____

2. Who first gave you specific information about this product (specifications, prices, etc.)?

- ☐ Dealer/Plumbing Supplier ☐ Builder ☐ Remodeler
☐ Plumbing Contractor ☐ Retailer/Home Center Store
☐ Decorator/Architect ☐ Already Installed
3. What was the main reason for purchase?
☐ Styling ☐ Warranty Service ☐ Product Features
☐ Brand Name ☐ Price ☐ Hydrotherapy
☐ Home Resale
☐ Other _____

4. Who finally decided which product you would buy?

- ☐ Self ☐ Spouse ☐ Self and Spouse Together
☐ Other Family Member ☐ Designer/Architect
☐ Builder/Plumber/Remodeler ☐ Already Installed
5. Who installed?
☐ Contractor/Plumber when remodeling
☐ Self/Spouse when remodeling
☐ Other _____

6. What is the current market value of this property?

7. Please estimate \$ _____ years

8. What is the age of the head of the household?

- ☐ Eller ☐ Lasco ☐ Price Pister ☐ Aqua Glass
☐ Kohler ☐ American Standard ☐ Sterling
☐ Other (Specify) _____

9. How long did you shop before purchasing unit?

- ☐ 1 day ☐ 2 months-6 months
☐ 2-7 days ☐ 6 months-1 year
☐ 1 week-2 weeks ☐ 1 year-2 years
☐ 2 weeks-4 weeks ☐ +2 years

10. Approximately how long have you lived in this home?

11. Please indicate, approximately, the total annual income of your household.

- ☐ Up to \$24,999 ☐ \$50,000 to \$74,999
☐ \$25,000 to \$29,999 ☐ \$75,000 to \$99,999
☐ \$30,000 to \$39,999 ☐ \$100,000 to \$149,999
☐ \$40,000 to \$49,999 ☐ \$150,000 and Above

12. Was your purchase process?

- ☐ Very easy ☐ Easy ☐ Difficult ☐ Very Difficult

Ninety-Day
Parts Only
Limited Warranty
On
Accessory(ies)