

1. **Insure proper ventilation.** In fully recessed drinking fountains be sure condenser faces louver panel and is within 1/2" (13 mm) of louver panel when panel is in place.
2. **Water inlet is 3/8" (10 mm) O.D. unplated tube connector.** Contractor to supply connections as required.
3. **Connecting lines to be made of unplated copper.** Thoroughly flush all lines to remove all foreign matter before connecting to cooler.
4. **Connect cooler to building supply** with a shut-off valve and install a 3/8" (10 mm) water line between the valve and cooler. Remove burrs from outside of water line. Insert water line into bulkhead union until it reaches a positive stop, approximately 3/4" (19 mm).

1000003082 (Rev. A - 12/15)

PARTS LIST		
ITEM NO.	PART NO.	DESCRIPTION
1	98724C	KIT - EVAPORATOR REPLACE ASSY
2	98775C	KIT - FAN MTR/BLADE/NUT
3	98778C	KIT - HEATX/DRIER
4	70841C	UNION - BULKHEAD
5	98773C	KIT - COLD CONTROL/SCREWS
*6	36322C	COMPRESSOR SERV. PAK
7	0000000238	KIT- ELECT/RELAY/COVER/OL
8	98777C	KIT- COMPRESSOR MTG HDWE
9	20282C	BRACKET - FAN MTG
10	66703C	DRIER
11	98776C	KIT - CONDENSER/DRIER
12	36208C	POWER CORD

220V 50/60HZ PARTS LIST		
ITEM NO.	PART NO.	DESCRIPTION
2	0000000244	KIT - FAN MTR/BLADE/NUT/SHROUD (50 HZ)
	0000000245	KIT - FAN MTR/BLADE/NUT/W/O SHRD (60 HZ)
*6	1000002147	COMP SERV. PAK (50 HZ)
	1000002146	COMP. SERV. PAK (60 HZ)
7	98751C	KIT-ELECT/RELAY/CVR/OL(50 HZ)
	98752C	KIT-ELECT/RELAY/CVR/OL(60 HZ)
12	31506C	POWER CORD (50/60 HZ)

***INCLUDES RELAY & OVERLOAD. IF UNDER WARRANTY REPLACE WITH SAME COMPRESSOR USED IN ORIGINAL ASSEMBLY.**
NOTE: ALL CORRESPONDENCE PERTAINING TO ANY OF THE ABOVE WATER COOLERS OR ORDERS FOR REPAIR PARTS **MUST** INCLUDE MODEL NO. AND SERIAL NO. OF COOLER, NAME AND PART NO. OF REPLACEMENT PART.

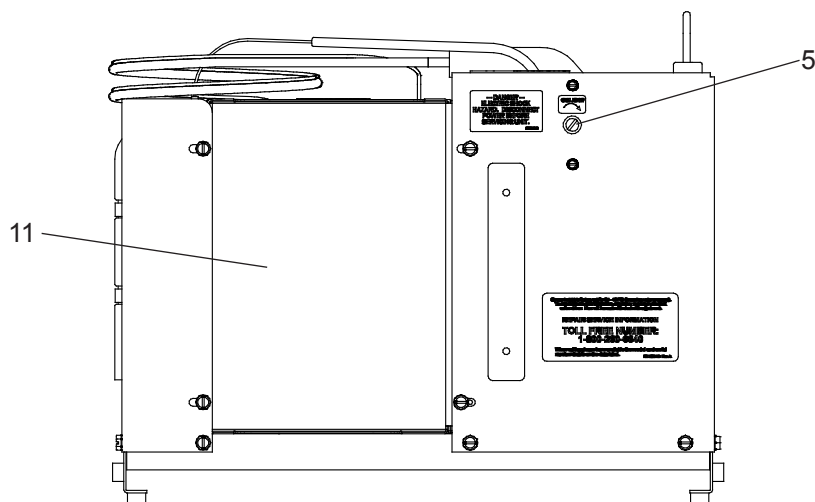
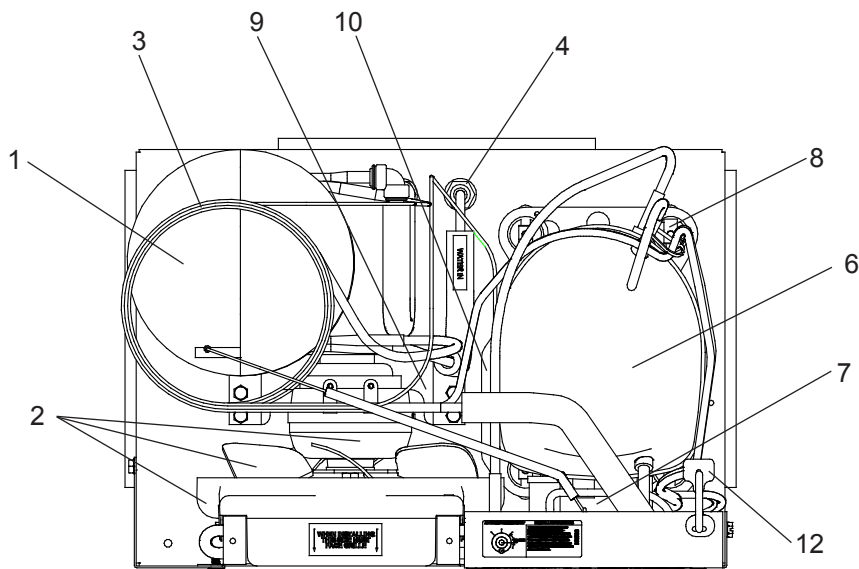

REPAIR SERVICE INFORMATION TOLL FREE NUMBER 1.800.260.6640
 FOR PARTS, CONTACT YOUR LOCAL DISTRIBUTOR OR CALL 1.800.834.4816
ELKAY MANUFACTURING COMPANY•2222 CAMDEN COURT•OAK BROOK, IL 60523•630.574.8484