

**BIDET FAUCET
K-470**

Features

- Brass construction
- Flexible connections for easy installation
- Brass valve bodies
- Quarter-turn washerless ceramic disc valves
- Pop-up drain with lift rod and tailpiece
- Variety of handle style options
- Vertical spray
- Fixture-mount transfer valve/vacuum breaker

Codes/Standards Applicable

Specified model meets or exceeds the following:

- ASME A112.18.1/CSA B125.1
- ASSE 1001

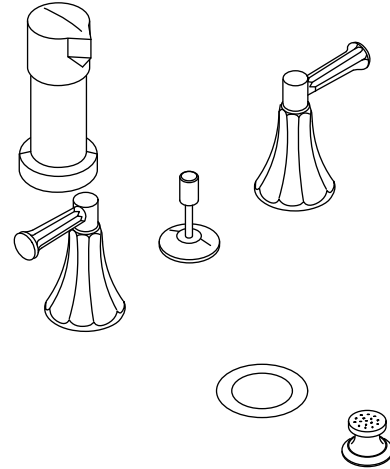

Colors/Finishes

- CP: Polished Chrome
- PB: Polished Brass
- Other: Refer to Price Book for additional colors/finishes

Specified Model

Model	Description	Color/Finish		
K-470-3C	Faucet with classic cross handles	<input type="checkbox"/> CP	<input type="checkbox"/> PB	<input type="checkbox"/> Other____
K-470-3S	Faucet with stately cross handles	<input type="checkbox"/> CP	<input type="checkbox"/> PB	<input type="checkbox"/> Other____
K-470-4C	Faucet with classic lever handles (shown)	<input type="checkbox"/> CP	<input type="checkbox"/> PB	<input type="checkbox"/> Other____
K-470-4S	Faucet with stately faceted lever handles	<input type="checkbox"/> CP	<input type="checkbox"/> PB	<input type="checkbox"/> Other____
K-470-4V	Faucet with stately Deco lever handles	<input type="checkbox"/> CP	<input type="checkbox"/> PB	<input type="checkbox"/> Other____

Product Specification

The two-handle fixture-mount bidet faucet shall be made of brass construction with brass valve bodies. Faucet shall feature quarter-turn washerless ceramic disc valves, assuring positive handle stop positioning. Faucet shall include flexible connections, pop-up drain with lift rod and tailpiece. Faucet shall include vertical spray, and fixture-mount valve/vacuum breaker. Faucet shall have variety of handle style options. Faucet shall be Kohler Model K-470-_____-_____.

MEMOIRS®

Installation Notes

Install this product according to the installation guide.

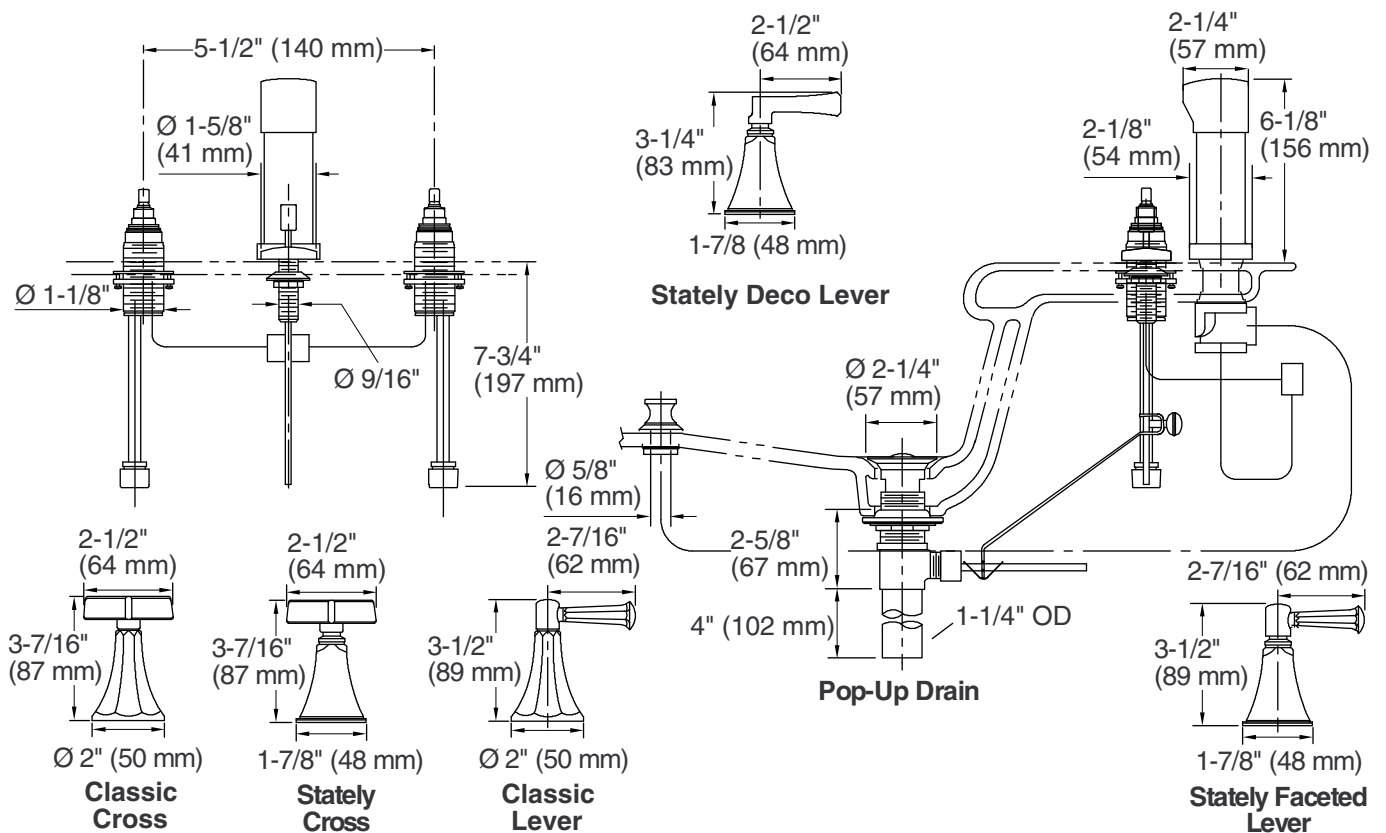

Product Diagram