



**Windward®**

6' Bath

**K-1115-L**



### Features

- Integral flange.
- Left drain.
- Integral lumbar support and armrests for comfort.
- 72" (1829 mm) x 42" (1067 mm) x 21" (533 mm)

### Material

- Acrylic

### Installation

- Alcove

### Recommended Accessories

K- 7166-AF Bath Drain

K- 11677 Bath Drain

K- 24916 Wireless Music Kit



### Codes/Standards

CSA B45.5/IAPMO Z124

ASTM E162

ASTM E662



Greenguard UL 2818 - Gold

### KOHLER® One-Year Limited Warranty

See website for detailed warranty information.

### Available Color/Finishes

*Color tiles intended for reference only.*

Color	Code	Description
	0	White
	96	Biscuit
	47	Almond

USA/Canada: 1-800-4KOHLER (1-800-456-4537)

Kohler Co. reserves the right to make revisions without notice to product specifications.

For the most current Specification Sheet, go to [www.kohler.com](http://www.kohler.com).

3-27-2016 06:01

THE BOLD LOOK  
OF **KOHLER®**

No change in measurements if connected with drain illustrated. (K-11677)

Recommended faucet area

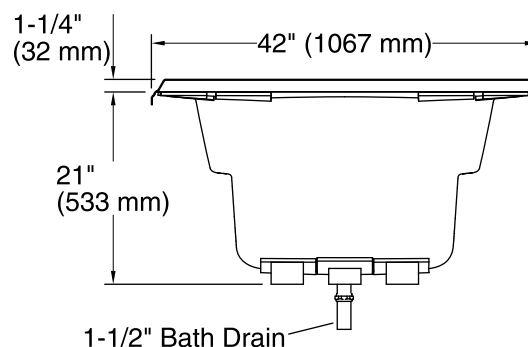
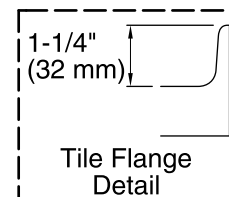
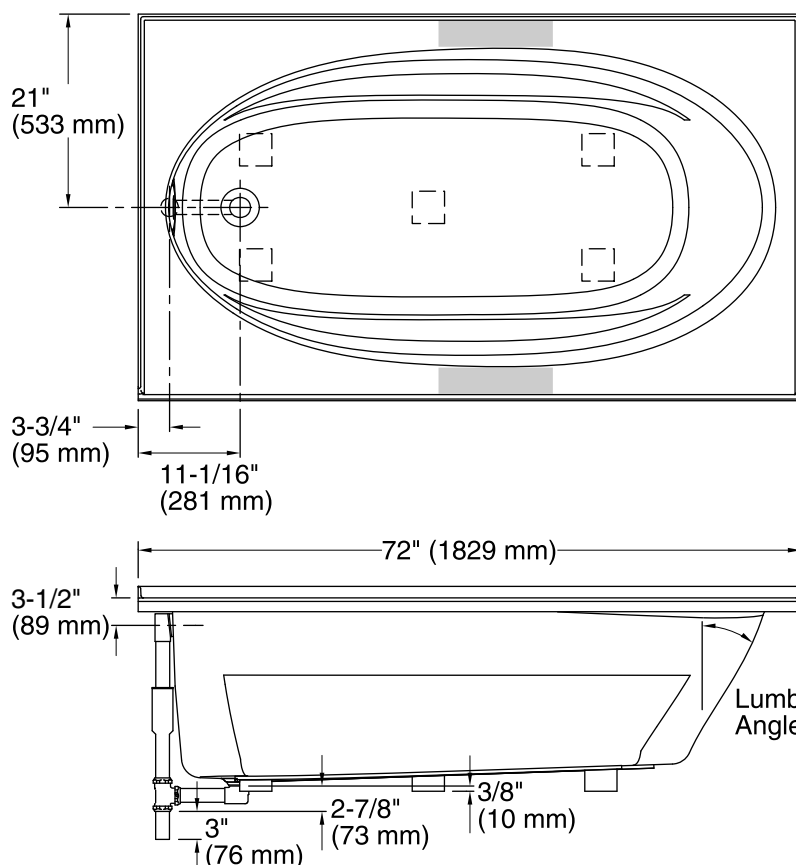

### Technical Information

All product dimensions are nominal.

Installation: 3-Wall Alcove

Drain location: Left

Basin area, bottom: 55" x 23-1/4" (1397 mm x 591 mm)

Basin area, top: 64" x 32" (1626 mm x 813 mm)

Weight: 100 lbs (45.4 kg)

Minimum floor load: 38 lbs/ft² (185.5 kg/m²)

Water depth: 15" (381 mm)

Water capacity: 78.5 gal (297.2 L)

Minimum flat for door: 3-1/16" (78 mm)

### Notes

Measure your actual product for rough-in details.

Install this product according to the installation instructions.

The hot water supply should be 70% of the capacity of the bath or greater. Installations will vary.

If installing a rim-mount faucet, make sure there is no interference with drain overflow before drilling any holes. Consult local and national codes for minimum air gap requirements if installing a spout on the faucet deck.