



**8 Degree™**  
Under-mount Kitchen Sink  
**K-3673**

**Features**

- 36-inch minimum base cabinet width.
- 16-gauge stainless steel.
- Under-mount.
- Single bowl.
- Includes installation hardware.
- Includes wine glass rack and bottom bowl rack.
- 33" (838 mm) x 18" (457 mm).

**Optional Accessories**

K- 3140 Cutting Board  
K- 8801 Sink Strainer

**Components**

Additional included component/s: Wine glass rack, bottom bowl rack, and hardware kit.



**Codes/Standards**

ASME A112.19.3/CSA B45.4

**Lifetime Limited Warranty for  
KOHLER® Stainless Steel Sinks**

See website for detailed warranty information.



**8 Degree™**  
Under-mount Kitchen Sink  
**K-3673**

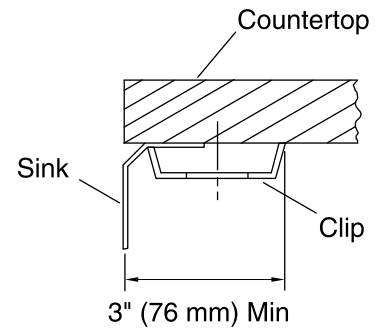
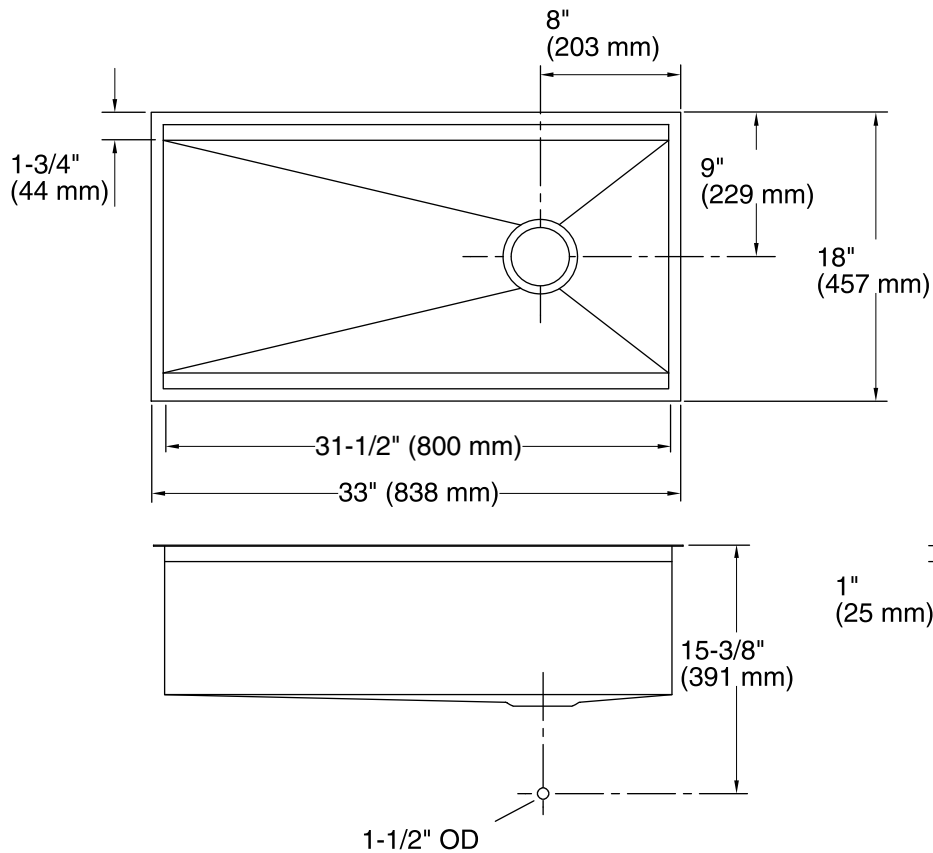

*\* Allow clearance around sink rim for clip attachment.*

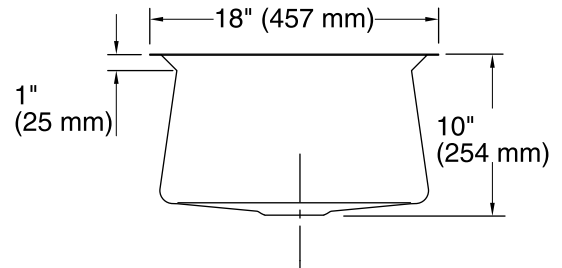

**Technical Information**

All product dimensions are nominal.

Bowl configuration: Single

Installation: Under-mount

Bowl area (Only) Length: 31-1/2" (800 mm)  
Width: 16-1/2" (419 mm)  
Bowl depth: 9-3/4" (248 mm)  
Water depth: 9-3/4" (248 mm)

Drain hole: 3-5/8" (92 mm)

Template: Under-mount, 1093327-7, required,  
included

**Notes**

Install this product according to the installation guide.

Allow a minimum of 3" (76 mm) clearance around the sink rim for clip attachment.