



# Underscore® Underscore®

## 5' BubbleMassage™ Bath

### K-5714-G



#### Features

- Dual lumbar supports two-person bathing by offering comfort at both ends
- Center drain.
- Slotted overflow allows for deep soaking. Requires K-7271 or K-7272 Clearflo slotted overflow bath drain (sold separately).
- Zones of Control™ feature allows you to target airjet massage to back, midsection, or feet.
- Variable-speed blower lets you adjust massage intensity to 18 levels.
- Automatic purge cycles remove residual water from air channels after use..

#### Material

- Acrylic

#### Hydrotherapy

- 118-122 BubbleMassage™ airjets. 18 levels of massage intensity.

#### Installation

- Drop-in

#### Required Accessories

K- 7271 Brass Slotted Overflow Bath Drain

or

K- 7272 PVC Slotted Overflow Bath Drain

#### Recommended Accessories

K- 24916 Wireless Music Kit



#### Codes/Standards

ASME A112.19.7/CSA B45.10

CSA B45.5/IAPMO Z124

UL 1795

CSA C22.2 No. 218.2

Greenguard UL 2818 - Gold





CARB P2

#### KOHLER® One-Year Limited Warranty

See website for detailed warranty information.

#### Available Color/Finishes

*Color tiles intended for reference only.*

Color	Code	Description
	0	White
	96	Biscuit
	47	Almond
	NY	Dune
	G9	Sandbar

No change in measurements if connected with drain illustrated. (K-7272)

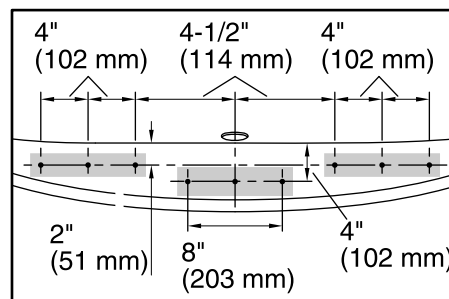
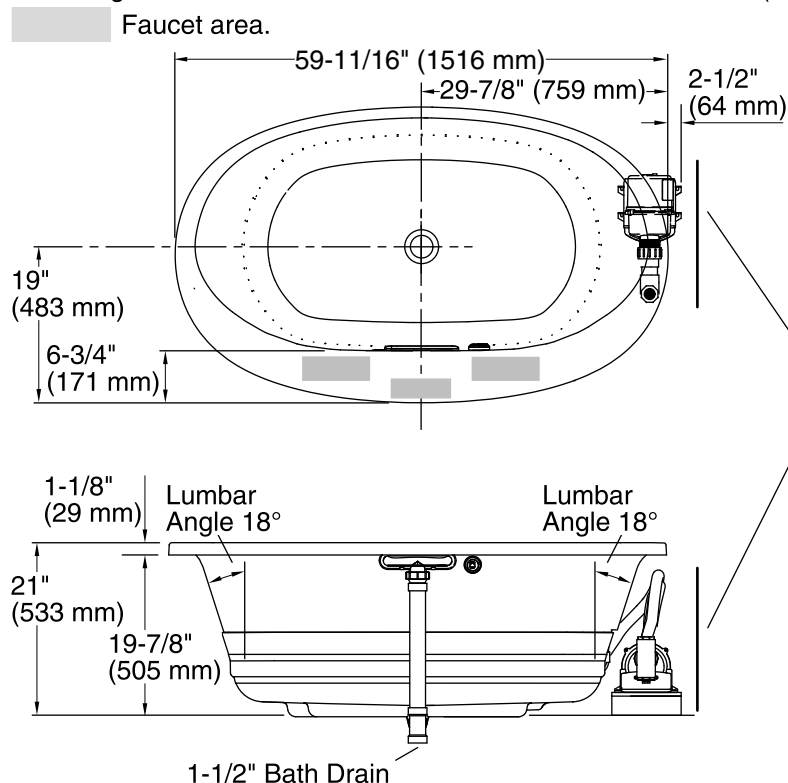

**Faucet Hole Locations  
(For KOHLER® Brand Only)**

Blower Motor Access  
30" (762 mm) W x 15" (381 mm) H

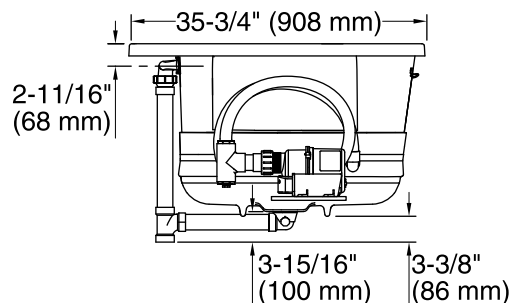

## Required Electrical Service

One dedicated circuit required, protected with Class A Ground-Fault Circuit-Interrupter (GFCI) or Residual Current Device (RCD).

Blower: 220-240 V, 15 A, 50/60 Hz

## Technical Information

All product dimensions are nominal.

Installation:	Drop-in
Drain location:	Center
Basin area, bottom:	43" x 25-5/8" (1093 mm x 651 mm)
Basin area, top:	55-9/16" x 28-3/8" (1411 mm x 720 mm)
Weight:	95 lbs (43.1 kg)
Minimum floor load:	45.4 lbs/ft² (221.7 kg/m²)
Water depth:	16-5/16" (415 mm)
Water capacity:	72.017 gal (272.6 L)
Template:	Drop-in, 1268438-7, required, included
Under-mount kit:	814-NA
Electrical component rating:	Blower: 220-240 V, 3 A, 50/60 Hz, 300 W
Blower speed:	Variable

## Notes

Measure your actual product for rough-in details.

Install this product according to the installation instructions.

The hot water supply should be 70% of the capacity of the bath or greater. Installations will vary.

Remote blower installation kit is available for relocating the blower.

Do not relocate or alter the PVC tee or coiled flexible tubing connected to the blower. Follow the blower relocation instructions exactly.

The blower base extends beyond the edge of the rim. Modify the framing as needed.