

Features

- Lever handles.
- 35° spout.
- Include showerhead with arm and flange, non-diverter spout with NPT connection, and faceplate with handle and push-button diverter.

Material

- Brass construction.

Technology

- 2.0 gpm (7.6 lpm) showerhead with Katalyst™ Spray Technology.

Required Accessories

K- 11748-K Pressure-Balancing Valve w/Diverter

or

K- 11748-KS Pressure-Balancing Valve w/Diverter

Adapters, Rough-in and Extension Kits

1016154

88526



Codes/Standards

ASME A112.18.1/CSA B125.1

ASSE 1016

DOE - Energy Policy Act 1992

EPA WaterSense®

See website for detailed warranty information.

Available Color/Finishes

Color tiles intended for reference only.

Color Code Description



CP Polished Chrome

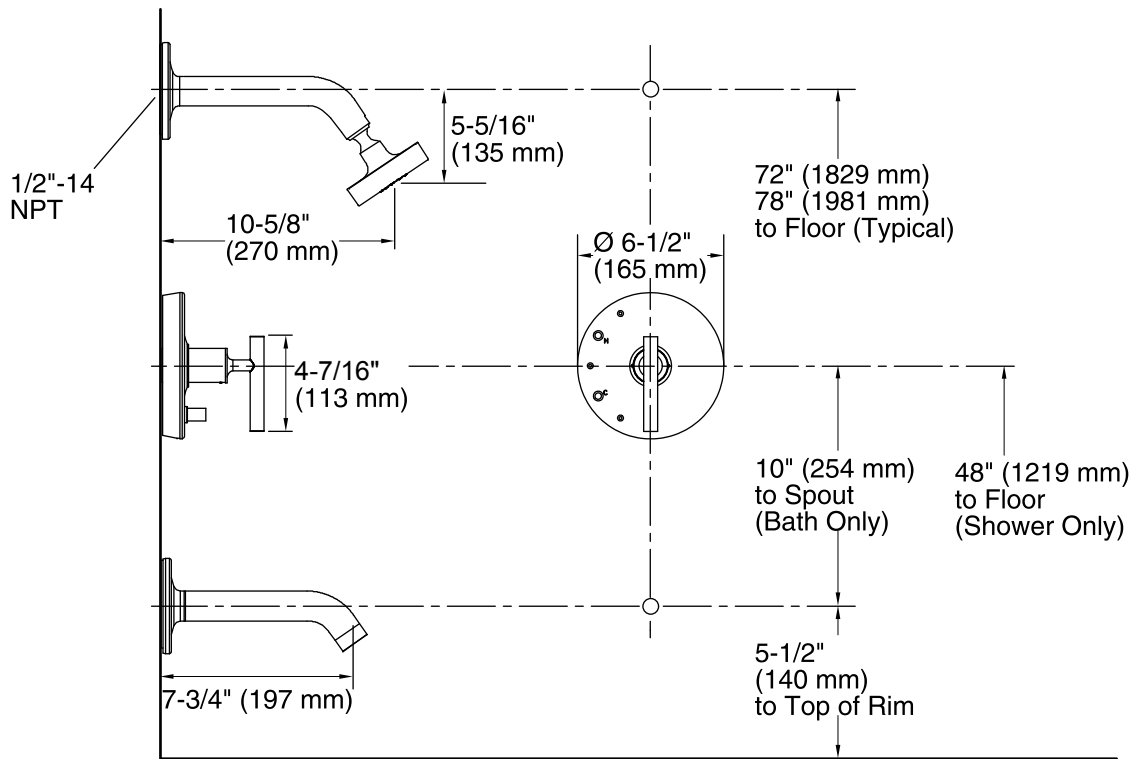

Technical Information

All product dimensions are nominal.

Showerhead:

Rated maximum flow: 2 gal/min (7.6 l/min)

Pressure: 80 psi (5.5 bar)

Notes

Install this product according to the installation guide.

Avoid cross-flow conditions. Do not install shut-off device on either valve outlet.

Cap the shower outlet if deck-mount spout, diverter, or handshower is connected to the spout outlet.