

### Features

- Brass construction.
- Dual control wall-mounted.
- Lever handles are ADA compliant.
- Less drain.
- Stationary spout.
- 4-9/16" (116 mm) min to 6-1/16" (154 mm) max spout from the wall to center of the outlet.
- 1.5 gal/min (5.7 l/min) maximum flow rate [max at 60 psi (4.14 bar)].

### Required Accessories

K- 410-K Wall-mount Valve

### Optional Accessories

K- 7107 Decorative Drain  
K- 7108 Decorative Drain  
K- 7114 Pop-Up Drain  
K- 7124 Pop-Up Clicker Drain  
K- 7127 Drain  
K- 7129 Drain



ADA

### Codes/Standards

ASME A112.18.1/CSA B125.1  
NSF 61  
NSF 372  
DOE - Energy Policy Act 1992  
EPA WaterSense®  
ADA  
ICC/ANSI A117.1  
All applicable US Federal and State material regulations

### KOHLER® Faucet Lifetime Limited Warranty

See website for detailed warranty information.

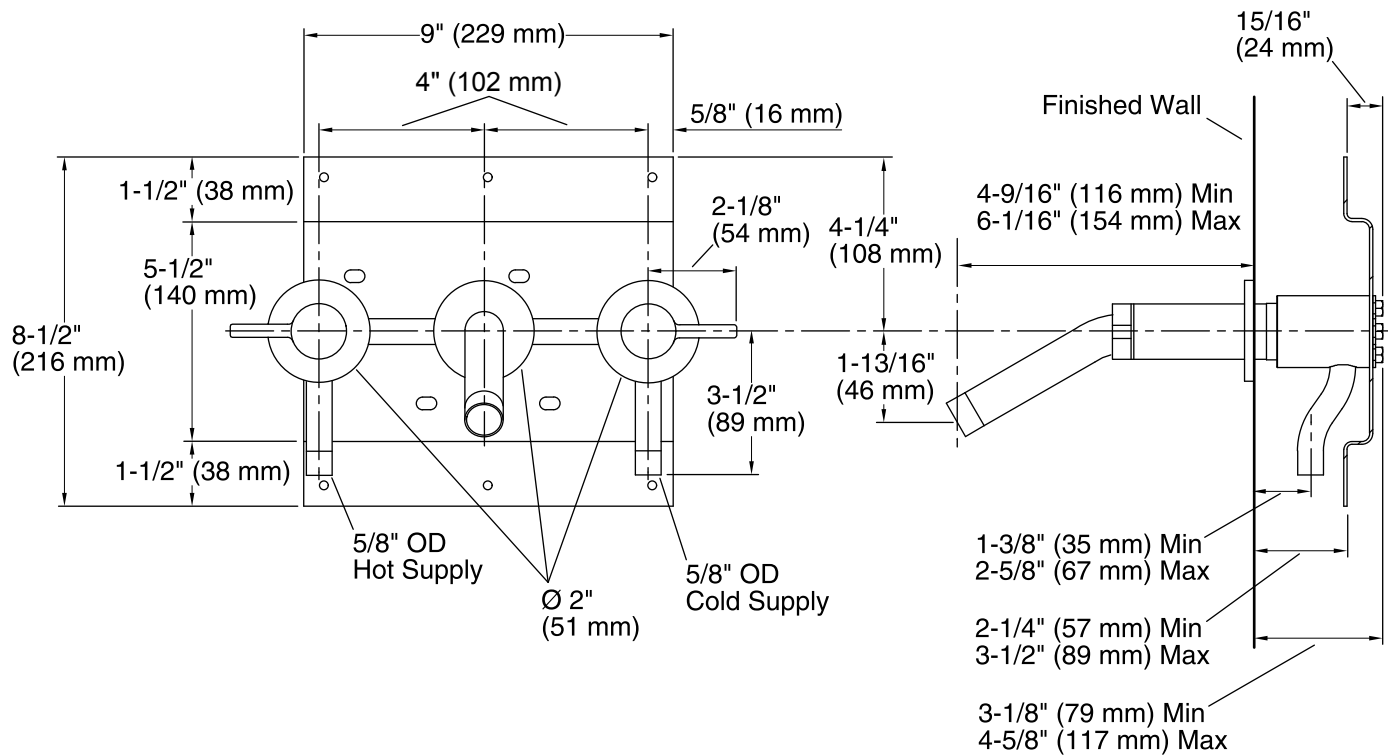

## Technical Information

All product dimensions are nominal.

## Faucet:

Flow rate: 1.5 gal/min (5.7 l/min)

Pressure: 60 psi (4.1 bar)

## Notes

Install this product according to the installation guide.

A minimum of 4" (102 mm) must be maintained between the bottom of the spout and the top of the fixture rim.

Three 1-1/2" (38 mm) diameter holes are required for the spout and handles.

ADA compliant when installed to the specific requirements of these regulations.