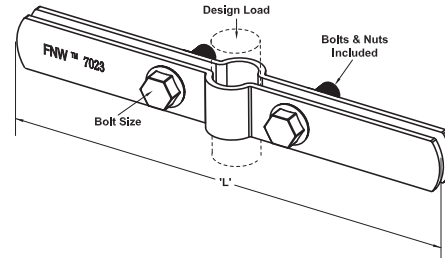

FIGURE 7023 - Riser Clamps for Copper Tube

Finish: Epoxy Plated
 Color: Copper
 MSS SP-58, Type 8
 Federal Specification WW-H-171, Type 8



Catalog Number	Pipe Size		L		Bolt Size	Design Load		Torque Value	Weight
	in.	mm	in.	mm		Lbs.	kN		
FNW7023EC0050	1/2	15.9	8-1/2	216.5	3/8-16UNC	75	0.33	25 ft.lbs	0.68
FNW7023EC0075	3/4	22.2	9-1/4	235.5	3/8-16UNC	75	0.33	25 ft.lbs	0.75
FNW7023EC0100	1	28.6	9-5/16	237.0	3/8-16UNC	120	0.53	25 ft.lbs	0.86
FNW7023EC0125	1-1/4	34.9	9-1/2	241.0	3/8-16UNC	150	0.67	25 ft.lbs	1.16
FNW7023EC0150	1-1/2	41.3	9-5/8	245.0	3/8-16UNC	150	0.67	25 ft.lbs	1.18
FNW7023EC0200	2	54.1	10-7/16	265.0	3/8-16UNC	150	0.67	25 ft.lbs	1.30
FNW7023EC0250	2-1/2	66.7	11-3/16	284.5	3/8-16UNC	300	1.34	25 ft.lbs	1.38
FNW7023EC0300	3	79.4	12	304.0	3/8-16UNC	300	1.34	25 ft.lbs	1.49
FNW7023EC0400	4	104.8	12-1/2	318.0	3/8-16UNC	300	1.34	25 ft.lbs	1.61
FNW7023EC0600	6	155.6	15-1/8	385.0	1/2-13UNC	600	2.67	55 ft.lbs	5.27

FIGURE 7610 - Standard U-Bolt w/4 Hex Nuts

- Includes 4 Finished Hex Nuts
- Available In:
 - Plain Carbon Steel
 - Zinc Coated Carbon Steel
 - 304 Stainless Steel
- Design: MSS SP-58 Type 24 Federal Specification WW-H-17E Type 24
- Selection & Application: MSS SP-69 Type 24

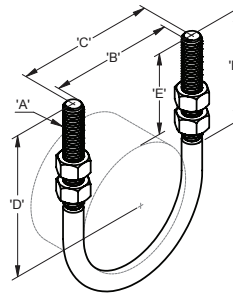

Pipe Size		A (Thread Size)	B		C		D		E		F		Weight Lbs.
in.	mm		in.	mm	in.	mm	in.	mm	in.	mm	in.	mm	
1/2	21.3	1/4"-20	15/16	23.8	1-3/16	30.2	2-3/4	69.8	2-5/16	58.7	2-1/8	54.0	0.86
3/4	26.6	1/4"-20	1-1/8	28.6	1-3/8	34.9	2-3/4	69.8	2-7/32	56.3	2-1/8	54.0	0.95
1	33.4	1/4"-20	1-3/8	34.9	1-5/8	41.3	2-3/4	69.8	2-3/32	53.2	2-1/8	54.0	1.01
1-1/4	42.1	3/8"-16	1-11/16	42.9	2-3/32	53.2	2-7/8	73.0	2-1/32	51.6	2-1/8	54.0	2.66
1-1/2	48.2	3/8"-16	2	50.8	2-3/8	60.3	3	76.2	2-1/16	52.4	2-1/2	63.5	2.75
2	60.3	3/8"-16	2-7/16	61.9	2-13/16	71.4	3-1/4	82.5	2-1/16	52.4	2-1/2	63.5	3.10
2-1/2	73.0	1/2"-13	2-15/16	74.6	3-7/16	87.3	3-3/4	95.2	2-5/16	58.7	3	76.2	7.04
3	88.9	1/2"-13	3-9/16	90.5	4-1/16	103.2	4	101.6	2-1/4	57.1	3	76.2	7.59
4	114.3	1/2"-13	4-9/16	115.9	5-1/16	128.6	4-1/2	114.3	2-1/4	57.1	3	76.2	8.78
5	141.3	1/2"-13	5-21/32	143.6	6-5/32	156.3	5	127.0	2-7/32	56.3	3	76.2	9.83
6	168.2	5/8"-11	6-3/4	171.4	7-3/8	187.3	6-1/8	155.6	2-13/16	71.4	3-3/4	95.2	19.14
8	219.1	5/8"-11	8-3/4	222.2	9-3/8	238.1	7-1/8	181.0	2-13/16	71.4	3-3/4	95.2	22.68
10	273.1	3/4"-10	10-7/8	276.2	11-5/8	295.3	8-3/8	212.7	3	76.2	4	101.6	39.75
12	323.9	7/8"-9	12-7/8	327.0	13-3/4	349.2	9-5/8	244.5	3-1/4	82.5	4-1/4	107.9	66.10
14	355.6	7/8"-9	14-1/8	358.8	15	381.0	10-1/4	260.3	3-1/4	82.5	4-1/4	107.9	70.18
16	406.4	7/8"-9	16-1/8	409.6	17	431.8	11-1/4	285.7	3-1/4	82.5	4-1/4	107.9	75.35
18	457.2	1"-8	18-1/8	460.4	19-1/8	485.8	12-5/8	320.7	3-5/8	92.1	4-3/4	120.6	134.4
20	508.0	1"-8	20-1/8	511.2	21-1/8	536.6	13-5/8	346.1	3-5/8	92.1	4-3/4	120.6	121.8
24	609.6	1"-8	24-1/8	612.8	25-1/8	638.2	15-5/8	396.9	3-5/8	92.1	4-3/4	120.6	168.7