



# Levity®

## Frameless Sliding Shower Door

### K-706167-L

#### Features

- Gently curved towel bars, inside and outside, provide integrated storage on the door.
- CleanCoat® technology creates a barrier between the water and glass to help keep your shower door looking new.
- Frameless, 5/16" (8 mm) thick Crystal Clear tempered glass door.
- Door tracking system features a hidden, cushioned, center guide for smooth, quiet sliding action.
- Innovative roller design simplifies installation and provides out-of-plumb adjustability.
- Frameless design emphasizes glass and creates a sleek, minimalist look.
- Smooth, easy-to-clean wall jambs.

#### Material

- Anodized aluminum hardware prevents rusting or corrosion.

#### Installation

- Out-of-plumb adjustability allows for simpler installation.
- Can be installed to open to the left or right.

#### Components

Additional included component/s: Hardware Kit.



#### Codes/Standards

ANSI Z97.1 (Tempered Glass)  
CPSC 16CFR 1201

#### KOHLER® One-Year Limited Warranty

See website for detailed warranty information.

#### Available Color/Finishes

*Color tiles intended for reference only.*

| Color | Code | Description |
|-------|------|-------------|
|-------|------|-------------|



|     |                        |
|-----|------------------------|
| SHP | Bright Polished Silver |
| NX  | Brushed Nickel         |
| ABZ | Anodized Dark Bronze   |

#### Available Glass Options

| Code | Description |
|------|-------------|
|------|-------------|

|  |               |
|--|---------------|
|  | Crystal Clear |
|--|---------------|

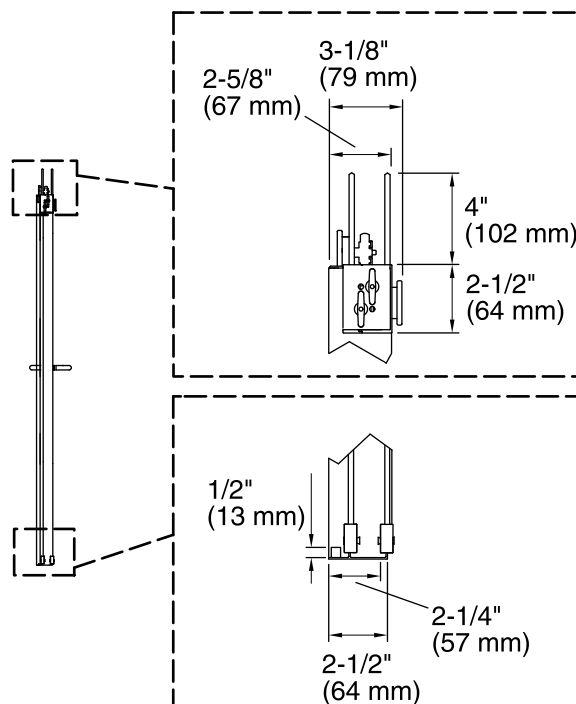
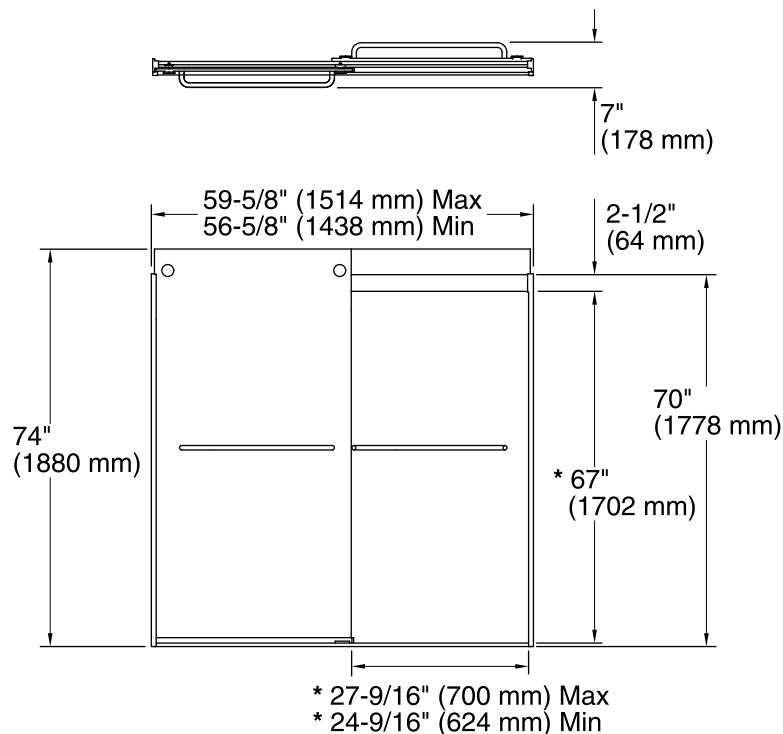

## \* Walk-Through

### Technical Information

All product dimensions are nominal.

Installation type: For shower base installation

Opening style: Sliding/Bypass

Opening Width - Min: 56-5/8" (1438 mm)

Opening Width - Max: 59-5/8" (1514 mm)

Walk-through - Min: 24-9/16" (624 mm)

Walk-through - Max: 27-9/16" (700 mm)

Glass thickness: 5/16" (8 mm)

Glass coating: CleanCoat®

### Notes

Install this product according to the installation guide.

The vertical opening should be a minimum of 76-1/2" (1943 mm) to allow for installation clearance.