

# Class 300 Carbon Steel Flanged Ball Valves

Unibody Design • Blowout-Proof Stem • 316 SS Trim • Mounting Pad • Fire Safe • Vented Ball

**740 PSI/51 bar non-shock cold working pressure\***

CONFORMS TO ASME/ANSI B16.34, B16.5, MSS SP 72,  
API 607 FOURTH EDITION, API 608, API 598,  
MSS SP 25

## MATERIAL LIST

PART	SPECIFICATION
1. <sup>1</sup> Body and End Piece	Carbon Steel ASTM A 216 Type WCB
2. <sup>1</sup> Ball (Vented)	Stainless Steel ASTM A 351 Type CF8M
3. Stem	Stainless Steel ASTM A 276 Type 316
4. Seat	Reinforced PTFE
5. Packing Set	Graphite and Braided Graphite
6. Pack Gland	Stainless Steel 304 SS
7. Pack Gland Nut	Carbon Steel Plated
8. O-Ring	Fluorocarbon Encapsulated
9. Gasket	304 SS/Graphite Spiral Wound

<sup>1</sup> Cast specifications shown. Smaller sizes may be manufactured from equivalent bar stock specifications.



**F-530-CS-R-66-FS**  
Carbon x Stainless  
Flanged

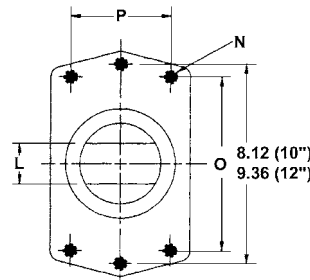

TOP FLANGE FOR  
10" & 12"

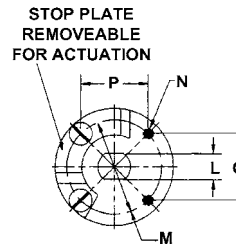

STOP PLATE  
REMOVEABLE  
FOR ACTUATION

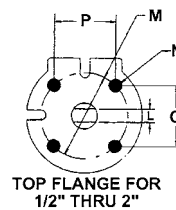

TOP FLANGE FOR  
3" THRU 8"

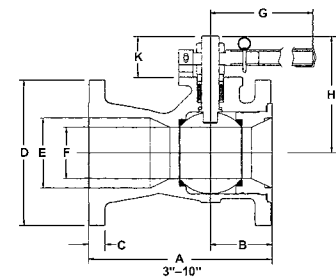
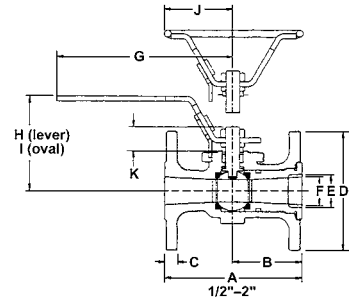

## DIMENSIONS—WEIGHTS—QUANTITIES

Size	Dimensions						
	A	B	C	D	E	F	
In. mm.	In. mm.	In. mm.	In. mm.	In. mm.	In. mm.	In. mm.	
1/2	15 5.50	140 2.13	54 .59	15 3.81	97 .50	13 .43	11
3/4	20 6.00	152 2.31	59 .65	17 4.68	119 .75	19 .63	16
1	25 6.50	165 2.50	64 .71	18 4.94	125 1.00	25 .81	21
1 1/2	40 7.50	191 3.25	83 .81	21 6.13	156 1.50	33 1.19	30
2	50 8.50	216 3.00	76 .87	22 6.50	165 2.00	51 1.50	38
3	80 11.13	283 4.00	102 1.13	29 8.25	210 3.00	76 2.38	60
4	100 12.00	305 4.25	103 1.25	32 10.00	254 4.00	102 3.00	76
6	150 15.88	403 5.25	133 1.44	37 12.50	318 6.00	152 4.38	111
8	200 16.50	419 5.50	140 1.63	41 15.00	381 8.00	203 5.68	144
10	250 18.00	457 6.50	165 1.88	48 17.50	443 10.00	254 7.50	190

Size	Dimensions											F-530-CS-R-66-FS		
	G	H	I	J	K	L	M	N	O	P	Lbs.	Kg.		
In. mm.	In. mm.	In. mm.	In. mm.	In. mm.	In. mm.	In. mm.	In. mm.	In. mm.	In. mm.	In. mm.				
1/2	15 6.63	168 2.84	72 3.16	80 2.56	65 .59	15 .25	6 1.68	43 .250-20	1.19	30 1.19	30	5.00	2.27	
3/4	20 6.63	168 3.20	81 3.58	91 2.56	65 .76	19 .25	6 1.68	43 .250-20	1.19	30 1.19	30	8.00	3.64	
1	25 6.63	168 3.45	88 3.83	97 2.56	65 .93	24 .31	8 1.68	43 .250-20	1.19	30 1.19	30	10.00	4.55	
1 1/2	40 9.13	232 4.75	121 5.25	133 3.31	84 1.22	31 .56	14 2.06	52 .250-20	1.46	37 1.46	37	20.00	9.09	
2	50 9.13	232 4.88	124 5.38	137 3.31	84 1.36	35 .56	14 2.06	52 .250-20	1.46	37 1.46	37	23.00	10.45	
3	80 16.60	422 6.16	156 —	— —	— —	1.97	50 .68	17 3.00	76 .375-16	2.12	54 2.12	54	54.00	24.55
4	100 16.60	422 7.22	183 —	— —	— —	2.16	55 .68	17 3.00	76 .375-16	2.12	54 2.12	54	91.50	41.59
6	150 32.80	833 10.09	256 —	— —	— —	3.59	91 1.13	29 4.50	114 .500-13	3.18	81 3.18	81	181.50	82.50
8	200 —	— —	— —	— —	— —	3.43	87 1.13	29 4.50	114 .500-13	3.18	81 3.18	81	257.00	116.82
10	250 —	— —	— —	— —	— —	5.56	141 1.75	44 —	—	7.24	184 3.66	93	429.00	195.00

Note: valves are static grounded by thrust washer.

♦ For detailed operating pressure, refer to pressure temperature chart on page 86.

Visit our website for the most current information.