

TECHNICAL DATA

Flow Rate	1.75 GPM at 45 PSI
Recommended Water Pressure	30-75 PSI
Max. Water Pressure	145 PSI
Recommended Hot Water Temp.	120°-140° F
Hole Size For Faucet	1" 3/8

NOTE

Contact us immediately if you see inconsistencies:

Phone - 1-800-626-5771

Email - kc-customerservice.us@franke.com

Website - www.frankeksd.com

CONTENTS IN BOX

- 1 - Faucet assembly
- 2 - Rubber gasket
- 3 - Plastic flange
- 4 - Rubber shaped flange
- 5 - Metal shaped flange
- 6 - Threaded bar
- 7 - Fixing nut
- 8 - Supply hoses
- 9 - Aerator key

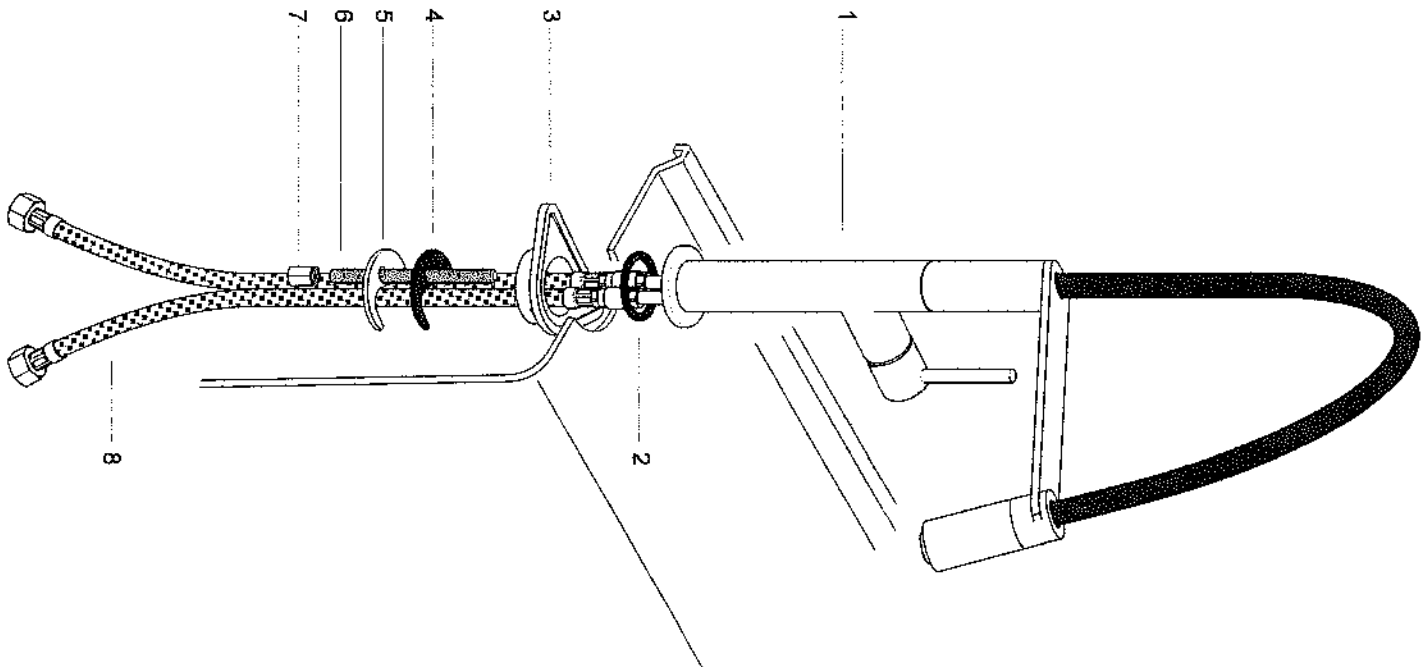
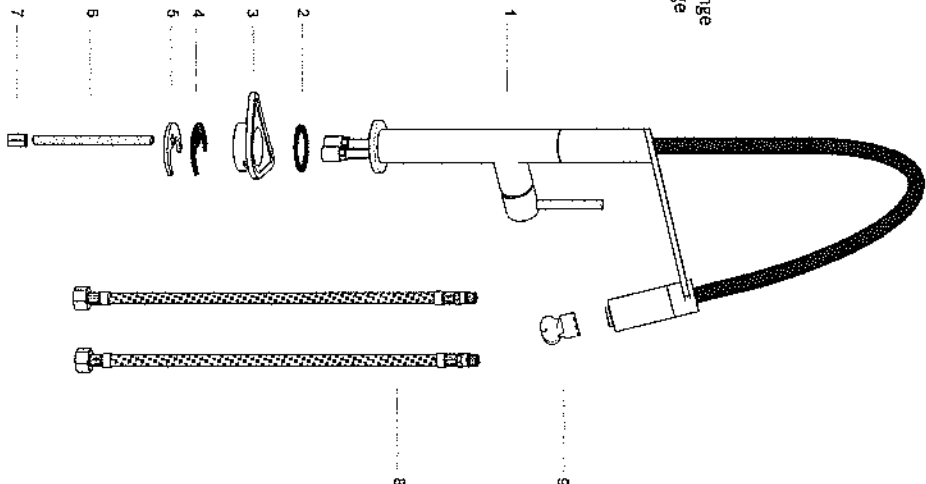

INSTALLATION INSTRUCTIONS

1. Remove all contents from the package and check for completeness.
2. Turn off water supply.
3. Remove faucet and hardware from its protective packaging. **Faucet assembled.**
4. Cut a mounting hole 1" 3/8 diameter (35mm) in the desired position top or sink (if one isn't available).
5. Connect the flexible supply hoses (8) to the short supply pipes in body (1) **HAND TIGHT ONLY.**
6. Ensure rubber gasket (2) is in the base of faucet. **ATTENTION:** The gasket should be sitting between the countertop base.

DO NOT use putty or other sealant at this location.

NOTES:

Solid surface installation: The countertop mounting surface needs to be free of debris otherwise the faucet may not sit properly. For tile installations, avoid installing faucet near or on top of grout. This may cause a weak joint between the faucet and the counter and leaks.

7. Install the threaded bar (6) to the base of the faucet body.
8. Install the mounting hardware to the base of the faucet body in the order: plastic flange (3), fixing washer flange (4), fixing metal flange (5), threaded bar (6), fixing nut (7), aerator key (9) as illustrated.
9. Tighten the fixing nut (7) on the body (1).
10. Connect the flexible supply hoses (8) to the water supply in the desired location.
11. Remove the aerator using an aerator key (9), turn on the water, and check for any debris. Ensure everything is functioning properly at this time. If there are any leaks, then reinstall the aerator.

