

'Apollo' Valves

SUBMITTAL SHEET

70-400 Series

Single Union End, Solder **Bronze** Ball Valve



Job Name:	
Job Location:	
Engineer:	
Contractor:	
Tag:	
PO Number:	
Representative:	
Wholesale Distributor:	



DESCRIPTION

The Apollo® 70-400 Series is a standard port ball valve that is designed to be soft soldered in to lines without disassembly. Manufactured with proven ASTM Materials in the USA.

FEATURES

- Adjustable Packing Gland
- Blow-Out Proof Stem Design
- RPTFE Seats and Stuffing Box Ring

PERFORMANCE RATING

- Maximum Pressure:
600 psi CWP, 150 psi SWP
- Maximum Temperature: 500°F
- Vacuum Service to 29 in. Hg

APPROVALS

- MSS SP-110
- Federal Specifications:
WW-V-35C, Type: II,
- CRN: OC10908.5C

MODELS

- 70-400 Series - Standard
- 70-440 Series - 316 SS Ball & Stem

OPTIONS & SIZES

- (-03) 1 1/4" CS Stem Extension 3/8" - 2"
- (-04) 2 1/4" CS Stem Extension 3/8" - 2"
- (-10) SS Lever & Nut 3/8" - 2"
- (-14) Side Vented Ball (Uni-Directional) 3/8" - 2"
- (-15) Wheel Handle, Steel 3/8" - 2"
- (-17) Rough Chrome Plated 3/8" - 2"
- (-20) Slot Vented Ball 3/8" - 2"
- (-21) UHMWPE Trim (Non-PTFE) 3/8" - 2"
- (-27) SS Latch-Lck Lever & Nut 3/8" - 2"
- (-32) SS Tee Handle & Nut 3/8" - 2"
- (-35) VTFF Trim 3/8" - 2"
- (-48) SS Oval Handle (No Latch) & Nut 3/8" - 2"
- (-50) 2-1/4" CS Locking Stem Extension 3/8" - 2"
- (-56) MPTFE Seats and Packing 3/8" - 2"
- (-57) Oxygen Cleaned 3/8" - 2"
- (-63) NPT x Solder/Socket weld 3/8" - 2"
- (-92) Balancing Stop 3/8" - 2"

STANDARD MATERIALS LIST

Part Name	Material
Lever and Grip	Steel, Zinc Plated w/ Vinyl Coating
Stem Packing / Bearing	RPTFE
Ball	B16 or B283, C37700 Chrome Plated
Seat (2)	RPTFE
Retainer	B16 Brass or B584-C84400 Bronze
Gland Nut & Stem	B16 Brass
Lever Nut	Steel, Zinc Plated
Body Seal (1-1/4" to 2")	PTFE
Body	B584-C84400 Bronze
Tailpiece & Nut	B16 or B584-C84400 Bronze
Union Seal	Fluorocarbon
Stem	B16

DIMENSIONS

Part Number	Size (in.)	Dimensions (in.)							Wt. (lbs.)
		A	B	C	D	E	F	G	
70-402-01	3/8"	0.37	1.81	3.09	1.75	3.87	0.50	0.37	0.85
70-403-01	1/2"	0.50	2.00	3.43	1.75	3.87	0.63	0.50	1.02
70-404-01	3/4"	0.68	2.62	4.56	2.06	4.78	0.88	0.75	1.93
70-405-01	1"	0.87	2.81	5.06	2.25	4.78	1.13	0.90	2.42
70-406-01	1-1/4"	1.00	2.87	5.18	2.62	5.50	1.38	0.96	4.11
70-407-01	1-1/2"	1.25	2.92	5.53	3.10	8.00	1.63	1.09	5.44
70-408-01	2"	1.50	3.50	6.75	3.24	8.00	2.13	1.34	7.77

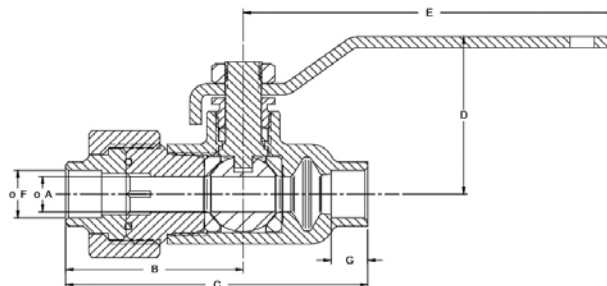

Apollo Valves, Manufactured by **Conbraco Industries, Inc.**
701 Matthews Mint-Hill Road, Matthews, NC 28105 USA
www.apollovalves.com | (704) 841-6000

