

The Mueller Centurion II Gas Meter Ball Valve, available in 3/4" and 1" insulated and non-insulated styles, is made from ductile iron with brass stem and a nickel/chrome plated brass ball. Since resilient seals are used, there is no lubricant to dry out and allow leakage. The 200 psig rated Centurion II valve provides superior, maintenance free performance at a price that is competitive with grease sealed plug valves. It has Mueller's exclusive Cationic Epoxy Electrocoat, a superior rust inhibiting agent, on the inside and outside of the valve body.

The Centurion II valve is a full-port ball valve featuring a tamper resistant design with a "blowout-proof" stem sealed by two O-rings. Produced in accordance with ASME B16.33, the Mueller Centurion II Gas Meter Ball Valve will provide years of maintenance-free service.

Mueller Centurion II Gas Meter Ball Valve features

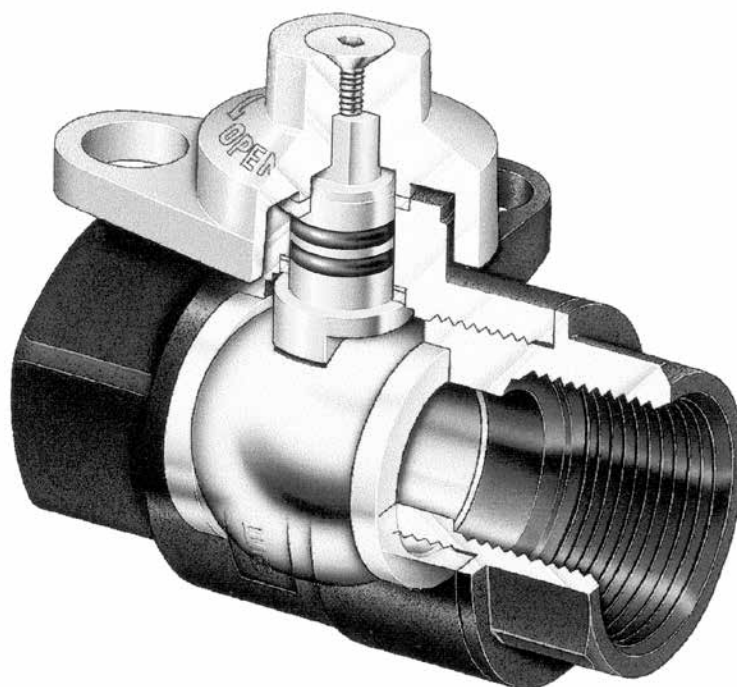

- ❑ **Dual Nitrile O-Rings On Stem** – for maintenance-free sealing at normal and cold temperatures.
- ❑ **Full Diameter Round Port** – provides optimum flow and accepts MUELLER NO-BLO® Valve Changer.
- ❑ **Meets Test Requirements** – as specified in ASME B16.33.
- ❑ **Maximum Pressure Rating** – 200 psig.
- ❑ **Ductile Iron Body** – resists vandalism and eliminates possible hex breakage.
- ❑ **Blow-Out Proof Stem** – design is tamperproof. The stem is positively retained by an integral flange, it is made of brass and sealed with two O-rings.
- ❑ **Gas Compatibility** – dry natural and manufactured gas.
- ❑ **Ball Type Closure Member** – made from nickel/chrome plated brass to provide a positive, long lasting sealing surface. Resilient PTFE primary seals for maintenance-free sealing at normal and cold temperatures.
- ❑ **Improved Tamper-Resistant Design** – makes the MUELLER CENTURION II Gas Meter Ball Valve nearly impossible to disassemble.
- ❑ **Zinc Die Cast Locking Cap** – integral to the valve.

The Mueller Brisco Gas Meter Valve is a special purpose valve that allows a number of operations to be performed at the meter set without the need to interrupt service to the gas customer. With a valve installed on the riser and customer sides, the meter set can be exchanged or pressure tested (both low and elevated pressure systems) using just a regulated by-pass hose with bleeder valve and pressure gauge. An external gas supply is not needed.

With a single Brisco valve installed on the riser side of the meter set, service and main pressure checks can be performed without taking the meter out of service. When only one valve is installed, traditional methods for exchanging the meter must be used, with the Brisco valve providing a reliable source of gas so that an external supply is not needed.

The Mueller Brisco Valve is based upon the Luboseal® valve design, with all its features. The style of Brisco valve designated for use on the riser side of the meter is insulated and available in 3/4" and 1" sizes (this valve is used for both one- valve and two-valve installations). A second style of Brisco valve designated for use on the customer side of the meter is non-insulated and available in 1" size (this valve is only used in two-valve installations).

Mueller Brisco Gas Meter Valve features

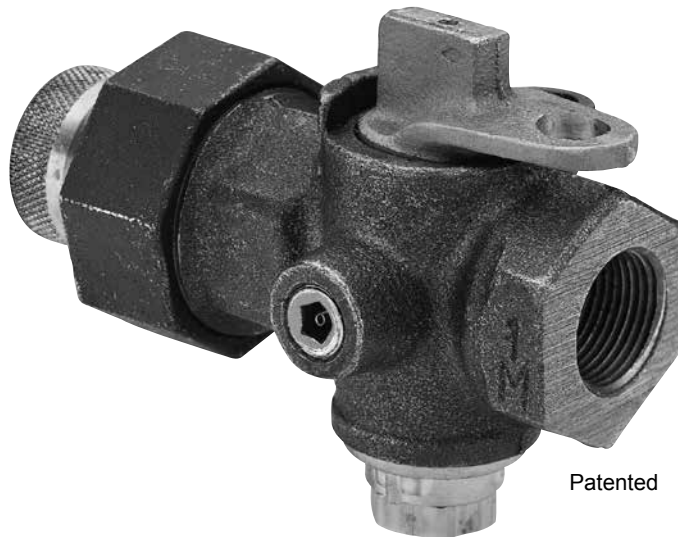

- **Mueller Patented Design** – features O-rings at the top and bottom of the key to put pressure on the grease in the valve so that a film of lubrication is maintained between the internal surfaces for an extended period of time. The O-rings also provide additional assurance against top and bottom leaks and prevent the entry of foreign material into the valve through the top or bottom.
- **Meets Test Requirements** – as specified in ASME B16.33.
- **Tamper-Proof Design** – features a blind-pinned washer to retain the key in the body and a pre-staked nut on the bottom of the stem. Once assembled, the nut can be torqued to specifications without affecting the precise fit between the body and key and destroying the seal between them. The addition of lubrication after assembly adds to the valve's sealing.
- **Lubrication** – helps ensure a gas tight seal and provides easier turning of the key in the body.
- **Tamper-Proof Port** – special hex key required to open access port, discouraging unauthorized tampering or removal.
- **Tested** - every Mueller Tamper-Proof Meter Valve is tested. The valves are submerged in a non-corrosive liquid and air pressure is applied in both the open and closed positions. No leakage is permitted.
- **Maximum Working Pressure** – Brisco valves rated at 100 psig.

Mueller Tamper-Proof Meter Valves are solid head valves designed to prevent unauthorized or unintentional removal of the key or improper adjustment of the stem nut. A heavy bronze washer is blind-pinned to a large boss on the lower end of the key. Minor adjustment of the stem nut is possible by the spring in the pin. The stop will remain operable with the stem nut removed or overtightened to the point of stripping the threads.

These stops are provided with false ports in the key which will line up with the body ports when in the closed position. This design prevents grit or dust from adhering to the seating surfaces of the key and later damaging them. The passageway through the key has flat sides which line up with the body ports, thereby improving the flow characteristics and adding strength to the key. This also reduces the seating contact to only those areas where it is useful, resulting in an easier operating stop.

Mueller Tamperproof Meter Valve Features

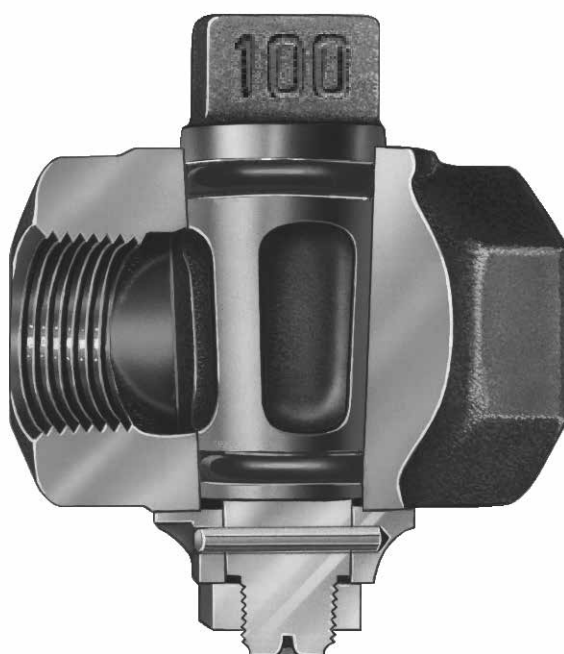

- **Meets Test Requirements** – as specified in ASME B16.33.
- **Maximum Working Pressure** – 100 psig.
- **False Ports** – in the key line up with the flow-way when the valve is closed, trapping foreign material and preventing it from damaging the sealing surface when the valve is turned back on.
- **Tamper-Proof Design** – features a blind-pinned washer to retain the key in the body and a pre-staked nut on the bottom of the stem. Once assembled, the nut can be torqued to specifications without affecting the precise fit between the body and the key.
- **Patented Design** – features O-rings at the top and bottom of the key to put pressure on the grease in the valve so that a film of lubrication is maintained between the internal surfaces for an extended period of time. The O-rings also provide additional assurance against top and bottom leaks and prevent the entry of foreign material into the valve through the top or bottom.
- **Tested** - every Mueller Tamper-Proof Meter Valve is tested. The valves are submerged in a non-corrosive liquid and air pressure is applied in both the open and closed positions. No leakage is permitted.

Mueller Luboseal Meter Valves are available in sizes from 1/2" to 2" for line service pressures of 175 psig and from 3/4" to 2" for 500 psig line pressures in all above ground applications. Proven in over five decades of field use, they provide safe, sure operation and include many features designed to extend the valve's service life.

Mueller Luboseal Gas Meter Valve features

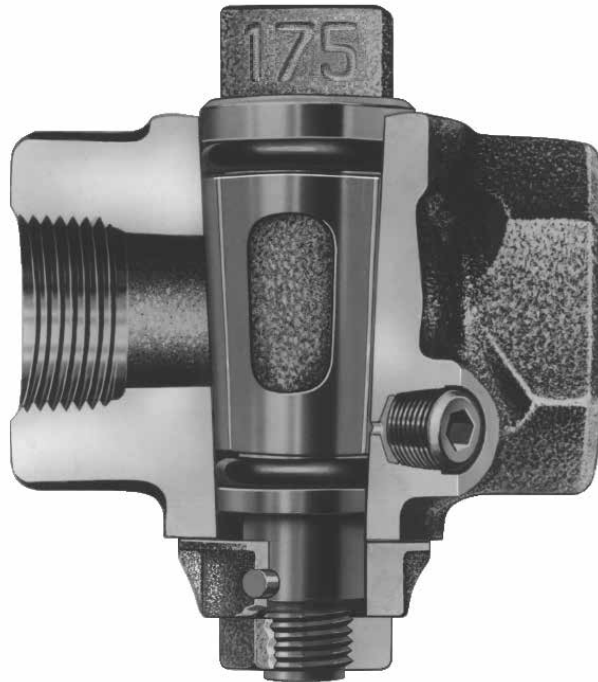

- **Mueller Co.'s Patented Design** – features O-rings at the top and bottom of the key to put pressure on the grease in the valve so that a film of lubrication is maintained between the internal surfaces for an extended period of time. The O-rings also provide additional assurance against top and bottom leaks and prevent the entry of foreign material into the valve through the top or bottom.
- **Meets** – the test requirements specified in ASME B16.33.
- **Maximum Working Pressure** – Luboseal rated at 175 psig. Ductile iron Luboseal rated at 500 psig.
- **Every Mueller LUBOSEAL Meter Valve** – is tested. The valves are submerged in a non-corrosive liquid and air pressure is applied in both the open and closed positions. No leaks are allowed.
- **Lubrication** – helps ensure a gas tight seal and provides easier turning of the key in the body. Luboseal Valves can be relubricated under pressure in both the open and closed positions.
- **False Ports** – in the key line up with the flow-way when the valve is closed, trapping foreign material and preventing it from damaging the sealing surface when the valve is turned back on.
- **Tamper-Proof Design** – features a blind-pinned washer to retain the key in the body and a pre-staked nut on the bottom of the stem. Once assembled, the nut can be torqued to specifications without affecting the precise fit between the body and key and destroying the seal between them. The addition of lubrication after assembly adds to the valve's sealing.

- ☐ Catalog number – **H-11116**
- ☐ Sizes* – 1/2", 3/4", 1", 1-1/4", 1-1/2", 2"
- ☐ Iron body valve
- ☐ Plain head
- ☐ O-ring sealed key
- ☐ Tamperproof feature
- ☐ Inlet and outlet with internal I.P. (F.I.P.) thread
- ☐ Available finishes: black (as cast), galvanized, electro-coat epoxy gray, electro-coat Rustoleum gray
- ☐ 100 psig (690 kPa)
- ☐ Available with 1/8" test port feature optional



H-11116

H-11116 Mueller Tamperproof Meter Valve Dimensions

Dimension	Valve Size*				
	1/2" x 1/2"***	3/4" x 3/4"	1" x 1"	1-1/4" x 1-1/4"	2"
A	1/2"-14	3/4"-14	1"-11-1/2	1-1/4"-11-1/2	2"-11-1/2
B	1-31/64"	1-21/32"	1-15/16"	2-5/16"	3-5/32"
C	2-5/32"	3-5/32"	3-13/16"	4-1/4"	5-9/32"
D	1-5/64"	1-21/64"	1-29/32"	2-1/8"	2-41/64"
E	1-31/64"	2"	2-3/16"	2-19/32"	3-19/64"
F	1-23/64"	1-9/16"	1-27/32"	2-5/32"	2-15/16"
G	45/64"	59/64"	1-11/64"	1-27/64"	1-29/32"

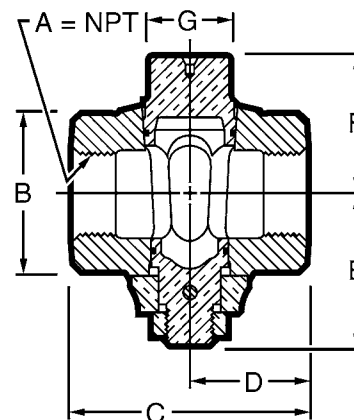

H-11116	Box Quantity
1/2"	28
3/4"	15
1"	15
1-1/4"	10
1-1/2"	5
2"	4

*Nominal

**1/2" size has no O-ring seal between body and key.

Rev. 8-17 Shaded area indicates changes

- ☐ Catalog number – **H-11118**
- ☐ Sizes* – 3/4", 3/4" x 1", 1", 1-1/4", 1-1/2", 2"
- ☐ Meets the test requirements specified in ASME B16.33
- ☐ Iron body valve
- ☐ Lockwing head
- ☐ O-ring sealed key
- ☐ Tamperproof feature
- ☐ Inlet and outlet with internal I.P. (F.I.P.) thread
- ☐ Available finishes: black (as cast), galvanized, electro-coat epoxy gray, electro-coat Rustoleum gray
- ☐ 100 psig (690 kPa)
- ☐ Available with 1/8" test port feature optional

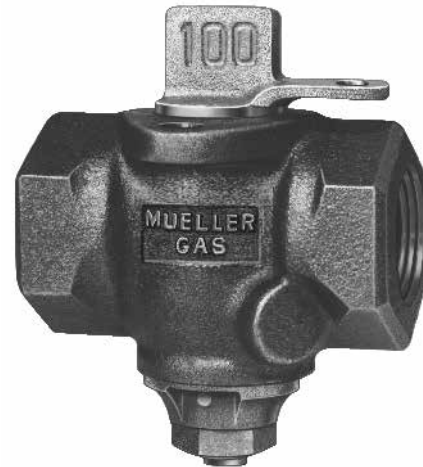
**H-11118****H-11118 Mueller Tamperproof Meter Valve Dimensions**

Dimension	Valve Size*					
	3/4"	3/4" x 1"	1"	1-1/4"	1-1/2"	2"
A	3/4"-14	1"-11-1/2	1"-11-1/2	1-1/4"-11-1/2	1-1/2"-11-1/2	2"-11-1/2
B	1-21/32"	1-21/32"	1-15/16"	2-5/16"	2-11/16"	3-5/32"
C	3-5/32"	3-13/16"	3-13/16"	4-1/4"	4-5/8"	5-9/32"
D	1-37/64"	1-29/32"	1-29/32"	2-1/8"	2-5/16"	2-41/64"
E	2"	2-3/16"	2-3/16"	2-19/32"	2-23/32"	3-19/64"
F	1-51/64"	2-3/32"	2-3/32"	2-21/64"	2-47/64"	3-11/64"
G	59/64"	1-11/64"	1-11/64"	1-27/64"	1-19/32"	1-29/32"

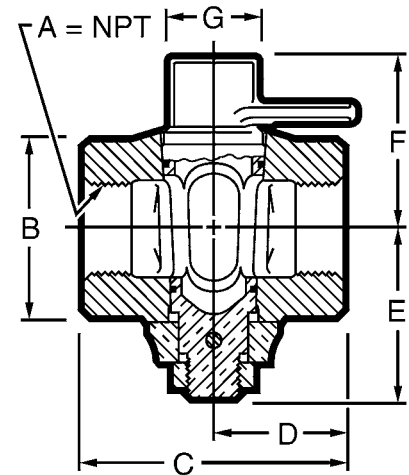

H-11118	Box Quantity
3/4"	15
3/4" x 1"	15
1"	15
1-1/4"	10
1-1/2"	7
2"	4

*Nominal

MUELLER® TAMPER-PROOF METER VALVE - 100 PSIG



14.7

Shaded area indicates change Rev. 8-17

- ☐ Catalog number – **H-11126**
- ☐ Sizes* – 3/4", 1", 1-1/4"
- ☐ Meets the test requirements specified in ASME B16.33
- ☐ Iron body valve
- ☐ Plain head
- ☐ O-ring sealed key
- ☐ Tamper-proof feature
- ☐ Inlet and outlet with internal I.P. (F.I.P.) thread – insulating outlet
- ☐ Available finishes: black (as cast), galvanized, electro-coat epoxy gray, electro-coat Rustoleum gray
- ☐ 100 psig (690 kPa)
- ☐ Available with 1/8" test port feature optional

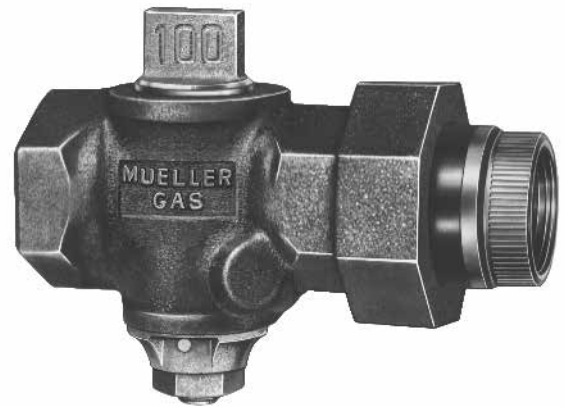

H-11126

H-11126 Mueller Tamperproof Meter Valve Dimensions

Dimension	Valve Size*		
	3/4"	1"	1-1/4"
A	3/4"-14	1"-11-1/2	1-1/4"-11-1/2
B	1-21/32"	1-15/16"	2-5/16"
C	5-13/64"	5-25/32"	6-11/32"
D	3-5/8"	3-7/8"	4-13/64"
E	2"	2-3/16"	2-19/32"
F	1-37/64"	1-55/64"	2-5/32"
G	59/64"	1-11/64"	1-27/64"

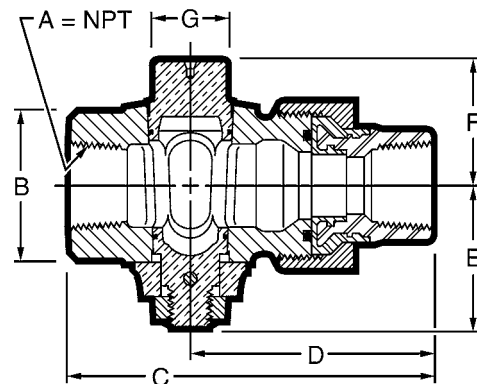

H-11126	Box Quantity
3/4"	15
1"	10
1-1/4"	7

Replacement Parts			
	3/4"	1"	1-1/4"
Steel tailpiece/union	83993	83994	83995
Coupling nut - black	501466	501467	501468
Coupling nut - galvanized	502018	n/a	502409
Union o-ring	40709	79351	501499

*Nominal

Rev. 8-17 Shaded area indicates changes

- ☐ Catalog number – **H-11128**
- ☐ Sizes** – 3/4", 1", 1-1/4"
- ☐ Meets the test requirements specified in ASME B16.33
- ☐ Iron body valve
- ☐ Lockwing head
- ☐ O-ring sealed key
- ☐ Tamperproof feature
- ☐ Inlet and outlet with internal I.P. (F.I.P.) thread – insulating outlet
- ☐ Available finishes: black (as cast), galvanized, electro-coat epoxy gray, electro-coat Rustoleum gray
- ☐ 100 psig (690 kPa)
- ☐ Available with 1/8" test port feature

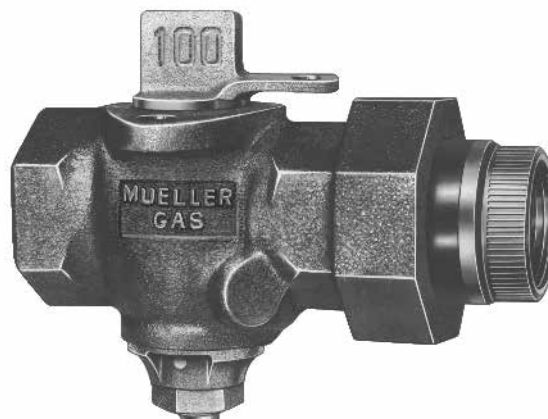
**H-11128****H-11128 Mueller Tamperproof Meter Valve Dimensions**

Dimension	Valve Size**		
	3/4"	1"	1-1/4"
A	3/4"-14	1"-11-1/2	1-1/4"-11-1/2
B	1-21/32"	1-15/16"	2-5/16"
C	5-13/64"	5-25/32"	6-11/32"
D	3-5/8"	3-7/8"	4-13/64"
E	2"	2-3/16"	2-19/32"
F	1-37/64"	1-55/64"	2-5/32"
G	59/64"	1-11/64"	1-27/64"

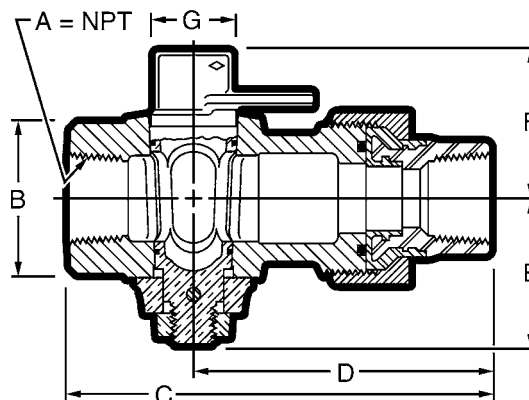

H-11128	Box Quantity
3/4"	15
1"	10
1-1/4"	7

Replacement Parts			
	3/4"	1"	1-1/4"
Steel tailpiece/union	83993	83994	83995
Coupling nut - black	501466	501467	501468
Coupling nut - galvanized	502018	502019	502409
Union o-ring	40709	79351	501499

* First size is size of inlet, second is size of outlet.

**Nominal

- ☐ Catalog number – **H-11170**
- ☐ Sizes* – 1/2", 3/4", 1", 1-1/4", 1-1/2", 2"
- ☐ Meets the test requirements specified in ASME B16.33
- ☐ Iron body valve
- ☐ Plain head
- ☐ Special lubrication system---can be re-lubricated under pressure
- ☐ O-ring sealed key
- ☐ Tamperproof feature
- ☐ Inlet and outlet with internal I.P. (F.I.P.) thread
- ☐ 175 psig (1208 kPa)
- ☐ Available with 1/8" test port feature optional

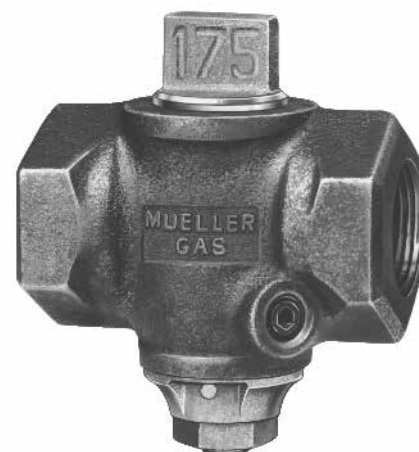

H-11170

Optional Equipment

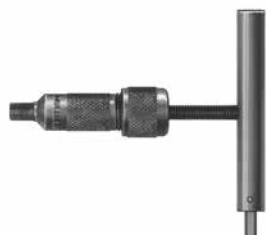

H-11199

H-11199 Relubricating Tool
 Used to relubricate Mueller Luboseal Meter Valves with H-853 lubricant shown below. A hex wrench is built into the tool handle for removal of valve lubricating port pipe plug. One tool fits all valve sizes.



H-853

H-853 Ground Key Lubricant
 Used for dry, natural or manufactured gas, air and vacuum applications. NOT recommended for petroleum solvents, mineral oils or concentrated acids or alkalis.
 Box of 24 #1 sticks

H-11170 MUELLER LUBOSEAL Meter Valve Dimensions

Dimension	Valve Size*					
	1/2"	3/4"	1"	1-1/4"	1-1/2"	2"
A	1/2"-14	3/4"-14	1-11/12"	1-1/4"-11-1/2"	1-1/2"-11-1/2"	2"-11-1/2"
B	1-1/2"	1-29/32"	2-15/64"	2-43/64"	3-7/64"	3-41/64"
C	2-13/16"	3-5/32"	3-13/16"	4-1/4"	4-5/8"	5-9/32"
D	1-13/32"	1-37/64"	1-29/32"	2-1/8"	2-5/16"	2-41/64"
E	1-37/64"	1-31/32"	2-5/32"	2-9/16"	2-11/16"	3-17/64"
F	1-9/32"	1-39/64"	1-57/64"	2-3/16"	2-35/64"	2-31/32"
G	3/4"	59/64"	1-11/64"	1-27/64"	1-19/32"	1-29/32"

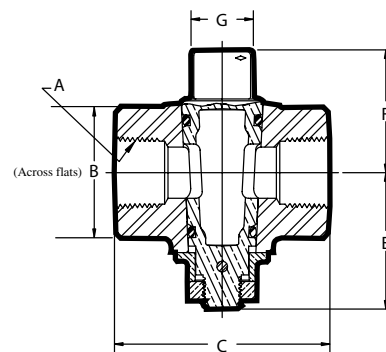

H-11170	Box Quantity
1/2"	25
3/4"	15
1"	15
1-1/4"	10
1-1/2"	5
2"	4

*Nominal

Rev. 8-17 Shaded area indicates changes

- ☐ Catalog number – **H-11175**
- ☐ Sizes* – 1/2", 3/4", 1", 1-1/4", 1-1/2", 2"
- ☐ Meets the test requirements specified in ASME B16.33
- ☐ Iron body valve
- ☐ Lockwing head
- ☐ Special lubrication system---can be re-lubricated under pressure
- ☐ O-ring sealed key
- ☐ Tamperproof feature
- ☐ Inlet and outlet with internal I.P. (F.I.P.) thread
- ☐ Available finishes: black (as cast), galvanized, electro-coat epoxy gray, electro-coat Rustoleum gray
- ☐ 175 psig (1208 kPa)
- ☐ Available with 1/8" test port feature

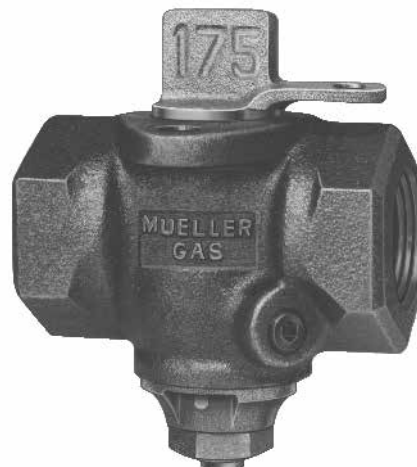
**H-11175**

Optional Equipment

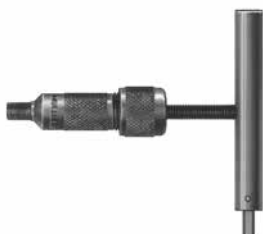
**H-11199**

H-11199 Relubricating Tool
 Used to relubricate Mueller Luboseal Meter Valves with H-853 lubricant shown below. A hex wrench is built into the tool handle for removal of valve lubricating port pipe plug. One tool fits all valve sizes.

**H-853**

H-853 Ground Key Lubricant

Used for dry, natural or manufactured gas, air and vacuum applications. NOT recommended for petroleum solvents, mineral oils or concentrated acids or alkalies.

Box of 24 #1 sticks

H-11175 Mueller Luboseal Meter Valve Dimensions

Dimension	Valve Size**					
	1/2"	3/4"	1"	1-1/4"	1-1/2"	2"
A	1/2"-14	3/4"-14	1"-11-1/2	1-1/4"-11-1/2	1-1/2"-11-1/2	2"-11-1/2
B	1-1/2"	1-29/32"	2-15/64"	2-43/64"	3-7/64"	3-41/64"
C	2-13/16"	3-5/32"	3-13/16"	4-1/4"	4-5/8"	5-9/32"
D	1-13/32"	1-37/64"	1-29/32"	2-1/8"	2-5/16"	2-41/64"
E	1-37/64"	1-31/32"	2-5/32"	2-9/16"	2-11/16"	3-17/64"
F	1-9/32"	1-39/64"	1-57/64"	2-3/16"	2-35/64"	2-31/32"
G	3/4"	59/64"	1-11/64"	1-27/64"	1-19/32"	1-29/32"

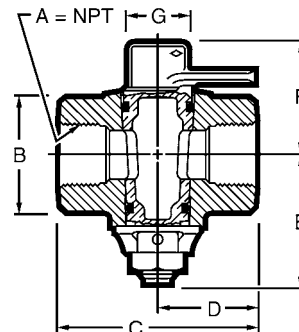

H-11175	Box Quantity
1/2"	25
1/2"x3/4"x3/4"	15
3/4"	15
1"	15
1-1/4"	10
1-1/2"	7
2"	4

*First size is size of inlet, second is size of outlet

*Nominal

- ☐ Catalog number – **H-11174**
- ☐ Sizes* – 3/4", 1", 1-1/4", 2"
- ☐ Meets the test requirements specified in ASME B16.33
- ☐ Iron body valve
- ☐ Plain head
- ☐ Special lubrication system – can be re-lubricated under pressure
- ☐ O-ring sealed key
- ☐ Tamperproof feature
- ☐ Inlet and outlet with internal I.P. (F.I.P.) thread – insulating outlet
- ☐ Available finishes: black (as cast), galvanized, electro-coat epoxy gray, electro-coat Rustoleum gray
- ☐ 175 psig (1208 kPa)
- ☐ Available with 1/8" test port feature



H-11174

Optional Equipment

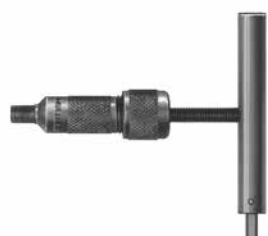

H-11199

H-11199 Relubricating Tool
 Used to relubricate Mueller Luboseal Meter Valves with H-853 lubricant shown below. A hex wrench is built into the tool handle for removal of valve lubricating port pipe plug. One tool fits all valve sizes.



H-853

H-853 Ground Key Lubricant
 Used for dry, natural or manufactured gas, air and vacuum applications. NOT recommended for petroleum solvents, mineral oils or concentrated acids or alkalis.
 Box of 24 #1 sticks

H-11174 Mueller Luboseal Meter Valve Dimensions

Dimension	Valve Size*			
	3/4"	1"	1-1/4"	2"
A	3/4"-14	1"-11-1/2	1-1/4"-11-1/2	2"-11-1/2
B	1-29/32"	2-15/64"	2-43/64"	3-41/64"
C	5-13/64"	5-25/32"	6-11/32"	7-21/64"
D	3-5/8"	3-7/8"	4-7/32"	4-11/16"
E	2-1/16"	2-1/4"	2-23/32"	3-3/16"
F	1-49/64"	2-1/32"	2-11/32"	2-31/32"
G	59/64"	1-11/64"	1-27/64"	1-29/32"

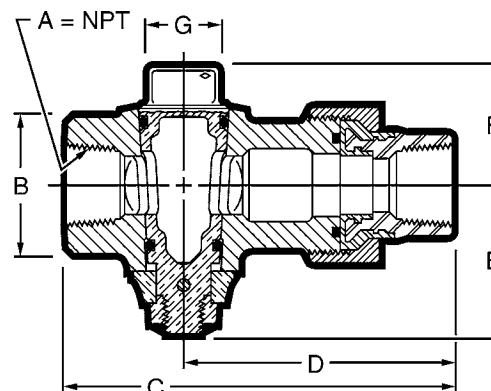

H-11174	Box Quantity
3/4"	15
1"	10
1-1/4"	7
2"	3

Replacement Parts				
	3/4"	1"	1-1/4"	2"
Steel tailpiece/union	83993	83994	83995	581308
Coupling nut - black	501466	501467	501468	528151
Coupling nut - galvanized	502018	N/A	N/A	506153
Union o-ring	40709	79351	501499	51329

*Nominal

Rev. 8-17 Shaded area indicates changes

- ☐ Catalog number – **H-11179**
- ☐ Sizes** – 1/2"x1/2"x3/4"*, 3/4", 1", 1-1/4", 2"
- ☐ Meets the test requirements specified in ASME B16.33
- ☐ Iron body valve
- ☐ Lockwing head
- ☐ Special lubrication system---can be re-lubricated under pressure
- ☐ O-ring sealed key
- ☐ Tamperproof feature
- ☐ Inlet and outlet with internal I.P. (F.I.P.) thread – insulating outlet
- ☐ Available finishes: black (as cast), galvanized, electro-coat epoxy gray, electro-coat Rustoleum gray – 1/2"x1/2"x3/4" size available in galvanized only
- ☐ 175 psig (1208 kPa)
- ☐ Available with 1/8" test port feature

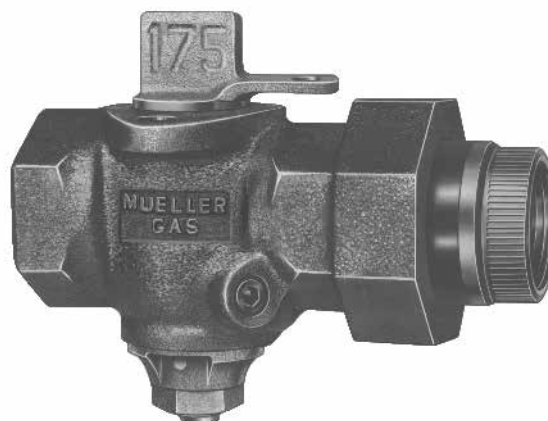
**H-11179**

Optional Equipment

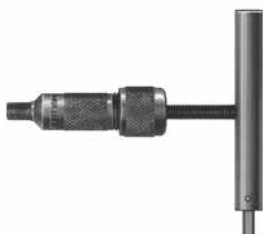
**H-11199**

H-11199 Relubricating Tool
 Used to relubricate Mueller Luboseal Meter Valves with H-853 lubricant shown below. A hex wrench is built into the tool handle for removal of valve lubricating port pipe plug. One tool fits all valve sizes.

**H-853**

H-853 Ground Key Lubricant

Used for dry, natural or manufactured gas, air and vacuum applications. NOT recommended for petroleum solvents, mineral oils or concentrated acids or alkalis.

Box of 24 #1 sticks

H-11179 Mueller Luboseal Meter Valve Dimensions

Dimension	Valve Size**				
	1/2" x 1/2" x 3/4"*	3/4"	1"	1-1/4"	2"
A	1/2"-14 x 3/4"-14	3/4"-14	1"-11-1/2	1-1/4"-11-1/2	2"-11-1/2
B	1-35/64"	1-27/32"	2-15/64"	2-43/64"	3-5/32"
C	5-1/32"	5-13/64"	5-25/32"	6-11/32"	7-21/64"
D	3-5/8"	3-5/8"	3-7/8"	4-7/32"	4-11/16"
E	1-37/64"	1-31/32"	2-5/32"	2-9/16"	3-17/64"
F	1-17/32"	1-52/64"	2-1/8"	2-23/64"	3-3/16"
G	3/4"	59/64"	1-11/64"	1-27/64"	1-29/32"

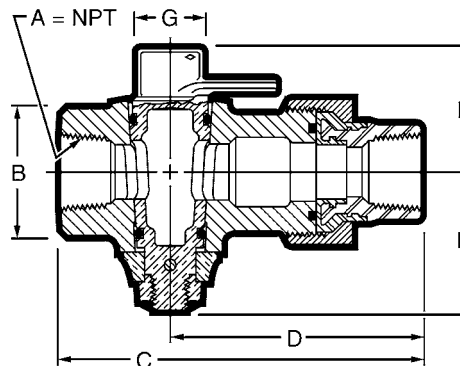

H-11179	Box Quantity
1/2"x1/2"x3/4"	12
3/4"	15
1"	10
1-1/4"	7
2"	3

Replacement Parts				
	3/4"	1"	1-1/4"	2"
Steel tailpiece/union	83993	83994	83995	581308
Coupling nut - black	501466	501467	501468	528151
Coupling nut - galvanized	502018	502019	502409	506153
Union o-ring	40709	79351	501499	51329

*First size is size of inlet, second is size of outlet – when three sizes are given, second size is nominal size of port opening.

*Nominal

- ☐ Catalog number – **H-11180**
- ☐ Sizes* – 3/4", 1", 1-1/4"
- ☐ Meets the test requirements specified in ASME B16.33
- ☐ Ductile iron body valve
- ☐ Plain head
- ☐ Special lubrication system---can be re-lubricated under pressure
- ☐ Quad-ring sealed key
- ☐ Tamperproof feature
- ☐ Inlet and outlet with recessed internal I.P. (F.I.P.) thread
- ☐ Available finishes: black (as cast), galvanized, electro-coat epoxy gray, electro-coat Rustoleum gray
- ☐ 500 psig (3450 kPa)
- ☐ Available with 1/8" test port feature



H-11180

Optional Equipment

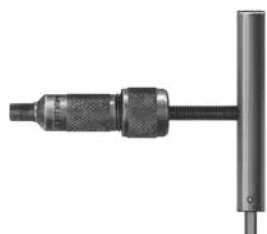

H-11199

H-11199 Relubricating Tool
 Used to relubricate Mueller Luboseal Meter Valves with H-853 lubricant shown below. A hex wrench is built into the tool handle for removal of valve lubricating port pipe plug. One tool fits all valve sizes.



H-853

H-853 Ground Key Lubricant
 Used for dry, natural or manufactured gas, air and vacuum applications. NOT recommended for petroleum solvents, mineral oils or concentrated acids or alkalis.
 Box of 24 #1 sticks

H-11180 Mueller Luboseal Meter Valve Dimensions

Dimension	Valve Size*		
	3/4"	1"	1-1/4"
A	3/4"-14	1"-11-1/2	1-1/4"-11-1/2
B	1-7/8"	2-11/32"	2-7/8"
C	4-7/16"	5-3/16"	5-3/4"
D	2-7/32"	2-19/32"	2-7/8"
E	2-11/64"	2-19/64"	2-7/8"
F	2-3/64"	2-11/32"	2-25/32"
G	59/64"	1-11/64"	1-27/64"

H-11180	Box Quantity
3/4"	10
1"	6
1-1/4"	6

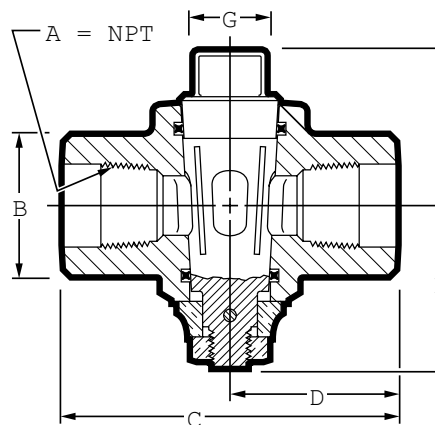

*Nominal

Rev. 8-17 Shaded area indicates changes

- ☐ **Catalog number – H-11185**
- ☐ Sizes**– 1/2"x3/4"*, 3/4", 1", 1-1/4", 2"
- ☐ Meets the tested requirements specified in ASME B16.33
- ☐ Ductile iron body valve
- ☐ Lockwing head
- ☐ Special lubrication system---can be re-lubricated under pressure
- ☐ Quad-ring sealed key
- ☐ Tamperproof feature
- ☐ Inlet and outlet with recessed internal I.P. (F.I.P.) thread
- ☐ Available finishes: black (as cast), galvanized, electro-coat epoxy gray, electro-coat Rustoleum gray
- ☐ 500 psig (3450 kPa)
- ☐ Available with 1/8" test port feature

**H-11185**

Optional Equipment

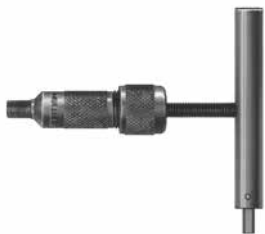
**H-11199**

H-11199 Relubricating Tool
 Used to relubricate Mueller Luboseal Meter Valves with H-853 lubricant shown below. A hex wrench is built into the tool handle for removal of valve lubricating port pipe plug. One tool fits all valve sizes.

**H-853**

H-853 Ground Key Lubricant

Used for dry, natural or manufactured gas, air and vacuum applications. NOT recommended for petroleum solvents, mineral oils or concentrated acids or alkalies.

Box of 24 #1 sticks

H-11185 Mueller Luboseal Meter Valve Dimensions

Dimension	Valve Size**				
	1/2" x 3/4"***	3/4"	1"	1-1/4"	2"
A	1/2"-14 x 3/4" -14	3/4"-14	1"-11-1/2	1-1/4"-11-1/2	2"-11-1/2
B	1-27/32"	1-27/32"	2-15/64"	2-43/64"	3-31/32"
C	4-7/16"	4-7/16"	5-3/16"	5-3/4"	6-3/4"
D	2-7/32"	2-7/32"	2-1/32"	2-7/8"	3-3/8"
E	2-11/64"	2-11/64"	2-9/64"	2-7/8"	3-1/2"
F	2-11/32"	2-11/32"	2-5/8"	3-1/16"	3-13/16"
G	59/64"	59/64"	1-11/64"	1-27/64"	1-29/32"

H-11185	Box Quantity
1/2"x1/2"x3/4"	10
3/4"	10
1"	6
1-1/4"	5
2"	2

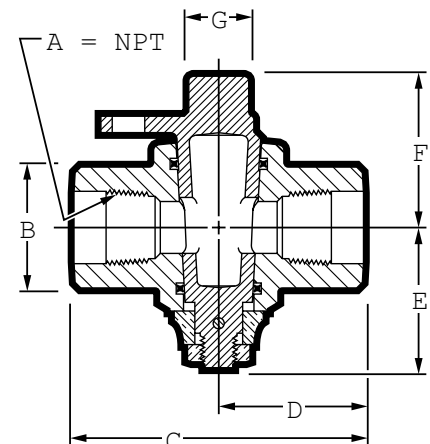

*First size is size of inlet, second is size of outlet.

**Nominal

MUELLER® LUBOSEAL® DOUBLE LOCKWING METER VALVE - 175 PSIG



14.15

Shaded area indicates change Rev. 8-17

- ☐ Catalog number – H-11195
- ☐ Sizes* – 1" and 2"
- ☐ Meets the test requirements specified in ASME B16.33
- ☐ Iron body valve
- ☐ Double lockwing head
- ☐ Special lubrication system---can be re-lubricated under pressure
- ☐ O-ring sealed key
- ☐ Tamperproof feature
- ☐ Inlet and outlet with internal I.P. (F.I.P.) thread
- ☐ Available finishes: black (as cast), galvanized, electro-coat epoxy gray, electro-coat Rustoleum gray
- ☐ 175 psig (1208 kPa)
- ☐ Available with 1/8" test port feature



H-11195

Optional Equipment

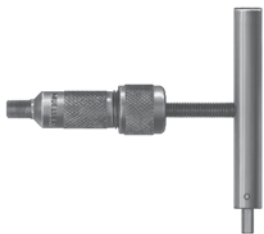

H-11199

H-11199 Relubricating Tool
Used to relubricate Mueller Luboseal Meter Valves with H-853 lubricant shown below. A hex wrench is built into the tool handle for removal of valve lubricating port pipe plug. One tool fits all valve sizes.

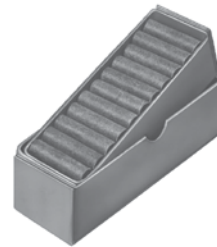

H-853

H-853 Ground Key Lubricant
Used for dry, natural or manufactured gas, air and vacuum applications. NOT recommended for petroleum solvents, mineral oils or concentrated acids or alkalis.
Box of 24 #1 sticks

H-11195 Mueller Luboseal Meter Valve Dimensions

Dimension		
	1"	2"
A	1"-11-1/2"	2"-11-1/2"
B	2-15/64"	3-41/64"
C	3-13/16"	5-9/32"
D	1-29/32"	2-41/64"
E	2-5/32"	3-17/64"
F	1-57/64"	2-31/32"
G	1-11/64"	1-29/32"

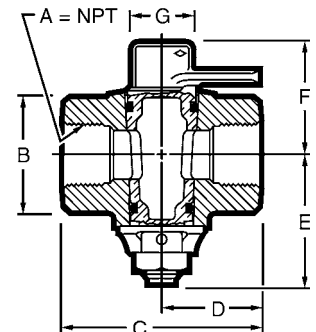

H-11195	Box Quantity
1"	10
2"	4

*Nominal

Rev. 8-17 Shaded area indicates changes

- ☐ Catalog number – **H-11475**
- ☐ Size* – 1"
- ☐ Meets the test requirements specified in ASME B16.33
- ☐ Iron body valve
- ☐ Tamper proof design
- ☐ O-ring sealed key
- ☐ Special lubrication system – can be re-lubricated under pressure
- ☐ Exclusive tamper-proof by pass feature
- ☐ Available in black (as cast) or galvanized finish
- ☐ 100 psig (689 kPa)

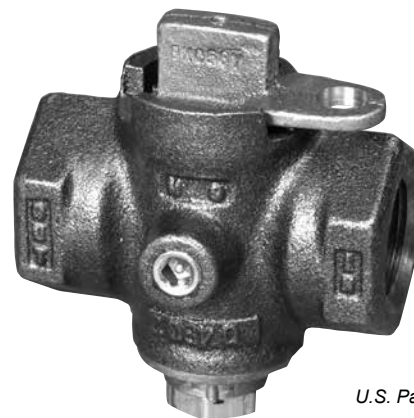

U.S. Patented

H-11475

Optional Equipment

**H-11199**

H-11199 Relubricating Tool
 Used to relubricate Mueller Luboseal Meter Valves with H-853 lubricant shown below. A hex wrench is built into the tool handle for removal of valve lubricating port pipe plug. One tool fits all valve sizes.

**H-853**

H-853 Ground Key Lubricant
 Used for dry, natural or manufactured gas, air and vacuum applications. NOT recommended for petroleum solvents, mineral oils or concentrated acids or alkalis. Box of 24 #1 sticks

**529195**

529195 Wrench used to remove tamper-proof by pass plugs on all Brisco By pass Meter Valves

H-11475 Mueller Brisco By pass Meter Valve Dimensions

Dimension	Valve Size*
	1"
A	1"
B	1-15/16"
C	3-53/64"
D	1-29/32"
E	2-5/32"
F	2-1/8"

H-11475	Box Quantity
1"	15

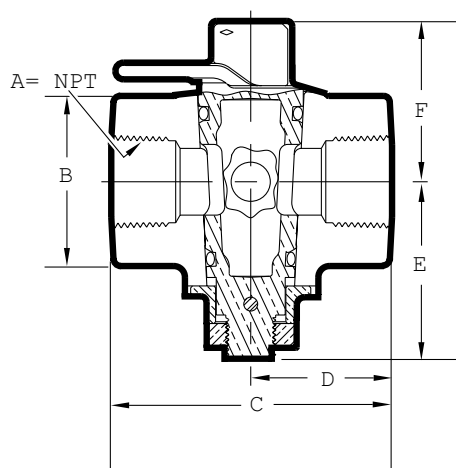

*Nominal

MUELLER® BRISCO™ BY PASS METER VALVE (FOR RISER SIDE) - 100 PSIG



14.17

Shaded area indicates change Rev. 8-17

- ☐ Catalog number – H-11479
- ☐ Sizes* – 3/4", 1"
- ☐ Meets all applicable parts of D.O.T./CFR TITLE 49 PART 192 and ASME B16.33
- ☐ Iron body valve
- ☐ Tamper proof feature
- ☐ O-ring sealed key
- ☐ Special lubrication system – can be re-lubricated under pressure
- ☐ Exclusive tamper-proof by pass feature
- ☐ Available in black (as cast) or galvanized finish
- ☐ Insulated Union Outlet
- ☐ 100 psig (689 kPa)

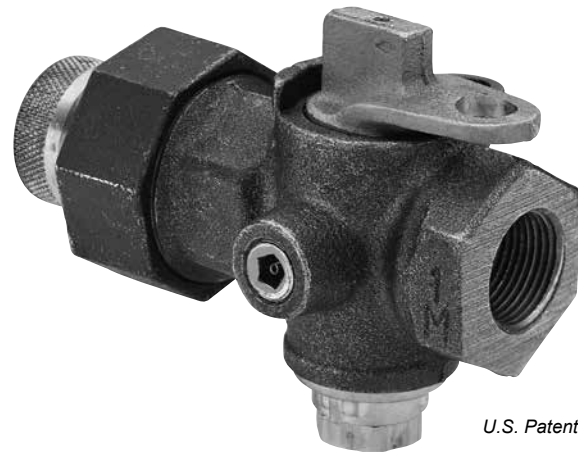

U.S. Patented

H-11479

Optional Equipment



H-11199

H-11199 Relubricating Tool
Used to relubricate Mueller Luboseal Meter Valves with H-853 lubricant shown below. A hex wrench is built into the tool handle for removal of valve lubricating port pipe plug. One tool fits all valve sizes.



H-853

H-853 Ground Key Lubricant
Used for dry, natural or manufactured gas, air and vacuum applications. NOT recommended for petroleum solvents, mineral oils or concentrated acids or alkalis. Box of 24 #1 sticks



529195

529195 Wrench used to remove tamper-proof by pass plugs on all Brisco By pass Meter Valves

H-11479 Mueller Brisco By pass Meter Valve Dimensions

Dimension	Valve Size*	
	3/4"	1"
A	3/4"	1"
B	1-21/32"	1-15/16"
C	5-13/64"	5-25/32"
D	3-5/8"	3-7/8"
E	2"	2-5/32"
F	1-3/16"	2-1/8"

H-11479	Box Quantity
3/4"	15
1"	10

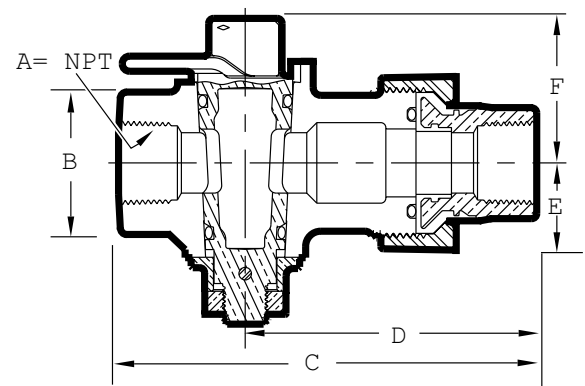

Replacement Parts		
	3/4"	1"
Steel tailpiece/union	83993	83994
Coupling nut - black	501466	501467
Coupling nut - galvanized	502018	502019
Union o-ring	40709	79351

*Nominal

Rev. 8-17 Shaded area indicates changes

- ☐ Catalog number – **B-31175**
- ☐ Sizes* – 3/4", 1"
- ☐ Meets test requirements specified in ASME B16.33
- ☐ Tamper proof design
- ☐ Ductile Iron body
- ☐ Dual O-ring sealed stem
- ☐ Integral locking cap
- ☐ Cationic Epoxy Electrocoat inside and outside
- ☐ PTFE seats
- ☐ Nickel/Chrome plated brass ball
- ☐ 200 psig (1380 kPa)

**B-31175****B-31175 Mueller Centurion II Meter Valve Dimensions**

Dimension	Valve Size*	
	3/4"	1"
A	3/4"	1"
B	1-29/64"	1-7/8"
C	2-15/16"	3-31/64"
D	1-3/8"	1-43/64"
E	23/32"	15/16"
F	1-53/64"	1-63/64"

B-31175	Box Quantity
3/4"	18
1"	16

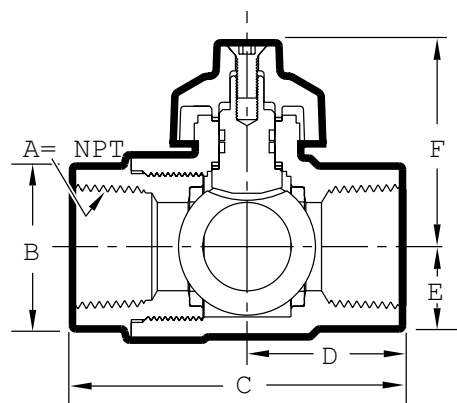

*Nominal

MUELLER® CENTURION II™
GAS METER BALL VALVE- 500 PSIG



14.19

Shaded area indicates change Rev. 8-17

- ☐ Catalog number – **B-3117565**
- ☐ Sizes* – 3/4"
- ☐ Meets test requirements specified in ASME B16.33
- ☐ Tamper proof design
- ☐ Ductile Iron body
- ☐ Dual O-ring sealed stem
- ☐ Integral locking cap
- ☐ Cationic Epoxy Electrocoat inside and outside
- ☐ PTFE seats
- ☐ Nickel/Chrome plated brass ball
- ☐ 500 psig (3447 kPa)



B-3117565

B-3117565 Mueller Centurion II Meter Valve Dimensions

Dimension	Valve Size* 3/4"
A	3/4"
B	1-29/64"
C	2-15/16"
D	1-3/8"
E	23/32"
F	1-53/64"

B-3117565	Box Quantity
3/4"	18

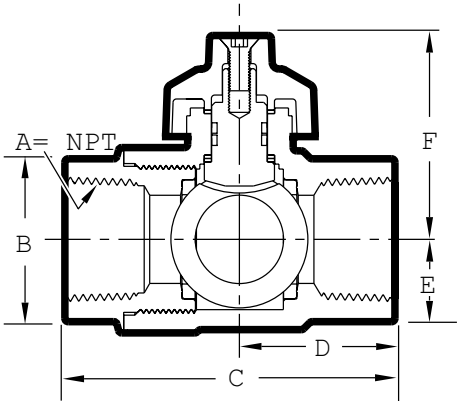

*Nominal

Rev. 8-17 Shaded area indicates changes

- ☐ Catalog number – **B-31179**
- ☐ Sizes* – 3/4", 1"
- ☐ Meets test requirements specified in ASME B16.33
- ☐ Tamper proof design
- ☐ Ductile iron body
- ☐ Dual O-ring sealed stem
- ☐ Integral locking cap
- ☐ Cationic Epoxy Electrocoat inside and outside
- ☐ PTFE seats
- ☐ Nickel/Chrome plated brass ball
- ☐ Insulated union outlet
- ☐ 200 psig (1380 kPa)
- ☐ Available finishes: 1-step gray epoxy

**B-31179****B-31179 Mueller Centurion II Meter Valve Dimensions**

Dimension	Valve Size*	
	3/4"	1"
A	3/4"	1"
B	1-29/64"	1-7/8"
C	5-1/6"	5-17/32"
D	3-29/64"	3-23/32"
E	49/64"	15/16"
F	1-53/64"	1-63/64"

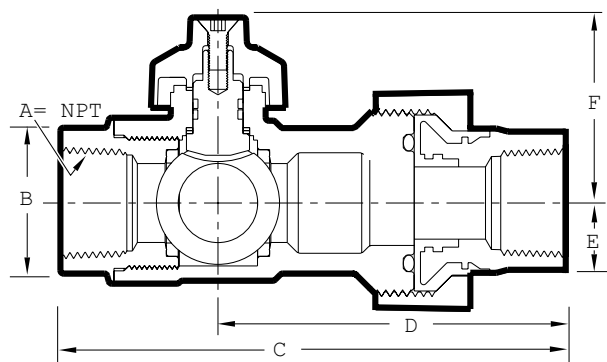

B-31179	Box Quantity
3/4"	20
1"	16

Replacement Parts		
	3/4"	1"
Steel tailpiece/union	83993	83994
Coupling nut - E-coated	528241	528386
Coupling nut - 1-step epoxy	538460	538461
Union o-ring	40709	79351

*Nominal

MUELLER® GAS METER BALL VALVE- 720 PSIG



14.21

Shaded area indicates change Rev. 8-17

- ☐ Catalog number – **B-31185**
- ☐ Sizes* – 3/4", 1"
- ☐ Meets test requirements specified in ASME B16.33
- ☐ Ductile Iron body
- ☐ Dual O-ring sealed stem
- ☐ Cationic Epoxy Electrocoat inside and outside
- ☐ PTFE seats
- ☐ Nickel/Chrome plated brass ball
- ☐ 720 psig (4964 kPa)

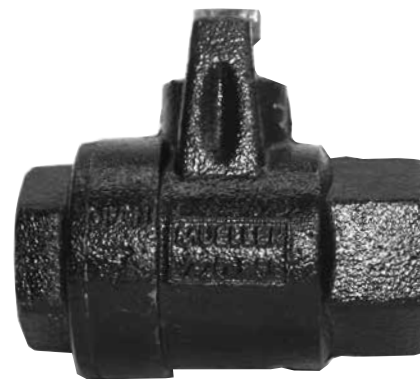

B-31185

B-31185 Meter Valve Dimensions

Dimension	Valve Size*	
	3/4"	1"
A	3/4	1"
B	2-5/16	2-5/16
C	3-53/64	3-53/64
D	1-15/16	1-15/16
E	1-5/32	1-5/32
F	2-13/32	2-13/32

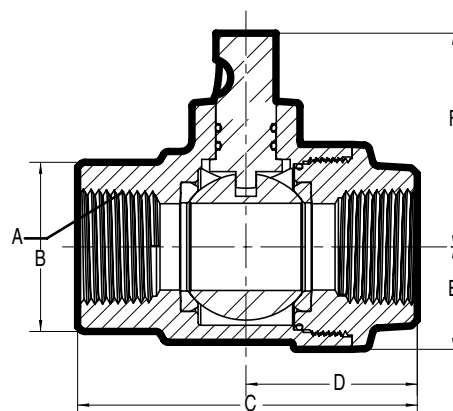

B-31185	Box Quantity
3/4"	10
1"	16

*Nominal

Rev. 8-17 Shaded area indicates changes

**Mueller Shur Stop FIP x FIP**

Non-directional flow; for Natural or LP gases; meets test requirements specified in ANSI B16.33; optional test taps at inlet and/or outlet; 175 psig (1208 kPa).

	Catalog Numbers	
	805002	805006
Body:	Black	Black
Size:	3/4"	1"
Weight (each):	2.9 lbs.	3.5 lbs.

**Mueller Shur Stop**

FIP x Wedgesal™ Insulated Union†
 Non-directional flow; for Natural or LP gases; meets test requirements specified in ANSI B16.33; optional test taps at inlet and/or outlet; 175 psig (1208 kPa).

	Catalog Numbers
	805000
Body:	Black
Pipe size:	3/4"
Weight (each):	3.6 lbs.

Replacement Parts	
	3/4"
Steel tailpiece/union	071197-5
Coupling nut - black	017814-1
Union o-ring	15294

Steel Dome Locking Device

The LOK-DOME™ locking device is made of hardened steel, with a zinc plated yellow chromate treatment. It fits over the Shur Stop valve head, shielding it from hammering, sawing or prying. One size fits both 3/4" and 1" Shur Stop valves. A two piece barrel locking pin is available that can be used with or without the LOK-DOME cap to lock-off Shur Stop valves. A special key is used to lock and unlock the device.



**71152
 LOK-DOME Cap**

* Includes an 1/8" steel recessed hex head pipe plug on side at inlet.

† Tailpiece of Wedgesal insulated union is brass. A 3/4" female NPT tailpiece is available in zinc plated steel.

++ Available in minimum quantities. Contact Customer Service for availability.

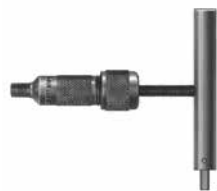

H-11199

H-11199 Relubricating Tool used to relubricate Mueller Luboseal® and Brisco™ Meter Valves with H-853 lubricant shown below. A hex wrench is built into the tool handle for removal of valve lubricating port pipe plug. One tool fits all valve sizes.



H-853

H-853 Ground Key Lubricant
Used for dry natural or manufactured gas, air and vacuum applications. NOT recommended for petroleum solvents, mineral oils or concentrated acids or alkalies. Box of 24 #1 sticks.



(valve not included)

Steel Yoke Locking Device
Can be used on the following 3/4" and 1" plain head Mueller® Gas meter valves (or meter valves of equivalent dimensions) to lock them in the closed position: H-11170, H-11174, H-11116, and H-11126. This device consists of a case hardened steel yoke that fits over the closed meter valve, a two piece parrel locking pin that secures the yoke to the valve, and a special key is used to lock and unlock the device. The yoke fits both 3/4" and 1" valves.

Yoke only: 507050
Barrel Locking pin only: 507049
Key only: 504980



(stop not included)

H-11090

H-11090 Lock wing sealing device
Is used with lock wings drilled 1/2". This device consists of two parts; collar and screw (H-11091) and a 15/32" O.D. pin (H-11092). This device is used to detect unauthorized use.



H-11091



H-11092



H-11093
(valve not included)

Iron Yoke Locking Device
Provides a method of locking the following plain head Mueller Gas meter valves (or meter valves of equivalent dimensions): H-11170, H-11174, H-11116, and H-11126. This device consists of an iron yoke that fits over the inlet hex and the key head of the closed valve, and a two piece barrel locking pin that secures the yoke to the valve body. A special key is required to operate the lock.

Part name	Size	
	3/4"	1"
Yoke	504976	504977
Locking pin	504978	504979
Key	504980	504980

14.24



**MUELLER® GAS
METER BALL VALVES**

Rev. 8-17 Shaded area indicates changes



Reliable Connections™

www.muellergas.com • moreinfo@muellercompany.com
