

INSTALLATION INSTRUCTIONS

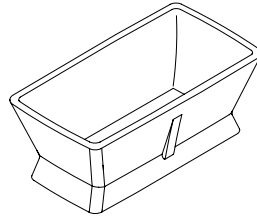

P50204

INSTALLATION INSTRUCTIONS

THANK YOU FOR CHOOSING KALLISTA

We appreciate your commitment to KALLISTA quality products. Please take a moment to review this manual before you install your KALLISTA product. If you encounter any installation or performance problems, please do not hesitate to contact us at the phone number listed at the bottom of the page.

BEFORE YOU BEGIN

⚠ CAUTION: Risk of personal injury. This bath is extremely heavy. Obtain sufficient help **and** use lifting straps to carefully lift or move the bath.

IMPORTANT! To ensure a successful installation, it is important that you install the bath on a level finished floor.

- Observe all local plumbing and building codes.

IMPORTANT! The drain cover and gaskets are included in a small box within the carton. Make sure you locate and retain the small box before discarding the carton and packing material.

- Unpack and inspect the bath for damage. Return the bath to the carton until installation.
- To simplify future maintenance, make sure all plumbing connections around the bath are easily accessible.
- This bath is heavy and will not easily fit through doorways. Carefully plan how to move the bath into the installation area.
- Install the bath to an adequately supported, level finished floor.
- This bath is designed for a freestanding installation only.
- This bath features a factory-installed drain and an integral, cast overflow.
- Install a floor- or ceiling-mount bath filler with this freestanding bath.
- This bath conforms to CSA B45.5/IAPMO Z124.
- KALLISTA reserves the right to make revisions in the design of products without notice, as specified in the Price Book.

TOOLS AND MATERIALS

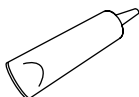
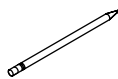
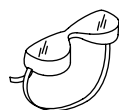

Silicone Sealant

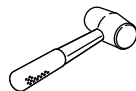
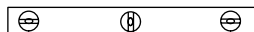

Rubber Mallet

Plus:

- Drop cloth
- Lifting straps
- Shims
- 2x4s
- Common woodworking tools
- Short Ø 1-1/2" PVC pipe or coupling

INSTALLATION INSTRUCTIONS

1. PREPARE THE SITE

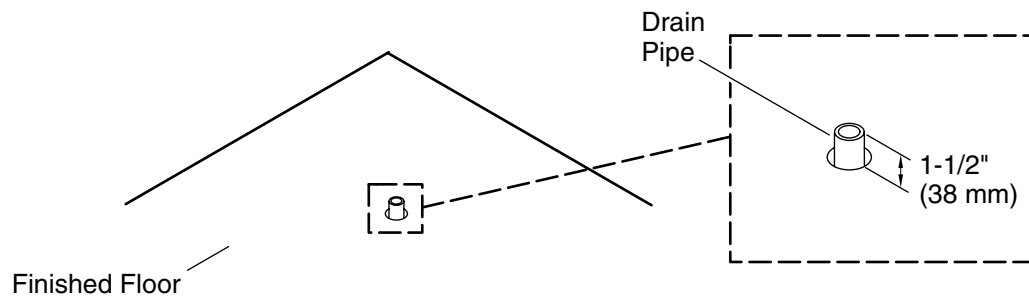

NOTICE: Provide adequate floor support.

NOTICE: Measure your product for site preparation. Visit the product page at www.kallista.com for more information.

- Determine the location of the bath.
- Position the bath so that it is oriented as desired, with the overflow side of the bath facing the preferred direction.
- Make sure the subfloor offers adequate support for your bath.
- Ensure the subfloor is level.

IMPORTANT! To ensure a successful installation, it is critical that you install the bath on a level finished floor.

- Install the finished floor material.
- Make sure the finished floor is level before proceeding.
- Position and install a standard PVC or brass bath drain pipe. Install the drain pipe so it extends 1-1/2" (38 mm) above the finished floor.

INSTALLATION INSTRUCTIONS

2. INSTALL THE BATH

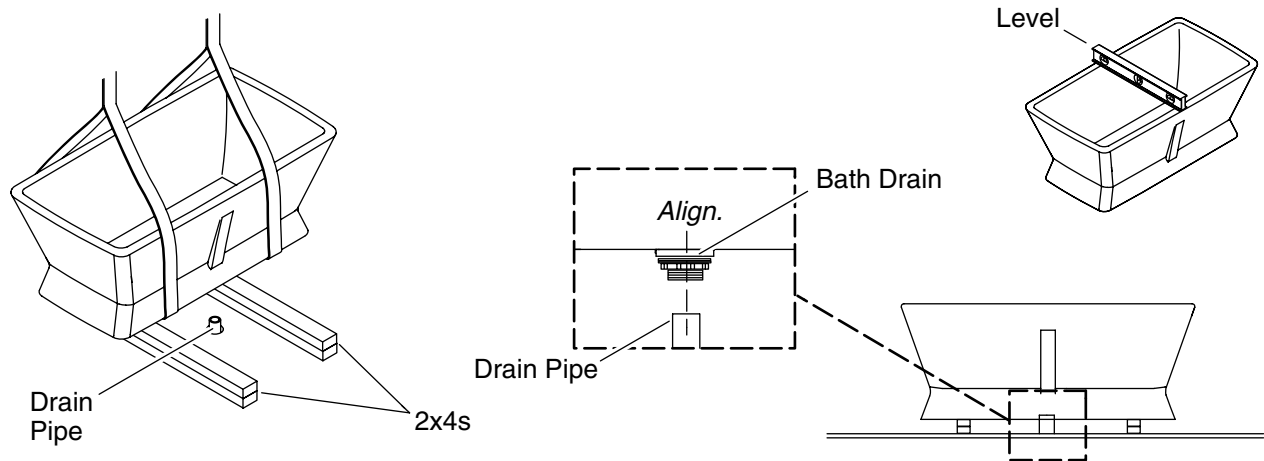

⚠ CAUTION: Risk of personal injury. This bath is extremely heavy. Obtain sufficient help **and** use lifting straps to carefully lift or move the bath.

⚠ CAUTION: Risk of property damage. Make sure the factory-installed drain connections have not become loose during shipping. Tighten as needed to prevent leakage.

- Stack together two 6' (1.8 m) lengths of 2x4 lumber. Secure each set of stacked 2x4s together with nails or screws.
- Position the stacked 2x4s on each side of the drain pipe to temporarily support the bath.
- With help, use lifting straps to carefully lift the bath into position on the 2x4s so the bath drain is over the pipe.
- Carefully reposition the bath as needed so the bath drain is directly over the drain pipe.
- Use lifting straps and obtain assistance to remove the 2x4 supports and carefully set the bath on the floor. Adjust the bath position as needed to ensure that the drain pipe is in the center of the bath drain hole.

INSTALLATION INSTRUCTIONS

3. INSTALL THE PLUMBING

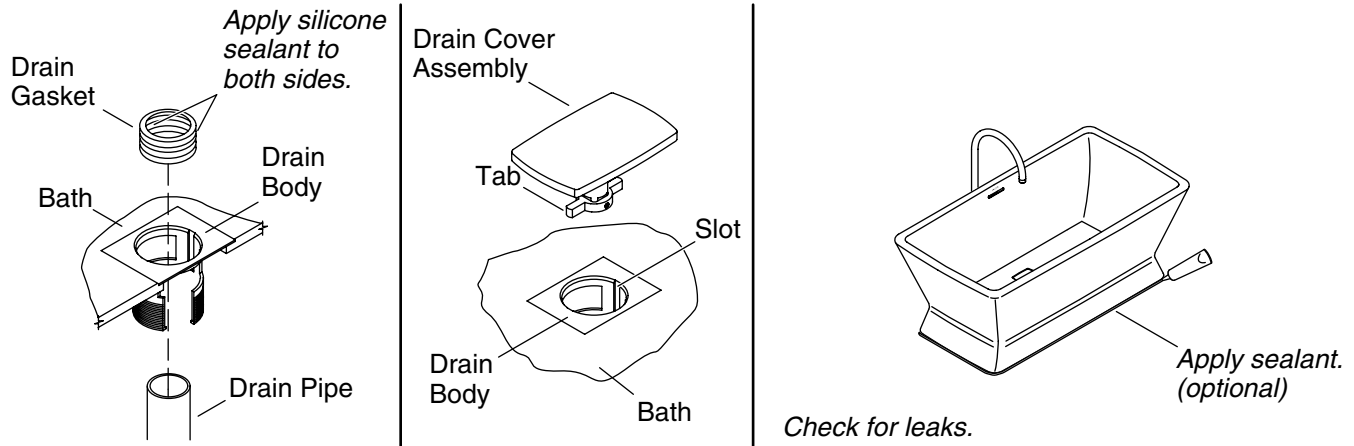

⚠ CAUTION: Risk of property damage. Make sure a watertight seal exists on all bath drain connections.

Make the Drain Connection

NOTE: The drain cover and gaskets are included in a small box located within the carton.

- Choose the thin drain cover for PVC drain pipes or the thick gasket for brass pipes.
- Apply silicone sealant to the inside and outside surfaces of the drain gasket to act as a lubricant.
- Use a rubber mallet and short section of 1-1/2" PVC tubing to install the drain gasket onto the drain pipe.
- Line up the tabs on the drain cover with the slots in the drain body, and insert the drain cover assembly into the flange.
- Press the drain cover several times to make sure the drain opens and closes properly.

Apply Sealant - Optional

- If desired, apply a thin, continuous bead of clear or color-matched silicone sealant to the seam between the bath and the finished floor.

Install the Bath Filler

- Install the bath filler according to the faucet manufacturer's instructions.
- Close the bath drain. Fill the bath to the overflow, and check for leaks.