

**INSTALLATION INSTRUCTIONS
KITCHEN BRIDGE FAUCET
WITH SIDE SPRAY
Model No's: 9456, 9458**

NEWPORT BRASS.
Flawless Beauty. From Faucet to Finish.™

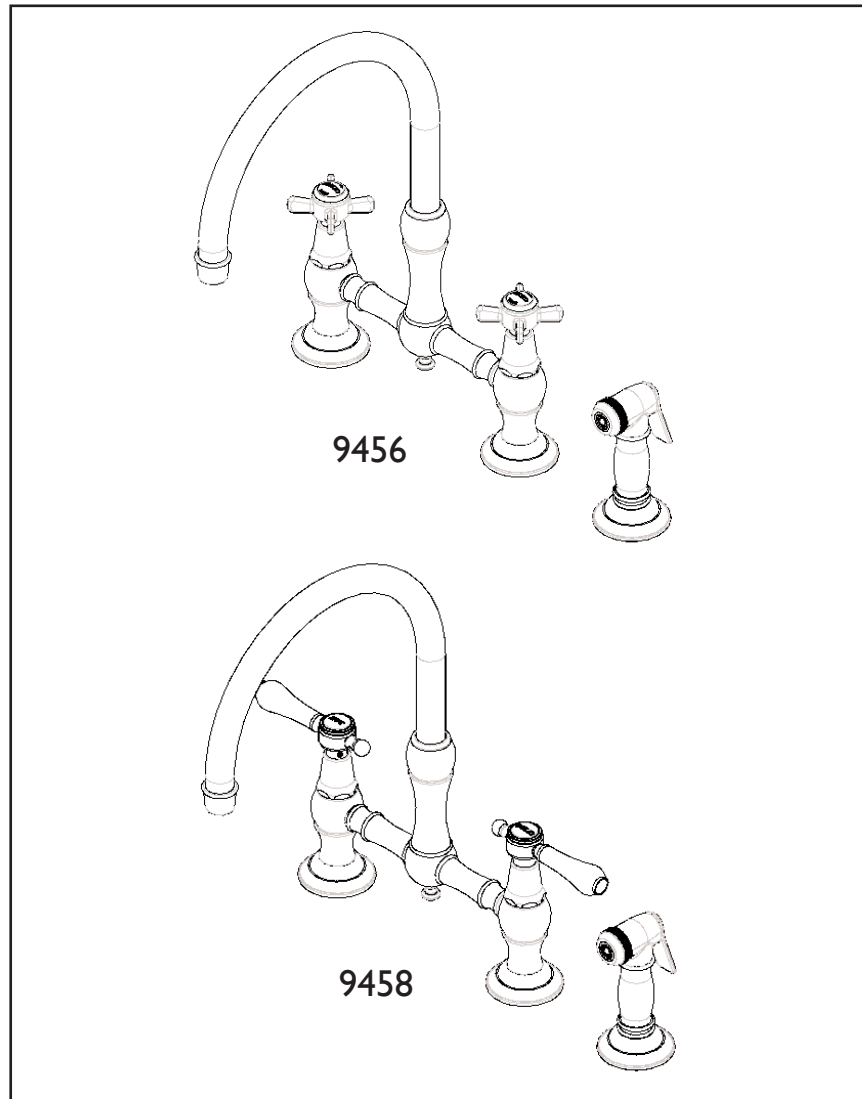

**Congratulations on the purchase
of this Newport Brass product,
an excellent choice, that will give you
years of quality service and enhance
the look and style of your home.**

Adjust Handle Alignment:

1. In **Figure 5**, ensure cartridges in full closed position and check HANDLE alignment. If the HANDLE is not correctly aligned, temporary remove the HANDLE, loosen up (but do not completely remove) the ADAPTER SCREW and rotate CARTRIDGE ADAPTER one tooth clockwise (18 degrees), reassemble the HANDLE and recheck alignment. Repeat until the HANDLE is aligned.
2. Remove the HANDLE and tighten the ADAPTER SCREW to firmly secure the CARTRIDGE ADAPTER to cartridge. Reattach the HANDLE to the CARTRIDGE ADAPTER and secure the HANDLE in place with set screw(s).

Note: When reattaching the HANDLE, assure a small gap between HANDLE and BONNET to prevent from metal-to-metal contact.

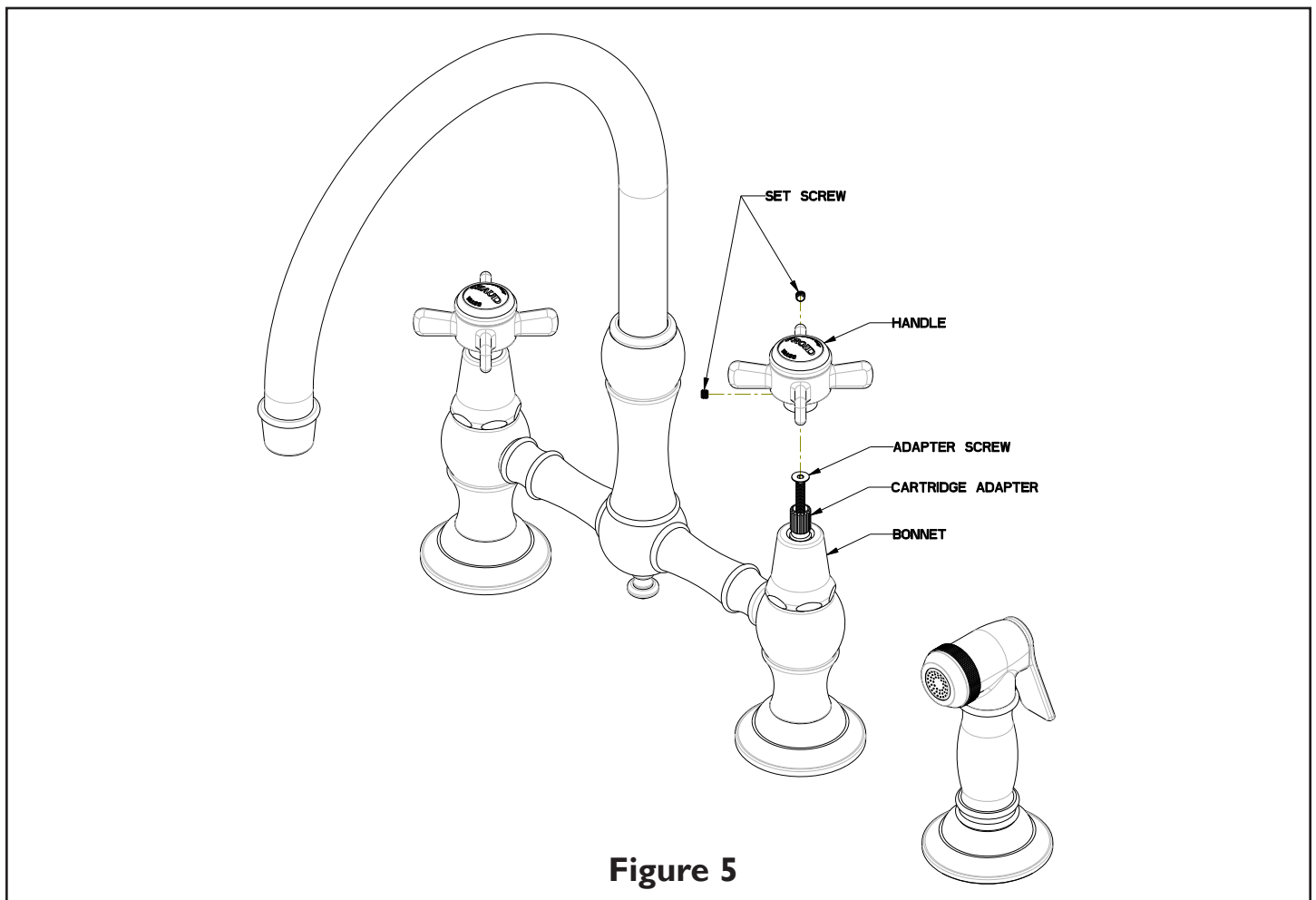

Figure 5