

PHYLTRICH®

Defining Luxury Since 1959

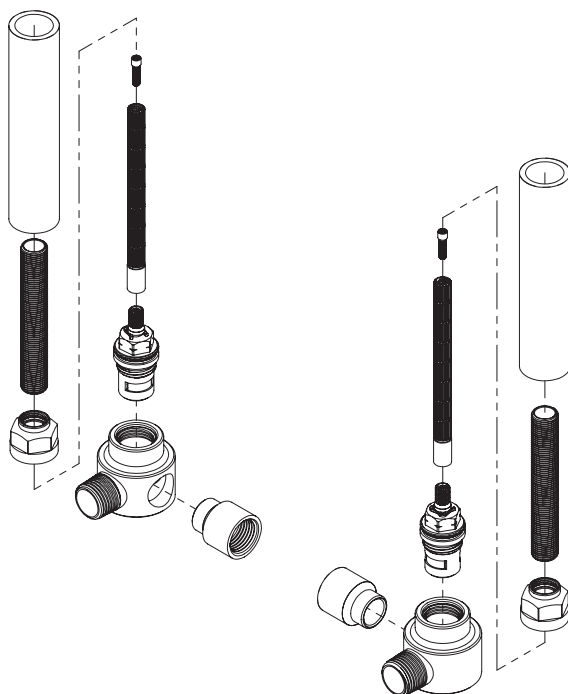

INSTALLATION INSTRUCTIONS FOR

8090536RC
80951PHY

8090536RC CORNER VALVES
80951PHY THREE HANDLE TUB & SHOWER VALVE

RECOMMENDED TOOLS & MATERIALS Most of the procedures require the use of common tools & materials, which are available from hardware & plumbing supply stores. It is essential that the tools and materials be on hand before work.

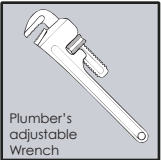
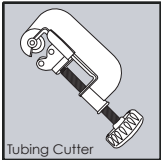

WE RECOMMEND THAT ALL PLUMBING PRODUCTS BE INSTALLED BY LICENSED PROFESSIONAL

PARTS BREAKDOWN

■ 8090536RC Corner Valves

(If you have purchased the 8090536RC)

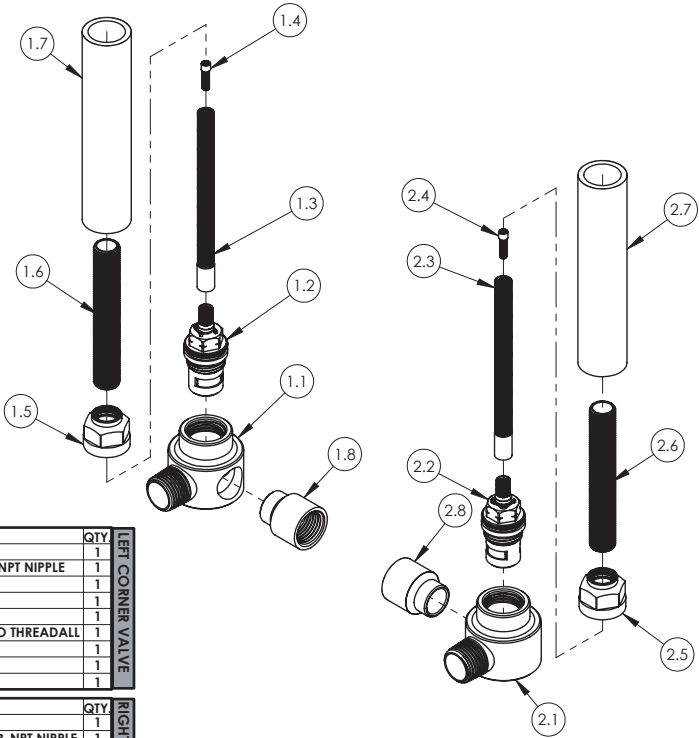

8090536RC CORNER VALVES			
#	PART #	DESCRIPTION	QTY
1	1-045	CORNER VALVE HOT 16 PT	1
1.1	10088	VALVE,INWALL LEFT 1/2"G & NPT NIPPLE	1
1.2	10211	CARTRIDGE VALVE HOT	1
1.3	10054	STEM EXTENSION	1
1.4	92157	SCREW, SMALL	1
1.5	10058	NUT, ADAPTOR CARTRIDGE TO THREADALL	1
1.6	10209	SHANK, NIPPLE THREADALL	1
1.7	10324	MUD GUARD PVC	1
1.8	10069	NIPPLE, 1/2" NPT FEMALE	1

#	PART #	DESCRIPTION	QTY
2	1-046	CORNER VALVE COLD 16 PT	1
2.1	10089	VALVE,INWALL RIGHT 1/2"G & NPT NIPPLE	1
2.2	10210	CARTRIDGE VALVE COLD	1
2.3	10054	STEM EXTENSION	1
2.4	92157	SCREW, SMALL	1
2.5	10058	NUT, ADAPTOR CARTRIDGE TO THREADALL	1
2.6	10209	SHANK, NIPPLE THREADALL	1
2.7	10324	MUD GUARD PVC	1
2.8	10069	NIPPLE, 1/2" NPT FEMALE	1

PARTS BREAKDOWN

■ 80951PHY Three Handle Tub & Shower Valve w/ Diverter

(If you have purchased the 80951PHY)

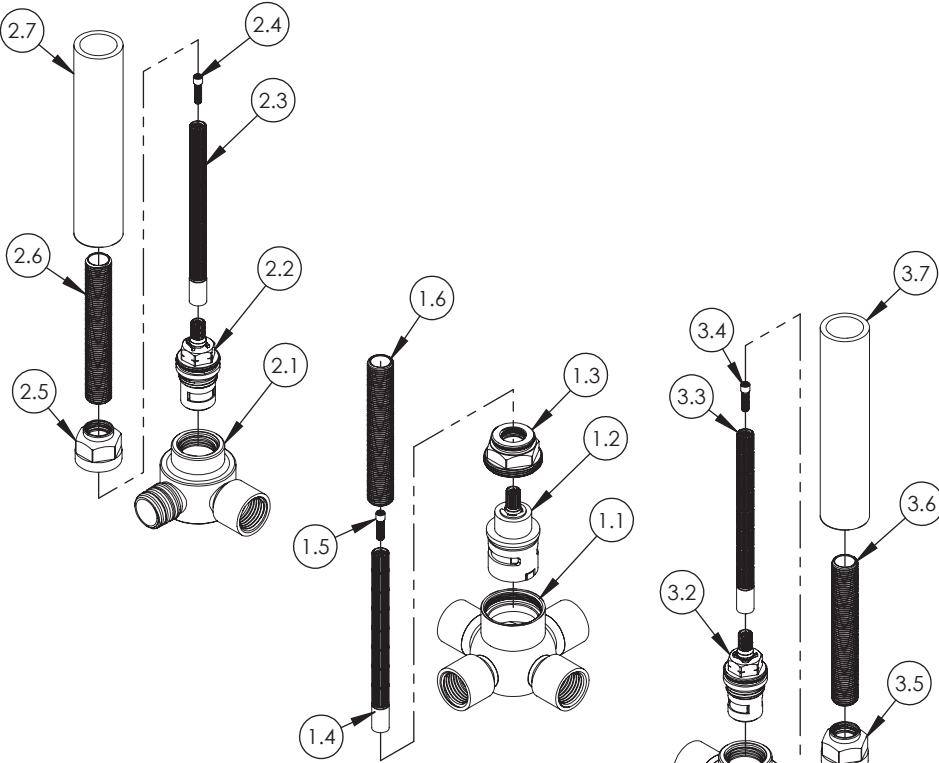

80951PHY THREE HANDLE TUB & SHOWER VALVE			
#	PART #	DESCRIPTION	QTY
1	1-019	INWALL DIVERTER, 4 PORT	1
1.1	2-036	DIVERTER BODY, 2 INS, 2 OUTS	1
1.2	10422	CARTRIDGE	1
1.3	10004	NUT, TOP BODY DIVERTER	1
1.4	10054	STEM EXTENSION, 20 PT.	1
1.5	92157	SCREW	1
1.6	10209	SHANK, NIPPLE THREADALL	1
#	PART #	DESCRIPTION	QTY
2	1-045	CORNER VALVE HOT	1
2.1	2-143	INWALL ROUGH VALVE (HOT)	1
2.2	10211	CARTRIDGE HOT	1
2.3	10054	STEM EXTENSION, 20 PT.	1
2.4	92157	SCREW	1
2.5	10058	NUT, ADAPTOR CART. TO THREADALL	1
2.6	10209	SHANK, NIPPLE THREADALL	1
2.7	10324	MUD GUARD PVC	1
#	PART #	DESCRIPTION	QTY
3	1-046	CORNER VALVE COLD	1
3.1	2-144	INWALL ROUGH VALVE (COLD)	1
3.2	10210	CARTRIDGE COLD	1
3.3	10054	STEM EXTENSION, 20 PT.	1
3.4	92157	SCREW	1
3.5	10058	NUT, ADAPTOR CART. TO THREADALL	1
3.6	10209	SHANK, NIPPLE THREADALL	1
3.7	10324	MUD GUARD PVC	1

Before starting the installation determine first the **rough-in specs** to determine the proper location of the valve.
See back of page for rough-in specs

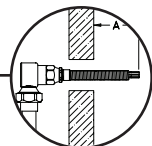

■ PART 1 Connection of Copper tubing/lines

Once the proper location has been determined secure the **valve**. Connect the **Copper lines** to the hot and cold supplies.

8090536RC VALVE

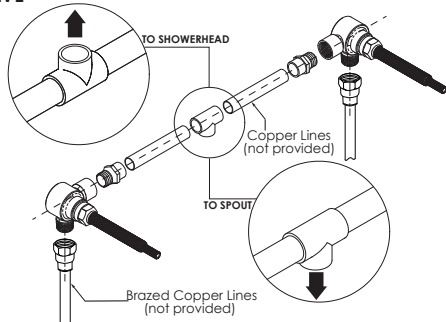

80951PHY VALVE

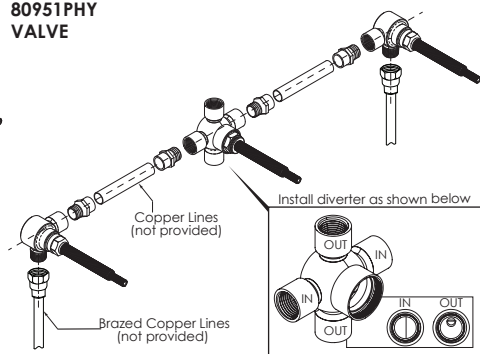

NOTE: COPPER LINES NOT PROVIDED, CENTER TO CENTER TO BE PROVIDED BY THE CUSTOMER

Follow the direction for the continuation of the install guide:

For Shower install go to **Part 2A**; For Wall lav/Tub Install go to **Part 2B**; For 80951PHY install go to **part 3**

■ PART 2A Wall Shower Installation

Determine the proper **location** of the showerhead. Install a **crossbeam** and secure a 1/2" brass **90° elbow**. Connect elbow to the valve using copper lines. Wall is **ready to be closed**.

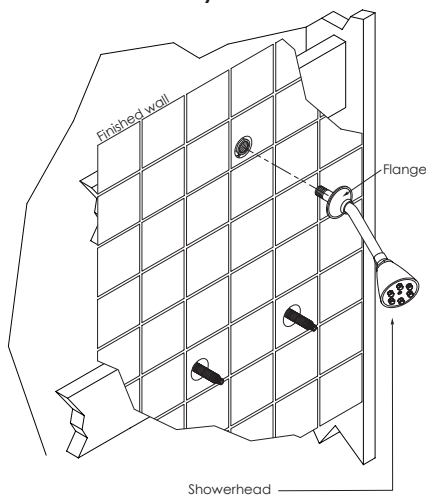
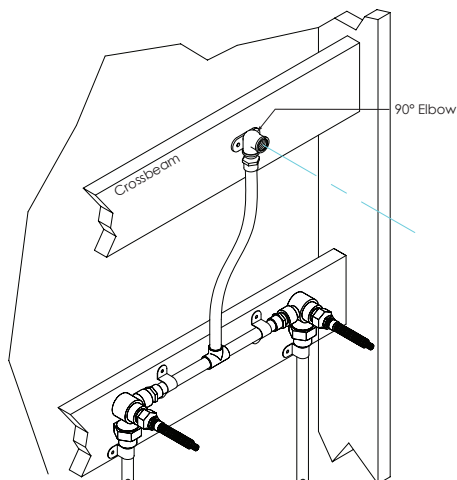

Once **finished wall** is installed, attach **Showerhead** to the brass **elbow**. Slide flange against wall.

NOTE: Check all connections for leaks and flush all lines.

PROCEED TO PART 4 (Escutcheons & Handles)

•PART 2B Wall Lav/ Tub Installation

Determine the proper location for the Tub spout. (**NOTE: the outlet of the spout must be minimum of 2" above the floodplane of the tub**). Install a crossbeam and secure a 1/2" brass 90° elbow. Connect elbow to the valve using copper lines. Connect a 1/2" brass nipple to elbow to accept the spout. **Wall is ready to be closed.**

NOTE: 1/2" NIPPLE NOT PROVIDED

WALL TUB INSTALLATION

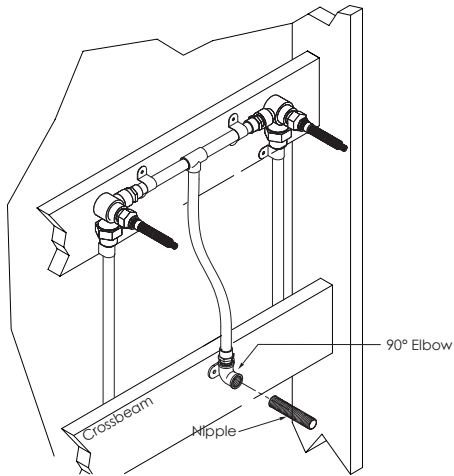

WALL LAV INSTALLATION

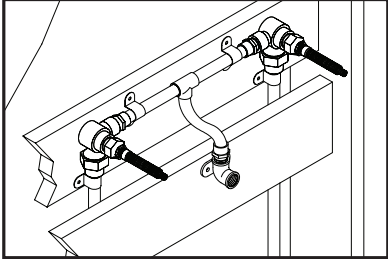

Once **finished wall** is installed, attach **Wall Tub Spout** to the brass nipple.

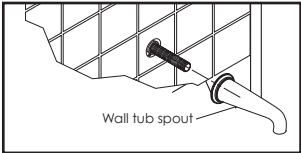

NOTE: Check all connections for leaks and flush all lines.

PROCEED TO PART 4 (Escutcheons & Handles)

•PART 3 80951PHY

Determine the proper location for Shower and the Tub spout. (**NOTE: the outlet of the spout must be minimum of 2" above the floodplane of the tub**).

Install a crossbeam and secure a 1/2" brass 90° elbow. Connect elbows to the valve using copper lines. Connect a 1/2" brass nipple to elbow to accept the spout.

Wall is ready to be closed.

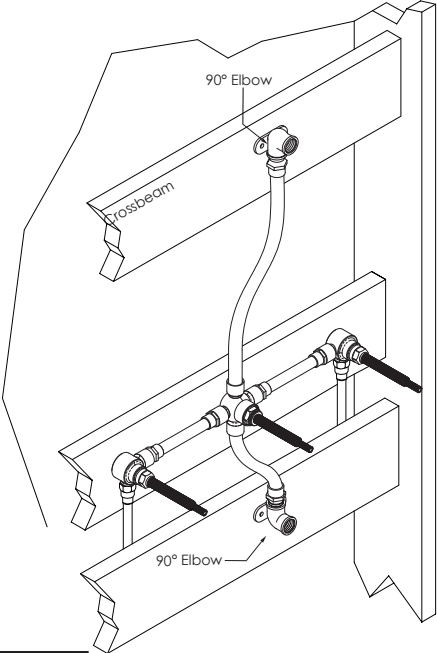
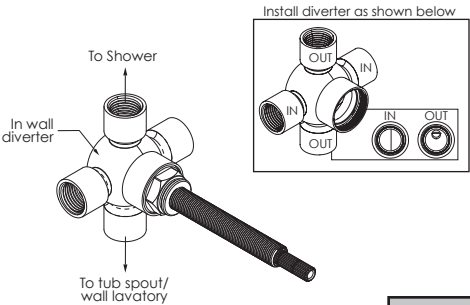

CONTINUE ON TO NEXT PAGE

Before installing, know first if you are installing a **female spout** or a **male spout**.

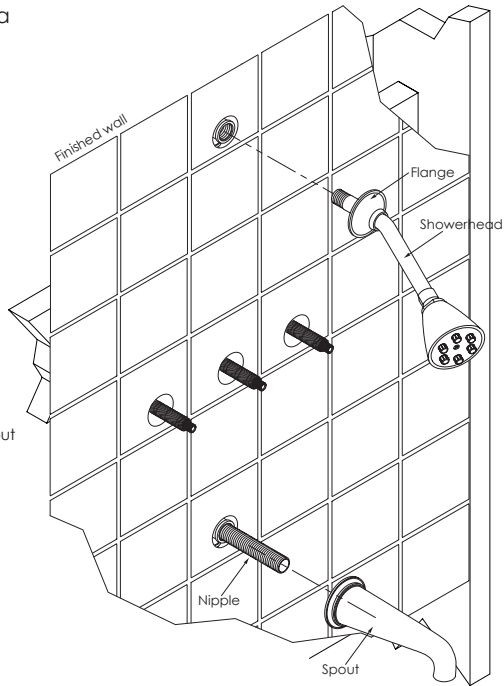
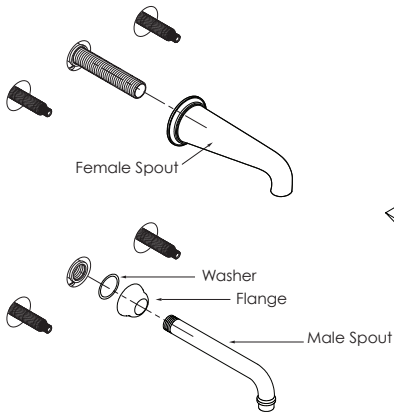

Once **finished wall** is installed, attach showerhead to the brass elbow & attach the **nipple** for the **wall tub spout**.

NOTE: Nipple not provided

PROCEED TO PART 4 (Escutcheons & Handles)

PART 4 (Escutcheons & Handles)

Once the **finished wall** is in place and the necessary installation finished, attach the **escutcheons and handles** to the stem assemblies.

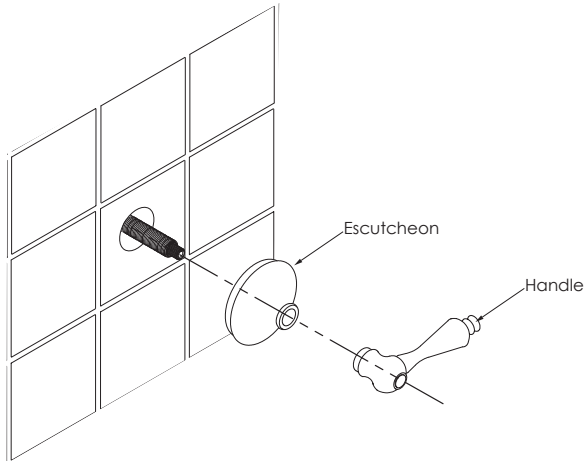

Proceed to the next step on how to fix trimming issues if applicable.

• TRIM OUT

INSTALLED TOO DEEP

If the valve is **installed too deep** behind the wall, **extension stems** are available. Please contact your local distributor to order part number **2-289 6 1/2"**

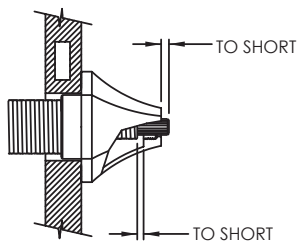

INSTALLED TOO FAR OUT

If the valve is **installed too far out of the wall**, the **stems and nipples** may be trimmed. To determine amount to be cut measure the gap between the **escutcheon and the wall** and/or the gap between the **handle and escutcheon**.

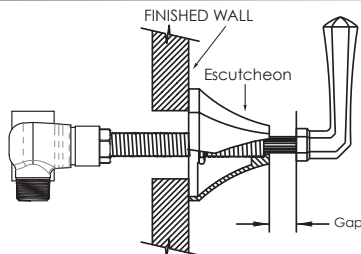

Secure handles using **setscrews** or 1/4-20 machine screws provided.

Your faucet is now ready to use.

Note: If you ordered/ purchased a replacement for the cartridge follow the instructions below.

• ADJUSTABLE CARTRIDGE KIT 2-197 (1/2" COLD) & 2-198 (1/2" HOT)

Warning: Before removing any plumbing make sure that the water line has been shut off

HANDLE ADJUSTMENT

1. Remove any existing cartridge & make sure that the **valve is free from any debris**.
2. Install new **cartridge**.
3. Rotate handle to desired "**off**" position (**3 o'clock** or **9 o'clock**) .
4. Remove handle and use a deep socket wrench (**12-14 ft-lb RECOMMENDED**) to secure the adjustment nut **DO NOT OVER TIGHTEN**
5. If the handle is heavy & starts to droop use a strap wrench on the **threaded nipple as needed**
6. **Reinstall trim & handle**

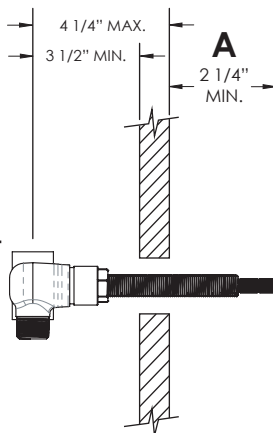
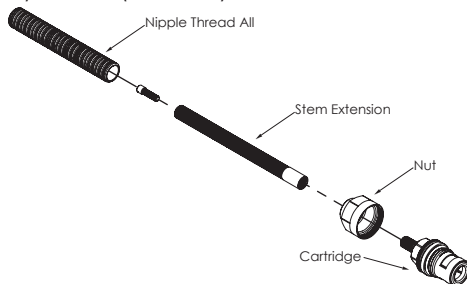

ROUGH-IN SPECIFICATIONS

See Page 8 for full trim specifications

Rough in specifications for wall lavatory tub sets

All Phylrich Doralfe valve installations must follow the measurement for "A" listed below

Please consult the trim number for correct rough in dimension

PHYLIRICH PROD#	Rough In	PHYLIRICH PROD#	Rough In	PHYLIRICH PROD#	Rough In
WL101	2 1/4"	WL180	2 7/8"	WL338B	2 1/2"
WL104	2 3/4"	WL181	2 7/8"	WL338C	2 1/2"
WL105	2 3/4"	WL234	2 1/2"	WL338D	2 1/2"
WL123	2 7/8"	WL240	3"	WL338F	2 1/2"
WL137	2 3/8"	WL241	3"	WL361	2 3/8"
WL137SF	2 3/8"	WL242	3"	DWL100	2 1/4"
WL141	2 3/8"	WL243	3"	DWL102	2 1/4"
WL144	2 1/4"	WL244	3"	DWL130	2 1/4"
WL158A	2 1/4"	WL270	2"	DWL134	2 1/4"
WL158B	2 1/4"	WL271	2"	DWL137	2 1/4"
WL158C	2 1/4"	WL272	2"	DWL205	2 3/4"
WL158D	2 1/4"	WL273	2"	DWL206	2 3/4"
WL170	2 1/2"	WL274	2"		
WL171	2 1/2"	WL338A	2 1/2"		

Rough in specifications for wall tub sets

All Phylrich valve installations must follow the measurement for "A" listed below

Please consult the trim number for correct rough in dimension

PHYLIRICH PROD#	Rough In	PHYLIRICH PROD#	Rough In	PHYLIRICH PROD#	Rough In
K1101	2 1/4"	K1171	2 1/2"	K1273	2"
K1104	2 3/4"	K1180	2 7/8"	K1274	2"
K1105	2 3/4"	K1181	2 7/8"	K1338A	2 1/2"
K1123	2 7/8"	K1183	2 7/8"	K1338B	2 1/2"
K1137	2 3/8"	K1184	2 7/8"	K1338C	2 1/2"
K1137SF	2 3/8"	K1234	2 1/2"	K1338D	2 1/2"
K1141	2 3/8"	K1240	3"	K1338F	2 1/2"
K1144	2 1/4"	K1241	3"	K1361	2 3/8"
K1158A	2 1/4"	K1242	3"	D1100	2 1/4"
K1158B	2 1/4"	K1243	3"	D1102	2 1/4"
K1158C	2 1/4"	K1244	3"	D1130	2 1/4"
K1158D	2 1/4"	K1270	2"	D1134	2 1/4"
K1158F	2 1/4"	K1271	2"	D1137	2 1/4"
K1170	2 1/2"	K1272	2"	D1205	2 3/4"
				D1206	2 3/4"

Rough in specifications for two handle shower sets

PHYLIRICH PROD#	Rough In	PHYLIRICH PROD#	Rough In	PHYLIRICH PROD#	Rough In
K3101	2 1/4"	K3170	2 1/2"	K3272	2"
K3104	2 3/4"	K3171	2 1/2"	K3273	2"
K3105	2 3/4"	K3180	2 7/8"	K3274	2"
K3109	2 1/2"	K3181	2 7/8"	K3338A	2 1/2"
K3123	2 7/8"	K3183	2 7/8"	K3338B	2 1/2"
K3137	2 3/8"	K3184	2 7/8"	K3338C	2 1/2"
K3137SF	2 3/8"	K3234	2 1/2"	K3338D	2 1/2"
K3141	2 3/8"	K3240	3"	K3338F	2 1/2"
K3144	2 1/4"	K3241	3"	K3361	2 3/8"
K3158A	2 1/4"	K3242	3"	D3100	2 1/4"
K3158B	2 1/4"	K3243	3"	D3102	2 1/4"
K3158C	2 1/4"	K3244	3"	D3130	2 1/4"
K3158D	2 1/4"	K3270	2"	D3134	2 1/4"
K3158F	2 1/4"	K3271	2"	D3137	2 1/4"
				D3205	2 3/4"
				D3206	2 3/4"