

Features

- Brass construction
- Compression valve
- Four-arm handle stop
- NPT connections

Codes/Standards Applicable

Specified model meets or exceeds the following at date of manufacture:

- NSF 61
- ASME A112.18.1/CSA B125.1
- All applicable US Federal and State material regulations

ANGLE STOP K-7659

ALSO K-7660, K-7662, K-7663

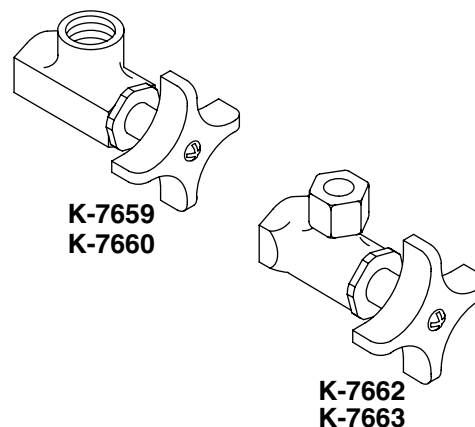

Colors/Finishes

- CP: Polished Chrome

Specified Model

Model	Description	Colors/Finishes
K-7659	Angle stop with 3/8" NPT connection	<input type="checkbox"/> CP
K-7660	Angle stop with 1/2" NPT connection	<input type="checkbox"/> CP
K-7662	Angle stop with 3/8" NPT connection and compression fitting for flexible riser	<input type="checkbox"/> CP
K-7663	Angle stop with 1/2" NPT connection and compression fitting for flexible riser	<input type="checkbox"/> CP

Product Specification

Angle stop shall be of brass construction. Product shall include a compression valve, four-arm handle stop, and NPT connections. Stop (single) shall be Kohler Model K-_____-_____-_____.
Stop (double) shall be Kohler Model K-_____-_____-_____-_____-_____.

Installation Notes

Install this product according to the installation guide.

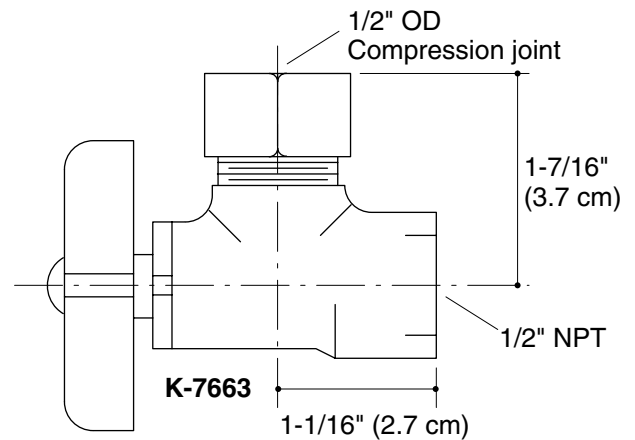
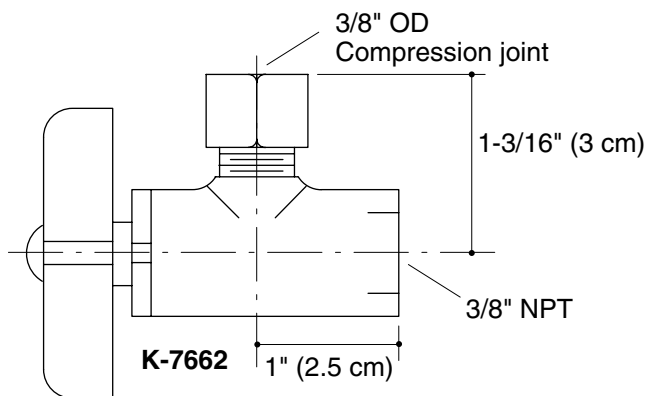
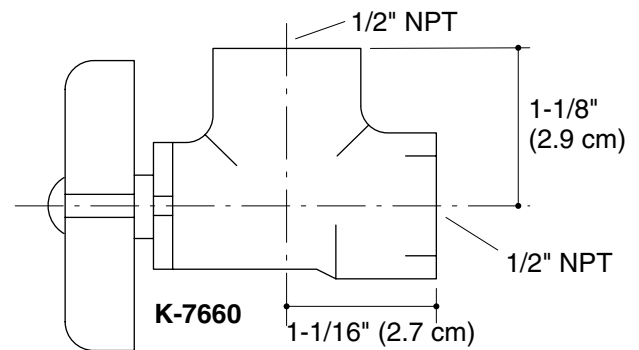
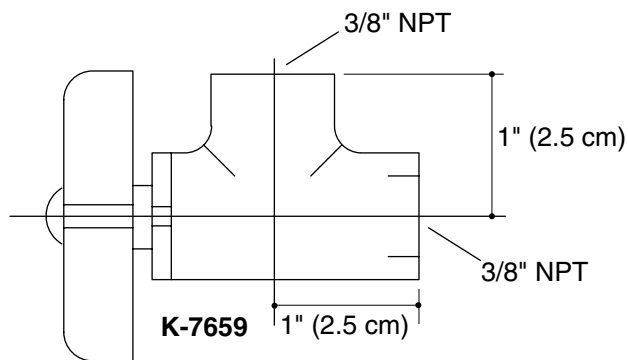

Product Diagram