

# 48" X 48" Junction Box

## Specifications:

1. Concrete: Has a Design Strength of 5,000 psi at 28 Days.

2. Steel Reinforcement: ASTM A-615, Grade 60 or ASTM A-497 Welded Wire Fabric.

3. Loading: Designed for H20 Loading.

## Weights

Catch Basin Weight - 7,275 Lbs.

Slab Top Weight - 2,200 Lbs.

Wye Inlet Weight - 2,550 Lbs.

Extension Weight (12") - 1,350 Lbs.

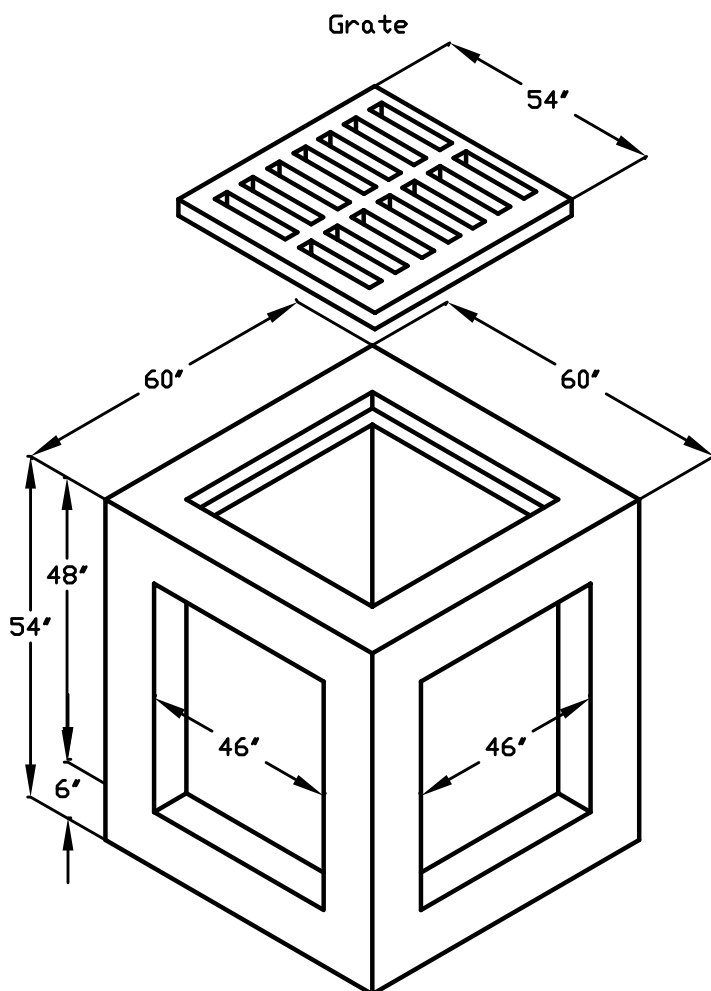
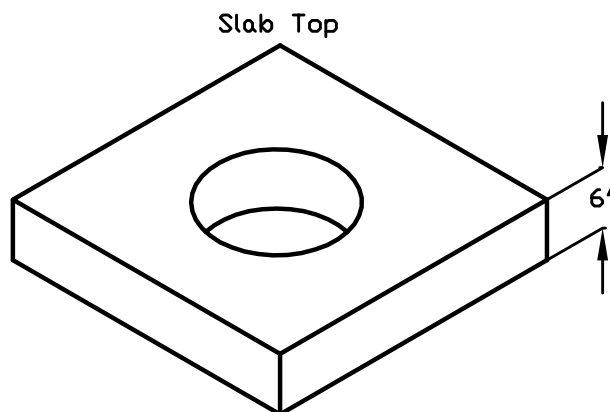
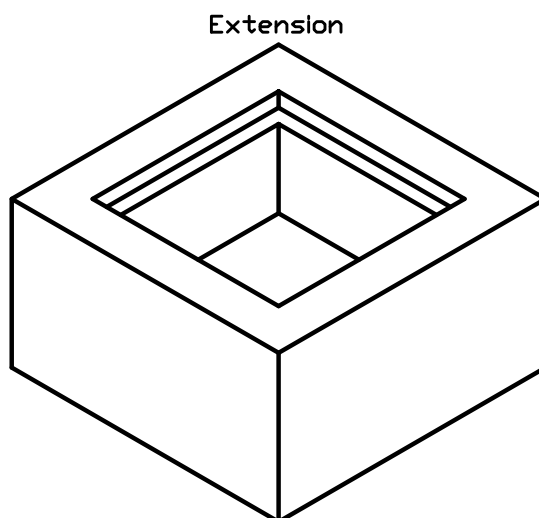
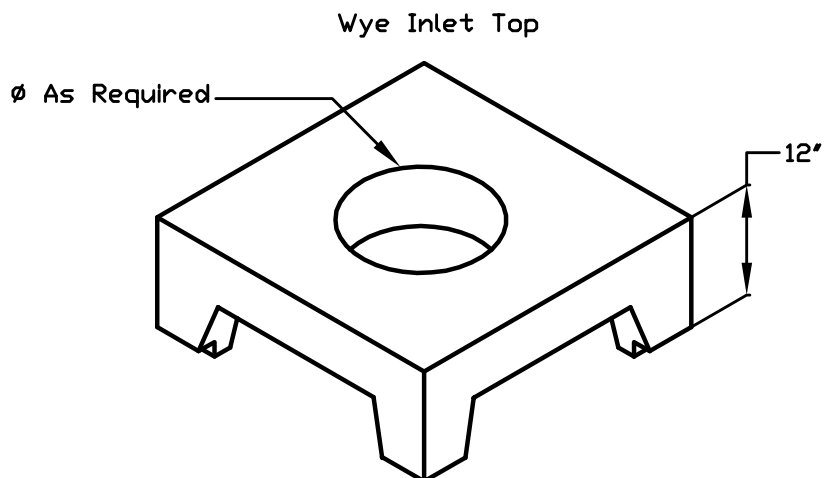

The Turner Company			11049 Highway 28 Rhame, Tx 76078 (817) 638-9053
Product: 48" x 48" Junction Box			
Concrete: 5,000 PSI MIN. - 28 DAY STRENGTH			
Reinforcement: MEETS OR EXCEEDS ASTM-A-615 or A-185			
Size:	Date:	DWG No.	
Weight:			