

# ZONECONE

## All Orange Cone

Work Area Protection has been a leading manufacturer of high-quality traffic cones for over 50 years. Work Area Protection cones are used every day, all over the world. These cones are designed and manufactured to last for years. Your safety demands it and Work Area Protection delivers it with high-visibility, durable, high-quality traffic cones.

### Features

- One-piece, flow-molded polyvinyl chloride
- Anti-fade, fluorescent orange color
- Permanent stenciling available
- Broad base for stability
- Heat resistance to 160°
- Elongation: 200%
- Tensile strength: 1200 psi minimum
- Hardness: 80±5 conical, 75±5 base
- Tear strength: 250 psi
- Meet NCHRP350 requirements
- Meet MUTCD and FHWA requirements

### STANDARD TRAFFIC CONES

Product No.	Model No.	Description	Top Thickness	Bottom Thickness	A	B	C	D	Cone Height	Weight Lbs.	Qty. Per Carton	Pallet Qty. (Cartons)	Pallet Qty. (Loose)
271449	6PVC	Standard	.056"	.090"	4-1/2"	-	7/8"	2-1/4"	6"	1/4	200	N/A	N/A
271452	12PVC	Standard	.065"	.120"	8-1/4"	1-1/4"	2-3/16"	6-1/2"	12"	1-1/2	30	480	1000
271456	18PVC	Standard	.065"	.120"	11-3/8"	1-1/4"	2-3/16"	7-1/4"	18"	3	20	240	750
271453	18PVCH	Heavy	.070"	.125"	11-3/8"	1-1/4"	2-3/16"	7-1/4"	18"	4	20	240	500
271459	18PVCX	Extra Heavy	.080"	.125"	13"	1-1/4"	2-3/16"	7-1/4"	18"	7	14	168	300
271469	28PVC	Standard	.075"	.130"	15-1/4"	1-1/4"	2-3/16"	10-1/2"	28"	7	10	90	250
271461	28PVCH	Heavy	.080"	.135"	15-1/4"	1-1/4"	2-3/16"	10-1/2"	28"	10	10	90	200
271486	28PVCX	Extra Heavy	.075"	.130"	15"	1-1/4"	2-1/2"	10-1/2"	28"	12	10	90	200
271494	36PVC	Standard	.075"	.130"	15"	1-1/4"	2-1/2"	10-1/2"	36"	10	10	90	200
271488	36PVCH	Heavy	.075"	.130"	15-1/2"	1-1/4"	2-1/2"	10-1/2"	36"	12	9	81	200

Based on Pallet: 45" x 45"

**A** = Base size (square)  
**B** = Hole diameter at top  
**C** = Cone diameter at top  
**D** = Cone diameter at base

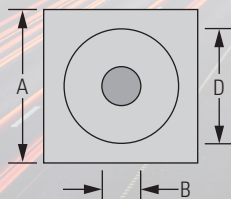

Standard 28" Cone with 6" & 4" Reflective Collars

Available plain or with reflective collars attached

## TRIMLINE CONES

Product No.	Model No.	Description	Top Thickness	Bottom Thickness	A	B	C	D	Cone Height	Weight Lbs.	Qty. Per Carton	Pallet Qty. (Cartons)	Pallet Qty. (Loose)
271477	28PVCTL	Trimline	.075"	.130"	13"	1"	1-3/4"	7-1/2"	28"	5	10	120	400
271485	28PVCTLS	Trimline Std.	.080"	.135"	13-3/4"	1"	1-3/4"	7-1/2"	28"	7	10	90	250
271482	28PVCTLH	Trimline Heavy	.080"	.135"	14-3/4"	1"	1-3/4"	7-1/2"	28"	10	10	90	200
271499	36PVCTLS	Trimline	.070"	.130"	14"	1"	1-9/16"	8-5/16"	36"	8-1/2	10	90	200

Based on Pallet: 45" x 45"

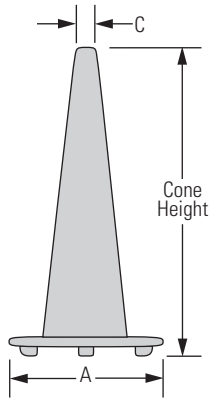

**A = Base size (square)**  
**B = Hole diameter at top**  
**C = Cone diameter at top**  
**D = Cone diameter at base**

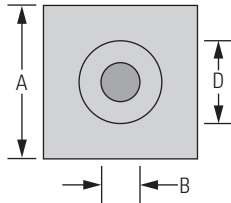

28" Trimline Cone with 6" & 4" Reflective Collars

Available plain or with reflective collars attached

## RECESSED COLLAR CONES

Product No.	Model No.	Description	Top Thickness	Bottom Thickness	A	B	C	D	Cone Height	Weight Lbs.	Qty. Per Carton	Pallet Qty. (Cartons)	Pallet Qty. (Loose)
271475	28PVCS-R	Standard	.075"	.130"	15-1/4"	1-1/4"	2-3/16"	10-1/2"	28"	7	10	90	250
271466	28PVCH-R	Heavy	.080"	.135"	15-1/4"	1-1/4"	2-3/16"	10-1/2"	28"	10	10	90	200
271498	36PVCS-R	Standard	.075"	.130"	15-1/2"	1-1/4"	2-1/2"	10-1/2"	36"	10	10	90	200
271493	36PVCH-R	Heavy	.075"	.130"	15-1/2"	1-1/4"	2-1/2"	10-1/2"	36"	12	9	90	200

Based on Pallet: 45" x 45"



28PVC-R Recessed Cone without Reflective Collars

Available plain or with reflective collars attached

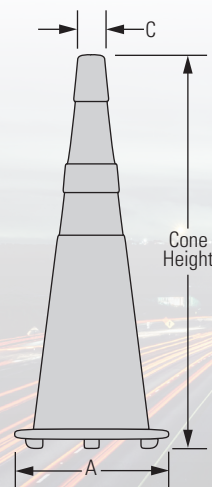

**A = Base size (square)**  
**B = Hole diameter at top**  
**C = Cone diameter at top**  
**D = Cone diameter at base**

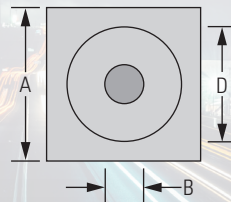

**HILL & SMITH INC.**

987 Buckeye Park Road | Columbus OH 43207

(614) 340-6294 | [info@hillandsmith.com](mailto:info@hillandsmith.com)

[www.hillandsmith.com](http://www.hillandsmith.com) | [www.workareaprotection.com](http://www.workareaprotection.com)