



# WS\_BHF Series

## Model 3887BHF

SUBMERSIBLE SEWAGE PUMP



### FEATURES

**Impeller:** Cast iron, enclosed, non-clog, dynamically balanced with pump out vanes for mechanical seal protection.

**Casing:** Cast iron flanged volute type for maximum efficiency. Designed for easy installation on A10-20 slide rail or base elbow rail systems.

**Mechanical Seal:** SILICON CARBIDE VS. SILICON CARBIDE sealing faces for superior abrasive resistance, stainless steel metal parts, BUNA-N elastomers.

**Shaft:** Corrosion-resistant, 300 series stainless steel. Threaded design. Locknut on all models to guard against component damage on accidental reverse rotation.

**Fasteners:** 300 series stainless steel.

Capable of running dry without damage to components.

Designed for continuous operation when fully submerged.

**EXTENDED WARRANTY AVAILABLE FOR RESIDENTIAL APPLICATIONS.**

### APPLICATIONS

Specifically designed for the following uses:

- Homes
- Water transfer
- Sewage systems
- Light industrial
- Dewatering/Effluent
- Commercial applications

Anywhere waste or drainage must be disposed of quickly, quietly and efficiently.

### SPECIFICATIONS

#### Pump

- Solids handling capabilities: 2" maximum
- Capacities: up to 220 GPM
- Total heads: up to 81 feet TDH
- Discharge size: 2" NPT threaded companion flange as standard. 3" option available but must be ordered separately. (Order no. A1-3)
- Temperature: 104°F (40°C) continuous  
140°F (60°C) intermittent.

#### MOTORS

- Fully submerged in high grade turbine oil for lubrication and efficient heat transfer. All ratings are within the working limits of the motor.

Class B insulation on 1/3-1 1/2 HP models.

Class F insulation on 2 HP models.

#### Single phase (60 Hz):

- Capacitor start motors for maximum starting torque.
- Built-in overload with automatic reset.
- SJTOW or STOW severe duty oil and water resistant power cords.
- 1/3 - 1 HP models have NEMA three prong grounding plugs.
- 1 1/2 HP and larger units have bare lead cord ends.

#### Three phase (60 Hz):

- Class 10 overload protection must be provided in separately ordered starter unit.
- STOW power cords all have bare lead cord ends.
- Bearings: Upper and lower heavy duty ball bearing construction.
- Designed for Continuous Operation: Pump ratings are within the motor manufacturer's recommended working limits, can be operated continuously without damage when fully submerged.
- Power Cable: Severe duty rated, oil and water resistant. Epoxy seal on motor end provides secondary moisture barrier in case of outer jacket damage and to prevent oil wicking. Standard cord is 20'. Optional lengths are available.
- Motor Cover O-ring: Assures positive sealing against contaminants and oil leakage.

#### AGENCY LISTINGS



Tested to UL 778 and CSA 22.2 108 Standards  
By Canadian Standards Association  
File #LR38549

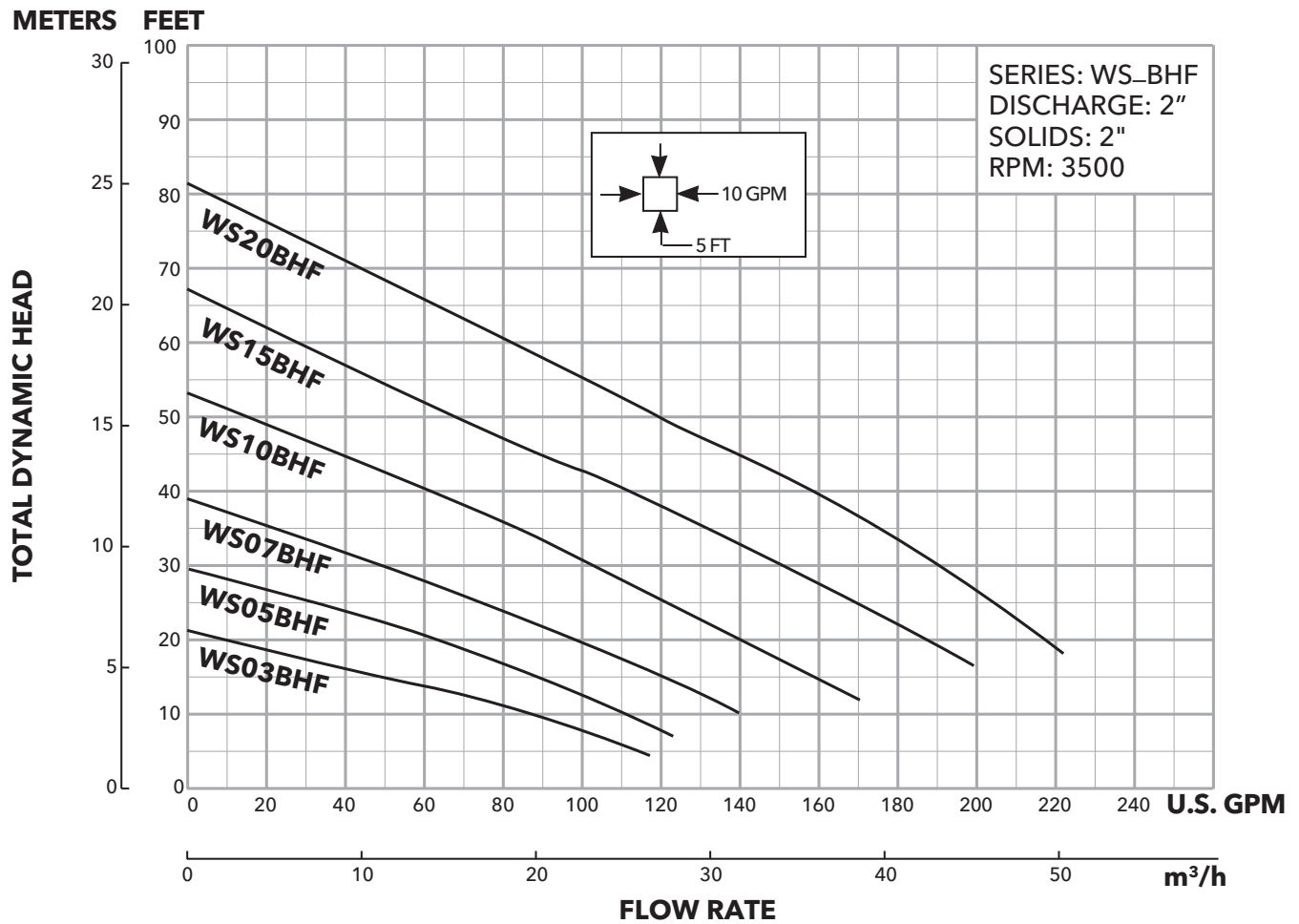

## DIMENSIONS

(All dimensions are in inches. Do not use for construction purposes.)

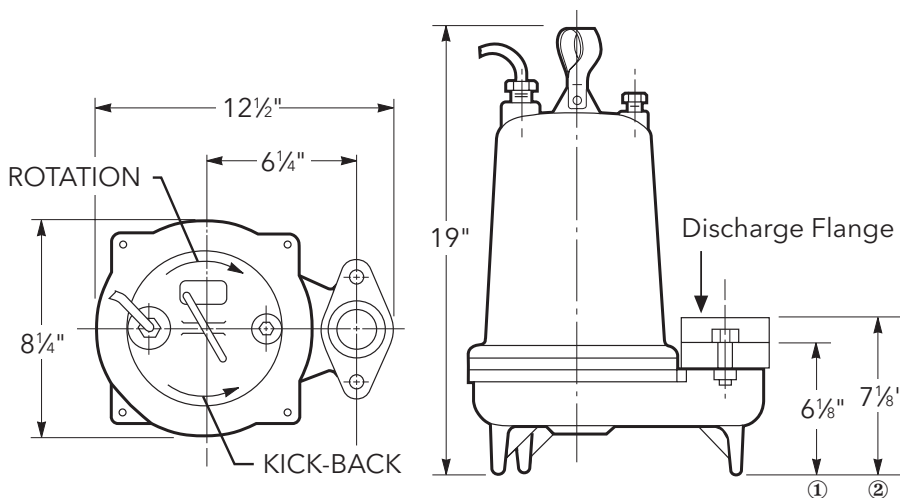

### MOTOR AND MODEL INFORMATION

Order Number	HP	Phase	Volts	RPM	Impeller Diameter (in.)	Maximum Amps	Locked Rotor Amps	KVA Code	Full Load Motor Efficiency %	Resistance	
										Start	Line-Line
WS0311BHF	0.33	1	115	3500	2.94	12.4	46.0	M	54	7.5	1.0
WS0318BHF			208			6.8	31.0	K	68	9.7	2.4
WS0312BHF			230			6.2	34.5	M	53	9.6	4.0
WS0511BHF	0.5	1	115		3.19	14.5	46.0	M	54	7.5	1.0
WS0518BHF			208			8.4	31.0	K	68	9.7	2.4
WS0512BHF			230			7.6	34.5	M	53	9.6	4.0
WS0538BHF		3	200			4.9	22.6	R	68	-	3.8
WS0532BHF			230			3.6	18.8	R	70	-	5.8
WS0534BHF			460			1.8	9.4	R	70	-	23.2
WS0537BHF			575			1.5	7.5	R	62	-	35.3
WS0718BHF	0.75	1	208		3.44	11.0	31.0	K	68	9.7	2.4
WS0712BHF			230			10.0	27.5	J	65	12.2	2.7
WS0738BHF		3	200			6.2	20.6	L	64	-	5.7
WS0732BHF			230			5.4	15.7	K	68	-	8.6
WS0734BHF			460			2.7	7.9	K	68	-	11
WS0737BHF			575			2.2	9.9	L	78	-	26.5
WS1018BHF	1	1	208		3.75	14.5	59.0	K	68	9.3	1.1
WS1012BHF			230			13.0	36.2	J	69	10.3	2.1
WS1038BHF		3	200			8.6	27.6	M	77	-	2.7
WS1032BHF			230			7.5	24.1	L	79	-	4.1
WS1034BHF			460			3.8	12.1	L	79	-	16.2
WS1037BHF			575			3.1	9.9	L	78	-	26.5
WS1512BHF	1.5	1	230		4.00	18.0	52.0	J	67	2.76	0.53
WS1538BHF		3	200			10.0	42.4	K	78	-	1.7
WS1532BHF			230			9.6	42.4	K	78	-	1.7
WS1534BHF			460			4.8	21.2	K	78	-	6.6
WS1537BHF			575			3.9	16.3	L	78	-	10.5
WS2012BHF	2	1	230		4.44	18.0	49.6	F	78	3.2	1.1
WS2038BHF		3	200			12.0	42.4	K	78	-	1.7
WS2032BHF			230			11.6	42.4	K	78	-	1.7
WS2034BHF			460			5.8	21.2	K	78	-	6.6
WS2037BHF			575			4.7	16.3	L	78	-	10.5

### PERFORMANCE RATINGS (gallons per minute)

Order No.		WS03-BHF	WS05-BHF	WS07-BHF	WS10-BHF	WS15-BHF	WS20-BHF
Total Head Feet of Water	HP	1⅓	1½	¾	1	1½	2
	RPM	3500	3500	3500	3500	3500	3500
	10	86	110	140	-	-	-
	15	48	88	120	158	-	-
	20	-	62	98	139	186	217
	25	-	32	74	120	170	204
	30	-	-	49	101	150	190
	35	-	-	21	82	130	175
	40	-	-	-	60	110	159
	45	-	-	-	38	88	140
	50	-	-	-	-	67	120
	55	-	-	-	-	47	100
	60	-	-	-	-	29	80
	65	-	-	-	-	-	62
	70	-	-	-	-	-	43
	75	-	-	-	-	-	23

### COMPONENTS (for reference only)

Item No.	Description
1	Impeller
2	Casing
3	Mechanical Seal
4	Motor Shaft
5	Motor
6	Ball Bearings
7	Power Cable
8	Casing O-Ring

\* For repair parts, reference repair parts book.

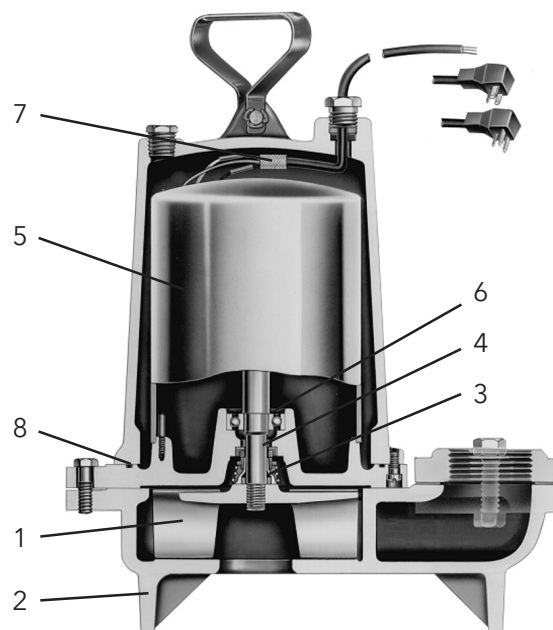

### STANDARD PANEL OPTIONS

Pump Order Number	K Series		Boulay Series	
	Simplex	Duplex	Simplex	Duplex
WS0311BHF	KS19020WF	KD19020WF	S10020	D10020
WS0318BHF	KS19020WF	KD19020WF	S10020	D10020
WS0312BHF	KS19020WF	KD19020WF	S10020	D10020
WS0511BHF	KS19020WF	KD19020WF	S10020	D10020
WS0518BHF	KS19020WF	KD19020WF	S10020	D10020
WS0512BHF	KS19020WF	KD19020WF	S10020	D10020
WS0538BHF	KS34518WF	KD34518WF	S34063	D34063
WS0532BHF	KS31255WF	KD31255WF	S32540	D32540
WS0534BHF	KS31255WF	KD31255WF	S31625	D31625
WS0537BHF	N/A	N/A	S31625	D31625
WS0718BHF	KS19020WF	KD19020WF	S10020	D10020
WS0712BHF	KS19020WF	KD19020WF	S10020	D10020
WS0738BHF	KS34518WF	KD34518WF	S34063	D34063
WS0732BHF	KS34518WF	KD34518WF	S34063	D34063
WS0734BHF	KS31255WF	KD31255WF	S32540	D32540
WS0734BHF	KS31255WF	KD31255WF	S31625	D31625
WS1018BHF	KS19020WF	KD19020WF	S10020	D10020
WS1012BHF	KS19020WF	KD19020WF	S10020	D10020
WS1038BHF	KS34518WF	KD34518WF	S36310	D36310
WS1032BHF	KS34518WF	KD34518WF	S36310	D36310
WS1034BHF	KS31255WF	KD31255WF	S32540	D32540
WS1037BHF	N/A	N/A	S32540	D32540
WS1512BHF	KS19020WF	KD19020WF	S10020	D10020
WS1538BHF	KS34518WF	KD34518WF	S31016	D31016
WS1532BHF	KS34518WF	KD34518WF	S36310	D36310
WS1534BHF	KS31255WF	KD31255WF	S34063	D34063
WS1537BHF	N/A	N/A	S32540	D32540
WS2012BHF	KS19020WF	KD19020WF	S10020	D10020
WS2038BHF	KS34518WF	KD34518WF	S31016	D31016
WS2032BHF	KS34518WF	KD34518WF	S31016	D31016
WS2034BHF	KS34518WF	KD34518WF	S34063	D34063
WS2037BHF	N/A	N/A	S34063	D34063

**Note:** Boulay Series part numbers have additional available features, see page 7 for more information.

**Note:** K Series panel part numbers include floats, to order without float switches, remove the 'WF' suffix. Boulay Series panels do not include float switches.