

1 1/2" LETTER

**WATER**

## Note:-

1. All the dimensions are in inches.
2. Material: Gray Cast Iron as per ASTM A48 Class 30B.
3. Meet H2O Loading Standards.
4. Tolerance should be  $\pm 0.0625$ ", unless otherwise specified.
5. Refer Sigma QIP Doc.No : QA/QIP/MCC for manufacturing and inspection procedure.

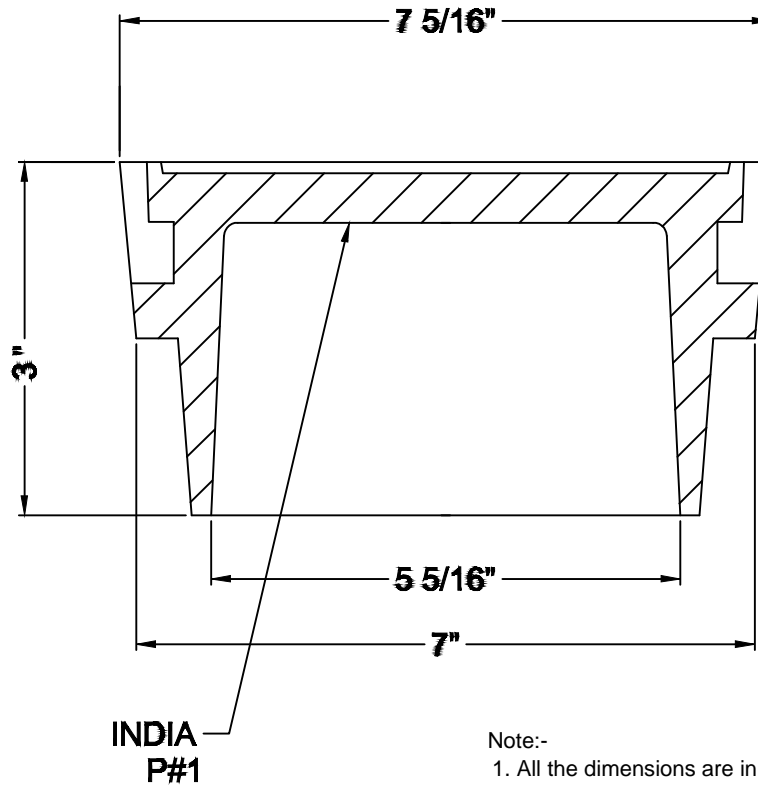

| Rev | Date       | Revision Record | Prepared | Approved |
|-----|------------|-----------------|----------|----------|
| 0   | 04.01.2013 | Format Changed  | KS4      | SR1      |
|     |            |                 |          |          |
|     |            |                 |          |          |
|     |            |                 |          |          |
|     |            |                 |          |          |
|     |            |                 |          |          |
|     |            |                 |          |          |
|     |            |                 |          |          |
|     |            |                 |          |          |
|     |            |                 |          |          |

|   |        |
|---|--------|
| All Radii & Fillets to be 0.12" (3mm) unless otherwise specified<br>All Draft angles to be 2° unless otherwise specified on drawing |        |
| Product Group :-  |        |
| MCC   |        |
| Coating:-   |        |
| PAINTED   |        |
| Type :-   |        |
| MCC SIZE AND CAST MARKS   |        |
| Product Description:-   |        |
| C.I.VALVE BOX WATER LID ONLY  |        |
| Drawing Number :-   | Rev :- |
| VB-2600W  | 0      |

**SIGMA**

CREAM RIDGE, NEW JERSEY

DATE : 04.01.2013

DRAWN BY  
KS4/BASANTA DASDRAWING FOR:  
SUBMITTALCHECKED BY  
MSK/ASHISDEYSCALE:  
NTSSHEET NO:  
1 OF 1APPROVED BY  
SR1