

EDENTON

IN-WALL SHOWER VOLUME CONTROL

SKU: 948908



FEATURES

Material: Brass
Shape: Round
Handle Type: Lever
Assembly Required: No
Installation Type: Wall
Metal Lever Handle
For Proper Installation, Requires Use Of a
Thermostatic Valve and Trim
Optional Rough-In Valve

CONTENTS

VOLUME CONTROL	PAGE 2
VALVE	PAGE 3

REVISED 10/05/2020

EDENTON

VOLUME CONTROL

SKU: 948908

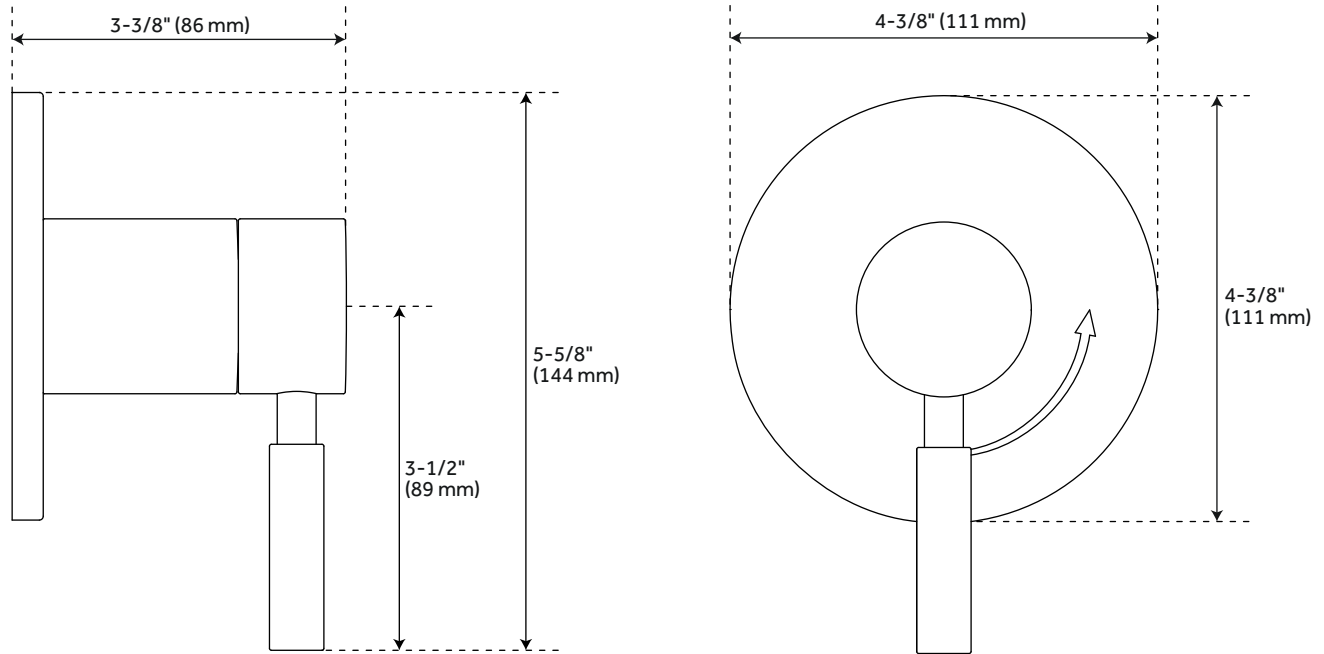

FEATURES

Width: 4-3/8"
Height: 4-3/8"
Depth: 3-3/8"
Wall Thickness Range: 1" to 1-3/4"

CODES/STANDARDS

cUPC
ASME A112.18.1/CSA B125.1
ADA compliant (when installed
according to ADA standards)
Massachusetts Accepted

PRODUCT IMAGE



All dimensions and specifications are nominal and may vary. Use actual products for accuracy in critical situations.

PAGE 2
Code: SHED9007

EDENTON

OPTIONAL VOLUME CONTROL VALVE WITH 1/2" -OR- 3/4" CONNECTION

SKU: 948908

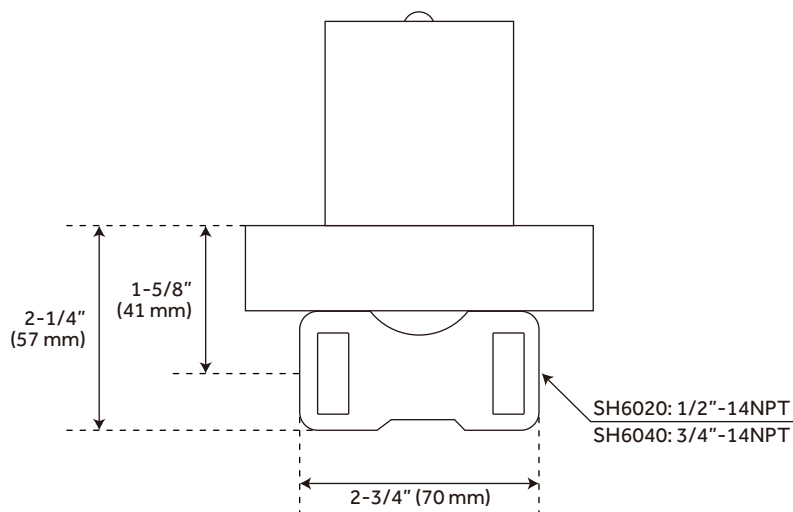
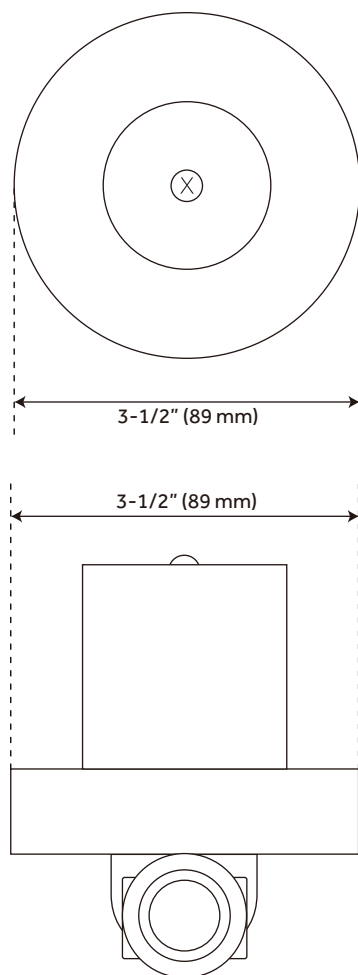

FEATURES

- Brass Valve Body
- Ceramic Cartridge
- Recommended Valve Installation Depth 1-5/8" to 2-3/8"

CODES/STANDARDS

- cUPC
- ASME A112.18.1/CSA B125.1
- Massachusetts Accepted

PRODUCT IMAGE



All dimensions and specifications are nominal and may vary. Use actual products for accuracy in critical situations.

PAGE 3
Code: SH6020, SH6040