



MULTI FITTINGS

LAYING LENGTH

ISSUE DATE: OCT 30/17
SUPERCEDES: MAR 11/05

TEST TEE SANITARY

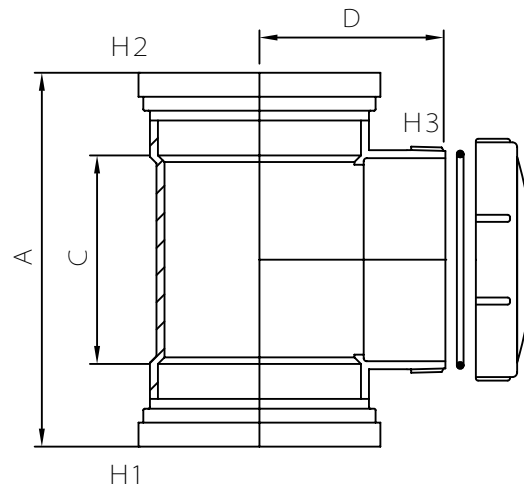

INJECTION MOLDED FITTING (M)

	SIZE H1xH2xH3	PART NUMBER	A REF	C REF	D REF
M #	4x4x4	043646	9.000	4.875	3.375
M #	6x6x4	043649	11.500	6.375	4.375

Note: # Refer to Page G4 - 1 for Hub Detail, Type B