

Installer's Guide

Customer Property: Contains wiring and service information. Please retain.

**DMPR-IN-38A
18-HE60D104-1**

Library	Service Literature
Product Section	Unitary
Product	Unitary Accessories
Model	Econ., Dmprs. Motors, etc.
Literature Type	Installer's Guide
Sequence	38A
Date	October 2001
File No.	SV-UN-ACC-DMPR-IN-38A 10/01
Supersedes	-DMPR-IN-38

Models : Used With:

BAYDMPR051A T*C036-060A*R
 Y*C036-060A*R
 WSC036-060A*R

BAYDMPR052A T*C036-060A*E
 Y*C036-060A*E

BAYDMPR054A T*C072-120A*R
 Y*C072-120A*R
 WSC072-120A*R

BAYDMPR055A T*C072-120A*E
 Y*C072-120A*E

0-50% Motorized Outside Air Damper

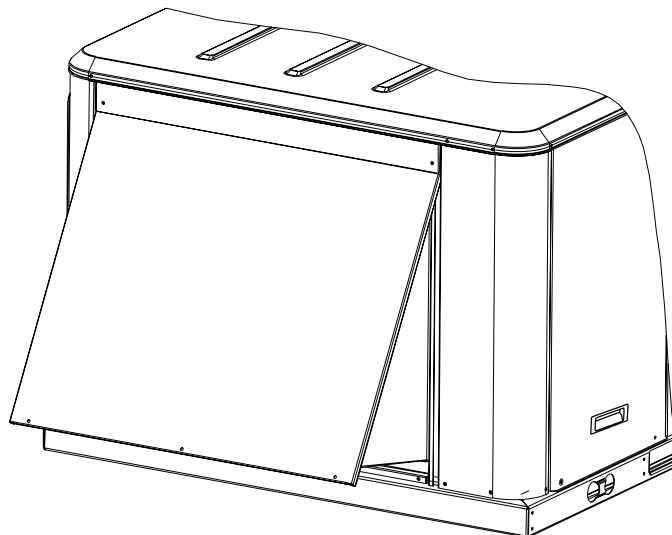

Installation - Field Installed

Note: This instruction covers installation of BAYDMPR051A, BAYDMPR052A (T/W/Y036-060 units) and BAYDMPR054A, BAYDMPR055A (T/W/Y072-120 units)

Parts List

- 1 - Motorized OA Damper Assembly
- 10 - Screws (T/W/Y036-060 units)
- 12 - Screws (T/W/Y072-120 units)
- 1 - Sealant; Silicone Rubber
- 1 - Blockoff; Bottom

Uncrate the damper and locate all parts shown in Figure 1.

⚠ WARNING: OPEN AND LOCK UNIT DISCONNECT TO PREVENT INJURY OR DEATH FROM ELECTRICAL SHOCK OR CONTACT WITH MOVING PARTS.

Each damper ships with items 1, 2 and 3 attached. Remove screws completely from items 1 and 2. Remove item 3 by loosening the 3 screws but do not remove them. Refer to Figure 1.

Figure 1

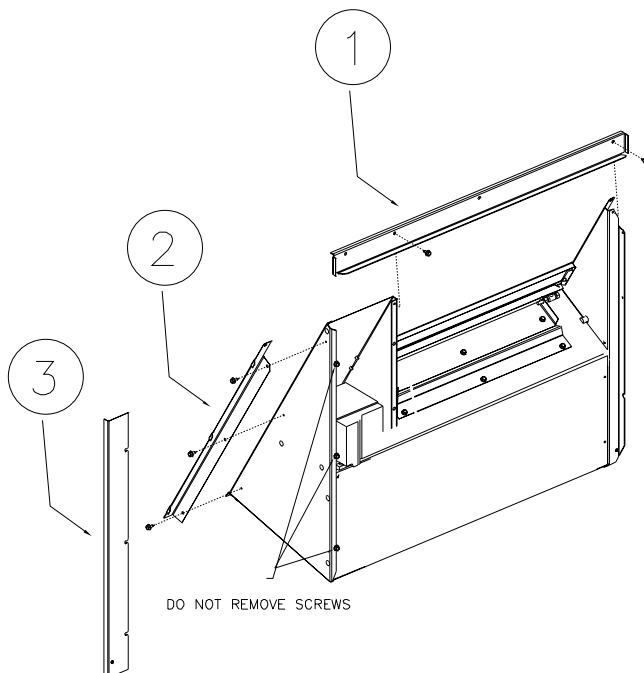

1. Remove unit end panel, retain the screws removed from the top of panel and the screws removed from bottom of panel for use later.
2. To install the damper, lift into position by fitting the upper left hand corner around the channel in the cabinet post. Then pivot the economizer into the opening in the cabinet. Refer to Figure 3.

3. Once the damper is in place, lift the damper and panel assembly to align the upper two screw holes. Secure the top by inserting 2 screws, top left 1 then top right 2. Refer to Figure 3.
4. Pull out on the bottom of the damper and secure bottom left 3. Refer to Figure 3.

Figure 2
Downflow Installation

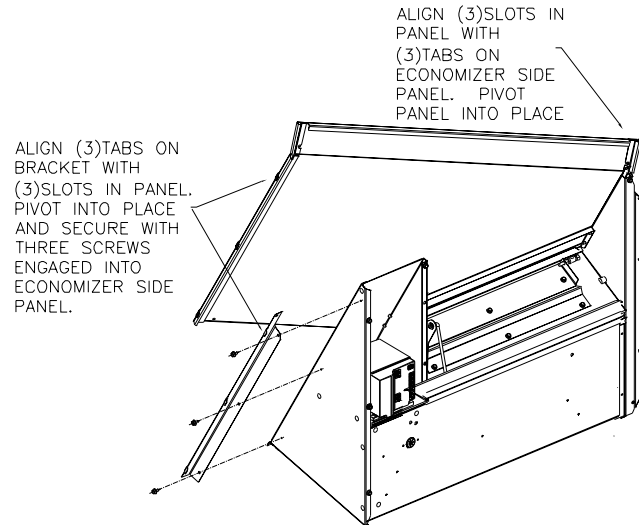

5. Remove the filter access panel. Position the adapter backing plate inside the filter section. The adapter backing plate will slip over the 3 screws that were loosened in Figure 1. Align the screw engagement hole in the adapter backing plate, with the screw clearance hole in panel and secure lower right side of damper with screw 4. Refer to Figure 3.
6. Install the bottom blockoff and secure with 3 screws. Refer to Figure 3.
7. Refer to Figure 6 for sealing instructions.

Wiring Connections

Reliatel Units

Locate unit wiring harness plug P7 and plug into J7 on the actuator motor.

Electromechanical Units

Locate unit wiring harness plug PPM2A and plug into the actuator motor wiring harness.

Figure 3

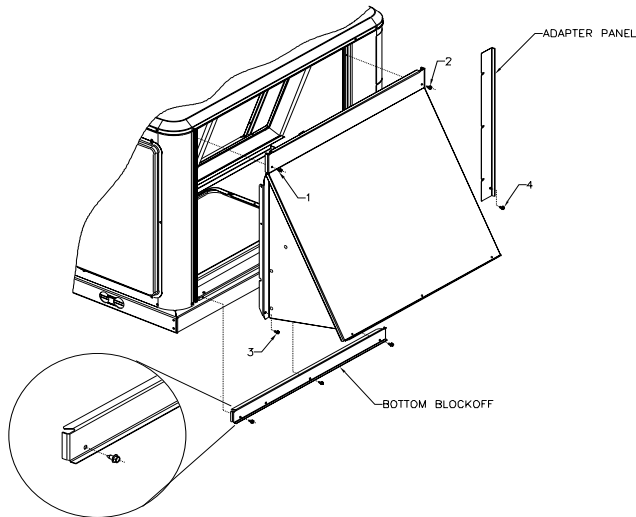

Instructions - Factory Installed Damper Set-Up

Downflow Configuration

To position damper for Downflow operation, complete the following steps:

⚠ WARNING: OPEN AND LOCK UNIT DISCONNECT TO PREVENT INJURY OR DEATH FROM ELECTRICAL SHOCK OR CONTACT WITH MOVING PARTS.

1. Remove filter access panel.
2. Remove bottom blockoff from its shipping location. See Figure 4.

Figure 4

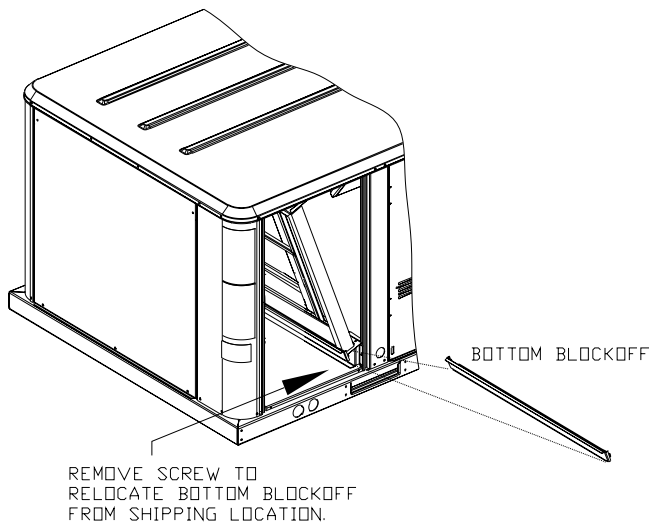

3. Remove the bottom three screws from the damper panel.
4. Pull the damper assembly out into operating position as shown in Figure 5.

5. Secure the damper assembly with 2 screws at the bottom of the corner posts.
6. Install bottom blockoff and secure with 3 screws.
7. Refer to Figure 6 for sealing instructions.

Figure 5

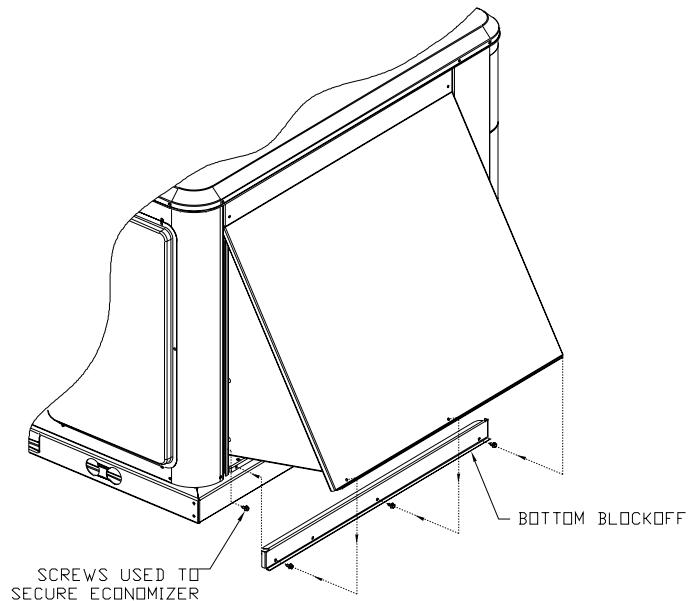

Minimum Position Setting

To adjust the minimum position setting and check out the damper, the power must be connected.

Close the unit disconnect and place the zone sensor fan selector in the fan "ON" position and the heat/cool selector in the "OFF" position. This will place the damper in the minimum ventilation position.

To adjust the minimum position setting for the required ventilation air, turn the potentiometer (on the damper motor) clockwise to "open" (to increase the amount of ventilation) or counterclockwise to "close" (to decrease the amount of ventilation). The damper will open to this setting each time the blower circuit is energized.

When adjusting minimum position, the damper may move to the new setting in several small steps. Once the damper has remained in position for 10 - 15 seconds without movement, it can be assumed it is at the new position.

Replace the filter access panel.

The damper will close when the blower circuit is de-energized.

Dry Bulb Setting

Standard economizer dry bulb change over temperature is field selectable to 4 outdoor temperatures. See the following table for potentiometer settings.

Potentiometer Setting	Dry Bulb	Enthalpy
A	73*	27
B	70	25
C	67	23
D	63	22

* Factory Setting

Figure 6

