

NDS D1200 Meter Box

NDS WATER METER BOXES AND COVERS

Standard Commercial Grade

The NDS D1200 body shall be tapered and have a minimum wall thickness of .187". The body shall have a double wall at the top cover seat area with a minimum thickness of .187". The cover seat area shall have 30 structural support ribs on the underside of the seat, each with a minimum thickness of 3/16". The bottom of the body shall have a 1" flange and has the ability to be anchored to concrete. The D1200 cover shall have a minimum thickness of .250". NDS D1200 meter boxes and covers are injection molded of high density polyethylene material with a melt index between 10-12. Coloring and UV stabilizers are added, along with processing lubricants when needed. Manufactured according to AASHTO A-0.3 requirements.

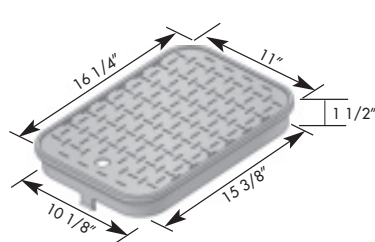

Overlapping Solid Cover

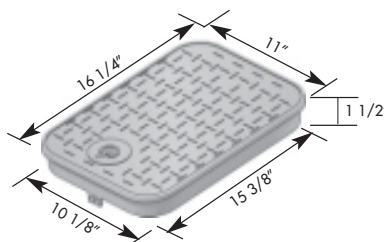

Overlapping Locking Cover

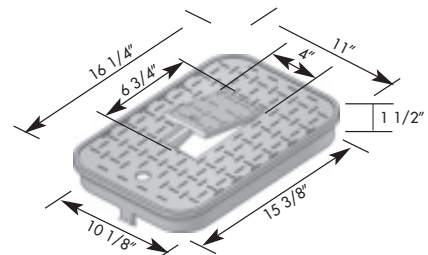

Overlapping Reader Cover

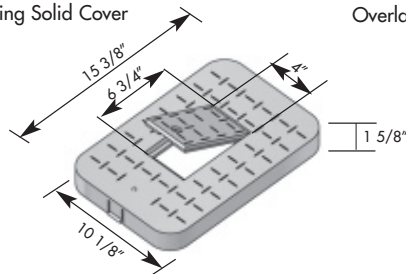

Drop In Reader Cover

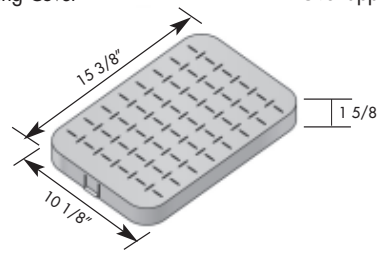

Drop In Solid Cover

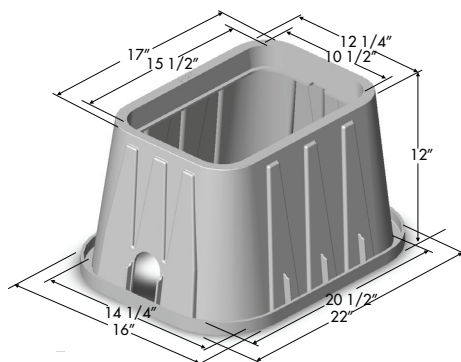

Standard Box

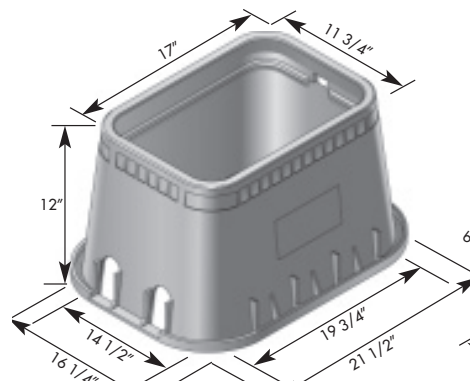

Dual Outlet Box

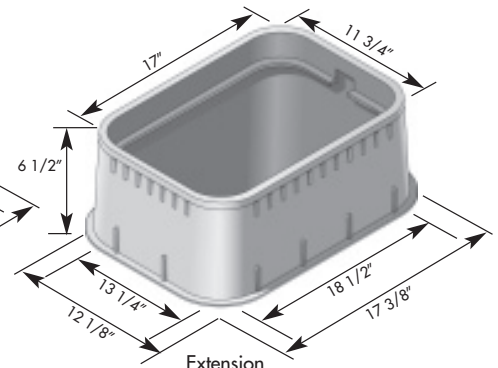

Extension

PART NUMBER	WEIGHT	BOX DESCRIPTION	COVER DESCRIPTION	COVER TYPE	COLOR (BOX /COVER)	WEIGHT
Drop In Box & Cover						
D1200-DISB		12"x17"x12" Standard Box	Drop-in Cover - Water Meter	Solid Plastic	Black/Black	9.00
D1200-DUDISB		12"x17"x12" Standard Dual	Box Drop-in Cover - Water Meter	Solid Plastic	Black/Black	9.00
D1200-DISBLU		12"x17"x12" Standard Box	Drop-in Cover - Water Meter	Solid Plastic	Black/Blue	9.00
D1200-DIRB		12"x17"x12" Standard Box	Drop-in Meter Reader Cover - Water Meter	Plastic w/ Plastic Reader	Black/Black	9.00
D1200-DUDIRB		12"x17"x12" Standard Dual Box	Drop-in Meter Reader Cover - Water Meter	Plastic w/ Plastic Reader	Black/Black	9.00
D1200-DIRB CET		12"x17"x12" Standard Box	Drop-in Meter Reader Cover - CESPT (1" x 1" letters)	Plastic w/ Plastic Reader	Black/Black	9.00
D1200-DIBLRD		12"x17"x12" Standard Box	Drop-in Meter Reader Cover - Water Meter	Plastic w/ Plastic Reader	Black/Blue	9.00
D1200-DIRG		12"x17"x12" Standard Box	Drop-in Meter Reader Cover - Water Meter	Plastic w/ Plastic Reader	Black/Green	9.00
D1200-DICIR		12"x17"x12" Standard Box	Drop-in Meter Reader Cover - Water Meter	Plastic w/ Cast Iron Reader	Black/Black	10.20
D1200-DUDICIR		12"x17"x12" Standard Dual Box	Drop-in Meter Reader Cover - Water Meter	Plastic w/ Cast Iron Reader	Black/Black	10.20
D1200P-DICIRP		12"x17"x12" Standard Box	Drop-in Meter Reader Cover - Reclaimed	Plastic w/ Cast Iron Reader	Purple/Purple	10.20
Overlapping Box & Cover						
D1200-OLSB		12"x17"x12" Standard Box	Overlapping Cover - Water Meter	Solid Plastic	Black/Black	9.20
D1200-DUOLSB		12"x17"x12" Standard Dual Box	Overlapping Cover - Water	Meter Solid Plastic	Black/Black	9.20
D1200-OLLOCB		12"x17"x12" Standard Box	Overlapping Locking Cover - Water Meter	Solid Plastic	Black/Black	9.40
D1200-CI		12"x17"x12" Standard Box	Overlapping Cast Iron Cover - Water Meter	Solid Cast Iron	Black/Black	19.00
D1200-OLRB		12"x17"x12" Standard Box	Overlapping Meter Reader Cover - Water Meter	Plastic w/ Plastic Reader	Black/Black	9.20
D1200-DUOLRB		12"x17"x12" Standard Dual Box	Overlapping Meter Reader Cover - Water Meter	Plastic w/ Plastic Reader	Black/Black	9.20
D1200-OLRBLU		12"x17"x12" Standard Box	Overlapping Meter Reader Cover - Water Meter	Plastic w/ Plastic Reader	Black/Blue	9.20
D1200-OLCIR		12"x17"x12" Standard Box	Overlapping Meter Reader Cover - Water Meter	Plastic w/ Cast Iron Reader	Black/Black	10.60
D1200-CICIR		12"x17"x12" Standard Box	Overlapping Cast Iron Meter Reader Cover - Water Meter	Cast Iron w/ Cast Iron Reader	Black/Black	10.28
Drop In Cover Only						
D1200-DISBL			12"x17" Standard Drop-in Cover - Water Meter	Solid Plastic	Black	2.20
D1200-DISBLUL			12"x17" Standard Drop-in Cover - Water Meter	Solid Plastic	Blue	2.20
D1200-DIRBL			12"x17" Standard Drop-in Meter Reader Cover - Water Meter	Plastic w/ Plastic Reader	Black	2.20
D1200-DIBLRDL			12"x17" Standard Drop-in Meter Reader Cover - Water Meter	Plastic w/ Plastic Reader	Blue	2.20
D1200-DIRP LID			12"x17" Standard Drop-in Meter Reader Cover - Reclaimed	Plastic w/ Plastic Reader	Purple	2.20
D1200-DICIRLID			12"x17" Standard Drop-in Meter Reader Cover - Water Meter	Plastic w/ Cast Iron Reader	Black	3.40
D1200-DICIRPLD			12"x17" Standard Drop-in Meter Reader Cover - Reclaimed	Plastic w/ Cast Iron Reader	Purple	3.40
Overlapping Cover Only						
D1200-OLSDL			12"x17" Standard Overlapping Cover - Water Meter Solid	Plastic	Black	2.40
D1200-OLLOCBLD			12"x17" Standard Overlapping Locking Cover - Water Meter	Solid Plastic	Black	2.60
D1200-OLBLL			12"x17" Standard Overlapping Cover - Water Meter	Solid Plastic	Blue	2.40
D1200-CIL			12"x17" Standard Cast Iron Cover - Water Meter	Solid Cast Iron	Black	12.20
D1200-OLSPDL			12"x17" Standard Overlapping Cover - Reclaimed	Solid Plastic	Purple	2.40
D1200-OLRBL			12"x17" Standard Overlapping Meter Reader Cover - Water Meter	Plastic w/ Plastic Reader	Black	2.40
D1200-OLRBLUL			12"x17" Standard Overlapping Meter Reader Cover - Water Meter	Plastic w/ Plastic Reader	Blue	2.40
D1200-OLCIR LD			12"x17" Standard Overlapping Meter Reader Cover - Water Meter	Plastic w/ Cast Iron Reader	Black	3.80
D1200-CICIR LD			12"x17" Standard Cast Iron Meter Reader Cover - Water Meter	Cast Iron w/ Cast Iron Reader	Black 1	5.40
Box Only						
D1200-B/O		12"x17"x12" Standard Box			Black	6.80
D1200-BDB/O		12"x17"x12" Standard Bolt Down Box			Black	7.00
D1200-DUB/O		12"x17"x12" Standard Dual Box			Black	6.80
D600E-EXT		12"x17"x6" Extension Only			Black	4.20

Call for additional options and availability

PROPERTIES OF UNFOAMED RESIN		
	ASTM Test Method	HDPE
Tensile Strength, Yield	ASTM D 638	3300 psi
Density	ASTM D 792	0.95 gm/cc
Density Test	ASTM D 1505	0.95 gm/cc
Durometer, Shore D	ASTM D 2240	66
Flexural Modulus	ASTM D 790	191,000 psi
Notched Izod Impact Strength @ 23 degrees C.	ASTM D 256	1.43 ft. lbs/in.
Notched Izod Impact Strength @ 18 degrees C.	ASTM D 256	6.8 ft. lbs/in.
Heat Deflection Temperature @ 66 PSI, Degrees F.	ASTM D 648	209 degrees F.

SHIPPING CONFIGURATION			
	Box	Extension	Lid
Pallet	72	42	216
Pieces per Stack	12	7	21
Stack per Pallet	6	6	10
Pallet Dimensions	42"x48"x48"	42"x42"x48"	42"x42"x42"



ndspro.com

NDS Technical Services
851 N. Harvard Ave, Lindsay, CA 93247
Phone: (888) 825-4716 • (559) 562-9888
Fax: (800) 726-1998 • (559) 562-4488
TechService@ndspro.com
www.ndspro.com