

2009 EDITION

4"–36"

**TR FLEX®**

RESTRAINED JOINT DUCTILE IRON PIPE AND FITTINGS



FOR FIRE PROTECTION, WATER & WASTEWATER

**MORE  
THAN  
JUST  
PIPE.**



866.DIP.PIPE



TR FLEX®

RESTRAINED JOINT DUCTILE IRON PIPE AND FITTINGS

NSF

Certified to ANSI/AWWA C900

2009 EDITION

P 2

## Table of Contents

TR FLEX Restrained Joint Pipe and Fittings 4"-36"	3
Suggested Specification Wording For 4"-36" Restrained Push-on Joint Pipe and Fittings	4
TR FLEX Assembly Instructions	5
Pipe and Fittings 4"-10"	7
Pipe and Fittings 12"-20"	8
Pipe and Fittings 24"-36"	9
Pipeline Expansion	10
TR FLEX Field Cut Pipe	11
TR FLEX GRIPPER® Rings	13
Notes Regarding the Use of Restrained Joint Pipe	19
TR FLEX Restrained Joint Pipe and Fittings - Basic Dimensions	21
Pressure Class - TR FLEX Pipe	22
Thickness Class - TR FLEX Pipe	24
Rubber Locking Segment Retainers for TR FLEX Pipe and Fittings	27
TR FLEX Bends	28
TR FLEX Tees	31
TR Flex Crosses	35
TR FLEX Wye Branches	37
TR FLEX Reducers	39
TR FLEX Flange Connecting Piece	41
TR FLEX Telescoping Sleeves	42
TR FLEX Sleeve/Connecting Piece	43
TR FLEX Caps and Plugs	44
Products for Water, Wastewater and Fire Protection	45

U.S. PIPE AND FOUNDRY CO. TR FLEX RESTRAINED JT. PIPE AND FITTINGS BRO-009

REVISED 11.09

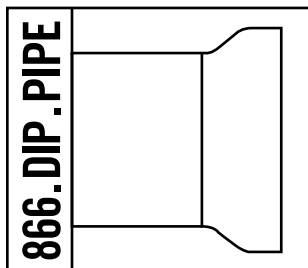

	
<h1>TR FLEX®</h1> <h2>RESTRAINED JOINT DUCTILE IRON PIPE AND FITTINGS</h2>	
	<b>2009 EDITION</b>
<b>P 3</b>	

## TR FLEX Restrained Joint Pipe and Fittings 4"-36"

**TR FLEX Pipe and Fittings** provide flexible restrained push-on joints for 4" through 36" Ductile Iron pipe and fittings. The TR FLEX Restrained Joint has a working pressure rating equivalent to the working pressure rating of the parent pipe with a maximum working pressure rating of 350 psi for 4" through 24" and 250 psi for 30" through 36".

For fire protection service, 4" through 12" pipe and fittings are listed by Underwriters Laboratories for 350 psi and are approved by Factory Mutual for 250 psi.

TR FLEX Pipe and Fittings utilize the conventional TYTON® Gasket for 4" through 36" sizes.

Ductile Iron locking segments, inserted through a slot (or slots) in the bell face, provide a positive axial lock between the bell interior surface and a retainer weldment on the spigot end of the pipe.

*\*For higher pressure ratings, consult your U.S. Pipe Sales Representative.*

*For a suggested design procedure for the restraint of thrust forces in pressurized, buried Ductile Iron piping systems, the design engineer should refer to the current DIPRA publication "Thrust Restraint Design for Ductile Iron Pipe" or the U.S. Pipe Brochure "The Use And Application of Restrained Joints for Ductile Iron Pipelines."*

### ANSI/AWWA Standards

#### **ANSI/AWWA C151/A21.51 "Ductile-Iron Pipe, Centrifugally Cast, for Water."**

Asphaltic outside coating and inside lining are in accordance with ANSI/AWWA C151/A21.51.

#### **ANSI/AWWA C153/A21.53 "Ductile-Iron Compact Fittings For Water Service" or ANSI/AWWA C110/A21.10 "Ductile-Iron and Gray-Iron Fittings, 3 In. Through 48 In., For Water."**

TR FLEX® Fittings conform to applicable requirements of ANSI/AWWA C153/A21.53 or ANSI/AWWA C110/A21.10.

#### **ANSI/AWWA C104/A21.4 "Cement-Mortar Lining for Ductile-Iron Pipe and Fittings for Water."**

Cement lining, in accordance with ANSI/AWWA C104 or special linings and/or coatings can be furnished for specific conditions.

#### **ASTM A746-03 "Standard Specification for Ductile Iron Gravity Sewer Pipe."**

#### **ASTM A716-08 "Standard Specification for Ductile Culvert Pipe."**

#### **ASTM A536 "Standard Specification for Ductile Iron Castings."**

**NOTE:** *If specifiers or users believe that corrosive soils will be encountered where our products are to be installed, please refer to ANSI/AWWA C105/A21.5 "Polyethylene Encasement for Ductile Iron Pipe Systems" for proper external protection procedures.*

*For certain wastewater applications a ceramic epoxy lining is available - see PROTECTO 401™ Ceramic Epoxy Lined Pipe and Fittings Brochure.*

*TR FLEX®, TR FLEX GRIPPER®, TYTON® and TYTON JOINT® are Registered Trademarks of U.S. Pipe and Foundry Co., LLC.*

866.DIP.PIPE		<div style="text-align: center;">  </div> <h1 style="margin: 0;">TR FLEX®</h1> <h2 style="margin: 0;">RESTRAINED JOINT DUCTILE IRON PIPE AND FITTINGS</h2>			
			2009 EDITION		P 4

## Suggested Specification Wording For 4"-36" Restrained Push-on Joint Pipe and Fittings

When joint restraint for a 4" through 36" push-on joint pipe installation is required and indicated in the project plans and specifications, restrained push-on joint pipe and fittings utilizing Ductile Iron components shall be provided.

Restrained joint pipe shall be Ductile Iron manufactured in accordance with the requirements of ANSI/AWWA C151/A21.51. Push-on joints for such pipe shall be in accordance with ANSI/AWWA C111/A21.11 "Rubber-Gasket Joints for Ductile-Iron Pipe and Fittings." Pipe thickness shall be designed in accordance with ANSI/AWWA C150/A21.50 "Thickness Design of Ductile-Iron Pressure Pipe," and shall be based on laying conditions and internal pressures as stated in the project plans and specifications.

Restrained joint fittings and the restraining components shall be Ductile Iron in accordance with applicable requirements of ANSI/AWWA C110/A21.10 and/or C153/A21.53 with the exception of the manufacturer's proprietary design dimensions. Push-on joints for such fittings shall be in accordance with ANSI/AWWA C111/A21.11.

Restrained joint pipe and fittings shall be U.S. Pipe's TR FLEX Pipe and Fittings or approved equal. Restraint of field cut pipe shall be provided with U.S. Pipe's TR FLEX GRIPPER® Ring, TR FLEX Pipe field weldments or approved equal.

Cement mortar lining and seal coating for pipe and fittings, where applicable, shall be in accordance with ANSI/AWWA C104/A21.4. Asphaltic outside coating shall be in accordance with ANSI/AWWA C151/A21.51 for pipe and ANSI/AWWA C110/A21.10 or ANSI/AWWA C153/A21.53 for fittings.

Restrained push-on joints for pipe and fittings shall be designed for a water working pressure of 350 psi for sizes 4" through 24" and 250 psi for sizes 30" through 36".

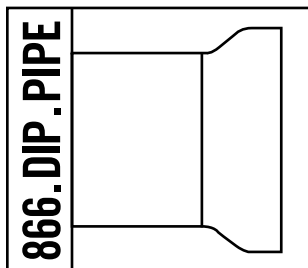

# TR FLEX®

## RESTRAINED JOINT DUCTILE IRON PIPE AND FITTINGS



2009 EDITION

P 5

## Assembly Instructions for Pipe and Fittings

**CAUTION: THE INSIDE OF THE SOCKET, THE GASKET, AND THE PLAIN END TO BE INSERTED, MUST BE KEPT CLEAN THROUGHOUT THE ASSEMBLY. JOINTS ARE ONLY AS WATERTIGHT AS THEY ARE CLEAN. IF THE JOINT IS SOMEWHAT DIFFICULT TO ASSEMBLE, INSPECT FOR PROPER GASKET POSITIONING, ADEQUATE LUBRICATION, AND REMOVAL OF FOREIGN MATTER IN THE JOINT.**

The recommended orientation of segment insertion slots located in the face of the TR FLEX Pipe bell is important for ease of assembly and is also used as a reference point for location of welded outlets (refer to U.S. Pipe's Welded Outlet brochure). Therefore particular attention should be paid to that portion of the assembly instructions.

Clean the sockets of all dirt, sand, gravel, or other foreign matter.

Conventional TYTON® Gaskets are used for TR FLEX Pipe and Fitting sockets in the 4" through 36" size range.

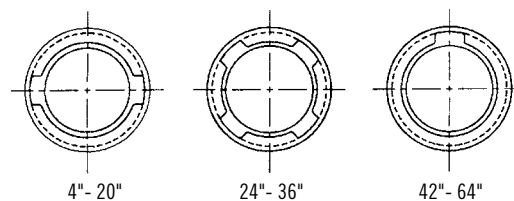

Insertion Slot Orientation

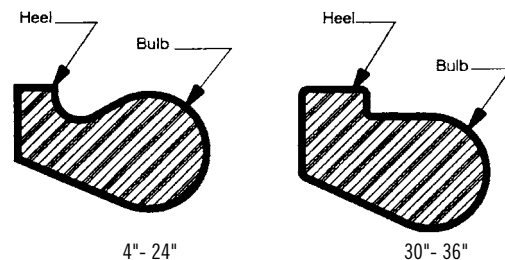

Gasket Installation

**NOTE:** For the 4" through 10" sizes where TR FLEX GRIPPER® Rings are not used, it may be preferable to locate the bell slots vertically with only the slot in the 12 o'clock position being used for inserting locking segments.

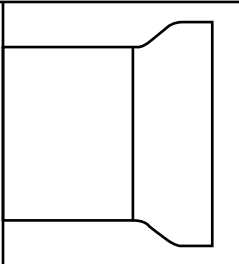

## Assembly Instructions for Pipe and Fittings (cont.)

Clean the gasket and the socket. Loop the gasket as shown in the illustrations. Place the gasket into the mating gasket seating area of the socket with the rounded bulb end of the gasket entering first. Seat the gasket heel firmly in the retainer groove of the socket.

Smaller size gaskets (4" through 12") require only one loop. With larger sizes, additional loops may be required: 14" through 36", two to three loops. Do not apply lubricant to the gasket seat.

Make sure the gasket is uniformly seated around the inside of the socket.

In colder weather, the gaskets should be kept at temperatures above 40°F to ensure the resiliency of the gasket during installation. In such conditions, the gaskets should be stored in a heated area or heated in drums of hot water prior to installation. If warm water is used, the gaskets should be dried before installation in the socket.

### Lubrication

After the gasket has been inserted into the gasket seating area of the socket, a thin film of TYTON JOINT® Lubricant should be applied to the inside surface of the gasket which will come in contact with the beveled end of the pipe. In warm, dry weather conditions, the lubricant can dry out, especially when applied to warm or hot pipe, it will be necessary to add a small amount of water to hydrate the lubricant. Only TYTON JOINT Lubricant should be used.

**CAUTION:** The use of spray-on lubricant is not recommended. Experience has determined that spray-on lubricant may not have sufficient lubricity to allow joint assembly without gasket displacement.

Clean the spigot end of the pipe back to the assembly stripes. Apply TYTON JOINT Lubricant to the cleaned spigot end. Do not allow the lubricated surface to touch the ground or trench sides prior to installation.



**NOTE:** For underwater installations, a special lubricant is available from U.S. Pipe.

## Assembly Instructions for Pipe and Fittings 4"-10"

### Two Bell Slots

1. Lay pipe or fitting such that one of the bell slots is accessible.
2. Clean the socket and insert a TYTON® Gasket.
3. Clean the pipe spigot end back to the assembly stripes.
4. Lubricate the exposed surface of the gasket and the pipe spigot end back to the weld bead.
5. Make a conventional push-on joint assembly, fully homing the pipe until the first assembly stripe is in the bell socket. Keep the joint in straight alignment during assembly.
6. Insert the right-hand locking segment into a bell slot and slide the segment clockwise around the pipe.
7. Insert the left-hand locking segment into the same bell slot and slide the segment counter-clockwise around the pipe.
8. Hold the segments apart and wedge the rubber retainer into the slot between the two locking segments. The opposite bell slot is not used but is required for use with a TR FLEX GRIPPER® Ring.
9. Extend the joint to remove the slack in the locking segment cavity. Joint extension is necessary to obtain the marked laying length on the pipe and to minimize growth or extension of the line as it is pressurized. (Refer to the Table on page 22 for average pull-out of each size.)
10. Set the joint deflection as required. (See Table on page 22.)

### Components required for each joint:

*1 right-hand locking segment  
(painted red, marked RH)*

*1 left-hand locking segment  
(painted black, marked LH)*

*1 rubber retainer*

*1 TYTON® Gasket*

*TYTON JOINT® Lubricant*

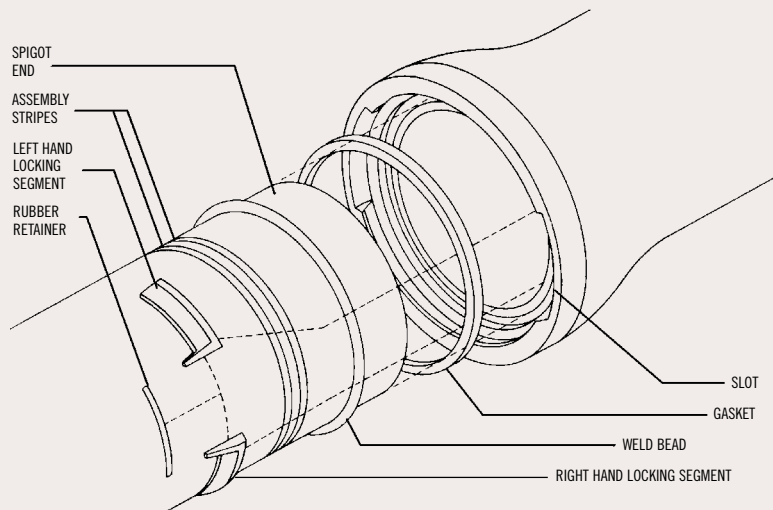

## Assembly Instructions for Pipe and Fittings 12"-20"

### Two Bell Slots

1. Lay pipe or fitting such that both of the bell slots are accessible (in the horizontal position if possible).
2. Clean the socket and insert a TYTON® Gasket.
3. Clean the pipe spigot end back to the assembly stripes.
4. Lubricate the exposed surface of the gasket and the pipe spigot end back to the weld bead.
5. Make a conventional push-on joint assembly, fully homing the pipe until the first assembly stripe is in the bell socket. Keep the joint in straight alignment during assembly.
6. Insert lower locking segment into a bell slot and slide the segment around the pipe.
7. Insert upper locking segment into the same bell slot and rotate around the pipe.
8. Hold the upper segment in place and wedge the rubber retainer into the slot between the two locking segments.
9. Repeat steps 6-8 for other slot. Make sure that all 4 locking segments and 2 rubber retainers are securely in place.
10. Extend the joint to remove the slack in the locking segment cavity. Joint extension is necessary to attain the marked laying length on the pipe and to minimize growth or extension of the line as it is pressurized. (Refer to the Table on page 22.)
11. Set the joint deflection as required. (See Table on page 22.)

### Components required for each joint:

2 right-hand locking segments  
(painted red, marked RH)

2 left-hand locking segments  
(painted black, marked LH)

2 rubber retainers

1 TYTON® Gasket

TYTON JOINT® Lubricant

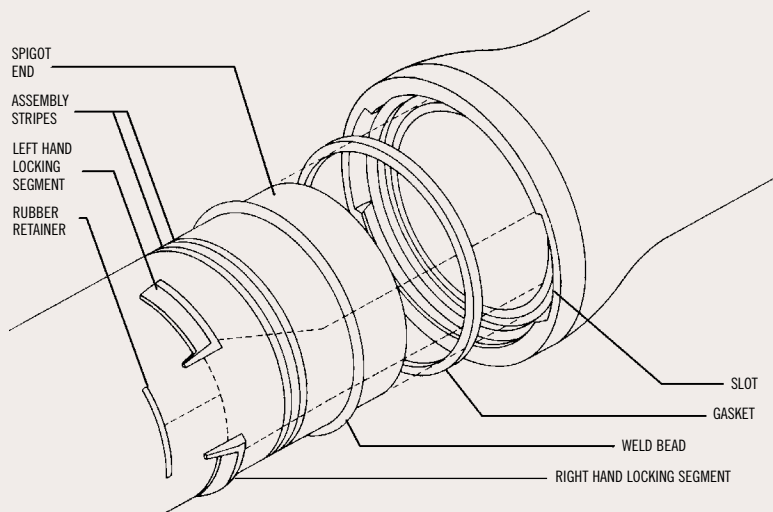



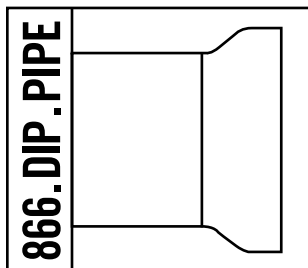

# TR FLEX®

## RESTRAINED JOINT DUCTILE IRON PIPE AND FITTINGS



2009 EDITION

P 9

## Assembly Instructions for Pipe and Fittings 24"-36"

### Four Bell Slots

1. Lay pipe or fitting such that all four of the bell slots are accessible (in the diagonal position if possible).
2. Clean the socket and insert a TYTON® Gasket.
3. Clean the pipe spigot end back to the assembly stripes.
4. Lubricate the exposed surface of the gasket and the pipe spigot end back to the weld bead.
5. Make a conventional push-on joint assembly, fully homing the pipe until the first assembly stripe is in the bell socket. Keep the joint in straight alignment during assembly.
6. Insert lower locking segment into a bell slot and slide the segment around the pipe.
7. Insert upper locking segment into the same bell slot and rotate around the pipe.
8. Hold the upper segment in place and wedge the rubber retainer into the slot between the two locking segments.
9. Repeat steps 6-8 for other slots. Make sure that all 8 locking segments and 4 rubber retainers are securely in place.
10. Extend the joint to remove the slack in the locking segment cavity. Joint extension is necessary to attain the marked laying length on the pipe and to minimize growth or extension of the line as it is pressurized. (Refer to the Table on page 22.)
11. Set the joint deflection as required. (See Table on page 22.)

### Components required for each joint:

4 right-hand locking segments  
(painted red, marked RH)

4 left-hand locking segments  
(painted black, marked LH)

4 rubber retainers

1 TYTON® Gasket

TYTON JOINT® Lubricant

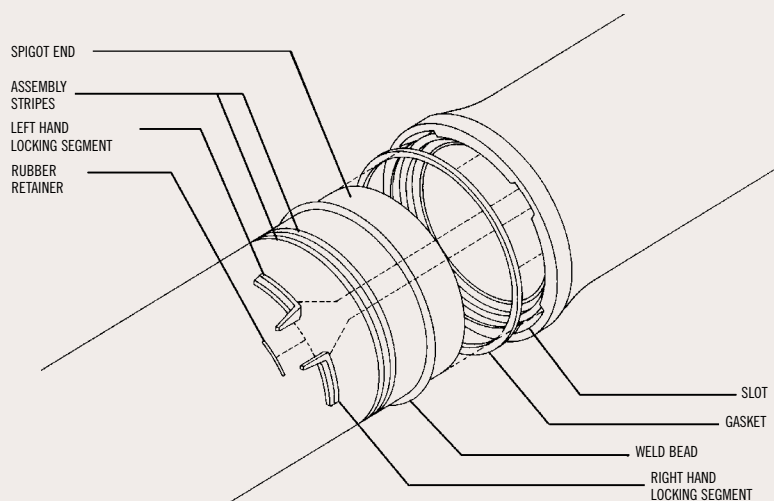

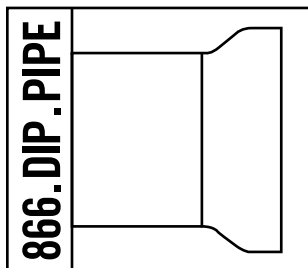

# TR FLEX®

## RESTRAINED JOINT DUCTILE IRON PIPE AND FITTINGS



2009 EDITION

P 10

## Pipeline Expansion

### TR FLEX Pipe and Fittings Socket Pull Out

(Linear Expansion Within The Assembled Socket)

In TR FLEX Pipe and Fitting sockets, there is a small amount of slack or pullout available at each joint. This pullout, or expansion capability, is the result of clearance inside the socket required for the insertion of the locking segments. The expansion can be minimized by extending the joint after installing the locking segments and prior to setting the joint deflection.

The expansion of the joint in both pipe and fitting sockets must be considered, particularly in the following cases:

- When TR FLEX Pipe are used above ground (bridge crossings, on piers, etc.)
- When TR FLEX Pipe are used in poor soil conditions (swamps, marshes, etc.)
- When long lengths of TR FLEX Pipe are required for restraint due to high operating pressures and/or unfavorable soil parameters
- Where TR FLEX Pipe are used inside casing pipe
- Where TR FLEX Pipe and Fittings are in vertical alignment

When TR FLEX Pipe are used inside a casing pipe, it is recommended that the assembled pipe be pulled through the casing. Additional security may be required to ensure that the locking segments are adequately retained in the socket during such installation.

Please note that if the joint is not extended during assembly, the expansion per joint during line pressurization will increase the length of a 1000 foot long installation by 2 to 5 feet, depending upon the pipe size. (Refer to Table 1 for the Pullout at each joint.)

### Minimum Laying Lengths For TR FLEX Pipe

The following drawings and dimensions in Table 1 define the minimum lengths for TR FLEX pipe when furnished in either Plain End x Plain End, or Bell x Plain End. The minimum laying lengths are determined on the basis of the socket depth and the minimum space required in front of the pipe bell face to insert the locking segments. These minimum laying lengths must be considered when ordering factory cut lengths or field cutting TR FLEX Pipe.

Table 1. Minimum Laying Lengths & Average Pullout For Each TR FLEX Pipe or Fittings Socket

SIZE Inches	DIMENSIONS Inches		PULLOUT Feet
	A	B	
4	12.75	10.25	.03
6	14.00	11.00	.04
8	15.25	12.00	.04
10	15.75	12.25	.05
12	16.50	13.00	.06
14	19.75	15.25	.05
16	20.25	15.50	.05
18	21.00	16.00	.05
20	21.50	16.25	.05
24	23.00	17.25	.05
30	26.25	19.00	.05
36	28.00	20.25	.05

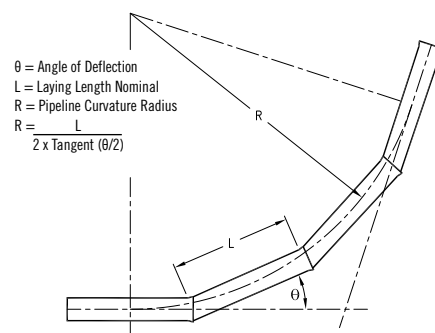
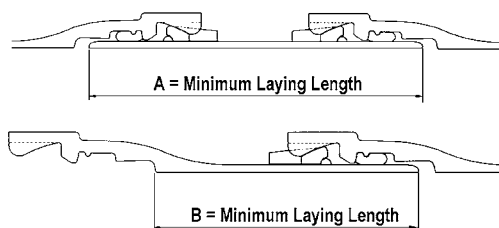

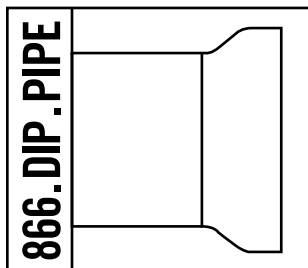

# TR FLEX®

## RESTRAINED JOINT DUCTILE IRON PIPE AND FITTINGS



2009 EDITION

P 11

## TR FLEX Field Cut Pipe Instructions

### Making a Field Cut

Before making the field cut, measure the pipe diameter or circumference at the location to be cut. The diameter or circumference should fall within the range shown in Table 2. If the measurement is not within the prescribed range, another pipe should be selected and checked before cutting.

The pipe must be cut as square as is practical. A field cut end that is not square may leak, especially if the joint is fully deflected. Measure from the factory manufactured spigot end to the desired cut location. Mark the measured distance around the circumference of the pipe at sufficient intervals to determine a square cut-line (a line perpendicular to the axis of the pipe). Scribe the square cut-line around the O.D. of the pipe.

When Ductile Iron pipe 14" and larger is to be cut in the field, the material should be ordered as "GAUGED FULL LENGTH." A *Full Length Gauged Pipe* is a pipe whose barrel outside diameter is within the spigot diameter dimensional specifications as determined by diameter tape measurements over the pipe's length to within approximately two feet of the bell chime. Pipe that is "gauged full length" is specially marked to avoid confusion. ANSI/AWWA C151 Standard for Ductile Iron pipe requires factory gauging of the spigot end. Accordingly, pipe selected for field cutting should also be field gauged in the location of the cut and ensured to be within the tolerances shown in Table 2. In the field a mechanical joint gland can be used as a gauging device.

Cut the pipe. (Abrasive saws are commonly used.) Bevel the field cut end (a disk grinder can be used). Refer to a shop manufactured bevel as a guide for proper shape. Additional grinding may be required to further bevel the pipe if difficulty in assembly of the joint is encountered.

Table 2.

NOM. PIPE SIZE Inches	CIRCUMFERENCE		DIAMETER	
	MINIMUM Inches	MAXIMUM Inches	MINIMUM Inches	MAXIMUM Inches
4	14-7/8	15-9/32	4.74	4.86
6	21-15/32	21-7/8	6.84	6.96
8	28-1/4	28-5/8	8.99	9.11
10	34-11/16	35-1/16	11.04	11.16
12	41-9/32	41-21/32	13.14	13.26
14	47-13/16	48-7/32	15.22	15.35
16	54-13/32	54-13/16	17.32	17.45
18	61	61-13/32	19.42	19.55
20	67-19/32	68-1/32	21.52	21.65
24	80-25/32	81-7/32	25.72	25.85
30	100-11/32	100-25/32	31.94	32.08
36	120-1/32	120-9/16	38.24	38.38

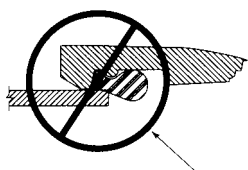

Sharp Edges or Burrs  
Can Cut or Push Gasket

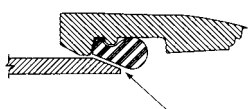

Properly Cut and Beveled End.

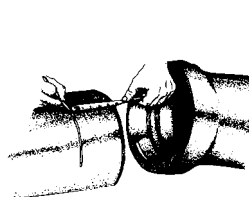

Spiral Cuts Leave  
Jagged Edges



Square Cut End  
With Proper Bevel

## TR FLEX Field Cut Pipe Instructions (cont.)

### Clean Spigot End

Clean the pipe spigot end of any excess coating, cement, dirt, etc. In general, if the peen pattern is not visible on the pipe surface, the coating can be assumed to be too thick and must be removed prior to assembly of the joint.

### Assembly Stripe Tape

It is important to have a highly visible assembly mark accurately located on the pipe spigot end. It is recommended that 2-inch duct tape, or a similar type tape, be used for this assembly stripe.

Measure from the square field cut end to the location shown in the Table 3 and make several marks around the pipe barrel at the measured distance. Apply the tape around the pipe spigot such that the spigot end of the tape is aligned with the marks.

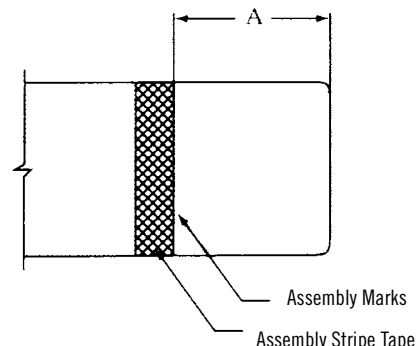

### Unrestrained Field Cut Pipe Instruction Method

The following schematic illustrates the use of a field cut pipe in the unrestrained portions of the line, thus eliminating the requirements for TR FLEX GRIPPER® Rings or field weldments.

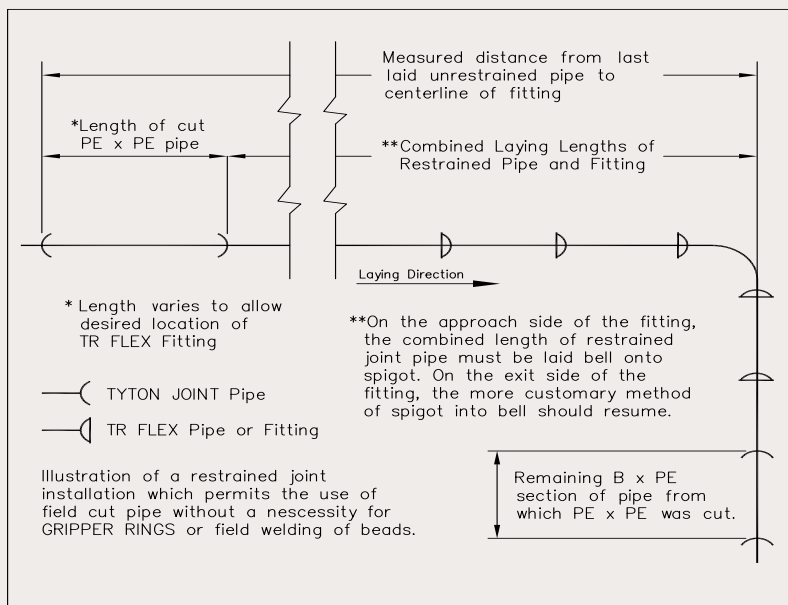

**Table 3. Assembly Stripe Location**

NORMAL PIPE SIZE Inches	A Inches
4	4 3/8
6	4 7/8
8	5 3/8
10	5 5/8
12	5 7/8
14	7 3/8
16	7 1/2
18	7 3/4
20	8
24	8 1/2
30	10
36	10 1/2

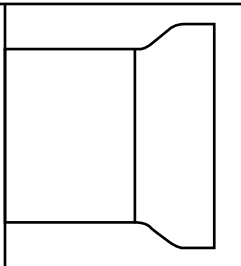

# TR FLEX®

## RESTRAINED JOINT DUCTILE IRON PIPE AND FITTINGS



2009 EDITION

P 13

## TR FLEX GRIPPER® Rings

**TR FLEX GRIPPER** Rings are used to restrain 4" through 36" field cut pipe (pipe without weldment) inside TR FLEX Pipe and Fittings. These joints are suitable for 350 psi working pressure for sizes 4" through 24" and 250 psi working pressure for 30" and 36" products. On many installations a "less than nominal" length of pipe (a closure piece) is required to complete a pipe run. These closure pieces can be made in the field, saving time and money.

**THE TR FLEX GRIPPER** Ring consists of Ductile Iron locking segments, which have stainless steel teeth mounted on the I.D. surface. These replace the locking segments normally used on TR FLEX Pipe and Fittings which have a weldment to provide a positive axial lock between the bell interior surface and the spigot end of the pipe.

Obvious advantages to using the TR FLEX GRIPPER Ring include:

1. Cost Savings: No special order spool piece is required.
2. Delivery: By cutting pipe in the field, the closure piece can be made when required.

Field weldments can be used for small diameter Ductile Iron Pipe. Field weldment bars, kits and instructions are available from U.S. Pipe. (See U.S. Pipe brochure, "Field Cutting and Welding Procedure for TR FLEX Pipe.")

It is easier to properly install TR FLEX GRIPPER Rings in TR FLEX Pipe sockets than TR FLEX Fitting sockets, since it is easier to keep a pipe to pipe joint in alignment during assembly.

TR FLEX GRIPPER Rings must not be used with Horizontal Drilling Pull Process. TR FLEX GRIPPER Rings must not be used in buried or aerial vertical installations greater than 45 degrees. A field weld bar or fabricated pipe closure should be used.

Prior to installing the TR FLEX GRIPPER Ring, please follow the instructions for TR FLEX Field Cutting on Ductile Iron pipe included in this brochure.

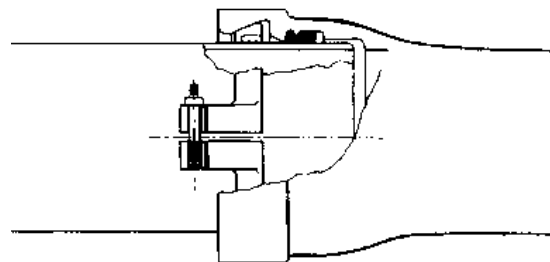
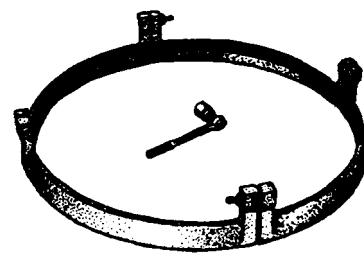
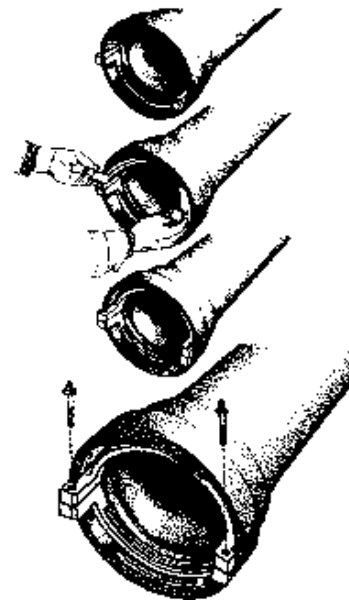

**TR FLEX GRIPPER Ring**

**NOTE:** There must be no more than 6 mils nominal coating thickness on the end of the pipe to be restrained with the TR FLEX GRIPPER Ring.

The TR FLEX GRIPPER Ring should only be used on Ductile Iron Pipe.

## TR FLEX GRIPPER® Rings Layout Instructions

The illustration shows how to use TR FLEX GRIPPER Rings in pipe while utilizing fittings. A field cut is made to a TR FLEX® Pipe at the desired location. The spigot end with the factory weld bead (A) is installed into one end of the TR FLEX Fitting and restrained with conventional TR FLEX Locking Segments. The field cut and beveled plain end (B) is installed into the bell of the preceding pipe and restrained with a TR FLEX GRIPPER Ring. A full length TR FLEX Pipe is then installed into the other socket of the TR FLEX Fitting and restrained with TR FLEX Locking Segments. The remaining bell by plain end cut piece is then installed into the socket of the full length TR FLEX Pipe with a TR FLEX GRIPPER Ring. Laying continues with conventional TR FLEX Pipe.

### TR FLEX GRIPPER Ring Installation Example

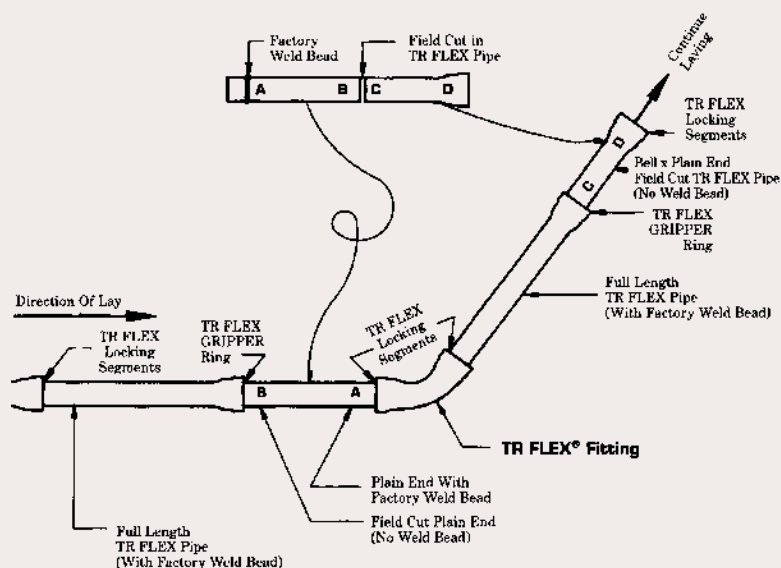

### Deflection

If the TR FLEX GRIPPER Ring is not square with the pipe during installation, any subsequent movement of the joint as pressure is applied could result in loosening the ring and possible joint separation.

The joint deflection should be set (as shown in Table 1, page 7) only after the installation is complete.

The precautions noted earlier under TR FLEX Pipe and Fittings Socket Pullout (page 11) also apply to TR FLEX GRIPPER Ring restrained joints.

### Installation Tips

*Many contractors have found that it is simpler to properly install the TR FLEX GRIPPER Ring in TR FLEX Pipe sockets than in TR FLEX Fitting sockets since it is easier to keep the pipe-to-pipe joint in alignment during assembly and installation. The illustration depicts an example of such an installation.*

**NOTE:** U.S. Pipe does NOT recommend Gripper Rings in vertical installations greater than 45° and those that choose to do so proceed at their own risk.

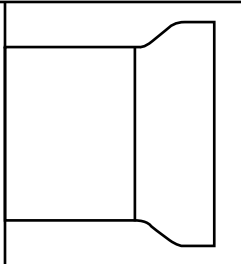

## TR FLEX GRIPPER® Ring Installation Instructions

### TR FLEX Bell Orientation

Where feasible lay the TR FLEX® Pipe or Fitting bells such that the slots in the bell face are accessible after the joint is assembled. Otherwise provide adequate bell holes to permit access to properly tighten bolts.

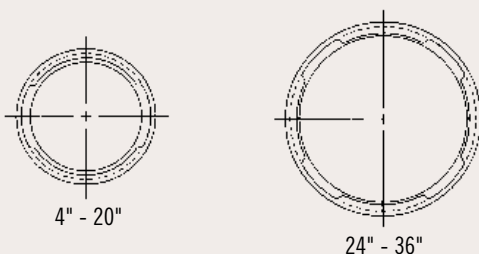

### Clean and Lubricate

Clean the gasket seat and locking segment cavity of the TR FLEX Pipe or Fitting socket and insert the TYTON® Gasket in the recommended manner. DO NOT apply lubricant in the gasket seat of the bell or to the outside of the gasket before inserting the gasket.

### Check TR FLEX GRIPPER® Ring

Select the proper size ring. Inspect the ring for any shipping damage. Also ensure that there is no excess coating, dirt, cement or weld spatter in or on the teeth or on the inner diameter of the ring segments.

### Insertion of the Ring Segments



The 4"-20" TR FLEX GRIPPER Rings are made in two segments. The 24"-36" rings are made in four segments.

Remove the bolts from the TR FLEX GRIPPER Ring. Position the TR FLEX GRIPPER Ring segments into the bell locking segment cavity so that the segment handles protrude beyond the bell face. At each location where the segment handles are joined, one side is drilled, and the other side is tapped, insert the bolts into the segment handles so that the segments form a loose ring. After removing the bolts, check that the internal treads of the Gripper Ring and the external threads of the bolts are clean. Apply a thin film of pipe lubricant to the threads of the bolt before proceeding with the installation. Be sure to insert the bolts into the drilled side first before engaging the threads in the tapped side.

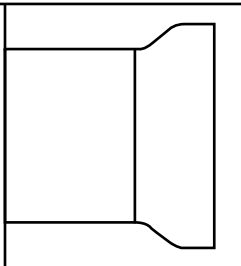

**TR FLEX®****RESTRAINED JOINT DUCTILE IRON PIPE AND FITTINGS****2009 EDITION****P 16**

## TR FLEX GRIPPER® Ring Installation Instructions (cont.)

The four segment 30" and 36" TR FLEX GRIPPER® Rings differ from the 24" ring in that two of the segments are joined with a jack screw. With the jack screw it is possible to fully expand the ring segments to provide the maximum assembly clearance for the entering pipe.

To install, remove the three short bolts. Do not remove the long jack screw.

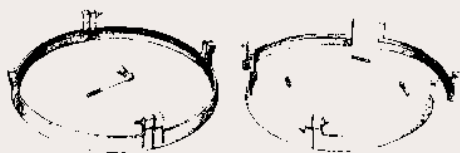

Position the two segments joined with the jack screw into the lower portion of the bell locking segment cavity.



The segment handles should protrude slightly beyond the bell face with the jack screw easily accessible.





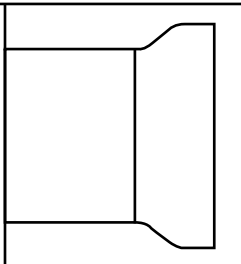

## TR FLEX GRIPPER® Ring Installation Instructions (cont.)

Install the other two ring segments in the bell and assemble to the initial segments by inserting the bolts into the segment handles to form a loose ring.

Back off the jack screw so that the segments are forced to become fully seated into the bell locking segment cavity.

**NOTE:** Prior to inserting the bolts back into the Gripper Ring, check to make sure the threads are clean. Wipe the threads of each bolt with a thin film of the lubricant supplied with the pipe.

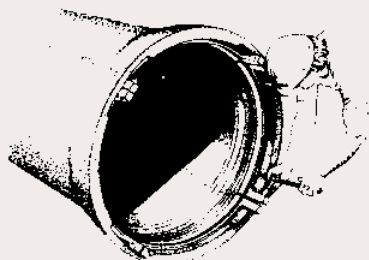

### Joint Assembly

Clean the pipe spigot end. Be sure that there are no burrs or sharp edges left from the cutting and beveling operations or any excess coating.

Lubricate the exposed gasket surfaces and the pipe spigot end with TYTON JOINT® Lubricant.

**NOTE:** Lubricant should NOT be used under the gasket in the bell socket.

Assemble the cut pipe into the pipe or fitting bell making sure that edge of the assembly stripe is flush with the bell face. Keep the joint in straight alignment.

TR FLEX GRIPPER® Rings in sizes 4"–20" are equipped with 1/2"–13 x 2" Torque Limiting bolts and sizes 24"–36" with 5/8" – 11 x 3" Torque Limiting bolts. Before re-installing the TORQUE LIMITING bolts, make sure the threads are clean and apply a thin coat of TYTON JOINT Lubricant to the threads.

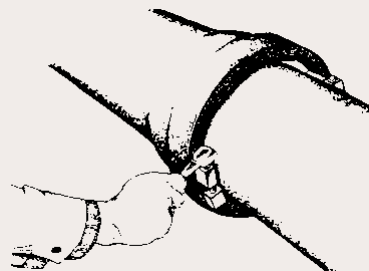

While keeping the assembled joint in straight alignment, tighten the 1/2" bolts using a common 3/8" 12-point socket wrench until the cap of the bolt shears off. Follow the same procedure for each TORQUE LIMITING bolt.

866.DIP.PIPE		<div style="text-align: center;">  </div> <h1 style="margin: 0;">TR FLEX®</h1> <h2 style="margin: 0;">RESTRAINED JOINT DUCTILE IRON PIPE AND FITTINGS</h2>			
			2009 EDITION		P 18

## TR FLEX GRIPPER® Ring Installation Instructions (cont.)

For sizes 24"–36" use a common 7/16" 12-point socket wrench.

After assembly of the 30" and 36" sizes, tighten the jack screw snugly then proceed to tighten the remaining (3)-5/8" TORQUE LIMITING bolts with a 7/16" 12-point socket wrench until the caps of the bolts shear off.

It is important that the joint not be deflected prior to tightening the TR FLEX GRIPPER® Ring. If the TR FLEX GRIPPER Ring is not square with the pipe as the bolts are tightened, any subsequent movement of the joint could result in loosening of the ring and possible joint separation.

Installers may find that it helps to push the Gripper Rings to the back of the lug cavity in order to insure that the ring is square with the pipe spigot before tightening of the bolts.

### Extension and Deflection of the Joint

After the installation is complete, the joint should be fully extended by attempting to pull the joint apart. This extension removes any slack from the joint and provides assurance that the TR FLEX GRIPPER Ring has been correctly installed. After extending the joint, the required joint deflection can be set. The joint should be installed with as little deflection as possible to allow for additional deflection in the event there is some movement or settling of the line after installation.

**NOTE:** If specifiers or users believe that corrosive soils will be encountered where our products are to be installed, please refer to ANSI/AWWA C105/A21.5 Polyethylene Encasement for Ductile- Iron Pipe Systems, for proper external protection procedures. Polyethylene encased sections of a line will require additional joint restraint since the friction between the pipe and soil is reduced with the use of polyethylene encasement. Refer to the DIPRA's **Thrust Restraint Design** brochure for additional details on restrained length calculations.

## Notes Regarding the Use of Restrained Joint Pipe

1. Large unbalanced thrust forces can be produced at dead ends, bends, tees or other changes in direction of high pressure and/or large diameter piping systems.
2. Concrete Thrust blocking or other means of thrust restraint is not required to be used with TR FLEX restrained joint when the TR FLEX restrained joint system is used in a designed thrust restraint system. The **Thrust Restraint Design for Ductile-Iron Pipe** published by the Ductile-Iron Pipe Research Association (DIPRA) is one method used to calculate the required length of restraint at a change in direction. This publication is available through your U.S. Pipe Representative or at [www.dipra.org](http://www.dipra.org).
3. In underground piping systems, an unbalanced thrust force can normally be resisted by providing a designed length of restraint at a change in direction where thrust forces are anticipated. Restrained joint pipe normally must transfer the thrust forces to the soil surrounding the pipeline.
4. Most restrained joints allow for joint take-up after installation. The amount of take-up or slack can vary considerably with the type of joint and installation conditions. Thrust forces produced by internal pressures can result in removal of this joint take-up thereby increasing the length of the restrained section of the line. In any situation or configuration where increases in the line segment length could be detrimental to the pipeline or surrounding structures, the restrained joints should be fully extended during installation.
5. Many contractors are more confident in the reliability of push-on joints if the joint is fully homed. That is not possible when installing a TR FLEX plain end into a TYTON JOINT® bell unless the plain end with the weld bead is cut off and re-beveled as recommended. U.S. Pipe can furnish TR FLEX Pipe without the weld bead to use as a transition piece between restrained and unrestrained portions of the pipeline. Likewise, a TYTON JOINT Pipe can be furnished with a TR FLEX plain end, if desired.
6. An increase in line segment length can also result in additional joint deflection. If an increase in length or other line movement are anticipated, the deflection of the restrained joints should be limited to only a portion of the joint design deflection during the installation of the pipe.
7. In fully extended, totally restrained piping systems, the thrust forces are carried by the piping system, and the resistance to the thrust is not dependent upon the surrounding soil. In situations where there is insufficient space to provide the designed restrained length, or where there are poor soil conditions, the entire section of line should be restrained or other external means of stability or restraint provided.
8. When TR FLEX Pipe is used in casings, it is preferred that it is pulled. Pulling will fully extend the joints and take up the joint slack prior to making end connections. If the pipe must be pushed contact a U.S. Pipe Sales Representative for special instructions. The length of restraint in the casing should not be considered as part of the designed length of the restraint required to provide the soil resistance to the thrust forces.

866.DIP.PIPE		<div style="text-align: right;"> <input type="checkbox"/> <input type="checkbox"/> <input type="checkbox"/> <input type="checkbox"/> </div> <h1 style="margin: 0;">TR FLEX®</h1> <h2 style="margin: 0;">RESTRAINED JOINT DUCTILE IRON PIPE AND FITTINGS</h2>			
			2009 EDITION		P 20

## Notes Regarding the Use of Restrained Joint Pipe (cont.)

9. Above ground lines subject to thrust forces should be fully restrained and extended to remove any slack from the joint. The joint can be extended by pulling out on the pipe after the restrained joint assembly is made. The thrust forces can cause an unexpected increase in length of an above ground line if the slack is not first removed from the joint. When restrained joint pipe are used for bridge crossings or other above ground installations, each length of pipe must be supported in a manner to restrict both vertical and horizontal movement.
10. It is the responsibility of the Purchaser or Consulting Engineer to ensure that proper trench preparation, compaction and pipe installation procedures are followed and that adequate restrained lengths or thrust block designs are provided to resist the unbalanced thrust loads generated by the installed piping systems.
11. In general, restrained joints are more electrically conductive than conventional push-on joints used for Ductile Iron pipe. This increased conductivity can make a restrained section of the line more susceptible to stray current corrosion caused by direct currents from sources such as electrical transit systems or cathodically protected steel structures (steel pipe, underground storage tanks, etc.). If exposure to stray current is anticipated, contact your U.S. Pipe Representative for the recommended method of protection.
12. Vertical Applications with TR FLEX Joints:

Do not use TR FLEX GRIPPER® Rings in buried or aerial vertical installations greater than 45°. A field weld bar or fabricated pipe closure should be used.

A. Joints used in vertical installations greater than 45°, buried or aerial, must have blocking or support provided to permanently keep the joint extended and a support pier provided at both horizontal pipe sections, or bends, adjacent to the portion of vertical pipe in the exposed location. Failure to keep joints extended can result in unwanted line growth or joint separation from dynamic impact loading.

B. Joints used in vertical installations up to 45° must be kept extended and a support pier provided at both horizontal pipe sections, or bends, adjacent to the portion of vertical pipe. A support pier is not needed in installations where the bottom bend is buried. Failure to keep joints extended can result in unwanted line growth or joint separation from dynamic impact loading.

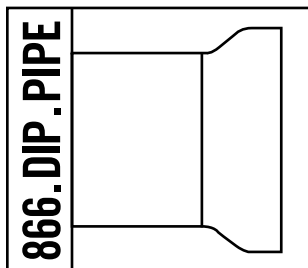

# TR FLEX®

## RESTRAINED JOINT DUCTILE IRON PIPE AND FITTINGS



2009 EDITION

P 21

## TR FLEX Restrained Joint Pipe and Fittings

### Basic Dimensions

SIZE	WORKING PRESSURE††	A	B	B	C	NO. OF D.I. LOCKING SEGMENTS	NO. OF RUBBER SEGMENTS RETAINERS	ACCESSORY WEIGHTS*	MAX. DEFLECTION	PULLOUT
Inches	psi	Inches	PIPE Inches	FITTINGS Inches	Inches			Pounds	Degrees	Feet
4	350	4.80	7.00	7.10	4.84	2	1	2	5°	.03
6	350	6.90	9.27	9.39	5.27	2	1	2	5°	.04
8	350	9.05	11.68	11.84	5.82	2	1	3	5°	.04
10	350	11.10	14.12	14.12	6.03	2	1	5	5°	.05
12	350	13.20	16.43	16.45	6.30	4	2	7	5°	.06
14	350	15.30	18.80	19.12	7.75	4	2	12	3 1/4°	.05
16	350	17.40	21.10	21.32	7.95	4	2	14	3 1/4°	.05
18	350	19.50	23.40	23.52	8.19	4	2	17	3°	.05
20	350	21.60	25.68	25.74	8.40	4	2	20	2 1/2°	.05
24	350	25.80	30.25	30.14	8.86	8	4	32	2 1/4°	.05
30	250	32.00	36.38	37.18	10.28	8	4	50	1 3/4°	.05
36	250	38.30	43.35	43.86	10.87	8	4	68	1 1/2°	.05

\*Accessory weights include segments, gaskets, and rubber retainers.

†For higher pressure ratings, consult your U.S. Pipe Sales Representative.

†† The TR FLEX Restrained joint has a working pressure rating equivalent to the working pressure rating of the parent pipe with a maximum working pressure rating of 350 psi for 4" through 24" and 250 psi for 30" through 36".

NOTE: These deflections are based on joints with nominal dimensions.

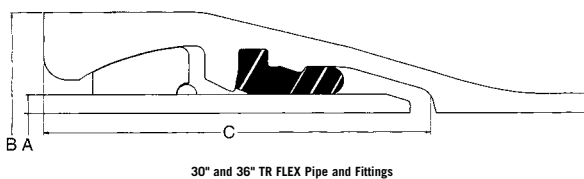
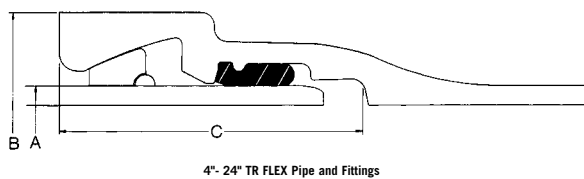

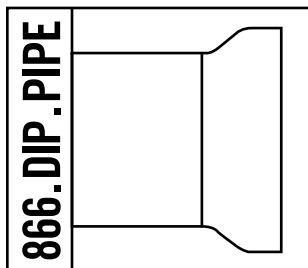

☐ ☐ ☐ ☐

# TR FLEX®

## RESTRAINED JOINT DUCTILE IRON PIPE AND FITTINGS

### 2009 EDITION

## P 22

## Pressure Class TR FLEX Pipe

Nominal Thickness for Standard Pressure Classes of Ductile Iron Pipe

SIZE Inches	OUTSIDE DIAMETER Inches	NOMINAL THICKNESS Inches					CASTING TOLERANCES Inches
		PRESSURE CLASS*					
		150	200	250	300	350	
4	4.80	—	—	—	—	0.25**	0.05
6	6.90	—	—	—	—	0.25**	0.05
8	9.05	—	—	—	—	0.25**	0.05
10	11.10	—	—	—	—	0.26	0.06
12	13.20	—	—	—	—	0.28	0.06
14	15.30	—	—	0.28	0.30	0.31	0.07
16	17.40	—	—	0.30	0.32	0.34	0.07
18	19.50	—	—	0.31	0.34	0.36	0.07
20	21.60	—	—	0.33	0.36	0.38	0.07
24	25.80	—	0.33	0.37	0.40	0.43	0.07
30	32.00	0.34	0.38	0.42	0.45	0.49	0.07
36	38.30	0.38	0.42	0.47	0.51	0.56	0.07

**NOTE:** Per ANSI/AWWA C150/A21.50 the thicknesses in above table include the 0.08" service allowance and the casting tolerance by size ranges.

Dimensions and weights of Special Classes (Thickness Classes) are found on pages 26-29.

\* Pressure Classes are defined as the rated water pressure of the pipe in psi. The thicknesses shown are adequate for the rated water working pressure plus a surge allowance of 100 psi. Calculations are based on a minimum yield strength of 42,000 and a 2.0 safety factor times the sum of the working pressure and 100 psi surge allowance.

\*\*Calculated thickness for these sizes and pressure ratings are less than those shown above. Presently these are the lowest nominal thicknesses available in these sizes.

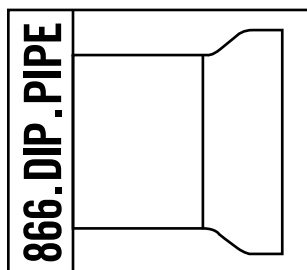

# TR FLEX®

## RESTRAINED JOINT DUCTILE IRON PIPE AND FITTINGS



2009 EDITION

P 23

## Pressure Class – Thickness, Dimensions and Weight

SIZE Inches	PRESSURE CLASS psi	THICKNESS Inches	OUTSIDE DIAMETER* Inches	18-FOOT LAYING LENGTH		20-FOOT LAYING LENGTH	
				WEIGHT PER LENGTH† Pounds	AVG. WEIGHT PER FOOT†† Pounds	WEIGHT PER LENGTH† Pounds	AVG. WEIGHT PER FOOT†† Pounds
4	350	0.25	4.80	210	11.7	—	—
6	350	0.25	6.90	310	17.2	—	—
8	350	0.25	9.05	415	23.1	—	—
10	350	0.26	11.10	540	30.0	—	—
12	350	0.28	13.20	695	38.6	—	—
14	250	0.28	15.30	835	46.4	915	45.8
14	300	0.30	15.30	970	53.9	1075	53.8
14	350	0.31	15.30	910	50.6	1000	50.0
16	250	0.30	17.40	1015	56.4	—	—
16	300	0.32	17.40	1075	59.7	—	—
16	350	0.34	17.40	1135	63.1	—	—
18	250	0.31	19.50	1180	65.6	—	—
18	300	0.34	19.50	1280	71.1	—	—
18	350	0.36	19.50	1345	74.7	—	—
20	250	0.33	21.60	1400	77.8	—	—
20	300	0.36	21.60	1510	83.9	—	—
20	350	0.38	21.60	1580	87.8	—	—
24	200	0.33	25.80	1690	93.9	—	—
24	250	0.37	25.80	1865	103.6	—	—
24	300	0.40	25.80	1995	110.8	—	—
24	350	0.43	25.80	2125	118.1	—	—
30	150	0.34	32.00	2160	120.0	—	—
30	200	0.38	32.00	2375	131.9	—	—
30	250	0.42	32.00	2590	143.9	—	—
30	300	0.45	32.00	2755	155.1	—	—
30	350	0.49	32.00	2970	165.0	—	—
36	150	0.38	38.30	2935	163.1	—	—
36	200	0.42	38.30	3195	177.5	—	—
36	250	0.47	38.30	3520	195.6	—	—
36	300	0.51	38.30	3780	210.0	—	—
36	350	0.56	38.30	4100	227.8	—	—

**NOTE:** Thicknesses and dimensions of 4" through 36" Ductile Iron pipe conform to ANSI/AWWA C151/A21.51. Weights may vary from the standard because of differences in bell weights.

\*Tolerance of O.D. of spigot end: 4-12 in., ±0.06 in.; 14-24 in., +0.05 in., -0.08 in.; 30-36 in., +0.08 in., -0.06 in.

† Including bell; calculated weight of pipe rounded off to nearest 5 lbs.

†† Including bell; average weight, per foot, based on calculated weight of pipe before rounding.

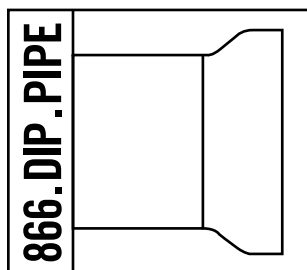

## Thickness Class – Thicknesses, Dimensions and Weight

SIZE Inches	THICKNESS CLASS	THICKNESS Inches	OUTSIDE DIAMETER* Inches	18-FOOT LAYING LENGTH		20-FOOT LAYING LENGTH	
				WEIGHT PER LENGTH† Pounds	AVG. WEIGHT PER FOOT†† Pounds	WEIGHT PER LENGTH† Pounds	AVG. WEIGHT PER FOOT†† Pounds
4	51	0.26	4.80	220	12.2	—	—
4	52	0.29	4.80	240	13.3	—	—
4	53	0.32	4.80	265	14.7	—	—
4	54	0.35	4.80	285	15.8	—	—
4	55	0.38	4.80	305	16.9	—	—
4	56	0.41	4.80	325	18.1	—	—
6	50	0.25	6.90	310	17.2	—	—
6	51	0.28	6.90	345	19.2	—	—
6	52	0.31	6.90	380	21.1	—	—
6	53	0.34	6.90	410	22.8	—	—
6	54	0.37	6.90	440	24.4	—	—
6	55	0.40	6.90	475	26.4	—	—
6	56	0.43	6.90	505	28.1	—	—
8	50	0.27	9.05	445	24.7	—	—
8	51	0.30	9.05	490	27.2	—	—
8	52	0.33	9.05	530	29.4	—	—
8	53	0.36	9.05	575	31.9	—	—
8	54	0.39	9.05	620	34.4	—	—
8	55	0.42	9.05	660	36.7	—	—
8	56	0.45	9.05	705	39.2	—	—
10	50	0.29	11.10	590	32.8	—	—
10	51	0.32	11.10	645	35.8	—	—
10	52	0.35	11.10	700	38.9	—	—
10	53	0.38	11.10	755	41.9	—	—
10	54	0.41	11.10	810	45.0	—	—
10	55	0.44	11.10	860	47.8	—	—
10	56	0.47	11.10	915	50.8	—	—

**NOTE:** Thicknesses and dimensions of 4" through 36" Ductile Iron pipe conform to ANSI/APWA C151/A21.51.  
Weights may vary from the standard because of differences in bell weights.

\*Tolerance of O.D. of spigot end: 4-12 in.,  $\pm 0.06$  in.; 14-24 in.,  $+0.05$  in.,  $-0.08$  in.; 30-36 in.,  $+0.08$  in.,  $-0.06$  in.

† Including bell; calculated weight of pipe rounded off to nearest 5 lbs.

†† Including bell; average weight, per foot, based on calculated weight of pipe before rounding.

Table continued on next page.



## Thickness Class – Thicknesses, Dimensions and Weight (cont.)

SIZE Inches	THICKNESS CLASS	THICKNESS Inches	OUTSIDE DIAMETER* Inches	18-FOOT LAYING LENGTH		20-FOOT LAYING LENGTH	
				WEIGHT PER LENGTH† Pounds	AVG. WEIGHT PER FOOT†† Pounds	WEIGHT PER LENGTH† Pounds	AVG. WEIGHT PER FOOT†† Pounds
12	50	0.31	13.20	760	42.2	—	—
12	51	0.34	13.20	825	45.8	—	—
12	52	0.37	13.20	890	49.4	—	—
12	53	0.40	13.20	955	53.1	—	—
12	54	0.43	13.20	1020	56.7	—	—
12	55	0.46	13.20	1080	60.0	—	—
12	56	0.49	13.20	1145	63.6	—	—
14	50	0.33	15.30	960	53.3	1055	52.8
14	51	0.36	15.30	1035	57.5	1140	57.0
14	52	0.39	15.30	1110	61.7	1225	61.3
14	53	0.42	15.30	1185	65.8	1310	65.5
14	54	0.45	15.30	1260	70.0	1390	69.5
14	55	0.48	15.30	1335	74.2	1475	73.8
14	56	0.51	15.30	1410	78.3	1555	77.8
16	50	0.34	17.40	1135	63.1	—	—
16	51	0.37	17.40	1220	67.8	—	—
16	52	0.40	17.40	1305	72.5	—	—
16	53	0.43	17.40	1390	77.2	—	—
16	54	0.46	17.40	1475	81.9	—	—
16	55	0.49	17.40	1565	86.9	—	—
16	56	0.52	17.40	1650	91.7	—	—
18	50	0.35	19.50	1315	73.1	—	—
18	51	0.38	19.50	1410	78.3	—	—
18	52	0.41	19.50	1505	83.6	—	—
18	53	0.44	19.50	1605	89.2	—	—
18	54	0.47	19.50	1700	94.4	—	—
18	55	0.50	19.50	1795	99.7	—	—
18	56	0.53	19.50	1895	105.3	—	—

**NOTE:** Thicknesses and dimensions of 4" through 36" Ductile Iron pipe conform to ANSI/AWWA C151/A21.51.  
Weights may vary from the standard because of differences in bell weights.

\*Tolerance of O.D. of spigot end: 4-12 in., ±0.06 in.; 14-24 in., +0.05 in., -0.08 in.; 30-36 in., +0.08 in., -0.06 in.

† Including bell; calculated weight of pipe rounded off to nearest 5 lbs.

†† Including bell; average weight, per foot, based on calculated weight of pipe before rounding.

Table continued on next page.

866.DIP.PIPE



# TR FLEX®

## RESTRAINED JOINT DUCTILE IRON PIPE AND FITTINGS



2009 EDITION

P 26

## Thickness Class – Thicknesses, Dimensions and Weight (cont.)

SIZE Inches	THICKNESS CLASS	THICKNESS Inches	OUTSIDE DIAMETER* Inches	18-FOOT LAYING LENGTH		20-FOOT LAYING LENGTH	
				WEIGHT PER LENGTH† Pounds	AVG. WEIGHT PER FOOT†† Pounds	WEIGHT PER LENGTH† Pounds	AVG. WEIGHT PER FOOT†† Pounds
20	50	0.36	21.60	1510	83.9	—	—
20	51	0.39	21.60	1615	89.7	—	—
20	52	0.42	21.60	1725	95.8	—	—
20	53	0.45	21.60	1830	101.7	—	—
20	54	0.48	21.60	1940	107.8	—	—
20	55	0.51	21.60	2045	113.6	—	—
20	56	0.54	21.60	2155	119.7	—	—
24	50	0.38	25.80	1910	106.1	—	—
24	51	0.41	25.80	2040	113.3	—	—
24	52	0.44	25.80	2170	120.6	—	—
24	53	0.47	25.80	2295	127.5	—	—
24	54	0.50	25.80	2425	134.7	—	—
24	55	0.53	25.80	2555	141.9	—	—
24	56	0.56	25.80	2685	149.2	—	—
30	50	0.39	32.00	2430	135.0	—	—
30	51	0.43	32.00	2645	146.9	—	—
30	52	0.47	32.00	2860	158.9	—	—
30	53	0.51	32.00	3075	170.8	—	—
30	54	0.55	32.00	3290	182.8	—	—
30	55	0.59	32.00	3505	194.7	—	—
30	56	0.63	32.00	3715	206.4	—	—
36	50	0.43	38.30	3260	181.1	—	—
36	51	0.48	38.30	3585	199.2	—	—
36	52	0.53	38.30	3910	217.2	—	—
36	53	0.58	38.30	4230	235.0	—	—
36	54	0.63	38.30	4550	252.8	—	—
36	55	0.68	38.30	4870	270.6	—	—
36	56	0.73	38.30	5190	288.3	—	—

**NOTE:** Thicknesses and dimensions of 4" through 36" Ductile Iron pipe conform to ANSI/AWWA C151/A21.51.  
Weights may vary from the standard because of differences in bell weights.

\*Tolerance of O.D. of spigot end: 4-12 in.,  $\pm 0.06$  in.; 14-24 in.,  $+0.05$  in.,  $-0.08$  in.; 30-36 in.,  $+0.08$  in.,  $-0.06$  in.

† Including bell; calculated weight of pipe rounded off to nearest 5 lbs.

†† Including bell; average weight, per foot, based on calculated weight of pipe before rounding.

866.DIP.PIPE



# TR FLEX®

## RESTRAINED JOINT DUCTILE IRON PIPE AND FITTINGS



Certified to  
ANSI/AWWA C151

2009 EDITION

P 27

## Rubber Locking Segment Retainers for TR FLEX Pipe and Fittings

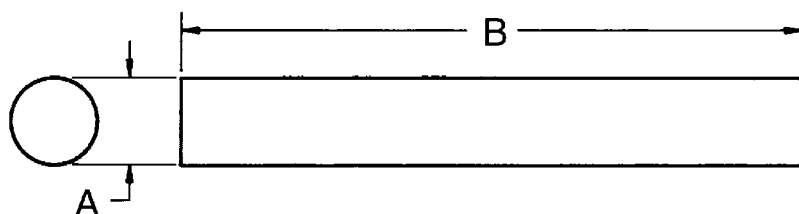

SIZE Inches	A DIAMETER Inches	B LENGTH Inches	NUMBER Per Joint
4	5/8	4-3/8	1
6	3/4	6-1/4	1
8	3/4	8-1/4	1
10	7/8	10-3/8	1
12	7/8	7-1/4	2
14	7/8	7-1/2	2
16	7/8	9	2
18	1	10	2
20	1	11	2
24	1	8	4
30	1	9-1/2	4
36	1-1/4	10-1/2	4

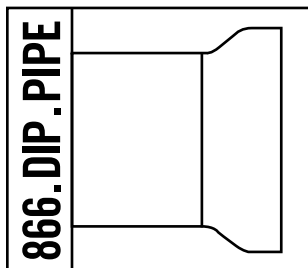

# TR FLEX®

## RESTRAINED JOINT DUCTILE IRON PIPE AND FITTINGS



2009 EDITION

P 28

## TR FLEX Fittings Thickness & Dimensions Bends

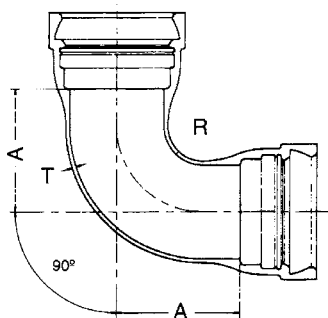

TR FLEX 90° Bends

SIZE Inches	PRESSURE RATING psi	DIMENSIONS Inches			WEIGHT Pounds
		T	A	R	
4	350	0.34	5.66	3.99	35
6	350	0.36	6.78	4.99	70
8	350	0.39	8.83	6.97	125
10	350	0.41	10.63	8.71	180
12	350	0.44	12.60	10.61	255
14	350	0.66	14.00	11.50	435
16	350	0.70	15.00	12.50	520
18	350	0.75	16.50	14.00	670
20	350	0.80	14.00	12.38	745
24	350	0.89	17.00	16.70	1070
30	250	1.03	23.00	21.00	1870
36	250	1.15	26.00	24.00	2740

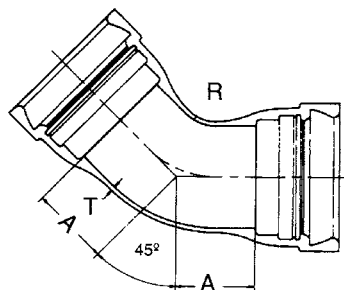

TR FLEX 45° Bends

SIZE Inches	PRESSURE RATING psi	DIMENSIONS Inches			WEIGHT Pounds
		T	A	R	
4	350	0.34	3.33	3.99	30
6	350	0.36	3.86	4.99	55
8	350	0.39	4.74	6.97	90
10	350	0.41	5.22	7.98	125
12	350	0.44	5.91	9.47	170
14	350	0.66	7.50	12.06	370
16	350	0.70	8.00	13.25	430
18	350	0.75	8.50	14.50	550
20	350	0.80	9.50	16.88	685
24	350	0.89	6.00	18.12	970
30	250	1.03	10.50	20.52	1452
36	250	1.15	11.50	22.94	1864

TR FLEX 60° Bends

SIZE Inches	PRESSURE RATING psi	DIMENSIONS Inches			WEIGHT Pounds
		T	A	R	
24	350	0.89	15.00	18.41	1020
30	250	1.03	15.00	20.19	1645
36	250	1.15	17.00	23.38	2390

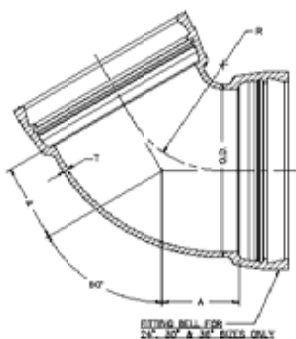

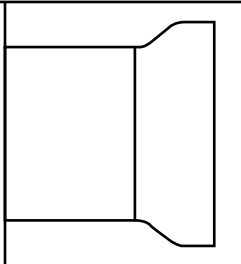

### TR FLEX Fittings Thickness & Dimensions Bends (cont.)

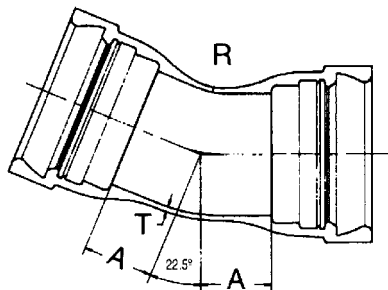

TR FLEX 22.5° Bends

SIZE Inches	PRESSURE RATING psi	DIMENSIONS Inches			WEIGHT Pounds
		T	A	R	
4	350	0.34	2.47	3.99	30
6	350	0.36	3.07	6.41	55
8	350	0.39	3.24	6.97	80
10	350	0.41	3.51	7.98	115
12	350	0.44	3.76	8.95	155
14	350	0.66	7.50	25.12	375
16	350	0.70	8.00	27.62	435
18	350	0.75	8.50	30.19	560
20	350	0.80	9.50	35.19	695
24	350	0.89	4.50	14.45	750
30	250	1.03	7.00	25.14	1305
36	250	1.15	8.00	30.16	1855

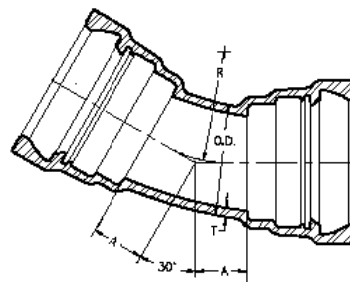

TR FLEX 30° Bends

SIZE Inches	PRESSURE RATING psi	DIMENSIONS Inches			WEIGHT Pounds
		T	A	R	
24	350	0.89	8.00	21.01	870
30	250	1.03	9.50	22.97	1419
36	250	1.15	11.00	27.99	2052

†Actual weight of fitting may exceed those shown.

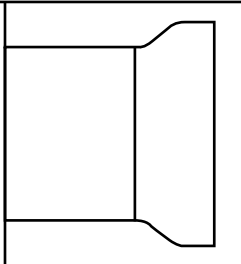

### TR FLEX Fittings Thickness & Dimensions Bends (cont.)

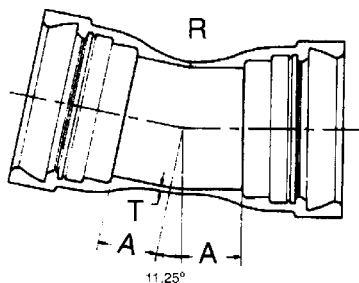

TR FLEX 11.25° Bends

SIZE Inches	PRESSURE RATING psi	DIMENSIONS Inches			WEIGHT Pounds
		T	A	R	
4	350	0.34	2.07	3.99	30
6	350	0.36	2.42	6.35	50
8	350	0.39	2.55	6.97	75
10	350	0.41	2.71	7.98	110
12	350	0.44	2.87	8.95	145
14	350	0.66	7.50	50.75	375
16	350	0.70	8.00	55.81	440
18	350	0.75	8.50	60.94	560
20	350	0.80	9.50	71.06	695
24	350	0.89	3.00	13.96	700
30	250	1.03	7.00	50.77	1305
36	250	1.15	8.00	60.92	1860

†Actual weight of fitting may exceed those shown.

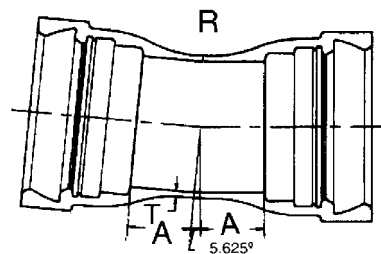

TR FLEX 5.625° Bends

SIZE Inches	PRESSURE RATING psi	DIMENSIONS Inches			WEIGHT Pounds
		T	A	R	
20	350	0.80	5.00	57.59	575
24	350	0.89	6.00	73.87	805
30	250	1.03	7.00	74.38	1310
36	250	1.15	8.00	91.60	1860

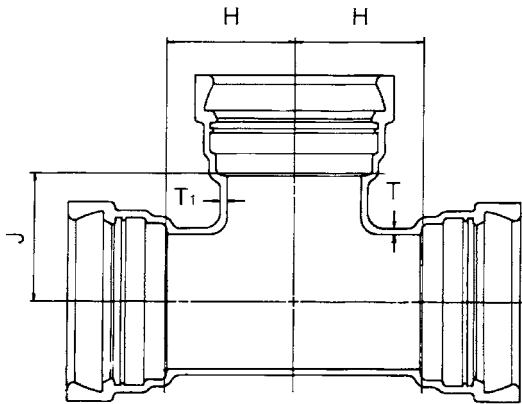
**TR FLEX Fittings Thickness & Dimensions Tees**

SIZE Inches		PRESSURE RATING psi	DIMENSIONS Inches				WEIGHT Pounds
RUN	BRANCH		T	T <sub>1</sub>	H	J	
4	4	350	0.34	0.34	5.16	5.16	50
6	4	350	0.36	0.34	5.17	6.15	85
6	6	350	0.36	0.36	6.16	6.16	100
8	4	350	0.39	0.34	5.18	7.64	125
8	6	350	0.39	0.36	6.20	7.65	145
8	8	350	0.39	0.39	7.65	7.65	170
10	4	350	0.41	0.34	5.24	8.63	165
10	6	350	0.41	0.36	6.27	9.03	190
10	8	350	0.41	0.39	7.66	8.65	215
10	10	350	0.41	0.41	8.65	8.65	235
12	4	350	0.44	0.34	5.30	9.63	220
12	6	350	0.44	0.36	6.33	10.23	245
12	8	350	0.44	0.39	7.66	9.64	270
12	10	350	0.44	0.41	8.66	9.64	295
12	12	350	0.44	0.44	9.65	9.65	325
14	6	350	0.66	0.55	14.00	14.00	515
14	8	350	0.66	0.60	14.00	14.00	535
14	10	350	0.66	0.68	14.00	14.00	560
14	12	350	0.66	0.75	14.00	14.00	590
14	14	350	0.66	0.66	14.00	14.00	630
16	6	350	0.70	0.55	12.25	13.25	550
16	8	350	0.70	0.60	12.25	13.25	570
16	10	350	0.70	0.68	12.25	13.25	590

SIZE Inches		PRESSURE RATING psi	DIMENSIONS Inches				WEIGHT Pounds
RUN	BRANCH		T	T <sub>1</sub>	H	J	
16	12	350	0.70	0.75	12.25	13.25	620
16	14	350	0.70	0.66	12.25	13.25	665
16	16	350	0.70	0.70	12.25	13.25	675
18	6	350	0.75	0.55	13.00	15.50	700
18	8	350	0.75	0.60	13.00	15.50	720
18	10	350	0.75	0.68	13.00	15.50	740
18	12	350	0.75	0.75	13.00	15.50	770
18	14	350	0.75	0.66	16.50	16.50	900
18	16	350	0.75	0.70	16.50	16.50	920
18	18	350	0.75	0.75	16.50	16.50	955
20	6	350	0.80	0.55	11.00	16.00	770
20	8	350	0.80	0.60	11.00	16.00	790
20	10	350	0.80	0.68	11.00	16.00	810
20	12	350	0.80	0.75	11.00	16.00	835
20	14	350	0.80	0.66	14.00	17.00	970
20	16	350	0.80	0.70	15.00	15.00	995
20	18	350	0.80	0.75	18.00	18.00	1150
20	20	350	0.80	0.80	15.00	15.00	1065

866.DIP.PIPE





# TR FLEX®

## RESTRAINED JOINT DUCTILE IRON PIPE AND FITTINGS



2009 EDITION

P 32

## TR FLEX Fittings Thickness & Dimensions Tees (cont.)

SIZE Inches		PRESSURE RATING psi	DIMENSIONS Inches				WEIGHT Pounds
RUN	BRANCH		T	T <sub>1</sub>	H	J	
24	6	350	0.89	0.55	15.00	19.00	1160
24	8	350	0.89	0.60	15.00	19.00	1180
24	10	350	0.89	0.68	15.00	19.00	1205
24	12	350	0.89	0.75	15.00	19.00	1230
24	14	350	0.89	0.66	15.00	19.00	1270
24	16	350	0.89	0.70	15.00	19.00	1290
24	18	350	0.89	0.75	17.00	21.00	1430
24	20	350	0.89	0.80	17.00	21.00	1475
24	24	350	0.89	0.89	17.00	21.00	1545
30	6	250	1.03	0.55	11.00	23.00	1550
30	8	250	1.03	0.60	11.00	23.00	1570
30	10	250	1.03	0.68	11.00	23.00	1595
30	12	250	1.03	0.75	11.00	23.00	1620
30	14	250	1.03	0.66	13.50	23.00	1790
30	16	250	1.03	0.70	13.50	23.00	1805
30	18	250	1.03	0.75	18.00	23.00	2080
30	20	250	1.03	0.80	18.00	23.00	2120
30	24	250	1.03	0.89	21.00	25.00	2390
30	30	250	1.03	1.03	21.00	25.00	2565
36	6	250	1.15	0.55	17.50	26.00	2545
36	8	250	1.15	0.60	17.50	26.00	2565
36	10	250	1.15	0.68	17.50	26.00	2584
36	12	250	1.15	0.75	17.50	26.00	2609
36	14	250	1.15	0.66	17.50	26.00	2651
36	16	250	1.15	0.70	17.50	26.00	2679
36	18	250	1.15	0.75	17.50	26.00	2707
36	20	250	1.15	0.80	17.50	26.00	2747
36	24	250	1.15	0.89	17.50	26.00	2833
36	30	250	1.15	1.03	20.00	26.00	3217
36	36	250	1.15	1.15	20.00	26.00	3589

†Actual weight of fitting may exceed those shown.



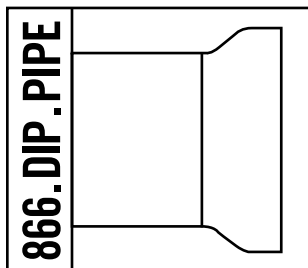

# TR FLEX®

## RESTRAINED JOINT DUCTILE IRON PIPE AND FITTINGS



2009 EDITION

P 33

## TR FLEX Tees with Flange Branch

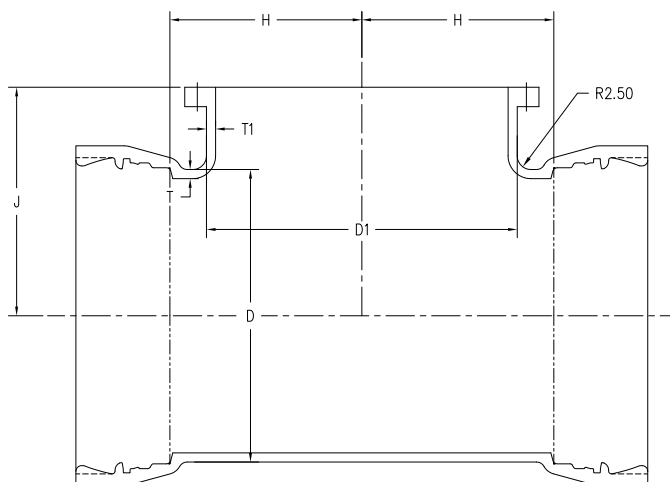

SIZE Inches		DIMENSIONS Inches						WEIGHT Pounds
RUN	BRANCH	D	D <sub>1</sub>	T	T <sub>1</sub>	H	J	
4	4	4.66	4.66	0.34	0.34	5.16	6.5	49
6	4	6.74	4.66	0.36	0.34	5.17	8.0	84
6	6	6.74	6.74	0.36	0.36	6.16	8.0	107
8	4	8.88	4.66	0.39	0.34	5.18	9.0	124
8	6	8.88	6.74	0.39	0.36	6.20	9.0	152
8	8	8.88	8.88	0.39	0.39	7.65	9.0	185
10	4	10.86	4.66	0.41	0.34	5.24	11.0	164
10	6	10.86	6.74	0.41	0.36	6.27	11.0	197
10	8	10.86	8.88	0.41	0.39	7.66	11.0	230
10	10	10.86	10.86	0.41	0.41	8.65	11.0	257
12	4	12.86	4.66	0.44	0.34	5.30	12.0	219
12	6	12.86	6.74	0.44	0.36	6.33	12.0	252
12	8	12.86	8.88	0.44	0.39	7.66	12.0	285
12	10	12.86	10.86	0.44	0.41	8.66	12.0	317
12	12	12.86	12.86	0.44	0.44	9.65	12.0	350
14	6	15.30	7.10	0.66	0.55	14.0	14.0	508
14	8	15.30	9.30	0.66	0.60	14.0	14.0	522
14	10	15.30	10.86	0.66	0.68	14.0	14.0	536
14	12	15.30	12.86	0.66	0.75	14.0	14.0	560
14	14	15.30	15.30	0.66	0.66	14.0	14.0	566

SIZE Inches		DIMENSIONS Inches						WEIGHT Pounds
RUN	BRANCH	D	D <sub>1</sub>	T	T <sub>1</sub>	H	J	
16	6	17.40	7.10	0.70	0.55	12.25	15.0	628
16	8	17.40	9.30	0.70	0.60	12.25	15.0	642
16	10	17.40	11.40	0.70	0.68	12.25	15.0	655
16	12	17.40	12.86	0.70	0.75	12.25	15.0	678
16	14	17.40	15.30	0.70	0.66	12.25	15.0	685
16	16	17.40	17.40	0.70	0.70	12.25	15.0	703
18	6	19.50	7.10	0.75	0.55	13.0	15.5	690
18	8	19.50	9.30	0.75	0.60	13.0	15.5	702
18	10	19.50	11.40	0.75	0.68	13.0	15.5	715
18	12	19.50	12.86	0.75	0.75	13.0	15.5	737
18	14	19.50	15.30	0.75	0.66	16.5	16.5	829
18	16	19.50	17.40	0.75	0.70	16.5	16.5	848
18	18	19.50	19.50	0.75	0.75	16.5	16.5	855
20	6	21.60	7.10	0.80	0.55	11.0	17.0	845
20	8	21.60	9.30	0.80	0.60	11.0	17.0	858
20	10	21.60	11.40	0.80	0.68	11.0	17.0	871
20	12	21.60	12.86	0.80	0.75	11.0	17.0	893
20	14	21.60	15.30	0.80	0.66	14.0	17.0	898
20	16	21.60	17.40	0.80	0.70	15.0	18.0	1031
20	18	21.60	19.50	0.80	0.75	18.0	18.0	1039

866.DIP.PIPE



# TR FLEX®

## RESTRAINED JOINT DUCTILE IRON PIPE AND FITTINGS

  
Certified to  
ANSI/AWWA C111

2009 EDITION

P 34

## TR FLEX Tees with Flange Branch (cont.)

SIZE Inches		DIMENSIONS Inches						WEIGHT Pounds
RUN	BRANCH	D	D <sub>1</sub>	T	T <sub>1</sub>	H	J	
24	6	25.80	7.10	0.89	0.55	15.0	19.0	1159
24	8	25.80	9.30	0.89	0.60	15.0	19.0	1172
24	10	25.80	11.40	0.89	0.68	15.0	19.0	1183
24	12	25.80	13.50	0.89	0.75	15.0	19.0	1204
24	14	25.80	15.30	0.89	0.66	15.0	19.0	1209
24	16	25.80	17.40	0.89	0.70	15.0	19.0	1225
24	18	25.80	19.50	0.89	0.75	17.0	22.0	1514
24	20	25.80	21.60	0.89	0.80	17.0	22.0	1542
24	24	25.80	25.80	0.89	0.89	17.0	22.0	1591
30	6	32.0	7.10	1.00	0.55	13.50	23.0	1527
30	8	32.0	9.30	1.00	0.60	13.50	23.0	1541
30	10	32.0	11.40	1.00	0.68	13.50	23.0	1554
30	12	32.0	13.50	1.00	0.75	13.50	23.0	1578
30	14	32.0	15.30	1.00	0.66	13.50	23.0	1707
30	16	32.0	17.40	1.00	0.70	13.50	23.0	1728
30	18	32.0	19.50	1.00	0.75	18.00	23.0	1962
30	20	32.0	21.60	1.00	0.80	18.00	23.0	1993
30	24	32.0	25.80	1.00	0.89	21.00	25.0	2243
30	30	32.0	32.00	1.00	1.00	21.00	25.0	2630
36	6	38.30	7.10	1.15	0.55	17.50	26.0	—
36	8	38.30	9.30	1.15	0.60	17.50	26.0	2550
36	10	38.30	11.40	1.15	0.68	17.50	26.0	2562
36	12	38.30	13.50	1.15	0.75	17.50	26.0	2584
36	14	38.30	15.30	1.15	0.66	17.50	26.0	2588
36	16	38.30	17.40	1.15	0.70	17.50	26.0	2605
36	18	38.30	19.50	1.15	0.75	17.50	26.0	2612
36	20	38.30	21.60	1.15	0.80	17.50	26.0	2638
36	24	38.30	25.80	1.15	0.89	17.50	26.0	2690
36	30	38.30	32.00	1.15	1.00	28.00	28.0	3564
36	36	38.30	38.30	1.15	1.15	28.00	28.0	3891

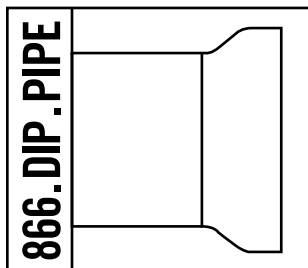

# TR FLEX®

RESTRAINED JOINT DUCTILE IRON PIPE AND FITTINGS



2009 EDITION

**P 35**

## TR FLEX Crosses

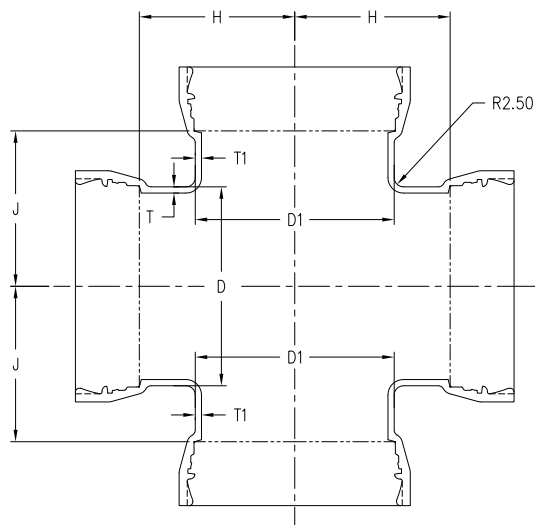

SIZE Inches		DIMENSIONS Inches						WEIGHT Pounds
RUN	BRANCH	D	D <sub>1</sub>	T	T <sub>1</sub>	H	J	
14	6	15.30	7.10	0.66	0.55	14.0	14.0	553
14	8	15.30	9.30	0.66	0.60	14.0	14.0	598
14	10	15.30	11.40	0.66	0.68	14.0	14.0	640
14	12	15.30	13.50	0.66	0.75	14.0	14.0	693
14	14	15.30	15.30	0.66	0.66	14.0	14.0	782
16	6	17.40	7.10	0.70	0.55	15.0	15.0	673
16	8	17.40	9.30	0.70	0.60	15.0	15.0	717
16	10	17.40	11.40	0.70	0.68	15.0	15.0	757
16	12	17.40	13.50	0.70	0.75	15.0	15.0	810
16	14	17.40	15.30	0.70	0.66	15.0	15.0	899
16	16	17.40	17.40	0.70	0.70	15.0	15.0	958
18	6	19.50	7.10	0.75	0.55	13.0	15.5	733
18	8	19.50	9.30	0.75	0.60	13.0	15.5	774
18	10	19.50	11.40	0.75	0.68	13.0	15.5	813
18	12	19.50	13.50	0.75	0.75	13.0	15.5	863
18	14	19.50	15.30	0.75	0.66	16.5	16.5	1044
18	16	19.50	17.40	0.75	0.70	16.5	16.5	1104
18	18	19.50	19.50	0.75	0.75	16.5	16.5	1161
20	6	21.60	7.10	0.80	0.55	14.0	17.0	889

SIZE Inches		DIMENSIONS Inches						WEIGHT Pounds
RUN	BRANCH	D	D <sub>1</sub>	T	T <sub>1</sub>	H	J	
20	8	21.60	9.30	0.80	0.60	14.0	17.0	931
20	10	21.60	11.40	0.80	0.68	14.0	17.0	970
20	12	21.60	13.50	0.80	0.75	14.0	17.0	1021
20	14	21.60	15.30	0.80	0.66	14.0	17.0	1108
20	16	21.60	17.40	0.80	0.70	18.0	18.0	1289
20	18	21.60	19.50	0.80	0.75	18.0	18.0	1347
20	20	21.60	21.60	0.80	0.80	18.0	18.0	1426
24	6	25.80	7.10	0.89	0.55	15.0	19.0	1202
24	8	25.80	9.30	0.89	0.60	15.0	19.0	1243
24	10	25.80	11.40	0.89	0.68	15.0	19.0	1280
24	12	25.80	13.50	0.89	0.75	15.0	19.0	1329
24	14	25.80	15.30	0.89	0.66	15.0	19.0	1413
24	16	25.80	17.40	0.89	0.70	15.0	19.0	1467
24	18	25.80	19.50	0.89	0.75	22.0	22.0	1836
24	20	25.80	21.60	0.89	0.80	22.0	22.0	1920
24	24	25.80	25.80	0.89	0.89	22.0	22.0	2087

866.DIP.PIP



# TR FLEX®

## RESTRAINED JOINT DUCTILE IRON PIPE AND FITTINGS



### 2009 EDITION

## P 36

## TR FLEX Crosses (cont.)

SIZE Inches		DIMENSIONS Inches						WEIGHT Pounds
RUN	BRANCH	D	D <sub>1</sub>	T	T <sub>1</sub>	H	J	
30	6	32.00	7.10	1.00	0.55	18.0	23.0	1919
30	8	32.0	9.30	1.00	0.60	18.0	23.0	1963
30	10	32.0	11.40	1.00	0.68	18.0	23.0	2004
30	12	32.0	13.50	1.00	0.75	18.0	23.0	2058
30	14	32.0	15.30	1.00	0.66	18.0	23.0	2144
30	16	32.0	17.40	1.00	0.70	18.0	23.0	2207
30	18	32.0	19.50	1.00	0.75	18.0	23.0	2271
30	20	32.0	21.60	1.00	0.80	18.0	23.0	2361
30	24	32.0	25.80	1.00	0.89	25.0	25.0	2978
30	30	32.0	32.00	1.00	1.00	25.0	25.0	3247
36	6	38.30	7.10	1.15	0.55	20.0	26.0	2752
36	8	38.30	9.30	1.15	0.60	20.0	26.0	2793
36	10	38.30	11.40	1.15	0.68	20.0	26.0	2831
36	12	38.30	13.50	1.15	0.75	20.0	26.0	2881
36	14	38.30	15.30	1.15	0.66	20.0	26.0	2963
36	16	38.30	17.40	1.15	0.70	20.0	26.0	3020
36	18	38.30	19.50	1.15	0.75	20.0	26.0	3076
36	20	38.30	21.60	1.15	0.80	20.0	26.0	3157
36	24	38.30	25.80	1.15	0.89	20.0	26.0	3328
36	30	38.30	32.00	1.15	1.00	28.0	28.0	4402
36	36	38.30	38.30	1.15	1.15	28.0	28.0	5183

# TR FLEX Wye Branches

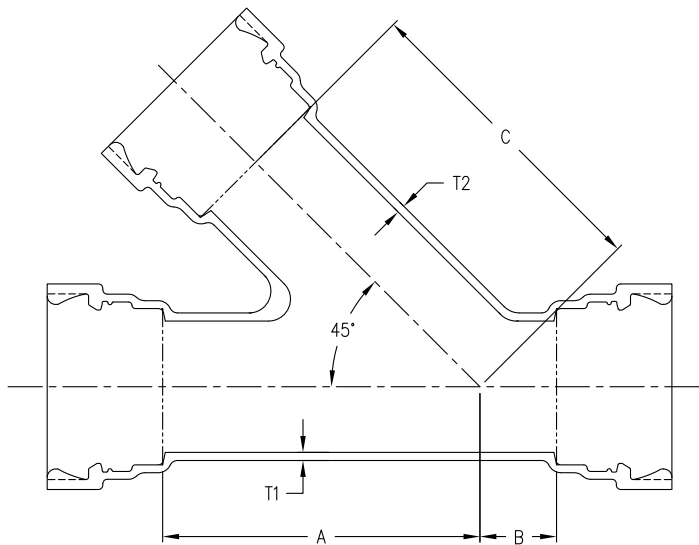

SIZE Inches		THICKNESS		DIMENSIONS Inches			WEIGHT Pounds
RUN	BRANCH	T <sub>1</sub>	T <sub>2</sub>	A	B	C	
10	4	0.68	0.52	20.5	5	20.5	—
10	6	0.68	0.55	20.5	5	20.5	—
10	8	0.68	0.60	20.5	5	20.5	—
10	10	0.80	0.80	20.5	5	20.5	—
12	4	0.75	0.52	24.5	5.5	24.5	—
12	12	0.75	0.75	24.5	5.5	24.5	570

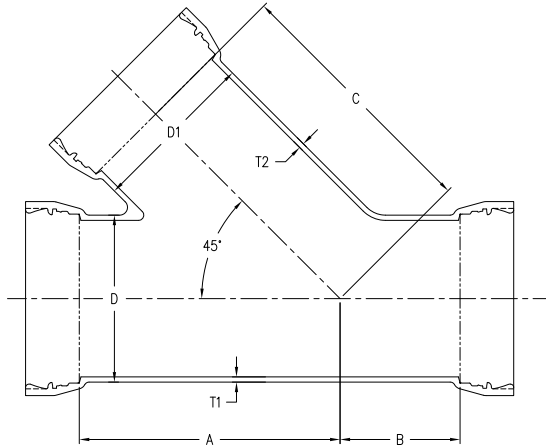
**TR FLEX Wyes**

SIZE Inches		THICKNESS				DIMENSIONS Inches		WEIGHT Pounds
RUN	BRANCH	D	D <sub>1</sub>	T	T <sub>1</sub>	A & C	B	
14	6	15.65	7.10	0.82	0.55	27.0	6.0	608
14	8	15.65	9.30	0.82	0.60	27.0	6.0	641
14	10	15.65	11.40	0.82	0.68	27.0	6.0	673
14	12	15.65	13.50	0.82	0.75	27.0	6.0	721
14	14	15.65	15.30	0.82	0.82	27.0	6.0	794
16	6	17.80	7.10	0.89	0.55	30.0	6.5	775
16	8	17.80	9.30	0.89	0.60	30.0	6.5	808
16	10	17.80	11.40	0.89	0.68	30.0	6.5	845
16	12	17.80	13.50	0.89	0.75	30.0	6.5	888
16	14	17.80	15.30	0.89	0.82	30.0	6.5	966
16	16	17.80	17.40	0.89	0.89	30.0	6.5	1027
18	6	19.92	7.10	0.96	0.55	32.0	7.0	952
18	8	19.92	9.30	0.96	0.60	32.0	7.0	985
18	10	19.92	11.40	0.96	0.68	32.0	7.0	1022
18	12	19.92	13.50	0.96	0.75	32.0	7.0	1065
18	14	19.92	15.30	0.96	0.82	32.0	7.0	1138
18	16	19.92	17.40	0.96	0.89	32.0	7.0	1199
18	18	19.92	19.50	0.96	0.96	32.0	7.0	1265
20	8	22.06	9.30	1.03	0.60	35.0	8.0	1228
20	10	22.06	11.40	1.03	0.68	35.0	8.0	1265
20	12	22.06	13.50	1.03	0.75	35.0	8.0	1308

SIZE Inches		THICKNESS				DIMENSIONS Inches		WEIGHT Pounds
RUN	BRANCH	D	D <sub>1</sub>	T	T <sub>1</sub>	A & C	B	
20	14	22.06	15.30	1.03	0.82	35.0	8.0	1391
20	16	22.06	17.40	1.03	0.89	35.0	8.0	1447
20	18	22.06	19.50	1.03	0.96	35.0	8.0	1513
20	20	22.06	21.60	1.03	1.03	35.0	8.0	1592
24	8	26.32	9.30	1.16	0.60	40.5	9.0	1781
24	10	26.32	11.40	1.16	0.68	40.5	9.0	1854
24	12	26.32	13.50	1.16	0.75	40.5	9.0	1910
24	14	26.32	15.30	1.16	0.82	40.5	9.0	1971
24	16	26.32	17.40	1.16	0.89	40.5	9.0	2035
24	18	26.32	19.50	1.16	0.96	40.5	9.0	2114
24	20	26.32	21.60	1.16	1.03	40.5	9.0	2288
24	24	26.32	25.80	1.16	1.16	40.5	9.0	2505
30	12	32.74	13.50	1.37	0.75	49.0	10.0	3070
30	14	32.74	15.30	1.37	0.82	49.0	10.0	3153
30	16	32.74	17.40	1.37	0.89	49.0	10.0	3219
30	18	32.74	19.50	1.37	0.96	49.0	10.0	3285
30	20	32.74	21.60	1.37	1.03	49.0	10.0	3369
30	24	32.74	25.80	1.37	1.16	49.0	10.0	3558
30	30	32.74	32.00	1.37	1.37	49.0	10.0	3975
36	12	39.16	13.50	1.58	0.75	60.0	19.5	5143
36	14	39.16	15.30	1.58	0.82	60.0	19.5	5336
36	16	39.16	17.40	1.58	0.89	60.0	19.5	5312
36	18	39.16	19.50	1.58	0.96	60.0	19.5	5393
36	20	39.16	21.60	1.58	1.03	60.0	19.5	5487
36	24	39.16	25.80	1.58	1.16	60.0	19.5	5691
36	30	39.16	32.00	1.58	1.37	60.0	19.5	6133
36	36	39.16	38.30	1.58	1.58	60.0	19.5	6682

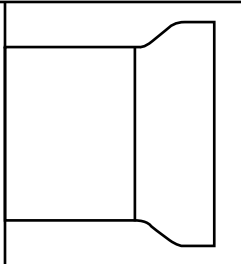

## TR FLEX Fittings Thickness & Dimensions Reducers

TR FLEX Concentric Reducers

SIZE Inches		PRESSURE RATING psi	DIMENSIONS Inches			WEIGHT Pounds
LARGE	SMALL		T	T <sub>1</sub>	L	
6	4	350	0.36	0.34	6.62	50
8	4	350	0.39	0.34	9.84	75
8	6	350	0.39	0.36	5.91	80
10	4	350	0.41	0.34	12.92	100
10	6	350	0.41	0.36	10.02	110
10	8	350	0.41	0.39	6.93	120
12	4	350	0.44	0.34	16.13	140
12	6	350	0.44	0.36	13.23	145
12	8	350	0.44	0.39	10.15	155
12	10	350	0.44	0.41	7.06	165
14	6	350	0.66	0.55	16.00	240
14	8	350	0.66	0.60	16.00	265
14	10	350	0.66	0.68	16.00	295
14	12	350	0.66	0.75	16.00	330
16	6	350	0.70	0.55	18.00	280
16	8	350	0.70	0.60	18.00	305
16	10	350	0.70	0.68	18.00	340
16	12	350	0.70	0.75	18.00	375
16	14	350	0.70	0.66	18.00	425
18	8	350	0.75	0.60	19.00	370
18	10	350	0.75	0.68	19.00	405
18	12	350	0.75	0.75	19.00	445
18	14	350	0.75	0.66	19.00	495
18	16	350	0.75	0.70	19.00	525
20	6	350	0.80	0.55	20.00	—
20	8	350	0.80	0.60	20.00	—
20	10	350	0.80	0.68	20.00	470
20	12	350	0.80	0.75	20.00	510
20	14	350	0.80	0.66	20.00	560
20	16	350	0.80	0.70	20.00	590
20	18	350	0.80	0.75	20.00	650
24	8	350	0.89	0.60	24.00	—
24	10	350	0.89	0.68	24.00	—
24	12	350	0.89	0.75	24.00	680
24	14	350	0.89	0.66	24.00	730

†Actual weight of fittings may exceed those shown.

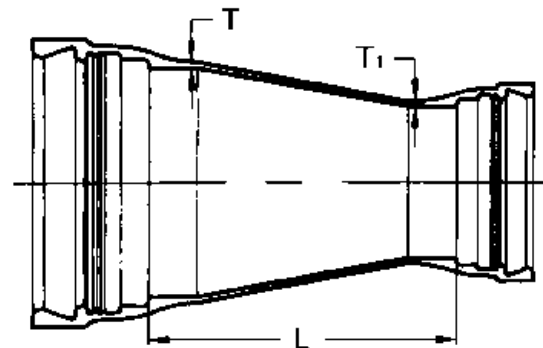

TR FLEX Concentric Reducers

SIZE Inches		PRESSURE RATING psi	DIMENSIONS Inches			WEIGHT Pounds
LARGE	SMALL		T	T <sub>1</sub>	L	
24	16	350	0.89	0.70	24.00	765
24	18	350	0.89	0.75	24.00	830
24	20	350	0.89	0.80	24.00	890
30	12	250	1.03	0.75	30.00	1046
30	16	250	1.03	0.70	30.00	1149
30	18	250	1.03	0.75	24.00	1225
30	20	250	1.03	0.80	24.00	1165
30	24	250	1.03	0.89	24.00	1290
36	18	250	1.15	0.75	24.00	1635
36	20	250	1.15	0.80	36.00	1733
36	24	250	1.15	0.89	24.00	1568
36	30	250	1.15	1.03	24.00	1837

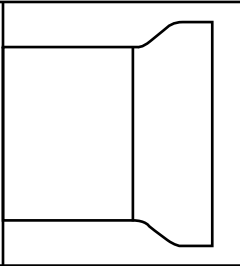

## TR FLEX Fittings Thickness & Dimensions Reducers

### TR FLEX Eccentric Reducers

SIZE Inches		PRESSURE RATING psi	DIMENSIONS Inches			WEIGHT Pounds
LARGE	SMALL		T	T <sub>1</sub>	L	
10	8	350	0.68	0.60	12.0	162
12	4	350	0.75	0.52	14.0	159
12	6	350	0.75	0.55	14.0	180
12	8	350	0.75	0.60	14.0	203
12	10	350	0.75	0.68	14.0	235
14	6	350	0.66	0.55	16.0	243
14	8	350	0.66	0.60	16.0	271
14	10	350	0.66	0.68	16.0	298
14	12	350	0.66	0.75	16.0	334
16	6	350	0.70	0.55	18.0	290
16	8	350	0.70	0.60	18.0	318
16	10	350	0.70	0.68	18.0	355
16	12	350	0.70	0.75	18.0	391
16	14	350	0.70	0.66	18.0	444
18	8	350	0.75	0.60	19.0	372
18	10	350	0.75	0.68	19.0	409
18	12	350	0.75	0.75	19.0	445
18	14	350	0.75	0.66	19.0	498
18	16	350	0.75	0.70	19.0	540
20	10	350	0.80	0.68	20.0	473
20	12	350	0.80	0.75	20.0	514
20	14	350	0.80	0.66	20.0	562
20	16	350	0.80	0.70	20.0	609
20	18	350	0.80	0.75	20.0	658
24	12	350	0.89	0.75	24.0	689
24	14	350	0.89	0.66	24.0	737
24	16	350	0.89	0.70	24.0	784

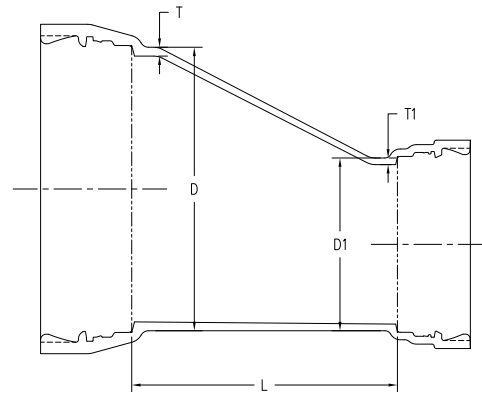

### TR FLEX Eccentric Reducers

SIZE Inches		PRESSURE RATING psi	DIMENSIONS Inches			WEIGHT Pounds
LARGE	SMALL		T	T <sub>1</sub>	L	
24	18	350	0.89	0.75	24.0	838
24	20	350	0.89	0.80	24.0	897
30	18	250	1.03	0.75	30.0	1217
30	20	250	1.03	0.80	30.0	1291
30	24	250	1.03	0.89	30.0	1436
36	20	250	1.15	0.80	36.0	1742
36	24	250	1.15	0.89	36.0	1902
36	30	250	1.15	1.03	36.0	2226



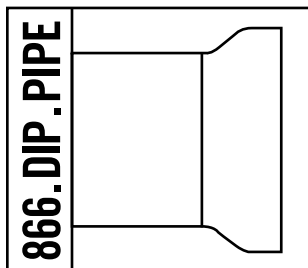

☐ ☐ ☐ ☐

# TR FLEX®

## RESTRAINED JOINT DUCTILE IRON PIPE AND FITTINGS

### 2009 EDITION

### P 41

## TR FLEX Flange Connecting Piece

SIZE Inches	OA Inches	WEIGHT Pounds (125)	WEIGHT Pounds (250)
4"	12.84	45	—
6"	13.27	65	—
8"	13.82	95	—
10"	14.03	135	—
12"	14.30	185	—
14"	15.75	250	—
16"	15.95	300	390
18"	16.19	350	470
20"	16.40	425	570
24"	16.86	570	795

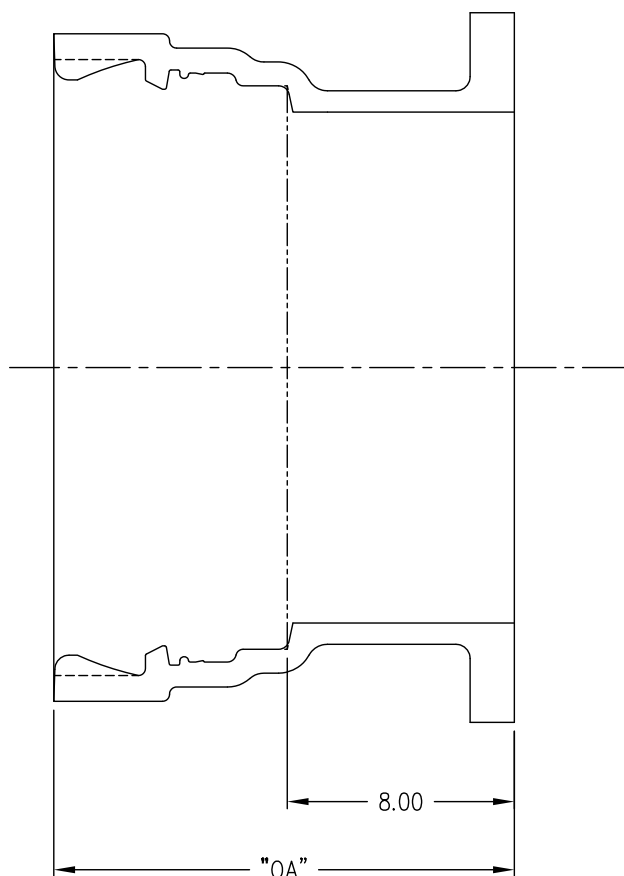

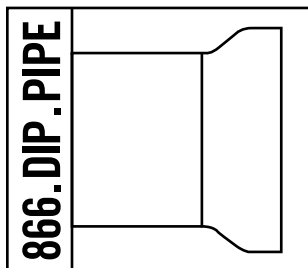

# TR FLEX®

## RESTRAINED JOINT DUCTILE IRON PIPE AND FITTINGS



2009 EDITION

P 42

## TR FLEX Telescoping Sleeves Thickness & Dimensions

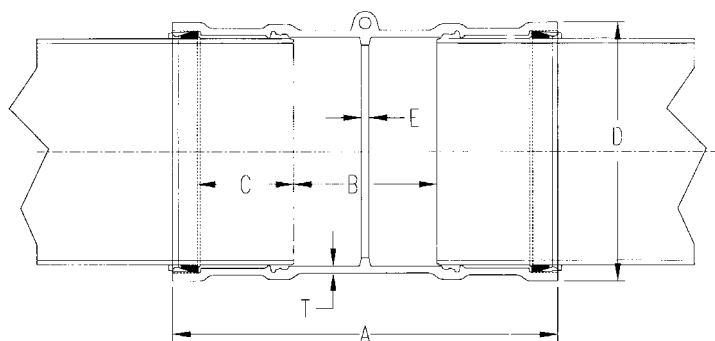

SIZE Inches	PRESSURE RATING psi	DIMENSIONS Inches						WEIGHT Pounds
		A	B	C*	D	E	T	
4	350	29.10	10.68	7.72	7.10	1.00	0.34	55
6	350	31.70	11.54	8.39	9.39	1.00	0.36	90
8	350	35.48	12.64	9.49	11.84	1.00	0.39	145
10	350	37.14	13.06	9.96	14.12	1.00	0.41	195
12	350	38.96	13.60	10.33	16.45	1.00	0.44	260
14	350	46.26	16.50	12.38	19.12	1.00	0.47	395
16	350	49.00	17.10	13.25	21.32	1.00	0.50	490
18	350	49.40	17.88	12.82	23.52	1.50	0.75	745
20	350	50.80	18.44	13.03	25.74	1.64	0.80	875
24	350	53.60	19.40	13.49	30.14	1.68	0.89	1180
30	250	61.40	22.32	15.51	37.18	1.76	1.03	2190
36	250	65.00	23.56	16.20	43.86	1.82	1.15	3060

\*Weld bead location for Telescoping Sleeve end pieces.

The U.S. Pipe TR FLEX Telescoping Sleeve is a Ductile Iron restrained joint fitting. The TR FLEX Telescoping Sleeve may be used in lieu of a mechanical joint sleeve where joint restraint of a Ductile Iron pipeline is required. The TR FLEX Telescoping Sleeve is ideally suited for use as a closure piece when connecting a new restrained joint pipeline to an existing one. Repairs to an existing restrained joint pipeline can be made with the use of a TR FLEX Telescoping Sleeve. This sleeve may also be used to facilitate the installation of fittings or valves in an existing restrained joint pipeline.

For additional information on TR FLEX Telescoping Sleeves, see U.S. Pipe's Telescoping Sleeve Brochure or contact your U.S. Pipe representative.

866.DIP.PIPE



# TR FLEX®

## RESTRAINED JOINT DUCTILE IRON PIPE AND FITTINGS

  
Certified to  
ANSI/AWWA C900

### 2009 EDITION

### P 43

## TR FLEX Sleeve/Connecting Piece

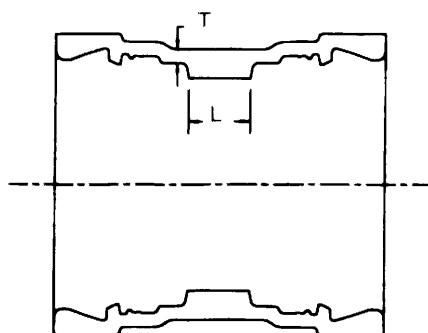

**TR FLEX Sleeve/Connecting Piece**

SIZE Inches	PRESSURE RATING psi	DIMENSIONS Inches		WEIGHT Pounds
		T	L	
6	350	0.36	1.00	55
8	350	0.39	1.00	90
10	350	0.41	1.00	125
12	350	0.44	1.50	175
14	350	0.66	1.50	285
16	350	0.70	1.50	325
18	350	0.75	4.00	430
20	350	0.80	4.36	510
24	350	0.89	4.74	695
30	250	1.03	7.00	1125

*The above sleeves are used to connect TR FLEX Pipe spigots and have an internal stop of laying length L. They are a component part of the XTRA FLEX® High Deflection Fitting. Please request our XTRA FLEX® Restrained Joint High Deflection Fittings brochure for additional information or contact your U.S. Pipe Representative.*

## TR FLEX Fittings Thickness & Dimensions Caps & Plugs

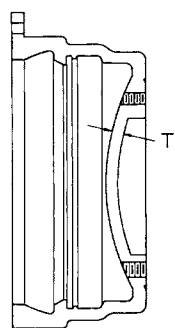

14" - 36"

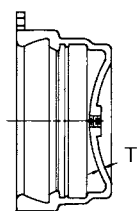

4" - 12"

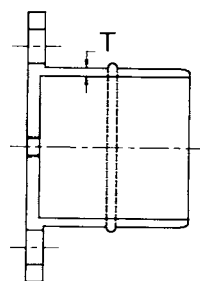

4" - 10"

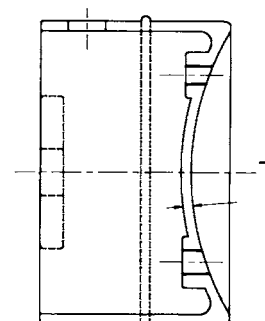

12" - 36"

TR FLEX Fittings Thickness & Dimensions Caps

SIZE Inches	PRESSURE RATING psi	T Inches	WEIGHT Pounds
4	350	0.34	15
6	350	0.36	25
8	350	0.39	40
10	350	0.41	60
12	350	0.44	90
14	350	0.66	165
16	350	0.70	205
18	350	0.75	250
20	350	0.80	305
24	350	0.89	440
30	250	1.03	780
36	250	1.15	1250

TR FLEX Fittings Thickness & Dimensions Plugs

SIZE Inches	PRESSURE RATING psi	T Inches	WEIGHT Pounds
4	350	0.33	16
6	350	0.36	28
8	350	0.39	43
10	350	0.41	70
12	350	0.44	64
14	350	0.47	89
16	350	0.50	108
18	350	0.75	290
20	350	0.80	362
24	350	0.89	520
30	250	1.03	922
36	250	1.15	1302

†Actual weight of fittings may exceed those shown.

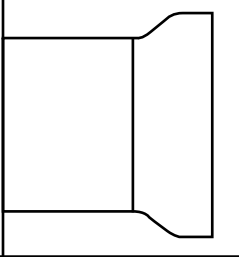

### Products for Water, Wastewater and Fire Protection

Ductile Iron Pipe	SIZE RANGE
TYTON JOINT® Pipe	4"-64" Ductile Iron
Mechanical Joint Pipe	4"-12" Ductile Iron
TR FLEX® Pipe	4"-36" Ductile Iron
HP LOK® Pipe	30"-64" Ductile Iron
Flanged Pipe	3"-64" Ductile Iron
Grooved Pipe	4"-36" Ductile Iron
USIFLEX® Boltless Ball Joint Pipe For Subaqueous Installations	4"-48" Ductile Iron
<b>Restrained Joints</b>	
TR FLEX® Restrained Joint	4"-36" Ductile Iron
HP LOK® Restrained Joint	30"-64" Ductile Iron
MJ FIELD LOK® Gaskets	4"-24"
FIELD LOK 350® Gaskets	4"-24"
FIELD LOK® Gasket	30" & 36"
TR FLEX GRIPPER® Rings	4"-36" Ductile Iron
TR TELE FLEX® Assemblies	4"-24" Ductile Iron
<b>Fittings</b>	
TYTON® Fittings	14"-24" Ductile Iron
TRIM TYTON® Fittings	4"-12" Ductile Iron
TR FLEX® Fittings and TR FLEX® Telescoping Sleeves	4"-36" Ductile Iron
HP LOK® Fittings and HP LOK® Telescoping Sleeves	30"-64" Ductile Iron
Mechanical Joint Fittings	30"-48" Ductile Iron
Flanged Fittings	30"-64" Ductile Iron
XTRA FLEX® Couplings	4"-24" Ductile Iron
<b>Miscellaneous Products</b>	
PROTECTO 401™ Lined Ductile Iron Pipe for Domestic Sewage and Industrial Wastes	4"-64" Ductile Iron
GLASS Lined Ductile Iron Pipe for Wastewater Treatment Plants	4"-30" Ductile Iron
RING FLANGE-TYTE® Gaskets	4"-36"
FULL FACE FLANGE-TYTE® Gaskets	4"-64"
MJ Harness-Lok	4"-48" Ductile Iron
Saddle Outlets	Various Ductile Iron
Welded Outlets	Various Ductile Iron
Polyethylene Encasement	4"-64"

*Our products are manufactured in conformance with National Standards so that our customers may be assured of getting the performance and longevity they expect. Use of accessories or other appurtenances that do not comply with recognized standards may jeopardize the performance and longevity of the project.*

*All U.S. Pipe brochures and/or products are  
subject to change without further notice.*

---

P.O. BOX 10406  
BIRMINGHAM, AL 35202  
866.DIP.PIPE (866.347.7473)  
FAX: 205.254.7165  
EMAIL: [INFO@USPIPE.COM](mailto:INFO@USPIPE.COM)  
[WWW.USPIPE.COM](http://WWW.USPIPE.COM)

**MORE  
THAN  
JUST  
PIPE.**

