

## FEATURES

- Framed and unframed door styles with tubular handle.
- Crafted of heavy-duty stainless steel.
- Dual convection oven with two fans for even heat distribution.
- Ten cooking modes—bake, roast, broil, convection, convection bake, convection roast, convection broil and proof—bake stone and dehydration modes require accessory.
- Wolf exclusive rotating glass touch control panel.
- Cobalt blue porcelain oven interior.
- Large viewing, triple-pane window and dual halogen interior lights.
- Three adjustable oven racks; one full-extension easy glide, one full-extension door glide and one standard.
- Hidden bake element and recessed broil element.
- Temperature probe and broiler pan.
- Self-clean, delayed start, timed cook and Sabbath features.
- Wolf exclusive spring and damper door hinge system for smooth opening and closing.



MODEL	
Framed	SO30F/S
Unframed	SO30U/S

## ACCESSORIES

- Bake stone kit (stone, rack and peel).
- Dehydration kit (racks and door stop).
- Set of three standard oven racks.
- Full-extension easy glide oven rack.
- 30" baking sheet.
- Temperature probe and broiler pan.

Accessories available through an authorized Wolf dealer. For local dealer information, visit the find a showroom section of our website, [wolfappliance.com](http://wolfappliance.com).

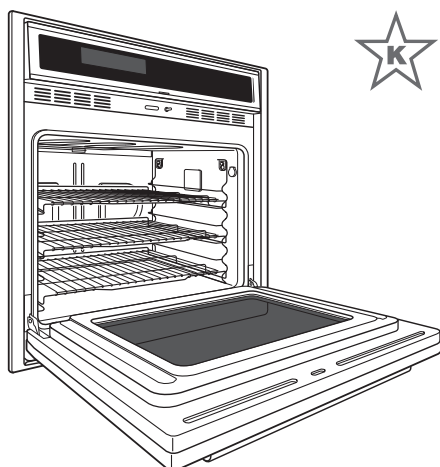

Model SO30F/S



Model SO30F/S



Model SO30U/S

## SPECIFICATIONS

### PRODUCT

Dimensions	29 <sup>7</sup> / <sub>8</sub> "W x 27 <sup>1</sup> / <sub>2</sub> "H x 24"D
Door Clearance	20 <sup>3</sup> / <sub>4</sub> "
Weight	273 lb

### OVEN INTERIOR

Capacity	4.5 cu ft
Interior	25"W x 16 <sup>1</sup> / <sub>2</sub> "H x 19"D

### ELECTRICAL

Supply	240/208 VAC, 60 Hz
Service	30 amp circuit
Conduit	4"

Specifications are subject to change without notice. Visit [wolfappliance.com/specs](http://wolfappliance.com/specs) for the most up-to-date information.

Dimensions may vary  $\pm 1/8$ " (3). Dimensions in parentheses are millimeters unless otherwise specified.

## DIMENSIONS

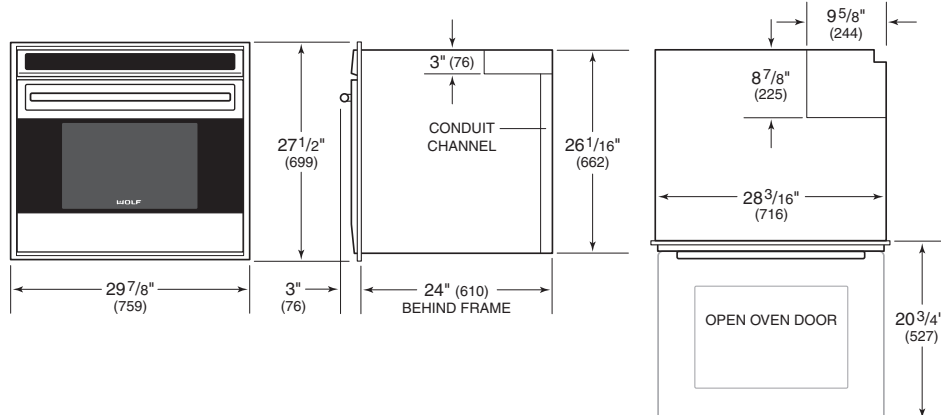

## INSTALLATION

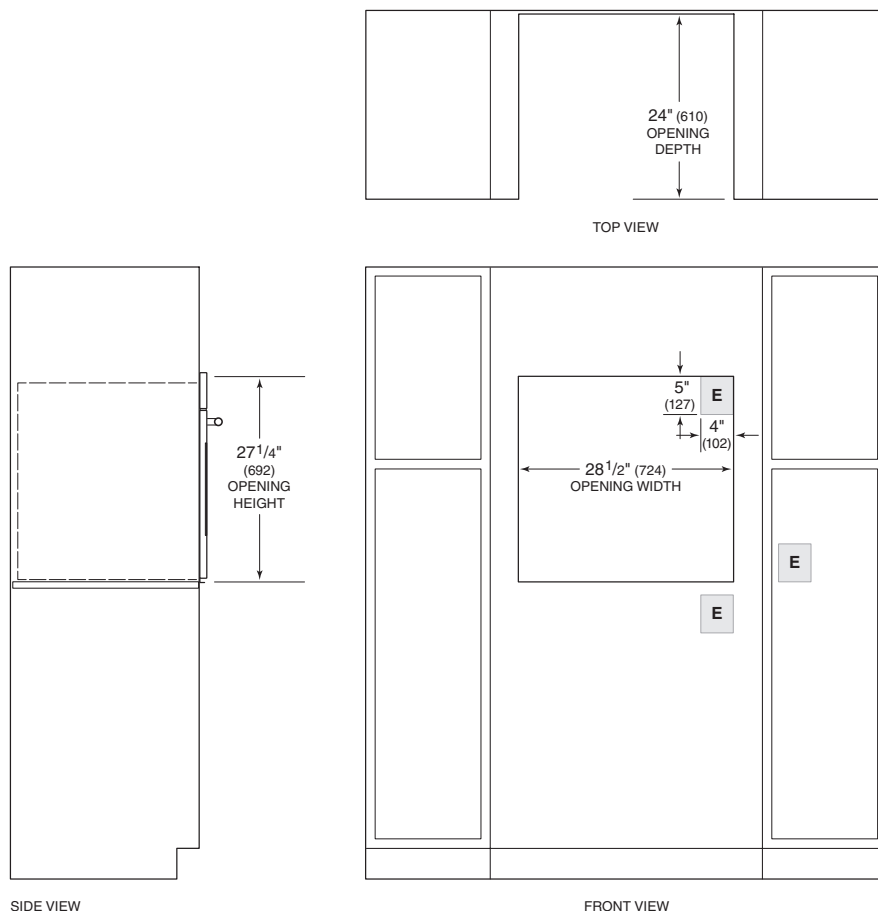

NOTE: Location of electrical supply within opening may require additional cabinet depth. Dashed line represents profile of unit.