

DIMENSIONAL SPECIFICATIONS

LEAD-FREE IMPORT BRASS FITTINGS* 125 LB.

CROSS

| Part # | Size (IN.) | Approx. Net WT. (LB.) | A | B | C |
|-----------|------------|-----------------------|------|------|------|
| XNL110-04 | 1/4 | 0.20 | 0.72 | 0.34 | 0.81 |
| XNL110-08 | 1/2 | 0.44 | 1.03 | 0.45 | 1.17 |
| XNL110-12 | 3/4 | 0.68 | 1.19 | 0.52 | 1.42 |
| XNL110-16 | 1 | 1.08 | 1.43 | 0.60 | 1.72 |
| XNL110-24 | 1-1/2 | 1.97 | 1.87 | 0.70 | 2.38 |
| XNL110-32 | 2 | 2.52 | 2.14 | 0.76 | 2.92 |

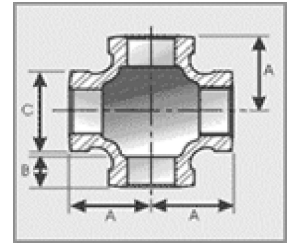

CAP

| Part # | Size (IN.) | Approx. Net WT. (LB.) | G1 | G2 | A |
|-----------|------------|-----------------------|------|------|------|
| XNL116-02 | 1/8 | 0.08 | 0.08 | 0.09 | 0.25 |
| XNL116-04 | 1/4 | 0.07 | 0.08 | 0.10 | 0.32 |
| XNL116-06 | 3/8 | 0.09 | 0.09 | 0.11 | 0.36 |
| XNL116-08 | 1/2 | 0.13 | 0.09 | 0.12 | 0.45 |
| XNL116-12 | 3/4 | 0.22 | 0.10 | 0.13 | 0.50 |
| XNL116-16 | 1 | 0.40 | 0.11 | 0.15 | 0.58 |
| XNL116-20 | 1-1/4 | 0.48 | 0.12 | 0.17 | 0.67 |
| XNL116-24 | 1-1/2 | 0.72 | 0.13 | 0.19 | 0.70 |
| XNL116-32 | 2 | 1.11 | 0.15 | 0.22 | 0.75 |
| XNL116-40 | 2-1/2 | 1.75 | 0.17 | 0.25 | 0.92 |
| XNL116-48 | 3 | 2.71 | 0.19 | 0.29 | 0.98 |
| XNL116-64 | 4 | 4.64 | 0.22 | 0.36 | 1.08 |

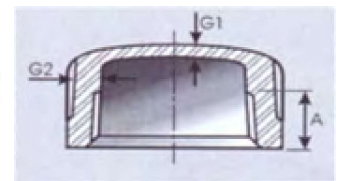

*Conforms with lead content requirements for lead-free plumbing as defined by the U.S. Safe Drinking Water Act. Certified <0.25 weighted average % lead.



MERIT BRASS

DIRECTING THE FLOW OF *Quality*