

# Pipe Hangers



Pipe hangers offered in this section are designed to support insulated or non-insulated pipe allowing for vertical adjustment and limited movement in the piping system.

## Materials

Carbon Steel, Malleable Iron and AISI Type 304 & 316 Stainless Steel are used in the manufacturing of pipe hangers. Other materials are available.

## Finishes

The standard finishes for mechanical supports are plain steel (oil coated) sometimes referred to as black, Electro-Galvanized Zinc (ASTM B633 SC3), Pre-Galvanized (ASTM A653 G90), Hot-Dip Galvanized After Fabrication (ASTM A123), Red Primer, Plastic Coating, DURA GREEN™, DURA-COPPER™ and other special coatings are available upon request.

**Note:** Due to the design of some products, (threads, connecting hardware, swivels, etc.) items may or may not be uniformly coated with special finishes i.e. Hot-Dip Galvanized, DURA GREEN, DURA-COPPER, PVC etc. In some cases, the hanger itself may be coated, however, the hardware may be supplied Electro-Plated, DURA-COPPER Painted or Stainless Steel. Consult customer service for availability.

## Approvals (as noted)

Items in this section are Underwriters Laboratories Listed, Factory Mutual Approved, and comply with Federal Specification VVW-H-171E & A-A-1192A or Manufacturers Standardization Society ANSI/MSS SP-69 & SP-58.

Seismic Restraints Catalog approved by the State of California Office of Statewide Health Planning and Development (OSHPD).

# Pipe Hangers

## TOLCO™ Fig. 200H - Heavy Duty Band Hanger (For Trapeze)

**Size Range:** 2" (50mm) thru 4" (100mm) trapeze pipe size.

**Material:** Steel — Pre-Galvanized to G40 Spec

**Function:** Designed primarily to support substantially heavier loads than is normally intended for the nominal hanger size. Used extensively to support trapeze installations and the increased loads from both above and below the trapeze assembly.

**Features:** Furnished with 3/8"-16 or 1/2"-13 adjusting threaded ring nut.

**Approvals:** Underwriters Laboratories listed in the USA (UL) and Canada (cUL). Conforms to Federal Specification WW-H-171E & A-A-1192A, Type 10 and Manufacturers Standardization Society ANSI/MSS SP-69 & SP-58, Type 10.

**Maximum Temperature:** 650°F (343°C)

**Finish:** Pre-Galvanized

**Order By:** Part number, pipe size and rod size.

**Important Design Note.** Because of the increased loads applied to the trapeze assembly, both the upper trapeze supports as well as the lower hanging unit must be able to hold the maximum loads intended.

† If using metric rods the M8 rod size is not UL Listed

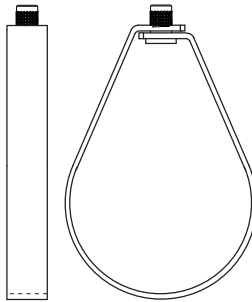
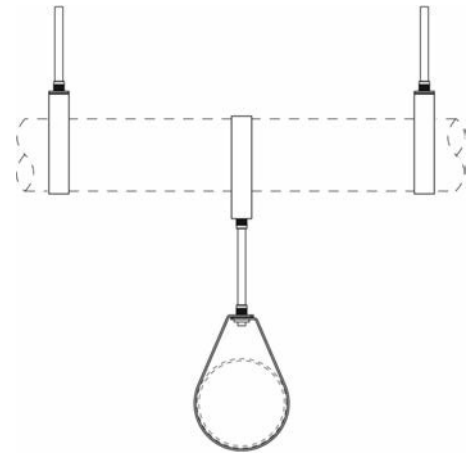
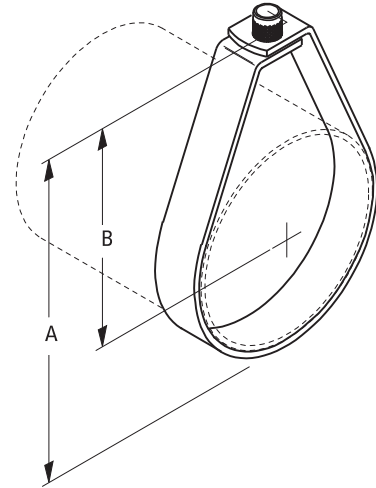

Part No.	Pipe Size in. (mm)	Rod Size	A in. (mm)	B in. (mm)	Max. Rec. Load lbs. (kN)	Approx. Wt./100 lbs. (kg)
200H-2-3/8	2" (50)	3/8"-16†	4 <sup>9</sup> / <sub>16</sub> " (115.9)	3 <sup>7</sup> / <sub>32</sub> " (81.7)	1200 (5.34)	48 (21.8)
200H-2-1/2	2" (50)	1/2"-13	4 <sup>23</sup> / <sub>32</sub> " (119.8)	3 <sup>3</sup> / <sub>8</sub> " (85.7)	1200 (5.34)	45 (20.4)
200H-2 <sup>1</sup> / <sub>2</sub> -3/8	2 <sup>1</sup> / <sub>2</sub> " (65)	3/8"-16†	5 <sup>5</sup> / <sub>16</sub> " (134.9)	3 <sup>23</sup> / <sub>32</sub> " (94.4)	1200 (5.34)	59 (26.7)
200H-2 <sup>1</sup> / <sub>2</sub> -1/2	2 <sup>1</sup> / <sub>2</sub> " (65)	1/2"-13	5 <sup>15</sup> / <sub>32</sub> " (138.9)	3 <sup>7</sup> / <sub>8</sub> " (98.3)	1200 (5.34)	56 (25.4)
200H-3-3/8	3" (75)	3/8"-16†	5 <sup>3</sup> / <sub>4</sub> " (146.0)	3 <sup>27</sup> / <sub>32</sub> " (97.6)	1200 (5.34)	63 (28.6)
200H-3-1/2	3" (75)	1/2"-13	5 <sup>7</sup> / <sub>8</sub> " (148.1)	3 <sup>31</sup> / <sub>32</sub> " (100.8)	1200 (5.34)	60 (27.2)
200H-4-3/8	4" (100)	3/8"-16†	6 <sup>7</sup> / <sub>8</sub> " (174.6)	4 <sup>7</sup> / <sub>16</sub> " (112.7)	1200 (5.34)	76 (34.5)
200H-4-1/2	4" (100)	1/2"-13	7 <sup>1</sup> / <sub>32</sub> " (178.6)	4 <sup>19</sup> / <sub>32</sub> " (116.7)	1200 (5.34)	73 (33.1)

Note:

Select trapeze pipe size based on section modulus required for span of trapeze per information provided in NFPA 13 (2002) Table 9.1.1.6.1 (a and b).

All sizes are UL Listed to support up to 8" pipe at max spacing per NFPA 13.

For 6" (150mm) and 8" (200mm) trapeze pipe, consult factory.

All dimensions in charts and on drawings are in inches. Dimensions shown in parentheses are in millimeters unless otherwise specified.