

Installer's Guide

Barometric Relief Damper

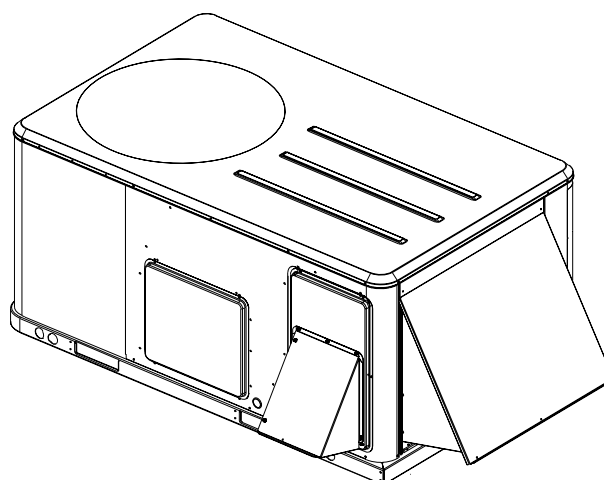

Model Number:	Used With:		
BAYBARM010A	T*C036-060A*R	TSC060BDK	TSC036E-060E*R
	THC033A*R	THC043A*R	THC063A*R
	THC036E*R	YHC036E*R	Y*C036-060A*R
	YSC060BDK	YSC036E-060E*R	YHC033A*R
	YHC043A*R	YHC063A*R	WSC036-060A*R
	WSC060BDK	WSC036E-048E*R	
BAYBARM011A	T*C072-120A*R	TSC072-120BDK	Y*C072-120A*R
	TSC072-120E*R	YSC072-120E*R	YSC072-120BDK
	THC048-060E*R	YHC048-060E*R	
	WSC072-120A*R	WSC072-090BDK	WSC060E*R

Preface and Warnings and Cautions

Hazard Identification

Warnings and Cautions appear at appropriate sections throughout this manual. Read these carefully.

WARNING

Indicates a potentially hazardous situation which, if not avoided, could result in death or serious injury.

CAUTION

Indicates a potentially hazardous situation which, if not avoided, may result in minor or moderate injury. It may also be used to alert against unsafe practices.

CAUTION

Indicates a situation that may result in equipment or property-damage-only accidents.

Model Number Description

All products are identified by a multiple-character model number that precisely identifies a particular type of unit. Its use will enable the owner/operator, installing contractors, and service engineers to define the operation, specific components, and other options for any specific unit.

When ordering replacement parts or requesting service, be sure to refer to the specific model number and serial number printed on the unit nameplate.

General Information

This booklet covers field set-up and installation of Barometric Relief dampers shipped with the unit from the factory and Barometric Relief damper accessory kits shipped for field installation. Refer to Barometric Relief Damper Shipped with Unit Field Set Up Procedures for damper setup below. If installing a Barometric Relief damper accessory kit see installation instructions on page 4 of this booklet.

Barometric Relief Damper Shipped with Unit

Parts List

- 1 - Barometric Relief Hood
- 1 - Duct Cover w/ Barometric Relief Cutout
- 1 - Barometric Relief Blade
- 1 - Mist Eliminator
- 1 - Rain shield
- 8 - Screws (T/W/Y036-060, except T/YHC048-060E, and WSC060E, units), (TH/YHC033 - 063 units)
- 10 - Screws (WSC060E, T/YHC048-060E, T/W/Y072-120 units)

Barometric Relief Damper Accessory Kit

Parts List

- 1 - Barometric Relief Hood
- 1 - Duct Cover w/ Barometric Relief Cutout
- 1 - Barometric Relief Blade
- 1 - Mist Eliminator
- 1 - Rain shield
- 9 - Screws (T/W/Y036-060, except T/YHC048-060E, and WSC060E, units), (TH/YHC033 - 063 units)
- 11 - Screws (T/YHC048-060E, WSC060E, T/W/Y072-120 units)

Installation

Barometric Relief Damper Shipped with Unit

Field Set Up Procedures

Note: This instruction covers installation of BAYBARM010A, (T/W/Y036-060 units except T/YHC048-060E, and WSC060E), (TH/YH033-063 units) and BAYBARM011A, (WSC060E, T/YHC048-060E, T/W/Y072-120 units).

Figure 1.

RETURN DUCT COVER W/
BAROMETRIC RELIEF OPENING AND
SWINGING BLADE.

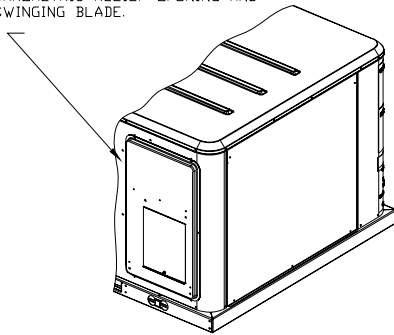

⚠ WARNING Hazardous Voltage!

Disconnect all electric power, including remote disconnects before servicing. Follow proper lockout/tagout procedures to ensure the power can not be inadvertently energized. Failure to disconnect power before servicing could result in death or serious injury.

1. Remove the barometric relief return air panel and pull off the clear film covering it.
2. The shipping location for the rain shield, internal hood parts and mist eliminator is in the return air section. Refer to Figure 2.

Figure 2.

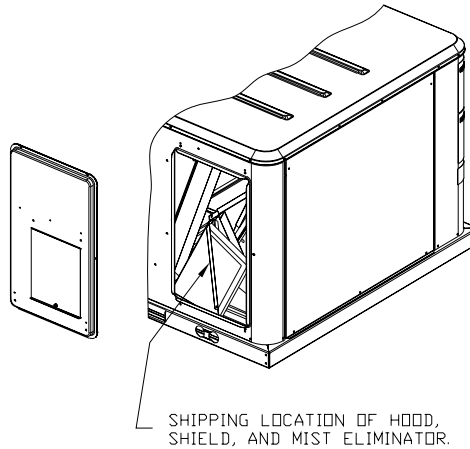

3. Remove the two screws that hold the rain shield components and internal hood components together. Refer to Figure 3.

Figure 3.

REMOVE TWO (2) SCREWS TO SEPARATE
RAIN SHIELD COMPONENTS FROM INTERNAL
HOOD COMPONENTS

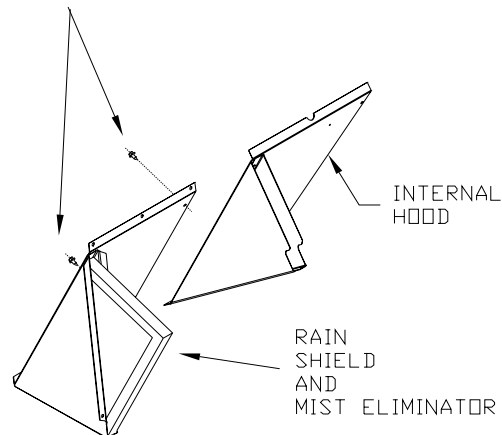

4. Remove the screw holding the rain shield and rain shield leg together. Refer to Figure 4.

Figure 4.

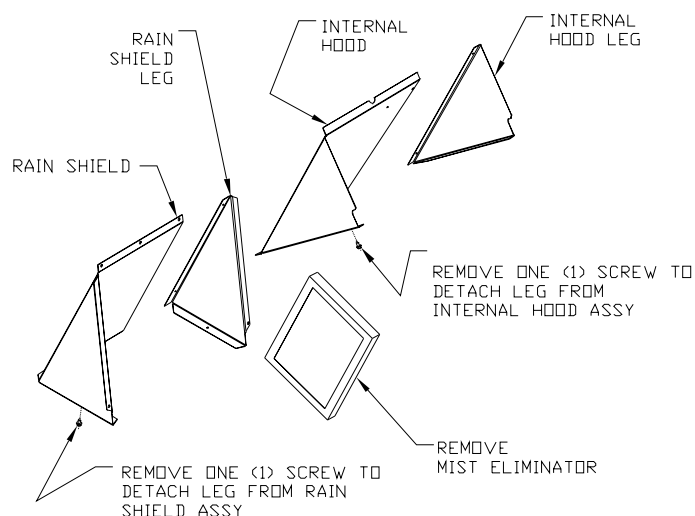

5. Attach rain shield leg to rain shield with 2 screws for (T/W/Y036-060, except except T/YHC048-060E, and WSC060E units) or 3 screws for (T/YHC048-060E, WSC060E, T/W/Y072-120 units). Refer to Figure 5.

Figure 5.

ATTACH LEGS OF RAIN SHIELD AND INTERNAL HOOD.

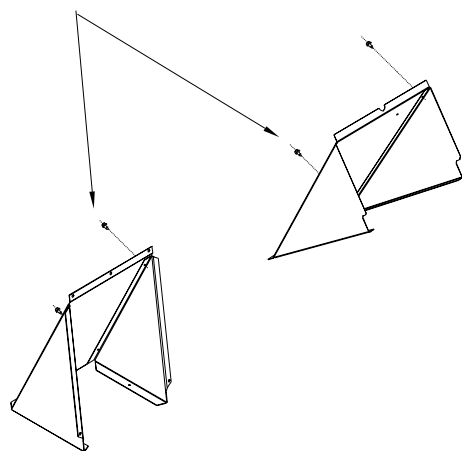

6. Attach internal hood leg to internal hood with 2 screws for (T/W/Y036-060, except T/YHC048-060E, and WSC060E units) or 3 screws for (T/YHC048-060E, WSC060E, T/W/Y072-120 units). Refer to Figure 5.

7. Remove one screw holding the Barometric Relief Blade to the duct cover. Refer to Figure 6.

Figure 6.

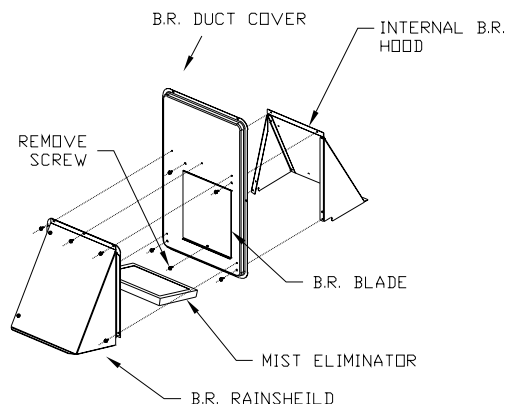

8. Attach the internal hood to the duct cover using four screws. Refer to Figure 6.
9. Insert the mist eliminator in the rain shield. Refer to Figure 6.
10. Attach the rain shield with mist eliminator to the duct cover using 5 screws. Refer to Figure 6.

Note: If unit has a factory installed economizer, remove the return duct blockoff. Refer to Figure 7. If you are field installing an economizer along with the barometric relief damper, do not install the return air blockoff contained in the economizer kit.

Note: Economizer must be in the open position prior to installing barometric relief.

11. Attach the assembly to the unit using six screws. Refer to Figure 7.

Installation

Figure 7.

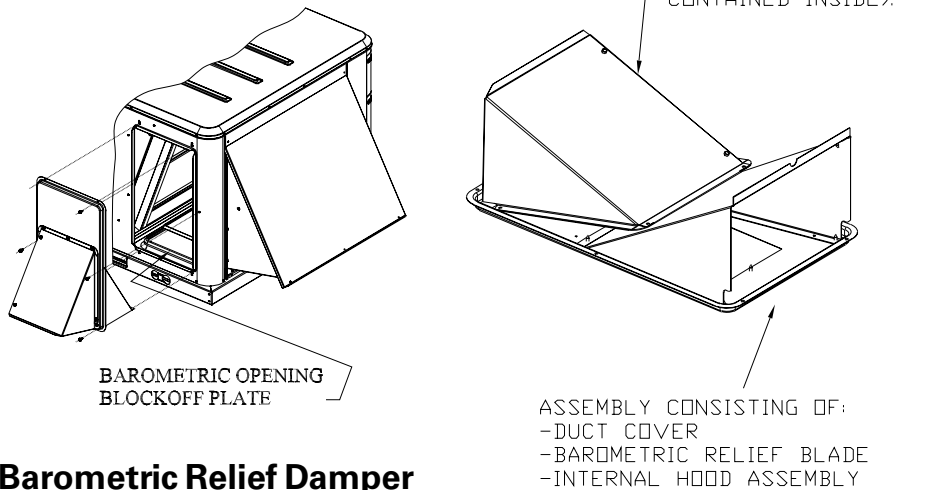

Barometric Relief Damper Accessory Kit

Field Set Up Procedures

Note: This instruction covers installation of BAYBARM010A, (T/W/Y036-060, except T/YHC048-060E, and WSC060E, units), (TH/YH033-063 units) and BAYBARM011A, (T/YHC048-060E, WSC060E, T/W/Y072-120 units)

⚠ WARNING Hazardous Voltage!

Disconnect all electric power, including remote disconnects before servicing. Follow proper lockout/tagout procedures to ensure the power can not be inadvertently energized. Failure to disconnect power before servicing could result in death or serious injury.

Figure 8.

1. Remove existing return air panel.
2. Separate rain shield with mist eliminator from main assembly. See Figure 9.

Figure 9.

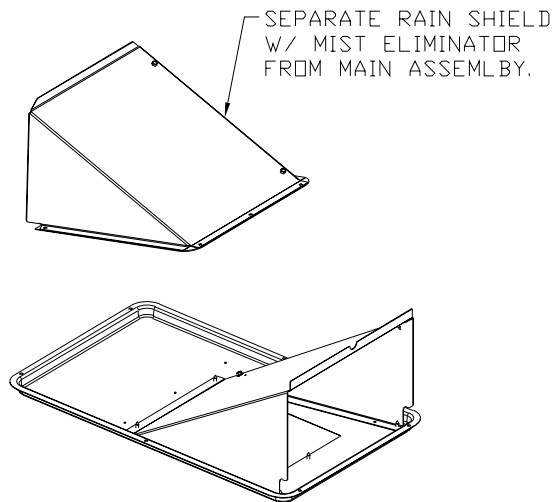

3. Insert mist eliminator in the external rain shield. Refer to Figure 10.

Figure 10.

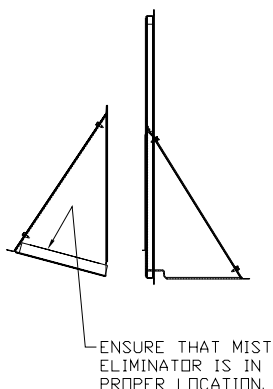

4. Remove screw holding the barometric relief blade. The barometric relief blade must swing freely. Refer to Figure 11.

Figure 11.

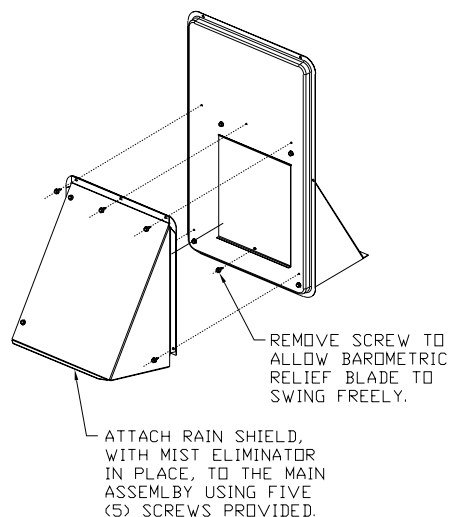

5. Attach rain shield with mist eliminator in place to the duct cover assembly using 5 screws. Refer to Figure 11.

Note: If unit has a factory installed economizer, remove the return duct blockoff. Refer to Figure 12. If you are field installing an economizer along with the barometric relief damper, do not install the return air blockoff

contained in the economizer kit.

Note: Economizer must be in the open position prior to installing barometric relief.

6. Attach the assembly to the unit using six screws. Refer to Figure 12.

Figure 12.

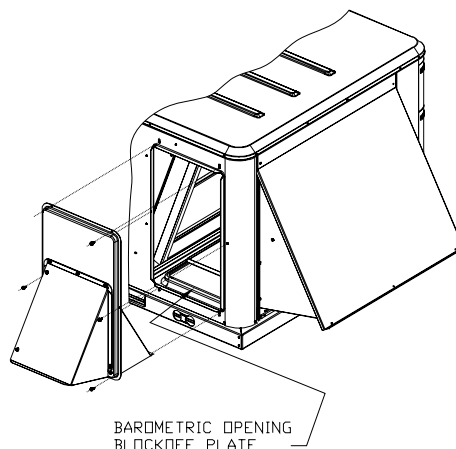

Literature Order Number	ACC-SVN52C-EN
Date	05/07
Supersedes	ACC-SVN52B-EN (10/06)

The manufacturer has a policy of continuous product and product data improvement and reserves the right to change design and specifications without notice.