



**AMERON**

FIBERGLASS-COMPOSITE PIPE GROUP

## Dualoy® 3000/LCX Installation

# Dualoy® 3000/LCX Secondary Containment Fittings for Closed Systems

## IMPORTANT INFORMATION – FOLLOW ALL INSTRUCTIONS

### Uses and applications

- Service station product, vent and vapor recovery piping
- Bulk plant terminals and fueling terminals
- Central fuel oil systems
- Marinas and marine terminals
- All underground piping systems with closed containment systems as defined by and requiring Listing by UL or cUL for motor vehicle, high blend, concentrated or aviation and marine fuels.
- **Designed for use with pressure, vacuum or hydrostatic monitoring systems**
- Underground use only

### Description

Dualoy 3000/LCX piping is UL Listed for use with Motor Vehicle Fuels, Concentrated Fuels, High Blend Fuels and Aviation and Marine Fuels. The integral containment system is UL Listed as a Closed System when installed according to this guide.

The Closed system rating consists of the following components:

- Ameron Dualoy 3000/LCX coaxial pipe
- 3000/LCX Containment Clamshell Elbows and Tees with reinforcing pipe rings
- 3000/LCX Containment Clamshell Couplings and Termination Sleeves

### Listings and approvals



The ring-reinforced clamshell fittings, as part of Dualoy 3000/LCX product are Listed in United States and Canada with Underwriters Laboratories for nonmetallic underground piping for motor vehicle, high blend, concentrated or aviation and marine fuels under File MH9162.

### Performance

Containment pressure rating to 50 psig.  
Continuous operating temperatures to 150°F (66°C).



## Reinforcement ring dimensions

The reinforcement rings are made from Dualoy 3000/L or Dualoy 3000/LCX primary pipe.

### Elbow reinforcement ring

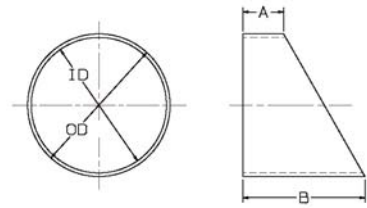

Ring Nominal Size (in)	OD (in)	ID (in)	A (in)	B (in)	Clamshell Size (in)
3	3.51	3.33	1.0	3.0	2
4	4.51	4.33	1.5	3.6	3

### Tee trunk reinforcement ring

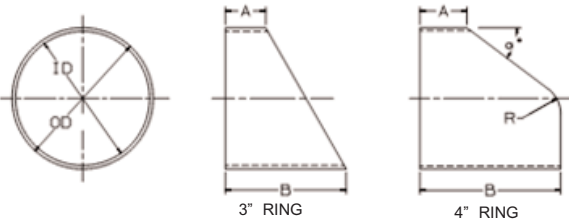

Ring Nominal Size (in)	OD (in)	ID (in)	A (in)	B (in)	a (deg)	R (in)	Clamshell Size (in)
3	3.51	3.33	1.0	3.0	-	-	2
4	4.51	4.33	1.5	3.6	37	1.0	3

### Tee branch reinforcement ring

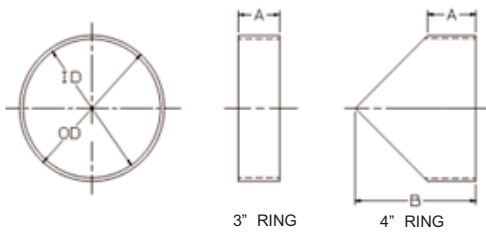

Ring Nominal Size (in)	OD (in)	ID (in)	A (in)	B (in)	Clamshell Size (in)
3	3.51	3.33	1.0		2
4	4.51	4.33	1.5	3.7	3

## Bonding reinforced containment piping

Reinforcements are required only for 90° elbows, 45° elbows and tees for a 50 psig rating.

The reinforcement rings should be properly located inside the clamshells during the bonding. Item #1 is the clamshell fitting and items #2 and #3 are the reinforcements.

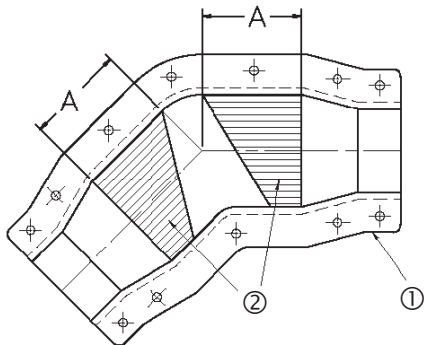

### Reinforced 45° elbow

Clamshell Size (in)	A (in)	Ring Nominal Size (in)
2	3.12	3
3	3.76	4

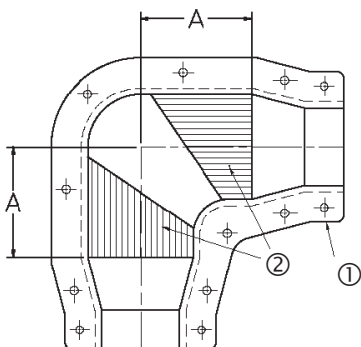

### Reinforced 90° elbow

Clamshell Size (in)	A (in)	Ring Nominal Size (in)
2	3.75	3
3	4.80	4

## Bonding reinforced containment piping (continued)

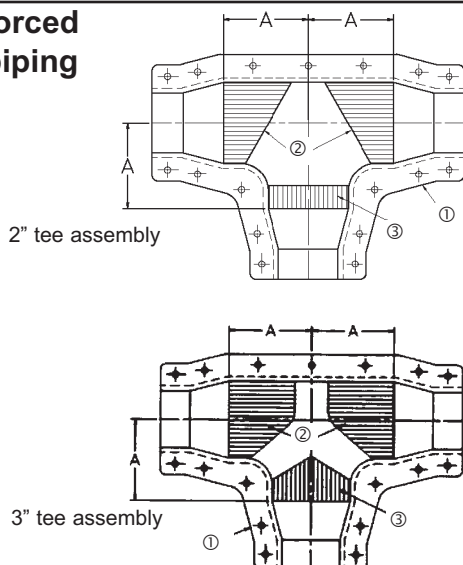

### Reinforced tee

Clamshell Size (in)	A	Ring Nominal Size (in)
2	3.75	3
3	4.80	4

## Bonding procedure

The bonding procedures specific to the reinforced clamshell fittings are described here. For more details of common installation procedures refer to Ameron INSTALLATION PRACTICES FOR DUALLOY 3000/LCX COAXIAL FIBERGLASS PIPING SYSTEM WITH BONDED CLAMSHELL FITTINGS, BULLETIN 9903, FP824.



Bonding surfaces on pipe, reinforcement rings and clamshells must be fully sanded.

Reinforcement rings should be placed over the primary line before bonding it.



Apply adhesive to the whole outside surface of the reinforcement ring.

Apply adhesive to all bonding surfaces on pipe as well.



Apply adhesive to the clamshell flange, rim and inside bonding surfaces.



Put the lower half of the clamshell on first. Make sure it is the half with propeller nuts.

## Bonding procedure (continued)



Adjust the reinforcement rings if necessary to make sure they are properly located.



Close the upper half of the clamshells, place bolts and tighten properly.

Remove excess adhesive and leave a smooth bead.

## Health and safety information

FOR CHEMICAL EMERGENCY  
SPILL, LEAK, FIRE, EXPOSURE  
OR ACCIDENT  
CALL **CHEMTREC-DAY**  
OR NIGHT  
1-800-424-9300  
Toll-free in the continental U.S.  
202-483-7616 in District of  
Columbia  
For calls originating outside the  
continental U.S.  
202-483-7616-Washington D.C.  
collect

### Toxicity of adhesive

**Hardener:** Irritating to the skin, eyes and respiratory tract; toxic orally; may cause sensitization.

**Resin:** May be mildly irritating to skin and eyes; may cause sensitization.

### Handling precautions for adhesive

**Hardener:** Do not get in eyes, on skin or clothing. Avoid breathing vapor. Wash thoroughly after handling. When handling in the field, wear gloves and eye protection. When handling in bulk quantities, wear rubber gloves, rubber apron and NIOSH approved respirator.

**Resin:** Avoid contact with eyes, skin or clothing. When handling in the field, wear gloves and eye protection. Wash thoroughly after handling.

### First aid for adhesive users

#### In case of contact

**Eyes:** Immediately flush with plenty of water for at least 15 minutes. Call a physician.

**Skin:** Wash with water and soap if available.

**Clothing:** Remove contaminated clothing and wash before reuse.

**Inhalation:** Remove to fresh air. Give oxygen or artificial respiration if necessary.

**Ingestion:** If hardener is swallowed and person is conscious, give plenty of water or milk to drink. **Do not induce vomiting.** Call a physician. If resin is swallowed, give 100 grams (about 1/4 lb) of activated charcoal slurry in water. **Do not induce vomiting.** Call a physician.

## Important notice



### FIBERGLASS-COMPOSITE PIPE GROUP - HEADQUARTERS

9720 Cypresswood Dr, Suite 325 • Houston, TX 77070 • Tel: (832) 912-8282 • Fax: (832) 912-9393 • [www.ameron-fpg.com](http://www.ameron-fpg.com)

#### Asia

Ameron (Pte) Ltd.  
No. 7A, Tuas Avenue 3  
Singapore 639407  
Tel: 65 6861 6118  
Fax: 65 6862 1302/861 7834  
email: [info@ameron.com.sg](mailto:info@ameron.com.sg)

#### Europe

Ameron B.V.  
J.F. Kennedylaan 7  
4190 CA Geldermalsen  
The Netherlands  
Tel: 31 345 587 587  
Fax: 31 345 587 561  
email: [info@ameron-fpg.nl](mailto:info@ameron-fpg.nl)

#### The Americas

P.O. Box 878  
Burkburnett, Texas 76354  
Tel: (940) 569-1471  
Fax: (940) 569-2764  
email: [marcom@ameronfpg.com](mailto:marcom@ameronfpg.com)

#### Centron International

P.O. Box 490  
600 FM 1195 South  
Mineral Wells, Texas 76068  
Tel: (940) 325-1341  
Fax: (940) 325-9681  
[www.centrongre.com](http://www.centrongre.com)