

Plumb Perfect™ Nylon Closet Bolt Installation

2½" & 3½" BOLT – 425 & 427 series

Strong thread design now sized for ½" nut driver.

1. Preload bolts to the closet flange.
2. Place wax ring on the underside of the toilet bowl.
3. Set bowl over bolts and flange.
4. Push down on bowl until the wax gasket compresses – making sure the bowl's rim contacts the floor.
5. Place cover cap-lock washer over bolt (correct side up).
Cover cap-lock washers come with new tank/bowl combos or can be purchased separately.



24110 South Peculiar Drive
Peculiar, Missouri 64078
P 1.800.821.3944
F 1.800.758.5950

6

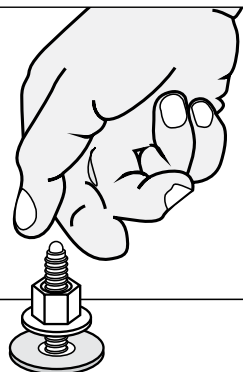

7

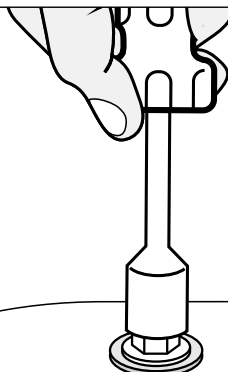

8

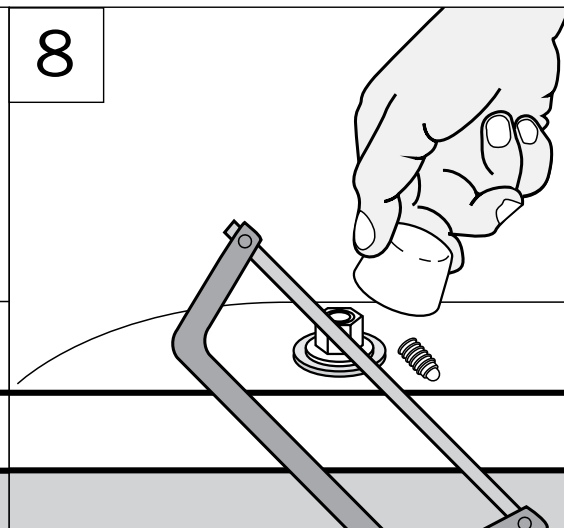

Thread nuts onto bolts until
hand tight.

Tighten nuts with ½" nut driver
1 to 2 full turns.

Cut off excess bolts and snap on
cover cap.