

# MultiPress Fittings

## for Wirsbo MultiCor™ Tubing

Wirsbo MultiPress fittings are reliable, durable and simple and quick to install. Unlike other fitting systems, MultiPress fittings do not require calibration gauges to ensure consistent fittings. MultiPress fittings are designed exclusively for Wirsbo MultiCor™ tubing.

### Installation Notes

1. Thoroughly read these instructions before the installation.
2. These instructions are for licensed contractors who are Wirsbo-trained to use MultiPress fittings and the associated installation tools.
3. Do not use Wirsbo MultiPress fittings on any other PEX tubing product. The fittings are compatible only with Wirsbo MultiCor tubing.
4. Do not use other PEX tubing fittings on Wirsbo MultiCor tubing. PEX fittings are not compatible with MultiCor tubing.
5. Use MultiCor and MultiPress fittings only in radiant heating applications.

### MultiPress Tools

Two tools are available to connect the MultiPress fitting to the Wirsbo MultiCor tubing: The MultiPress Manual Tool (D6275063) and the MultiPress Battery Tool (D6251500).

Use the MultiPress Manual Tool for ½" and ⅝" MultiCor tubing only. The tool comes with ½" and ⅝" jaws sets. Refer to **Figure 1**.

**MultiPress Manual Tool**

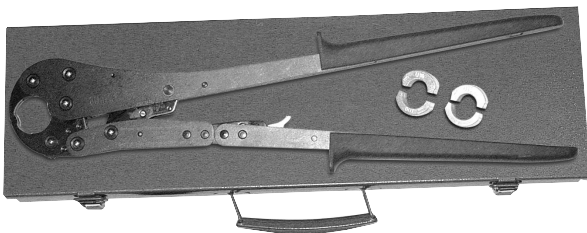

**Figure 1**

You can use the MultiPress Battery Tool for all MultiCor tubing dimensions (½", ⅝", ¾" and 1"). The ¾" and 1"



**MultiPress Battery Tool**  
**Figure 2**

jaws sets are included with the tool. Purchase the ½" and ⅝" jaws sets separately. The tool also comes with two rechargeable NiCAD batteries and one battery charger. Refer to **Figure 2**.

### Making a MultiPress Fitting

#### Step 1: Prepare the MultiCor Tubing

1. Square cut the PEX tubing perpendicular to the length of the tubing.

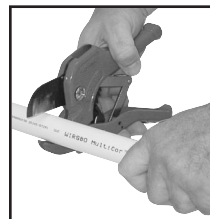

2. Use a Wirsbo tubing cutter (E6081125 or E6081500) to ensure a proper cut.
3. After cutting the tubing, use the appropriate chamfering tool on the tubing end. Use either the three-way chamfering tool for ½", ⅝" and ¾" tubing or individual T-handled chamfering tools for ½", ⅝", ¾" and 1" tubing.
4. Chamfer the tubing end until uniform. Remove the tool and clean any shavings from the chamfered end.

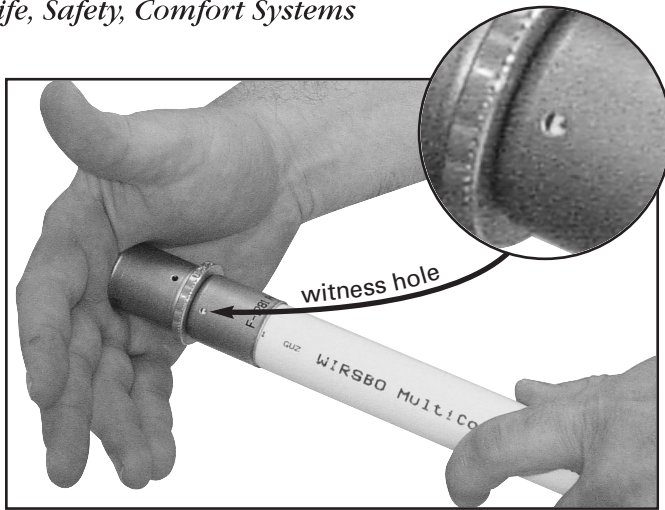

### Step 2: Install the MultiPress Fitting

1. Insert the tubing end into the MultiPress fitting until the tubing is visible through the witness holes on the stainless steel sleeve. Take care not to damage the o-rings.
2. Ensure the MultiPress Battery Tool has the appropriately sized press head installed. Read the MultiPress Installation Guide, included with the tool, before proceeding.
3. Manually push the press head jaws together at the base near the tool body until the jaws can be positioned over the MultiPress fitting. Release the pressure on the press head so the jaws close down around the fitting. Position the jaws of the press head equal distances from each end of the fitting's stainless steel sleeve.



4. Engage the trigger switch to close the jaws over the fitting. Hold the trigger until you hear a clicking noise that signals the press is complete. Push the reset button and manually push the press head jaws together at the base near the tool body until the jaws release the head from the completed fitting.

5. When using the MultiPress Manual Tool, press the handles of the tool together until they close against the stops. Release the handles and remove the tool from the completed fitting.



### Step 3: When Installing the MultiPress Sweat Fittings (When applicable)

1. If not already disassembled, remove the two o-rings from the fitting prior to sweating.
2. After the sweating, allow the fitting to cool down to room temperature.
3. Reinstall the o-rings in their proper position on the fitting. Position the large o-ring in the groove next to the shoulder of the fitting. Position the smaller o-ring in the groove midway along the fitting. See **Figure 3**.
4. Slide the stainless steel sleeve over the fitting until it snaps into place. Ensure the witness holes are positioned toward the shoulder of the fitting and not the end.
5. Complete the fitting installation as described in **Step 1** — Prepare the MultiCor Tubing and in **Step 2** — Install the MultiPress Fitting.

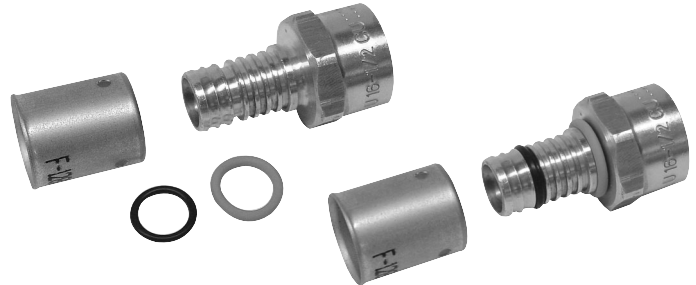

**MultiCor Sweat Fitting with Press Sleeve Removed**  
**Figure 3**

### Step 4: Inspection and Pressure Testing

1. Visibly inspect all fittings prior to pressurizing the system.
2. Pressurize the hydronic system in accordance with local code requirements. In the absence of code requirements, pressurize the system with air to 60 psi for at least 24 hours prior to embedding tubing in concrete.
3. Keep the system under pressure until construction around the tubing system is completed. This will ensure system integrity throughout the construction phase.

MPF\_IS 08/03