

INSTALLATION INSTRUCTIONS

P22730-00, P22730-LV, P22730-CC,
P22730-BC, P22730-GC, P23100-LV,
P23200-LV, P23200-RK, P23200-SK,
P23200-SL, P24030-CR, P24030-KL,
P24030-CL, P24030-RB, P24030-RL

INSTALLATION INSTRUCTIONS

THANK YOU FOR CHOOSING KALLISTA

We appreciate your commitment to KALLISTA quality products. Please take a moment to review this manual before you install your KALLISTA product. If you encounter any installation or performance problems, please do not hesitate to contact us at the phone number listed at the bottom of the page.

TOOLS

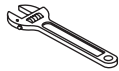

Adjustable
Wrench



Thread
Sealant



Plumbers
Putty

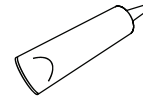

Heavy Duty
Pipe Sealant

IMPORTANT INFORMATION

- Observe all local building codes.
- Shut off the main water supply.
- Carefully inspect waste and supply tubing for any sign of damage. Replace if necessary.
- For new installations, install the faucet before installing the lavatory.
- The appearance of your product may differ from what is shown in these instructions, however, the installation procedure is the same.
- KALLISTA reserves the right to make revisions in the design of products without notice, as specified in the Price Book.

1. ASSEMBLE THE QUICK-CONNECT TEE (P23200 ONLY)

- Install the rubber washer and gasket in the top of the quick connect tee.
- Install the O-ring and pop-up rod sleeve cap in the bottom of the quick connect tee.
- Install the O-rings in the grooves in the quick connect tee. Apply lubricant (included in hardware kit) to O-rings.

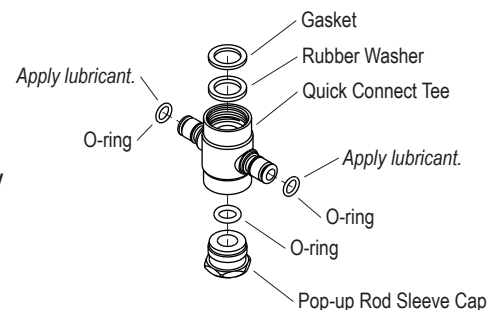

INSTALLATION INSTRUCTIONS

2. SPOUT INSTALLATION (P22730 ONLY)

- Remove the pop-up rod sleeve cap, quick connect tee, nut and washer from the spout assembly.
 - Ensure that the gasket is installed in the underside of the escutcheon.
 - Fit the spout shank through the top of lavatory.
 - Install the washer and nut. Securely wrench tighten the nut.
- NOTE:** If the lift rod tube will not pass through the quick connect tee easily, **DO NOT** force it. Remove the retainer nut, sleeve, and O-ring from the quick connect tee.
- Ensure that the fiber washer is in the tee. Thread the tee on to the spout shank.
 - Hold the spout in position and tighten the tee securely. Do not overtighten.
 - Replace the O-ring, sleeve and retainer nut, if necessary.
 - Slide the pop-up rod sleeve cap all the way up the pop-up rod and secure to the bottom of the pop-up rod sleeve with the screw.

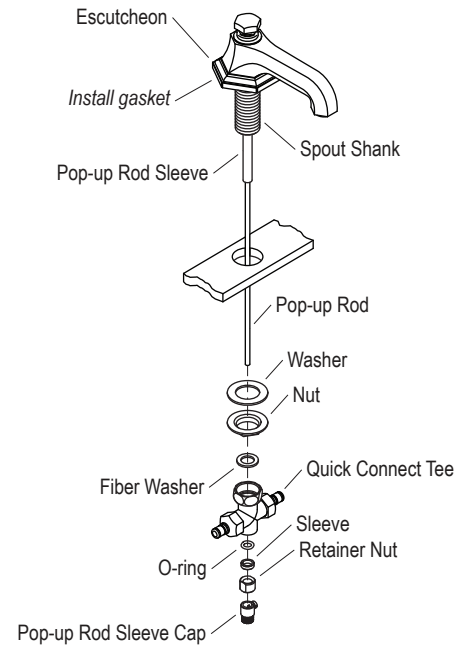

3. SPOUT INSTALLATION (ALL OTHER)

- Ensure that the gasket is installed in the underside of the escutcheon.
 - Fit the spout shank through the top of lavatory.
 - Install the rubber washer, washer and nut. Securely wrench tighten the nut.
- NOTE:** If the lift rod tube will not pass through the quick connect tee easily, **DO NOT** force it. Remove the retainer nut, sleeve, and O-ring from the quick connect tee.
- Insert the fiber washer into the tee. Thread the tee on to the spout shank.
 - Hold the spout in position and tighten the tee securely. Do not overtighten.
 - Replace the O-ring, sleeve and retainer nut, if necessary.

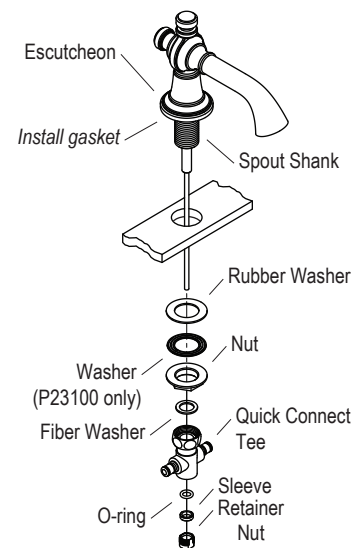

INSTALLATION INSTRUCTIONS

4. HANDLE BODY INSTALLATION

- Ensure that the gasket is installed in the underside of the escutcheon.
- Remove the washers and nuts from the valve assemblies.
- Insert the valve assembly hoses through the mounting holes from the top of the lavatory. Make sure the valve assembly marked "COLD" is installed in the right-hand hole (as viewed from the front of the lavatory).
- Install the spacers (spacers may be omitted for thick deck applications), washers, and nuts to the bottom of the valve assemblies.
- Align the valve assemblies so that the handles are oriented as desired in the off position .
- Wrench tighten the nuts.
- Connect the quick connect fittings to the quick connect tee inlets. Do not use thread sealant. To avoid kinking the hoses, loop them as shown.

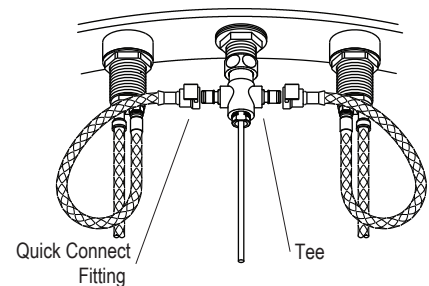
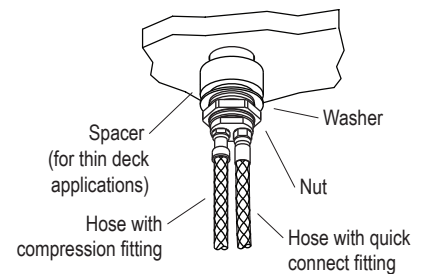
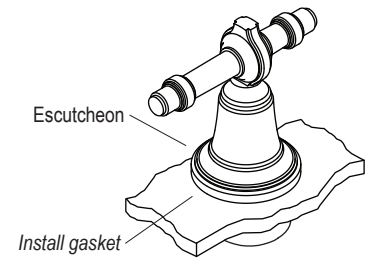

5. HANDLE ALIGNMENT ADJUSTMENT

- If adjustment is needed to achieve the desired handle alignment, ensure that the handles are in the closed position (Hot = Counterclockwise, Cold = Clockwise).
- Unscrew the handle assembly from the collar.
- Remove the spline adapter from the valve stem and rotate it one spline. Reinstall the spline adapter onto the valve stem.
- Place the handle assembly on the valve stem and check the handle position.
- Repeat the procedure until the proper handle position is achieved.
- Thread the handle assembly onto the collar. To maintain the proper handle alignment, hold the handle in place with one hand and turn the base of the handle assembly with the other hand.
- Repeat the procedure with the second handle assembly.

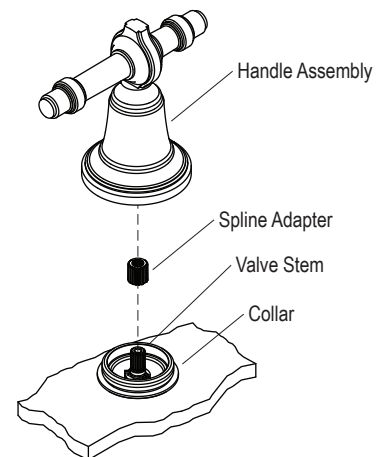

INSTALLATION INSTRUCTIONS

6. DRAIN INSTALLATION

- Remove the protective cover from the flange.
- Apply a ring of plumbers putty or other sealant to the underside of the flange according to the putty manufacturer's instructions.
- Assemble the nut, flat washer, and tapered gasket (tapered side up) fully onto the body.
- From the underside of the fixture, insert the drain body up into the drain hole.
- From the top of the fixture, securely hand tighten the flange onto the drain body.
- Make sure the drain body seal hole is facing the back of the fixture, and securely tighten the nut.
- Remove any excess putty or sealant.

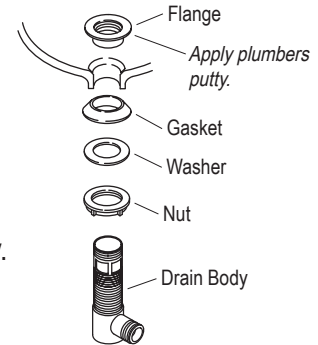

7. COMPLETE DRAIN INSTALLATION

- Insert the stopper into the flange.
- For regular installations, insert the short end of the rod into the body seal hole and under the stopper. For vandal-resistant installations, fit the rod through the hole in the stopper. Hand tighten the body nut.
- Remove and adjust the stopper as needed so it lifts about 3/8" (1 cm) when opened. To adjust, rotate the threaded stopper rod in or out as needed. Retighten the stopper nut.
- Apply thread sealant tape to the tail piece threads, and thread the tail piece to the body. Tighten the tail piece securely.
- Slide one end of the clip on to the rod. Slide the link onto the rod with the thumb screw facing the back of the fixture.

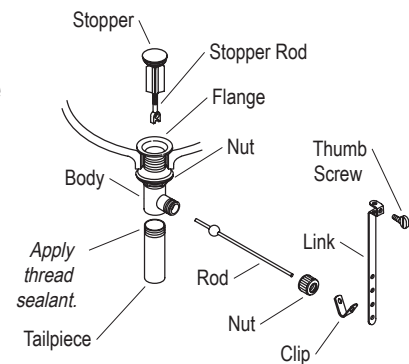

8. SUPPLY TUBE AND SUPPLY STOP CONNECTION

- Install the lavatory using the lavatory manufacturer's instructions.
- Connect the supply hoses from the valve assemblies to the supply stops. (Left is hot - right is cold).
- Tighten all connections.

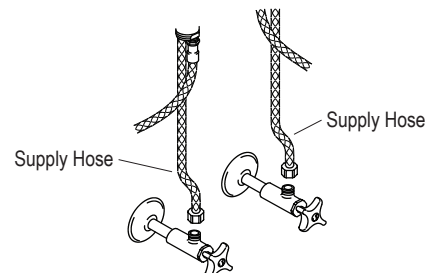

INSTALLATION INSTRUCTIONS**9. INSTALLATION CHECKOUT**

- Connect the tailpiece and P-trap (not supplied).
- Ensure that all connections are watertight.
- Remove the aerator assembly by turning it counterclockwise.
- Open the drain. Turn on the main water supply and check for leaks.
Repair as needed.
- Open both hot and cold valves and run water through the spout for one minute to remove debris. Check for leaks in the flexible hose connections.
Turn valves off.
- Re-install the aerator assembly.

