

# Installation Instructions

## Towel Ring, Hook & Open Towel/Tissue Holder

Model No. 34-09, 34-12, 34-13,  
34-27, 35-09, 35-12, 35-13, 35-27

NEWPORT BRASS®

Flawless Beauty. From Faucet to Finish.™

Recommended Installation by a Professional Contractor

1. Drill hole in wall at points marked using the appropriate drill size:

- Wood Screw (#6 x 2") - use: 3/32" Drill
- Toggle Screw (6-32 x 3") - use: 3/8" Drill

2. Fasten FLANGE (1) to wall using either WOOD/TOGGLE SCREW (3). Engage POST (2), into FLANGE (1). Complete engagement of POST (2) height is 2" from mounting surface. Secure POST (2), into place by tightening SETSCREW (4), on FLANGE (1). (See Fig. 1)

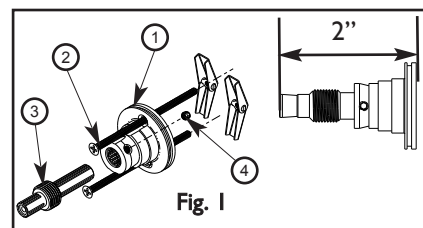

3. Place ESCUTCHEON (3), onto FLANGE (1), place BONNET (4) over POST (2) and against ESCUTCHEON (3). (See Fig. 2)

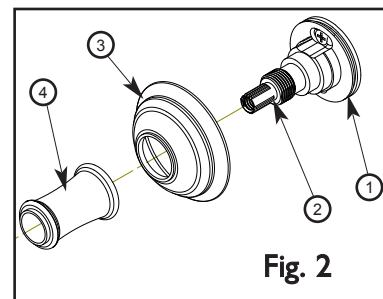

4a. **Garment Hook:** Slide END POST (1) into BONNET (3). Secure into place with SCREW (4). Place O-RING (5) onto END CAP (6) and press into END POST (1). (See Fig. 3 & 4)

4b. **Towel / Tissue Holder:** Slide END POST (1) into BONNET (3). Secure into place with SCREW (4). Place O-RING (5) onto END CAP (6) and press into END POST (1). (See Fig. 5 & 6.)

